

n°	Artikel	Aantal gebruikt
1B	986812 HOUSING ASS'Y	1
2A	963383 HEX. SOCKET SET SCREW M4X8	2
2B	938477 HEX. SOCKET SET SCREW M5X8	2
3B	990721 BRUSH HOLDER	2
3A	980928 BRUSH HOLDER	2
4A	313754 GEAR COVER ASS'Y	1
5A	980920 CRANK CASE	1
6	980921Z CYLINDER CASE	1
7	980864 HEX. HD. TAPPING SCREW D5X40	2
8	980865 WASHER (A)	1
9	946362 BEARING LOCK	1
11	873085 O-RING (P-14)	1
12	971736 WASHER (B)	1
13A	6000DD BALL BEARING 6000DDCMPS2L	1
14	980866 WASHER (C)	1
15A	872470 O-RING (S-26)	1
15	931701 BEARING LOCK	1
16	980867 NEEDLE BEARING (HK0609)	1
17	980868 CRANK SHAFT	1
18	940220 WOODRUFF KEY 2.5X8	1
19	980869 FIRST GEAR	1
20	980870 DISTANCE COLLAR	1
21	6202DD BALL BEARING 6202DDCMPS2L	1
22	980871 BEARING COVER	1
23	949217 MACHINE SCREW M4X12 (10 PCS.)	2
24	949453 SPRING WASHER M4 (10 PCS.)	2
25	980872 NUT (A)	1
26	980873 WASHER	1
27	626VVM BALL BEARING 626VVC2PS2L	1
28	980874 THIRD PINION	1
29	980875 CLUTCH PLATE	2
30	980876 SLIP PLATE	2
31	980877 BELLEVILLE SPRING	1
32	980878 SECOND GEAR	1
33	6001DD BALL BEARING 6001DDCMPS2L	1
34	980948 O-RING	1
35	980880 OIL CAP	1
36	980881 CONNECTING ROD ASS'Y	1
37	673422 NEEDLE BEARING (HK0709)	1

38	980882	PISTON	1
39	980883	PISTON PIN	1
40	980884	O-RING (A)	2
41	980885	CYLINDER	1
42	980886	THIRD GEAR	1
43	980887	STRIKER	1
44	980888	SECOND HAMMER	1
45	872645	O-RING (P-9)	1
46A	980889	RETAINER SLEEVE (A) (FOR SQUARE SHANK)	1
46B	980935	RETAINER SLEEVE (FOR SQUARE SHANK)	1
46D	980952	RETAINER SLEEVE (E) (FOR ROUND SHANK)	1
46C	980944Z	RETAINER SLEEVE (C) (FOR SQUARE SHANK)	1
46	980942Z	RETAINER SLEEVE (B) (FOR SQUARE SHANK)	1
47	980890	O-RING (D)	2
48	959150	STEEL BALL D6.35 (10 PCS.)	6
49	980891	PIPE	1
50A	6906T2	BALL BEARING 6906T2CN	1
51	980893	WASHER (D)	1
52	980929	OIL SEAL	1
53	980894	CYLINDER CAP	1
54	980895	O-RING (C)	1
55	980896	SEAL PACKING (B)	1
56	980937	SPRING	1
58B	980936Z	SLIDE GRIP	1
58A	980898	SLIDE GRIP	1
58C	990763	SLIDE GRIP	1
59	971769	FRONT CAP	1
61	958705	TAPPING SCREW D4X25	3
63	960266	CORD CLIP	1
64	954004	TAPPING SCREW D4X16	2
65	949423	WASHER M4 (10 PCS.)	2
66A	985620	TAPPING SCREW (W/FLANGE) D5X25	2
68	949243	MACHINE SCREW M5X25 (10 PCS.)	2
69	949454	SPRING WASHER M5 (10 PCS.)	2
70	949431	BOLT WASHER M5 (10 PCS.)	2
71A	992253	HEX. SOCKET HD. BOLT (W/FLANGE) M5X25	4
72A	980951	HEX. SOCKET HD. BOLT (W/FLANGE) M5X45	4
75B	999021	CARBON BRUSH (1 PAIR)	2
75A	999035	CARBON BRUSH (1 PAIR)	2
75A	980666Z	CARBON BRUSH (AUTO STOP TYPE) (1 PAIR)	2
75C	999070	CARBON BRUSH (AUTO STOP TYPE) (1 PAIR)	2

76	937847	BRUSH CAP	2
77	971816	HANDLE PACKING	1
78	980900	PLATE	1
79	980901	SIDE HANDLE	1
80A	980902	SIDE HANDLE HOLDER	1
81	980903	SQUARE BOLT M8	1
82	980904	BAND	1
83	980905	ROD HOLDER	1
84A	980906	STOPPER ROD	1
85	971787	DUST CUP	1
87	949510	RIVET D2.5X4.8 (10 PCS.)	2
88	980908K	STATOR ASS'Y 220V-230V	1
88	980908G	STATOR ASS'Y 220V	1
88	980908F	STATOR ASS'Y 230V-240V	1
89	980910F	ARMATURE 240V	1
89	980910E	ARMATURE 220V-230V	1
90	500232Z	CORD	1
90	500422Z	CORD	1
90B	500457Z	CORD	1
90	500390Z	CORD	1
90C	500440Z	CORD	1
90	500391Z	CORD	1
90	500235Z	CORD	1
90	500408Z	CORD	1
90	500239Z	CORD	1
90	500394Z	CORD	1
90A	500446Z	CORD	1
91	953327	CORD ARMOR D8.8	1
91	938051	CORD ARMOR D10.1	1
92A	320139	SWITCH (2P INSERT TYPE) W/LOCK	1
93	994273	NOISE SUPPRESSOR	1
94	930153	SUPPORT (B)	1
95A	986277	INTERNAL WIRE	1
95	971825	INTERNAL WIRE	1
95	971776	INTERNAL WIRE	1
97	959140	CONNECTOR 50091 (10 PCS.)	1
98	959141	CONNECTOR 50092 (10 PCS.)	1
100	980923Z	HANDLE (B)	1
101	980924Z	HANDLE COVER (B)	1
103	930630	BRUSH TERMINAL	2
104		NAME PLATE	1

105	980930	URETHANE RING	1
106	980931	FAN GUIDE	1
107	980132Z	CHOKE COIL (C)	1
108B	312645	CASE	1
109	981373	TUBE (D)	2
110	310290	HOLDER PLATE	1
110	938307	PILLAR TERMINAL	1
113	958308Z	PILLAR TERMINAL (A)	1
114	980934Z	CAUTION PLATE (ENGLISH)	1
115	980938Z	RETAINER SLEEVE ASS'Y (FOR SQUARE SHANK)	1
116A	971812	NEEDLE ROLLER	2
116	959151	STEEL BALL D7.14 (10 PCS.)	4
123	980939	SIDE HANDLE ASS'Y	1
127	980949	CYLINDER CASE ASS'Y	1
128	980950	RETAINER SLEEVE ASS'Y (FOR SQUARE SHANK)	1
128A	980954	RETAINER SLEEVE (E) ASS'Y (ROUND SHANK)	1
129	309470	TAPPING SCREW (W/FLANGE) D4X12 (BLACK)	1
601	930119	CHUCK WRENCH 6.5G	1
602	321811	DRILL CHUCK 10VLB-D	1
603	971794	ANCHOR SETTING ADAPTER A W1/4" (MANUAL)	1
604	971795	ANCHOR SETTING ADAPTER A W5/16" (MANUAL)	1
605	971796	ANCHOR SETTING ADAPTER A W3/8" (MANUAL)	1
606	971799	ANCHOR SETTING ADAPTER B W1/4" (MANUAL)	1
607	971800	ANCHOR SETTING ADAPTER B W5/16" (MANUAL)	1
608	971801	ANCHOR SETTING ADAPTER B W3/8" (MANUAL)	1
615	971810Z	A-TAPER SHANK ADAPTER	1
626	971976	DRILL BIT (A) D9.5X159	1
641	980927	GREASE FOR HAMMER.HAMMER DRILL (500G)	1
642	980943Z	CHUCK ADAPTER (B) (SQUARE SHANK)	1
643	981840	GREASE (A) FOR HAMMER.HAMMER DRILL (30G)	1
644	936728	WRENCH	1
645A	981142	SERVICE KIT (VR-16 ETC.)	1
646	308471	GREASE FOR HAMMER.HAMMER DRILL (70G)	1

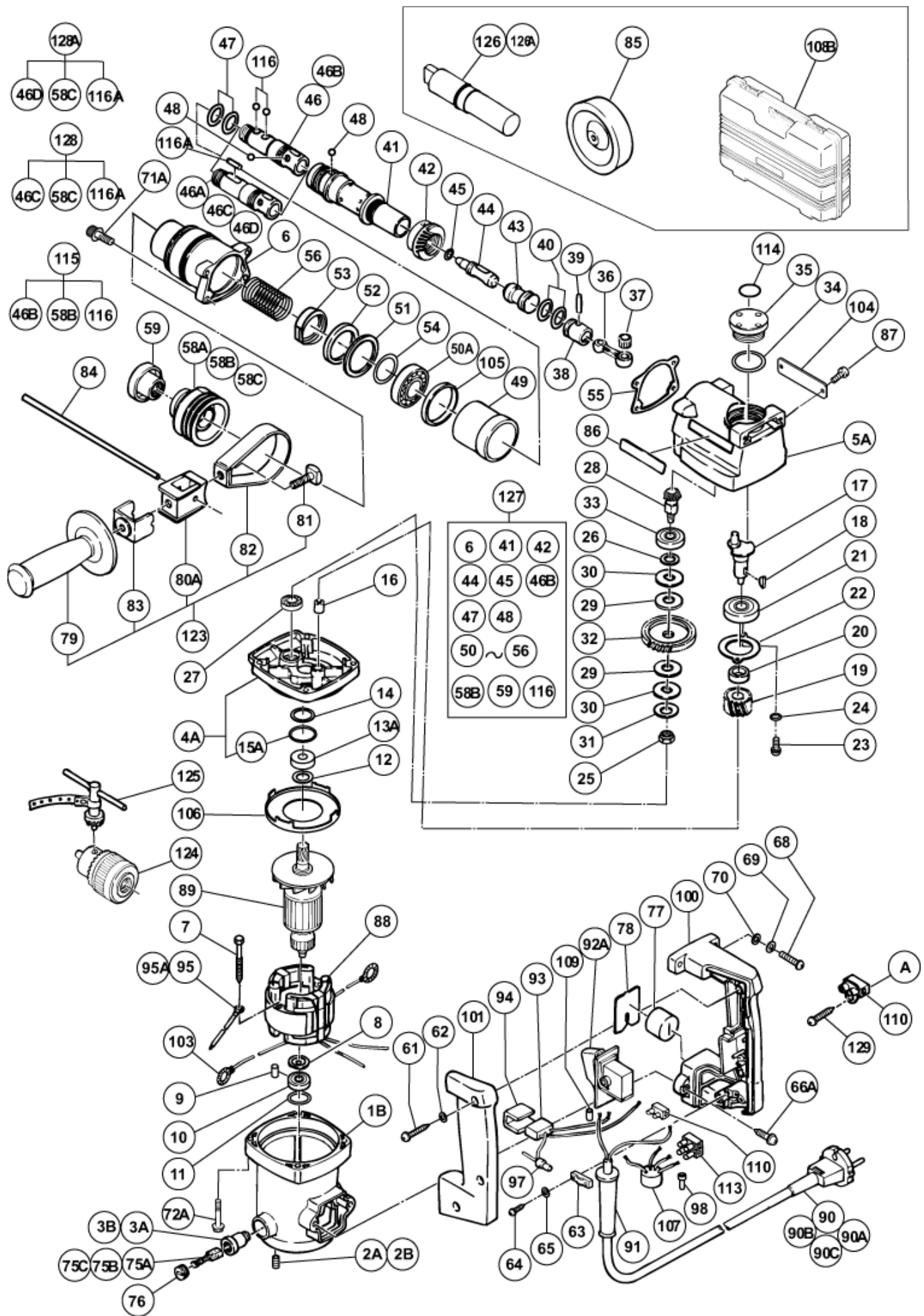

形 名
VRV-16