

# SCROLL SAW

## SC155

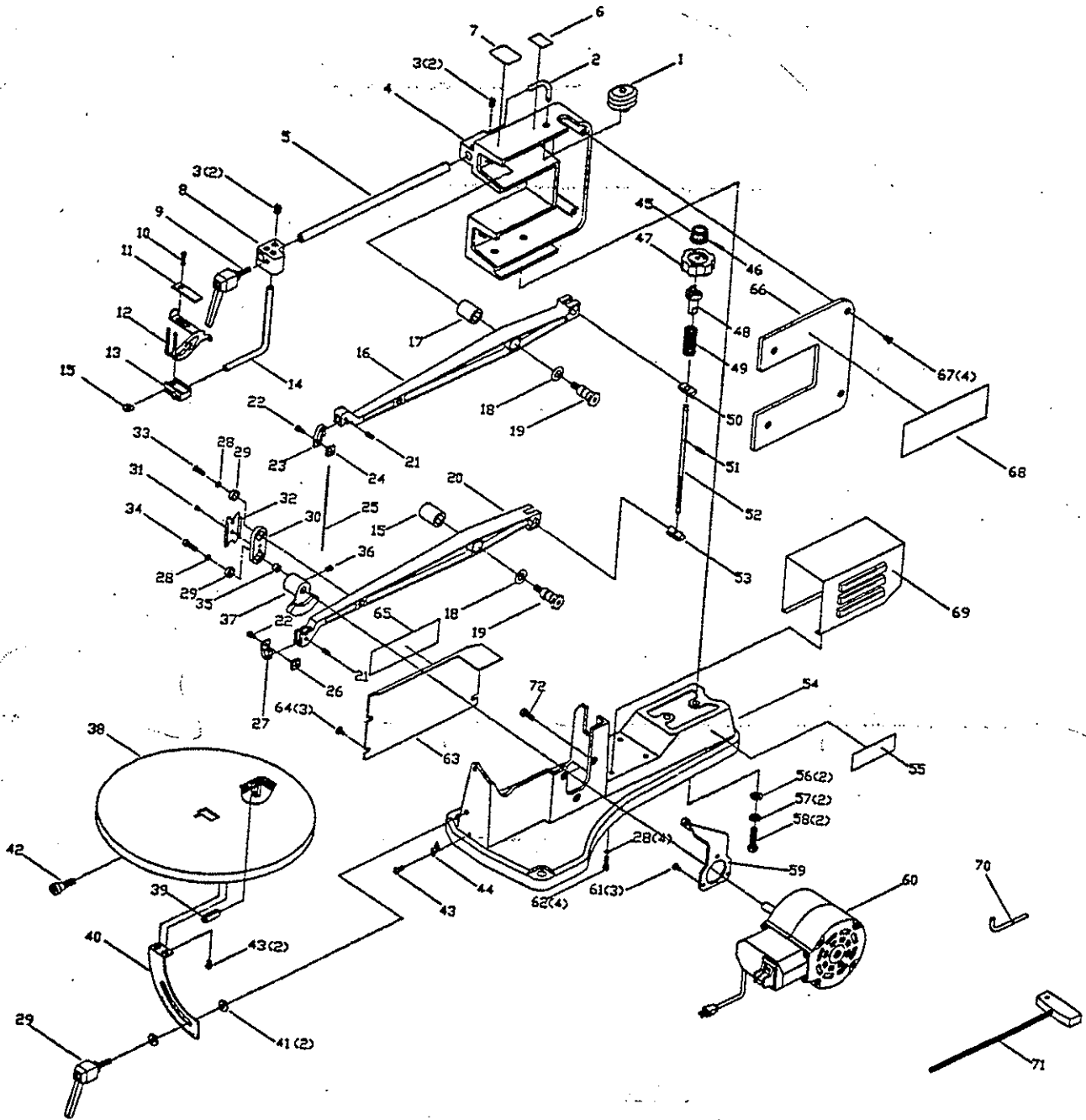

## PARTS LIST FOR AFTER SALES SERVICE MODEL SC-155

QTY	PART NO.	DESCRIPTION	QTY	REF	PART NO.	DESCRIPTION	QTY
	102020005	DUST BLOWER	1	37	105014003	COUNTERBALANCE	1
2	105013007	ELBOW	1	38	105015009	TURN TABLE	1
3	180030801	CLAMP SCREW M8 X 10L	4	39	420010502	ROLL SPRING PIN	1
4	105002006	"C" FRAME	1	40	105018007	MITER SCALE	1
5	105020004	SUPPORT BAR	1	41	350306162	FLAT WASHER M6	2
6	168042007	INSTRUCTION PLATE	1	42	102039004	TABLE SCREW	1
7	168043003	CAUTION LABEL	1	43	190030500	BOLT M5 X 15L	3
8	104055006	BRACKET	1	44	104022003	INDICATOR POINT	1
9	104056002	LOCK HANDLE ASSEMBLY	2	45	105045004	KNOB	1
10	700305016	HEX SKT BOLT M5 X 16L	1	46	420010031	ROLL SPRING PIN	1
11	102031006	SUPPORT PLATE	1	47	105046000	KNOB	1
12	105023002	HOLD DOWN	1	48	105027006	SPACER	1
13	105022006	HOLD DOWN CLAMP	1	49	105024008	ARM SPRING	1
14	105021000	SUPPORT BAR	1	50	102019004	TENSION WEDGE	1
15	350305122	FLAT WAHER	1	51	420010302	ROLL SPRING PIN	1
16	105011005	UPPER ARM	1	52	105028002	TENSION BOLT	1
17	105016002	BUSHING	2	53	105012001	TENSION WEDGE	1
18	380314300	WAVY WASHER	2	54	105001000	BASE PLATE	1
19	104030006	SPACER	2	55	168040005	NAME PLATE	1
20	105016005	LOWER ARM	1	56	350308161	FLAT WASHER M8	2
21	420010501	ROLL SPRING PIN	2	57	360308000	SPRING WAHER M8	2
22	700305008	HEX SKT BOLT M5 X 8L	2	58	100308020	HEX BOLT M8 X 20L	2
23	101003204	UPPER CLAMP	1	59	105004008	TABLE SUPPORT	1
	101030104	UPPER HOLDER	1	60	904200004	MOTOR	1
25	101074001	BLADE	1	61	160030400	BOLT M4 X 8L	3
26	101031100	LOWER HOLDER	1	62	100030501	BOLT M5 X 15L	4
27	101004200	LOWER CLAMP	1	63	105017001	COVER	1
28	360305000	SPRING WASHER M5	6	64	190030500	BOLT M5 X 8L	3
29	9820625	BALL BEARING 6252Z	2	65	168041001	WARNING LABEL	1
30	104038004	LINK	1	66	105025004	COVER ASSEMBLY	1
31	230030400	SCREW M4 X 8L	1	67	160030601	BOLT M6 X 15L	4
32	104062002	BEARING HOLDER	1	68	168037002	LOGO PLATE	1
33	800305018	HEX SCREW M5 X 18L	1	69	105019003	ARM COVER	1
34	700305018	HEX SKT BOLT M5 X 18L	1	70	101058102	BLADE CHANGE ROD	1
35	100025009	ARM BUSH	1	71	101060002	"T" HANDLE WRENCH	1
36	180030600	CLAMP SCREW M6 X 6L	1	72	300305015	HEX BOLT M5 X 15L	3

**SERVICE NOTES:**

Switch Key  
4550041