

ELECTRIC TOOL PARTS LIST

■ BELT SANDER
Model SB-75

1994 · 4 · 4
(E11)

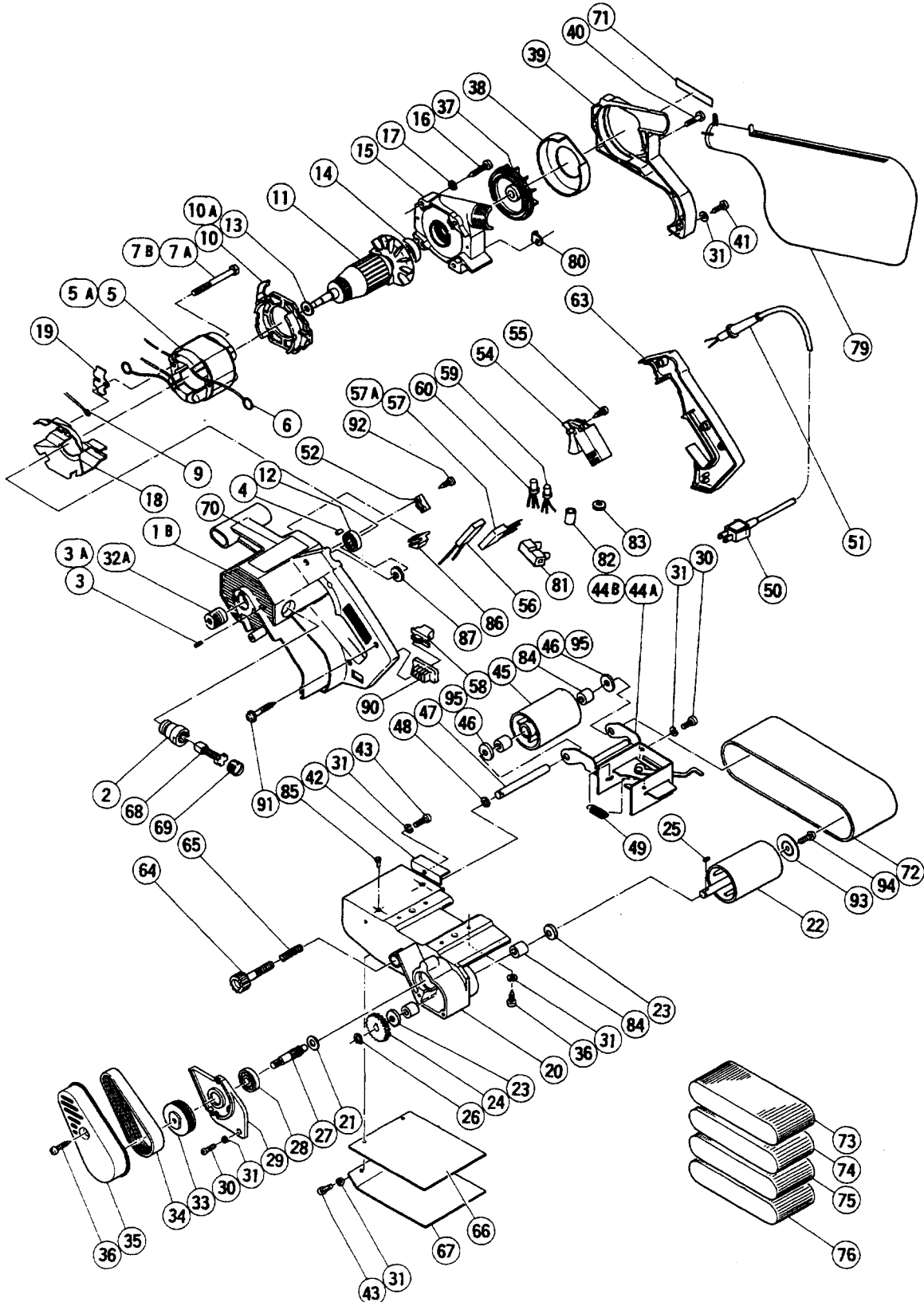

PARTS

SB - 75

ITEM NO.	CODE NO.	DESCRIPTION	NO. USED	REMARKS
* 1B	953-140	HOUSING ASS'Y	1	INCLUD.2,3A,7B,90
* 1B	953-172Z	HOUSING ASS'Y	1	INCLUD.2,3A,7B,90 FOR AUT
* 2	958-900	BRUSH HOLDER	2	
* 2	981-586	BRUSH HOLDER	2	FOR AUT
3	949-368	SLOTTED HD. SET SCREW M4X10 (10 PCS.)	2	TILL 6.1988
3A	938-477	HEX. SOCKET SET SCREW M5X8	2	SINCE 7.1988
4	931-701	BEARING LOCK	1	
* 5	953-142C	STATOR ASS'Y 110V - 115V	1	INCLUD.6
* 5	953-142D	STATOR ASS'Y 120V - 127V	1	INCLUD.6
* 5	953-142E	STATOR ASS'Y 220V - 230V	1	INCLUD.6
* 5	953-142F	STATOR ASS'Y 240V	1	INCLUD.6
* 5	953-142G	STATOR ASS'Y 230V	1	INCLUD.6 FOR NZL
* 5	953-142M	STATOR ASS'Y 230V	1	INCLUD.6 FOR SAF
* 5	953-142H	STATOR ASS'Y 240V	1	INCLUD.6 FOR GBR
* 5	953-142K	STATOR ASS'Y 110V	1	INCLUD.6 FOR GBR
* 5	953-142L	STATOR ASS'Y 115V	1	INCLUD.6 FOR USA
* 5A	340-104L	STATOR ASS'Y 220V - 230V	1	INCLUD.6 FOR EUROPE
* 5A	340-104M	STATOR 220V - 230V	1	INCLUD.6 FOR FRG
6	930-703	BRUSH TERMINAL	2	
7A	949-233	MACHINE SCREW M5X55 (10 PCS.)	2	TILL 6.1980
7B	953-174	HEX. HD. TAPPING SCREW D5X55	2	SINCE 7.1980
* 9	953-033	INTERNAL WIRE	1	
* 9	961-421Z	INTERNAL WIRE	1	FOR FIN,AUT
* 10	953-143	FAN GUIDE (A)	1	FOR AUS,GBR,HOLDEN,SWE,AUT,SUI
* 10A	953-185	FAN GUIDE	1	FOR SAU,INA,SYR,SIN,KUW,NGU,NZL,SAF,ITA, FRG,FRA,USA,CAN,FIN,NOR
* 11	953-145U	ARMATURE ASS'Y 110V - 115V	1	INCLUD.12 - 14
* 11	953-145D	ARMATURE 120V - 127V	1	
* 11	953-145E	ARMATURE 220V - 230V	1	
* 11	953-145F	ARMATURE 230V - 240V	1	FOR KUW,NGU,AUS,GBR,FRG,FRA,FIN,NOR
12	629-VVM	BALL BEARING 629VVMC2EPS2L	1	
13	954-234	BEARING WASHER (B)	1	
14	620-0VV	BALL BEARING 6200VVCMP2S	1	
15	953-146	INNER COVER	1	
16	957-580	TAPPING SCREW D5X30	4	
17	949-454	SPRING WASHER M5 (10 PCS.)	4	
* 18	953-147	FAN GUIDE (B)	1	TILL 11.1986 FOR AUT,GBR,HOLDEN,SWE, AUS,SUI
* 19	953-148	FAN GUIDE (C)	2	TILL 11.1986 FOR AUT,GBR,HOLDEN,SWE, AUS,SUI
* 20	953-149	BODY ASS'Y	1	INCLUD.21,84
* 20	953-176Z	BODY ASS'Y	1	INCLUD.21,84 FOR SWE,NOR
21	935-522	METAL	1	
* 22	953-150	DRIVE PULLEY	1	(TILL 12.1985 FOR FRG ONLY)
* 22	953-183	DRIVE PULLEY	1	SINCE 1.1986 FOR FRG
23	948-213	WASHER (B) D19	2	
24	953-151	GEAR	1	
25	944-109	FEATHER KEY 3X3X8	1	
26	939-540	RETAINING RING FOR D10 SHAFT (10 PCS.)	1	
27	953-152	PINION	1	
28	620-0VV	BALL BEARING 6200VVCMP2S	1	

*: ALTERNATIVE PARTS

PARTS

SB - 75

ITEM NO.	CODE NO.	DESCRIPTION	NO. USED	REMARKS
29	953-153	GEAR COVER	1	
30	949-218	MACHINE SCREW M4X14 (10 PCS.)	5	
31	949-453	SPRING WASHER M4 (10 PCS.)	8	
32A	987-532	PULLEY (A)	1	
33	953-154	PULLEY (B)	1	
34	958-874	BELT	1	
35	953-155	BELT COVER	1	
36	954-004	TAPPING SCREW D4X16	5	
37	953-053	DUST FAN	1	
38	953-156	DUST GUIDE	1	
39	953-157	DUST COVER	1	
40	949-223	MACHINE SCREW M4X25 (10 PCS.)	2	
41	956-384	TAPPING SCREW D4X20	1	
42	953-158	STRIKING GUIDE	1	
43	949-216	MACHINE SCREW M4X10 (10 PCS.)	3	
* 44A	953-159	BELT TENSIONER ASS'Y	1	INCLUD.45 -- 49 (TILL 12.1985 FOR FRG ONLY)
* 44B	953-182	BELT TENSIONER ASS'Y	1	INCLUD.45 -- 49,95 SINCE 1.1986 FOR FRG
45	953-180	IDLE PULLEY ASS'Y	1	INCLUD.84
46	953-161	WASHER	2	
47	953-162	SHAFT (B)	1	
48	939-540	RETAINING RING FOR D10 SHAFT (10 PCS.)	1	
49	953-163	SPRING	1	
* 50	500-201Z	CORD	1	(CORD ARMOR D10.7) FOR ASIA
* 50	500-223Z	CORD	1	(CORD ARMOR D10.7) FOR SIN
* 50	500-226Z	CORD	1	(CORD ARMOR D8.2) FOR OCEANIA
* 50	500-231Z	CORD	1	(CORD ARMOR D8.2) FOR GBR,SAF
* 50	500-234Z	CORD	1	(CORD ARMOR D8.2) FOR EUROPE
* 50	500-240Z	CORD	1	(CORD ARMOR D8.2) FOR USA
* 50	500-420Z	CORD	1	(CORD ARMOR D10.7) FOR SAU (127V)
* 50	500-423Z	CORD	1	(CORD ARMOR D8.2) FOR SAU (220V)
* 51	958-049Z	CORD ARMOR D8.2	1	
* 51	940-778	CORD ARMOR D10.7	1	
52	937-631	CORD CLIP	1	
* 54	956-632	SWITCH (B) (2P SCREW TYPE) W/LOCK	1	
* 54	931-573	SWITCH (2P PILLAR TYPE) W/LOCK	1	FOR GBR,HOL,DEN,FIN,SWE,AUT,NOR,ITA,ESP
* 54	953-178	SWITCH (2P PILLAR TYPE) W/SAFETY LOCK	1	FOR FRA
55	954-017	TAPPING SCREW D4X12	1	
* 56	958-613	DIODE 100V - 127V	1	
* 56	958-614	DIODE 200V - 240V	1	
* 56	953-250P	DIODE 115V	1	FOR USA
* 57	960-283Z	NOISE SUPPRESSOR	1	FOR SUI
* 57A	994-273	NOISE SUPPRESSOR	1	
* 58	953-171	SLIDE SWITCH (1P SOLDER TYPE)	1	
* 58	953-179	SLIDE SWITCH (1P SOLDER TYPE)	1	FOR USA
* 59	959-140	CONNECTOR 50091 (10 PCS.)	1	
* 60	959-141	CONNECTOR 50092 (10 PCS.)	1	
* 61	959-144	TERMINAL 50051 (10 PCS.)	1	
* 62	959-145	TERMINAL 50052 (10 PCS.)	2	
63	953-164	HANDLE COVER	1	
64	953-070	ADJUSTING SCREW	1	
65	953-071	SPRING	1	

*: ALTERNATIVE PARTS

PARTS

SB - 75

ITEM NO.	CODE NO.	DESCRIPTION	NO. USED	REMARKS
66	953-165	SHOE CUSHION	1	
67	953-166	SHOE PLATE	1	
68	999-043	CARBON BRUSH (1 PAIR)	2	
* 69	945-161	BRUSH CAP	2	
* 69	961-781	BRUSH CAP	2	FOR AUT
* 70		NAME PLATE	1	
71	957-561	HITACHI LABEL	1	
72	939-731	SANDING BELTS 76X533 WA40 (10 PCS.)	1	
73	939-732	SANDING BELTS 76X533 WA60 (10 PCS.)	1	
74	939-733	SANDING BELTS 76X533 WA80 (10 PCS.)	1	
75	939-734	SANDING BELTS 76X533 WA100 (10 PCS.)	1	
76	939-735	SANDING BELTS 76X533 WA120 (10 PCS.)	1	
* 77	942-944	CUP WASHER	2	
* 78	949-440	WASHER (BRASS) M3.5 (10 PCS.)	3	
79	953-078	DUST BAG	1	
80	953-169	PLATE	1	
* 81	938-307Z	PILLAR TERMINAL	1	
* 82	981-373	TUBE (D)	2	
* 83	949-440	WASHER (BRASS) M3.5 (10 PCS.)	2	
84	953-175	METAL D10X14X12	2	
* 85	949-509	RIVET D2.5X3.2 (10 PCS.)	2	
* 86	953-177Z	WIND COVER	1	FOR NZL
* 87	944-516	BEARING WASHER (B)	1	TILL 12.1985
90	971-792	SLIDE SWITCH COVER	1	SINCE 1.1986
91	956-636	TAPPING SCREW (W/WASHER) D4X25	3	
92	984-750	TAPPING SCREW (W/FLANGE) D4X16	2	
* 93	953-181	WASHER (B)	1	FOR FRG
* 94	987-201	SEAL LOCK SCREW (W/SP. WASHER) M4X10	1	FOR FRG
* 95	953-184	WASHER (B)	2	FOR FRG

*: ALTERNATIVE PARTS

OPTIONAL ACCESSORIES

SB - 75

ITEM NO.	CODE NO.	DESCRIPTION	NO. USED	REMARKS	
601	939-736	SANDING BELTS 76X533 WA150 (10 PCS.)	1		
602	939-737	SANDING BELTS 76X533 WA180 (10 PCS.)	1		
603	939-738	SANDING BELTS 76X533 WA240 (10 PCS.)	1		
604	939-739	SANDING BELTS 76X533 AA30 (10 PCS.)	1		
605	939-740	SANDING BELTS 76X533 AA40 (10 PCS.)	1		
606	939-741	SANDING BELTS 76X533 AA80 (10 PCS.)	1		
607	939-742	SANDING BELTS 76X533 AA80 (10 PCS.)	1		
608	939-743	SANDING BELTS 76X533 AA100 (10 PCS.)	1		
609	939-744	SANDING BELTS 76X533 AA120 (10 PCS.)	1		
610	939-745	SANDING BELTS 76X533 AA150 (10 PCS.)	1		
611	939-746	SANDING BELTS 76X533 AA180 (10 PCS.)	1		
612	939-747	SANDING BELTS 76X533 AA240 (10 PCS.)	1		
613	939-748	SANDING BELTS 76X533 AA320 (10 PCS.)	1		
614	939-749	SANDING BELTS 76X533 AA400 (10 PCS.)	1		
615	939-752	SANDING BELTS 76X533 CC80 (10 PCS.)	1		
616	939-753	SANDING BELTS 76X533 CC80 (10 PCS.)	1		
617	939-754	SANDING BELTS 76X533 CC100 (10 PCS.)	1		
618	939-755	SANDING BELTS 76X533 CC120 (10 PCS.)	1		
619	939-758	SANDING BELTS 76X533 CC240 (10 PCS.)	1		