

ELECTRIC TOOL PARTS LIST

■ DUST COLLECTOR

1997 · 5 · 30

Model RP 30SA

(E1)

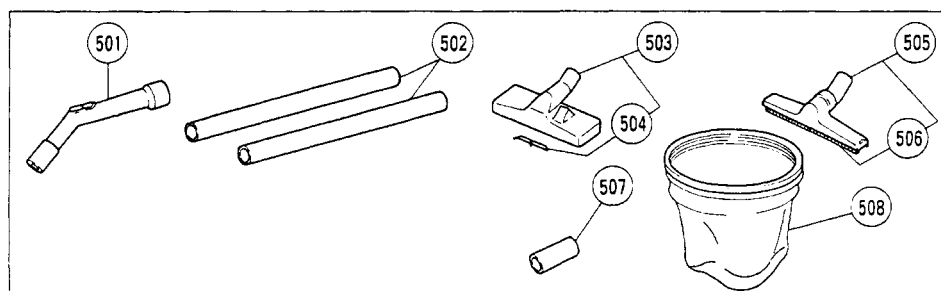
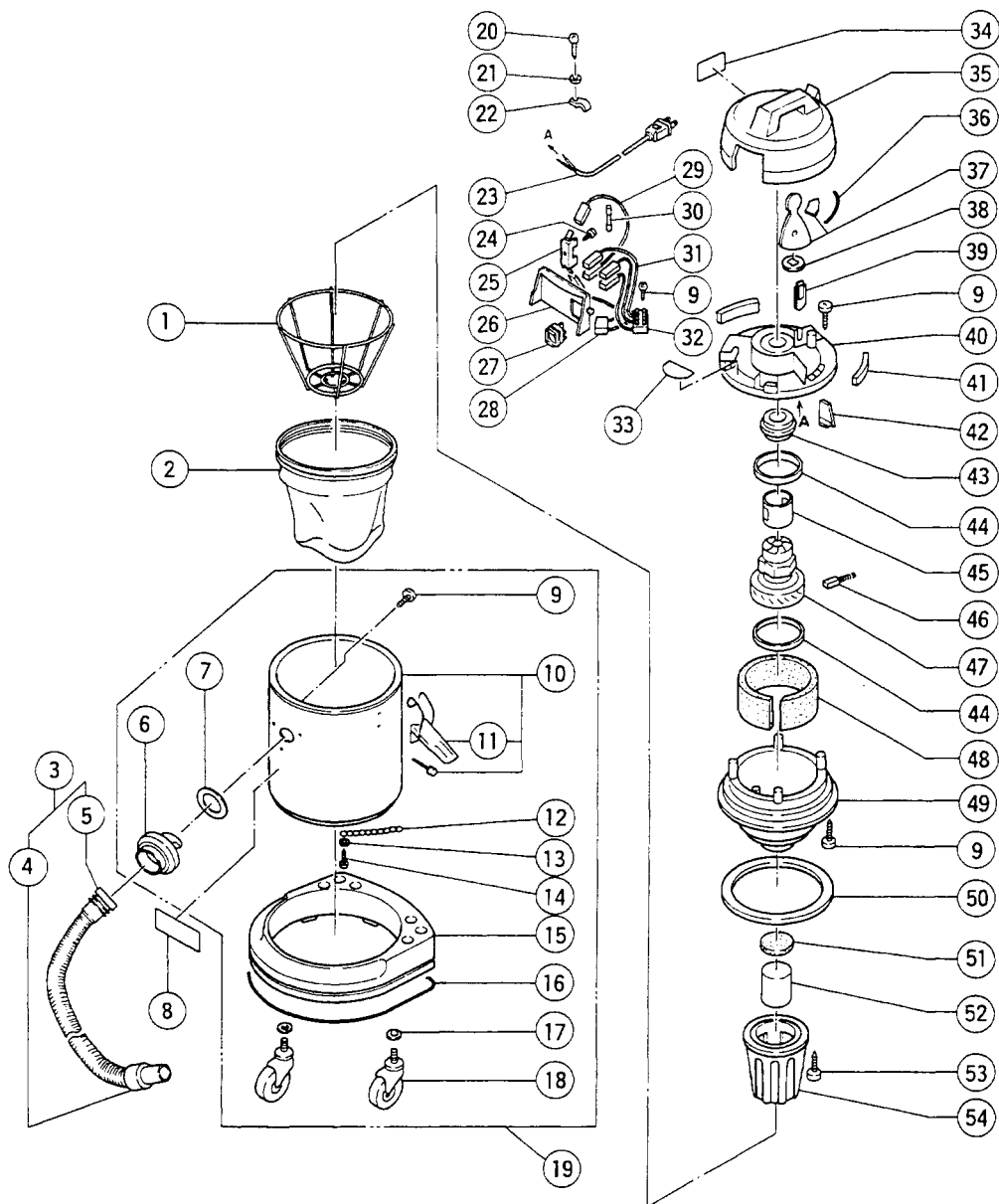

PARTS

RP 30SA

ITEM NO.	CODE NO.	DESCRIPTION	NO. USED	REMARKS
1	308-455	FILTER CAGE	1	
2	314-708	DRY DUST FILTER	1	
3	308-463	HOSE ASS'Y D36	1	INCLUD.4.5
4	309-454	SLEEVE (B)	1	
5	309-453	SLEEVE (A)	1	
6	308-445	INTAKE VALVE	1	
7	308-446	INTAKE VALVE PACKING	1	
8		DESING LABEL	1	
9	308-447	TAPPING SCREW D3.5X19	13	
10	308-443	TANK ASS'Y	1	INCLUD.11
11	308-444	CLAMP	1	
12	308-451	EARTH CHAIN	1	
13	308-493	CHAIN WASHER	1	
14	308-452	BOLT M6X8	1	
15	308-442	TANK BASE	1	
16	308-450	BASE BELT	1	
17	308-448	CASTER WASHER	4	
18	308-449	CASTER	4	
19	308-441	TANK BASE ASS'Y	1	INCLUD.6,7,9,10,12 -- 18
20	308-432	TAPPING SCREW D4.8X19	1	
21	308-434	WASHER	1	
22	314-701	CORD CLAMP	1	
23	314-700	CORD	1	
24	314-707	TAPPING SCREW D3.5X13	1	
25	314-703	FUSE HOLDER	1	
26	314-706	SUPPORT HOLDER (A)	1	
27	308-439	SWITCH	1	
28	308-438	NOISE SUPPRESSOR	1	
29	314-705	INTERNAL WIRE	1	
30	314-704	FUSE (250V - 20A)	1	
31	308-435	INTERNAL WIRE	4	
32	314-702	PILLAR TERMINAL (4P)	1	
33		SWITCH LABEL	1	
34		NAME PLATE	1	
35	308-411	HANDLE CASE	1	
36	308-412	COVER PACKING	1	
37	308-413	SPONGE PACKING	3	
38	308-414	PACKING RING	2	
39	308-494	PLUG P.P	1	
40	308-415	MOTOR COVER	1	
41	308-416	PACKING	3	
42	308-417	BULKHEAD PACKING	1	
43	308-418	MOTOR PACKING (TOP)	1	
44	308-419	MOTOR PACKING (FAN)	2	
45	308-420	MOTOR SPONGE PACKING (A)	1	
46	999-048	CARBON BRUSH (1PAIR)	2	
47	314-699	MOTOR ASS'Y	1	INCLUD.46
48	308-422	MOTOR SPONGE PACKING (B)	1	
49	308-423	MOTOR SUPPORT	1	
50	308-425	TANK PACKING	1	
51	308-424	MOTOR FILTER	1	

* : ALTERNATIVE PARTS

PARTS

RP 30SA

ITEM NO.	CODE NO.	DESCRIPTION	NO. USED	REMARKS
52	308-426	FLOAT	1	
53	308-429	FLAT HD. TAPPING SCREW D3.5X16	3	
54	308-427	FLOAT HOLDER	1	

STANDARD ACCESSORIES

ITEM NO.	CODE NO.	DESCRIPTION	NO. USED	REMARKS
501	308-461	JOINT HANDLE	1	
502	309-455	EXTENSION PIPE D36	1	
503	314-710	PEDAL BRUSH ASS'Y	1	INCLUD.504
504	308-458	SHAFT	1	
505	308-459	NOZZLE FOR FLUID ASS'Y	1	INCLUD.506
506	308-460	RUBBER STRIP	2	
507	963-558	ADAPTER	1	
508	314-709	WET AND DRY FILTER	1	

OPTIONAL ACCESSORIES

ITEM NO.	CODE NO.	DESCRIPTION	NO. USED	REMARKS
601	308-466	BRUSH	1	
602	308-465	CREVICE NOZZLE	1	
603	308-464	UPHOLSTERY NOZZLE	1	
604	308-457	PEDAL BRUSH WITH WHEEL ASS'Y	1	INCLUD.605
605	308-458	SHAFT	1	
606	308-462	EXTENSION PIPE D36	2	
607	308-303	FILTER ASS'Y	1	INCLUD.602 - 604
608	308-467	CARTRIDGE FILTER	1	
609	308-468	FILTER BRACKET	1	
610	308-469	FILTER KNOB	1	
611	309-176	FILTER FOAM KILLER	1	
612	309-481	PAPER DUSTBAG SET (5 PCS.)	1	
613	990-912	DUST COLLECTOR (FOR IMPACT DRILL C)	1	
614	986-388	DUST COLLECTOR (FOR HAMMER B)	1	
615	306-054	DUST COLLECTOR	1	
616	300-082	CLEANER ADAPTER	1	
617	963-557	DUST COVER	1	
618	314-711	DUST COLLECTION ADAPTER (FOR D60)	1	
619	308-776	DUST COLLECTOR SET	1	INCLUD.620
620	308-774	ADAPTER (A)	1	
621	302-690	DUST COLLECTOR SET	1	
622	997-466	DUST COLLECTION ADAPTER SET	1	
623	303-377	DUST COLLECTOR SET	1	
624	309-451	HOSE ASS'Y D36X5M	1	INCLUD.626.627
625	309-452	HOSE ASS'Y D36X9M	1	INCLUD.626.627
626	309-453	SLEEVE (A)	1	
627	309-454	SLEEVE (B)	1	
628	309-679	HOSE ASS'Y D25X5M	1	INCLUD.629.630
629	309-680	SLEEVE (B)	1	
630	309-681	SLEEVE (A)	1	
631	308-470	HOSE BAND	1	

* : ALTERNATIVE PARTS