

ROLAIR

SCHMATIC FOR
PMP12K35

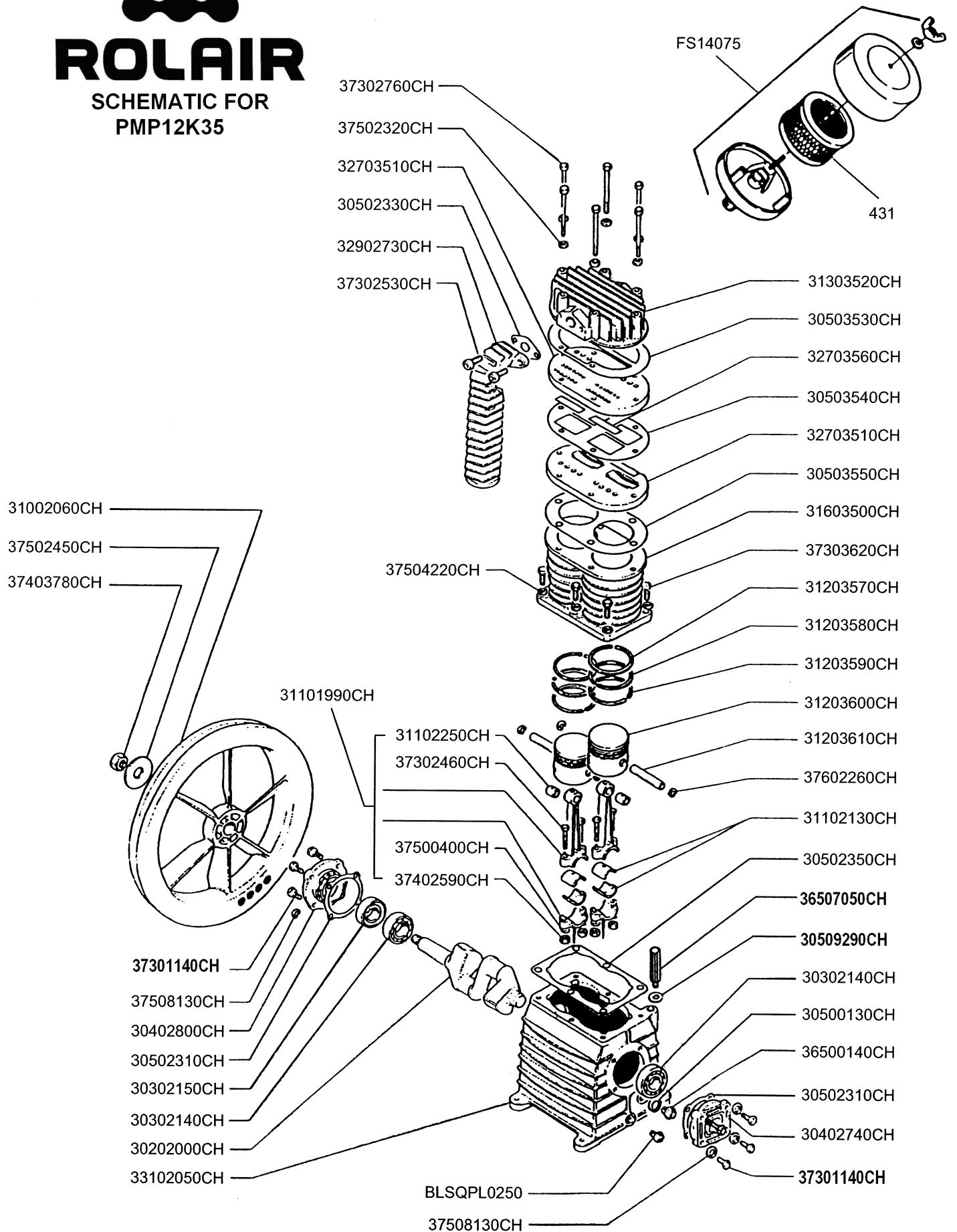

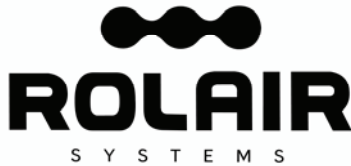

PARTS LIST FOR PMP12K35

Description	Part #	Qty.	Description	Part #	Qty.
Crankshaft	30202000CH	1	Valve Plate	32703510CH	2
Bearing	30302140CH	2	Valve	32703560CH	8
Oil Seal	30302150CH	1	Aftercooler	32902730CH	1
Bearing Carrier	30402740CH	1	Crankcase	33102050CH	1
Bearing Carrier	30402800CH	1	Sight Gauge	36500140CH	1
Gasket	30500130CH	1	3/8" Breather/Oil Fill	36507050CH	1
O-Ring	30509290CH	1	Plug		
Gasket	30502350CH	1	Bolt	37301140CH	8
Gasket	30502310CH	2	Bolt	37302460CH	4
Gasket*	30502330CH	1	Bolt	37302530CH	2
Gasket	30503530CH	1	Bolt	37302760CH	6
Gasket	30503540CH	1	Bolt	37303620CH	6
Gasket	30503550CH	1	Nut	37402590CH	4
Flywheel	31002060CH	1	Nut	37403780CH	1
Connecting Rod w/Upper	31101990CH		Washer	37508130CH	8
Bushing			Washer	37500400CH	4
Bearing Shell	31102130CH	2	Washer	37502320CH	6
Bushing	31102250CH	2	Washer	37502450CH	1
Ring	31203570CH	2	Washer	37504220CH	6
Ring	31203580CH	2	Snap Ring	37602260CH	4
Ring	31203590CH	2	Filter Element	431	1
Piston	31203600CH	2	Plug	BLSQPL0250	1
Piston Pin	31203610CH	2	Silencer/Filter Assembly	FS14075	1
Head	31303520CH	1	Ring Set	K35RINGS	1
Cylinder	31603500CH	1	Gasket Set	K35GASKETS	1
			Valve Plate Assembly	3500VK35	1

*Pumps produced after January 2005 use a 30502500CH O-Ring.

