

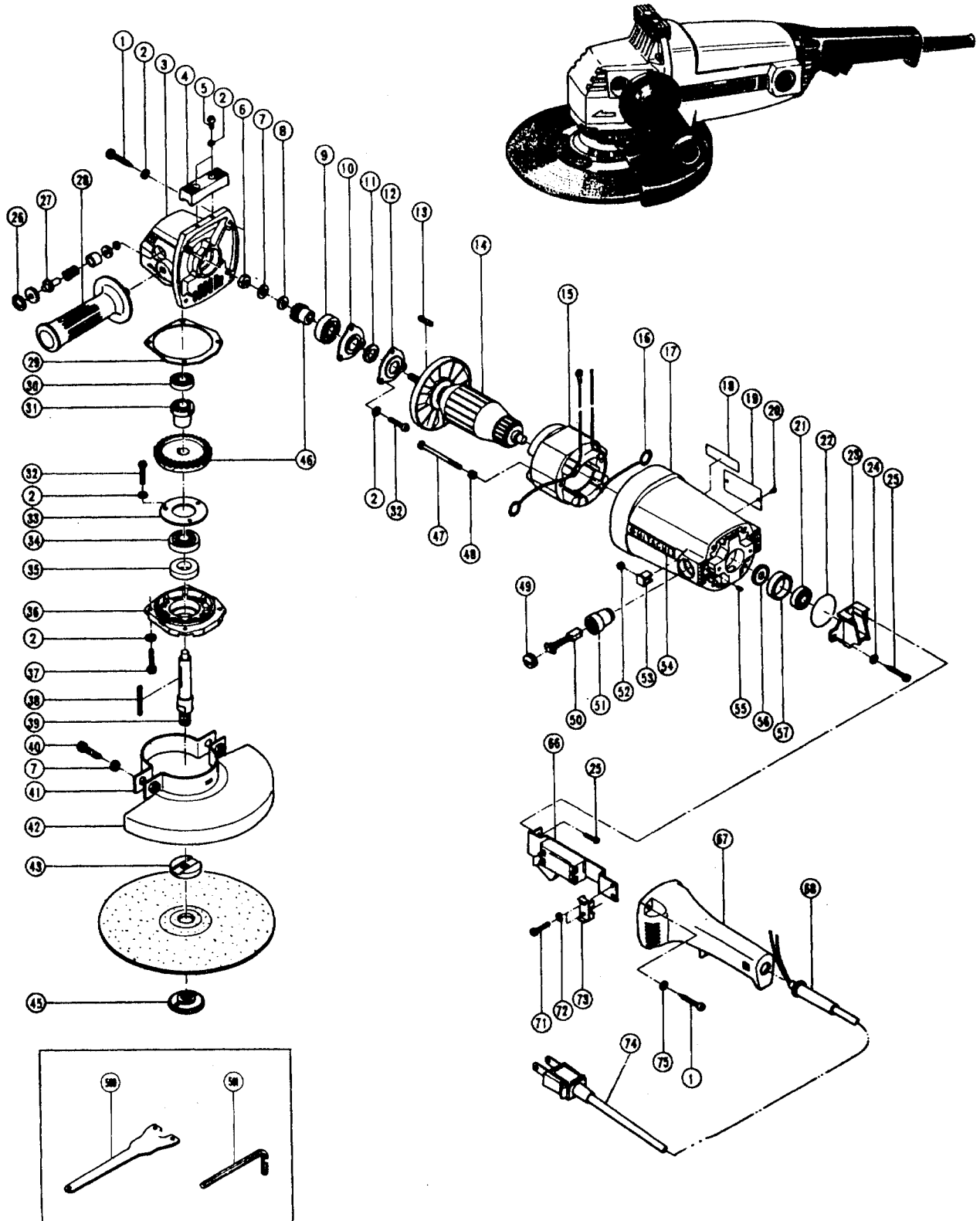

HITACHI

9" DISC GRINDER

Model PDL-230





HITACHI

9" DISC GRINDER

Model PDL-230

ITEM NO.	PART NO.	NO. USED	DESCRIPTION	SUPPLY QTY	ITEM NO.	PART NO.	NO. USED	DESCRIPTION	SUPPLY QTY
1	937807	8	Tapping Screw D5×25		36	937902	1	Packing Gland	
2	949454	16	Spring Washer M5	10	37	949238	4	Machine Screw M5×16	10
3	981680Z	1	Gear Cover Assembly (includes Item 4,5,26,27)		38	948920	1	Feather Key 4×4×30	
4	981681Z	1	Tool Rest		39	93102P	1	Spindle	
5	949237	2	Machine Screw M5×12	10	40	949656	2	Hexagon Socket Head Bolt M8×20	10
6	949568	1	Lock Nut M8	10	41	937911	1	Set Ring (A)	
7	949457	3	Spring Washer M8	10	42	937984Z	1	Wheel Guard	
8	937988	1	Pawl Washer M8		43	937922P	1	Wheel Washer	
9	6301VV	1	Ball Bearing 6301VVCMP2S		45	937923P	1	Wheel Nut	
10	937940	2	Distance Plate		46	937897	1	Gear	
11	936853	1	Felt Packing (A)		47	937925	2	Bolt M5×80	
12	937896	1	Bearing Cover (A)		48	956764	2	Special Washer	
13	940533	1	Feather Key 3×3×10		49	940540	2	Brush Cap	
14	937945C	1	Armature Assembly (includes Item 21, 56)		50	999044	2	Carbon Brush	2
15	981682D	1	Stator Assembly (includes Item 16)		51	937943Z	2	Carbon Brush Auto stop type	2
16	958032	1	Brush Terminal		52	980487	2	Brush Holder	
17	937890Z	1	Housing Assembly (includes Item 51, 55)		53	949555	2	Nut M5	10
18	937833Z	1	Caution Plate		54	937892	2	Nut Cover	
19	-	1	Name Plate		55	938098	1	HITACHI Label	
20	949510	2	Rivet D2.5×4.8	10	56	949385	2	Slotted Set Screw M4×5	10
21	6200VV	1	Ball Bearing 6200VVCMP2S		57	955260	1	Dust Seal (A)	
22	937946	1	Bearing Seal		58	937894	1	Bearing Bush	
23	937905	1	Bearing Cover		66 A	937921P	1	Switch till 7,1981	
24	949423	3	Washer M4	10	66 B	981685P	1	Switch AC / DC since 8,1981	
25	954004	1	Tapping Screw D4×16		67 A	937980Z	1	Handle (B) till 7,1981	
26	948011	1	Retaining Ring D16 hole		67 B	981686P	1	Handle (C) since 8,1981	
27	938094	1	Lock Pin		68	940778	1	Cord Armor D10.7	
28	937981Z	1	Side Handle		71	949218	2	Machine Screw M4X14	10
29	937901	1	Seal Packing (B)		72	949453	2	Spring Washer	10
30	6200VV	1	Ball Bearing 6200VVCMP2S		73	937904	1	Cord Clip	
31	938096	1	Sleeve		74	500242Z	1	Cord	
32	949236	6	Machine Screw M6×10	10	75	949424	4	Washer M5	10
33	937035	1	Bearing Cover (B)		500	937913Z	1	Wrench	
34	6302VV	1	Ball Bearing 6302VVCMP2S		501	872422	1	Hexagon Bar Wrench 6	
35	938099	1	Felt Packing (B)						