

Position	Amount	Type number	Description
1	1	1010712064	TRANSPORT PROTECTION KGS 305
2	1	1010712382	TURNTABLE KGS 305
3	1	1010712129	POINTER KGS 305
4	1	1010712161	GLIDE SEGMENT KGS 305
5	1	1010712145	Turntable for KGS 305
6	1	1010712390	TABLE SIDE EXTENSION KGS 305
7	1	1010712374	GUIDE PLATE KGS 305
8	1	1010712404	TABLE SIDE EXTENSION KGS 305
9	1	1010712153	RUBBER FOOT SET KGS 305
10	1	1010712358	DISC GUARD KGS 305 USA
11	1	1010712072	SWIVEL LEVER ASSEMBLY KGS 305
12	1	1010712080	FLANGE AND COUNTERFLANGE KGS 305 USA
13	1	1010712099	RETRACTABLE BLADE GUARD KGS 305
14	1	1010712056	Spring with guidance
15	1	1380712420	AUXILIARY FENCE KGS 305
16	1	1380712438	AUXILIARY FENCE KGS 305
17	1	1010712366	HARDWARE BAG KGS 305
18	1	1380712411	FENCE KGS 305
19	1	1010712048	POINTER KGS 305
20	1	1010712110	KERF PLATE KGS 305
21	1	1010712315	Stabilisator KGS 305
22	1	1010712137	FEED ROD KGS 305
23	1	1010712323	Pivot compl.,KGS305
24	1	1010712455	REPAIR KIT KGS 305
25	1	1010712307	SHIM PLATE KGS 305
26	1	1010712331	SWIVEL CASTING KGS 305
27	1	1010712340	Rastereinheit f.Kippsegment KGS 305
28	1	1010712170	MOTOR, CROSSCUT AND MITRE SAW KGS 305 U
29	1	1010712200	END CAP KGS 305
30	1	1010712196	CARBON BRUSH SET KGS 305 USA
31	1	1010712234	ARMATURE ASSEMBLY KGS 305 USA
32	1	1010712226	TRANSMISSION ASSEMBLY KGS 305
33	2	2391729746	PLUG-IN BUFFER KGS 305
34	1	1010712102	DUST EXTRACTION PORT KGS 305
35	1	1010712293	FENCE KGS 305
36	1	1010712218	LOCK KGS 305
39	1	7233712447	POLY-RIB BELT 8 PJ 584 KGS 305
41	1	1010712285	SWITCH ASSEMBLY KGS 305 USA
43	1	1010712277	HANDLE, PVC HOUSIN KGS 305
44	1	1010712269	BEARING BLOCK KGS 305
46	1	1010712250	TERMINAL BOX ASSEMBLY KGS 305 USA

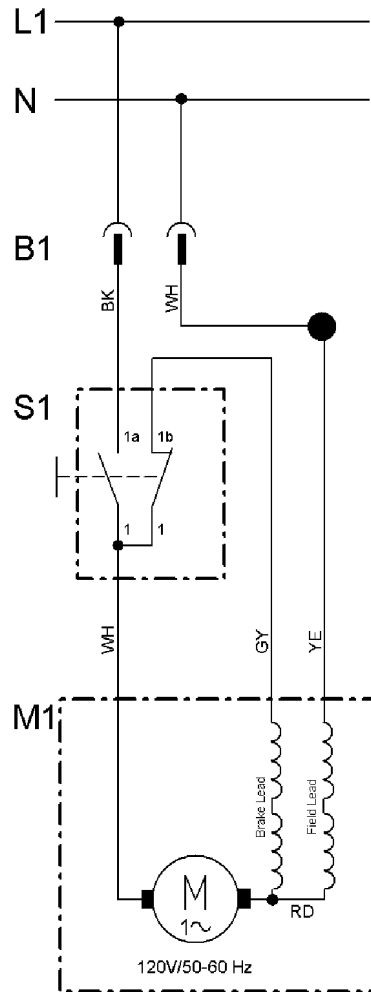

KGS 305
0103050042 11

47	1	1010712188	CABLE WITH PLUG KGS 305
48	1	1010712242	BELT GUARD KGS 305 USA
49	1	1010712978	TABLE KGS 305 USA
50	1	1010712986	BEVEL TILT SCAL KGS 305



	Colour of strands	Couleur des cordons	Colores de los cordones
BK	black	noir	negro
WH	white	blanc	blanco
BU	blue	bleu	azul
YE	yellow	jaune	amarillo
RD	red	rouge	rojo
TR	transparent	transparent	transparente
BN	brown	brun	marrón
GY	grey	gris	gris
GNYE	green-yellow	vert-jaune	verde-amarillo
BKWH	black-white	noir-blanc	negro-blanco
GN	green	vert	verde
OG	orange	orange	naranja
VT	violet	violet	violeta
TQ	turquoise	turquoise	turquesa

	Meaning of the symbols	Interprétation des symboles	Significado de las abreviaturas
B	plug	fiche	Clavija de enchufe
C	condensør	condensateur	Condensador
D	interference suppression inductance	inductance d'antiparasitage	Choque antiparasitario
E	electronic unit	unité électronique	Unidad electrónica
I	induction coil	bobine d'inductance	Bobina de inducción
K	terminal	borne	Borne
L	light	lumière	Luz
M	motor	moteur	Motor
O	overload cut-out	déclencheur de surintensité	Protección contra sobrecargas
R	reversing switch	commutateur droite-gauche	Commutador de inversión de marcha
S	switch	interrupteur	Interruptor
U	change-over switch	commutateur	Commutador
X	electronic element	élément électronique	Elemento electrónico