

# K46 BT

**Spare parts**

**Ersatzteile**

**Pièces détachées**

**Reserve onderdelen**

**Repuestos**

**Reservdelar**

ACTUAL PARTS  
 MAY NOT APPEAR  
 AS SHOWN

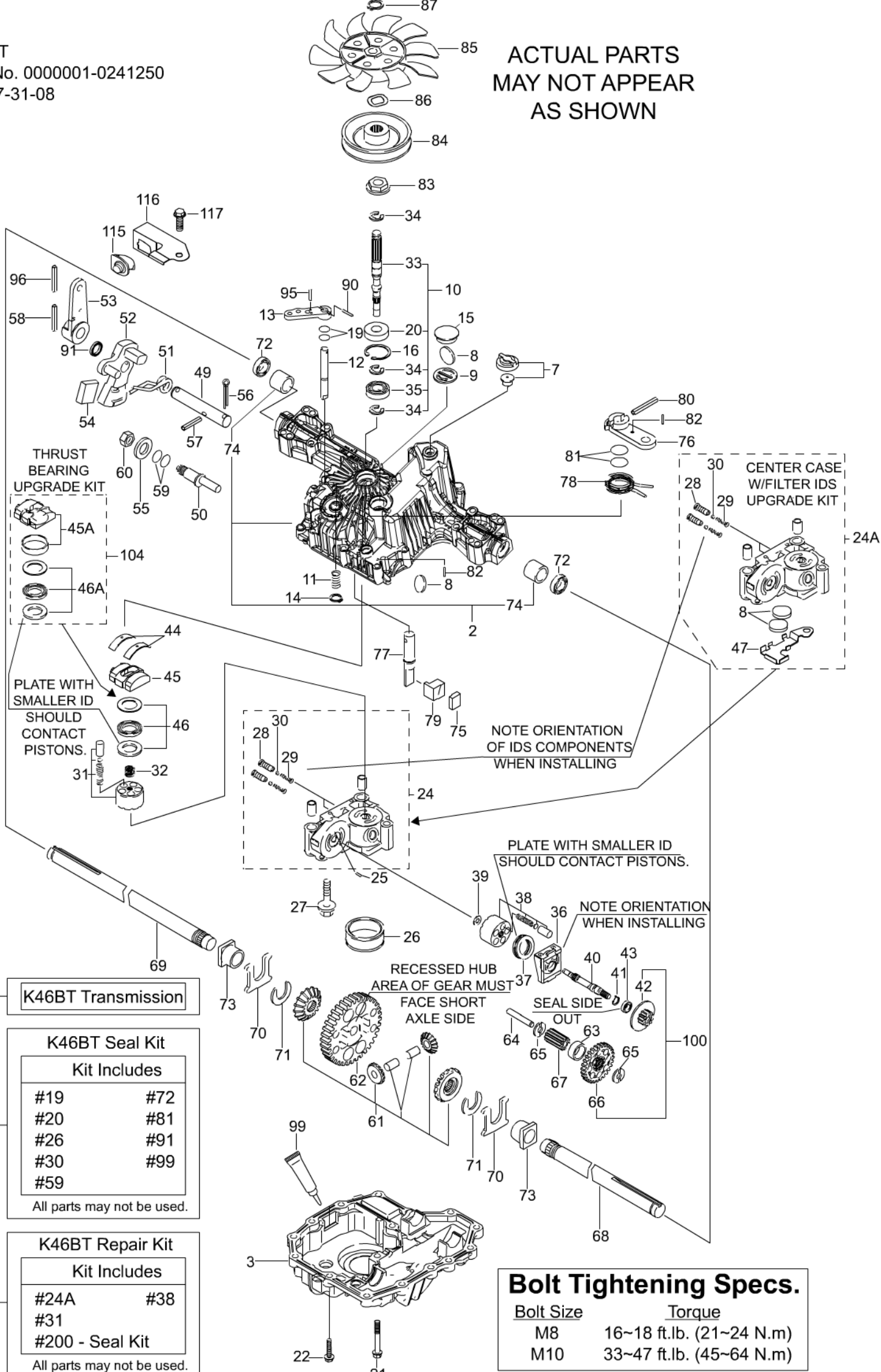

1 K46BT Transmission

200 K46BT Seal Kit  
 Kit Includes  
 #19 #72  
 #20 #81  
 #26 #91  
 #30 #99  
 #59  
 All parts may not be used.

201 K46BT Repair Kit  
 Kit Includes  
 #24A #38  
 #31  
 #200 - Seal Kit  
 All parts may not be used.

**Bolt Tightening Specs.**

| Bolt Size | Torque                   |
|-----------|--------------------------|
| M8        | 16~18 ft.lb. (21~24 N.m) |
| M10       | 33~47 ft.lb. (45~64 N.m) |

K46BT

K46BT 000001-0241250 - (K46BT-HOP / 7A646084180)

| KEY NO. | PART NO.     | DESCRIPTION                 | TUFF TORQ PART NO |
|---------|--------------|-----------------------------|-------------------|
| 1       | 505 56 35-01 | K46BT HUSQ TRANSAXL         | 7A646084180       |
| 2       | 505 56 36-01 | UPPER CASE                  | 1A646084421       |
| 3       | 505 56 37-01 | LOWER CASE                  | 1A646084300       |
| 7       | 505 56 38-01 | VENTVALVE                   | 19485924252       |
| 8       | 505 56 39-01 | MAGNET                      | 19216324360       |
| 9       | 502 45 20-01 | MAGNET HOLDER               | 1A646029000       |
| 11      | 502 46 01-01 | SPRING 25                   | 19215427281       |
| 12      | 505 56 40-01 | BYPASS SHAFT                | 1A646029510       |
| 13      | 535 40 28-17 | BYPASS LEVER                | 1A632029520       |
| 14      | 535 40 28-49 | SNAP RING 10                | 19216829570       |
| 15      | 535 40 28-32 | SEALING CAP 30              | 1C655036300       |
| 16      | 535 40 28-50 | SNAP RING C 35              | 22252000350       |
| 19      | 535 40 28-15 | O-RING 1A P10A              | 24311240100       |
| 20      | 502 46 23-01 | SEAL TC 153507              | 24421153507       |
| 21      | 535 40 28-51 | TAPPING SCREW 8 * 55        | 26476080552       |
| 22      | 535 40 28-28 | TAPPING SCREW 8 * 30        | 26476080302       |
| 24      | 505 56 41-01 | KIT CASE                    | 1A646099070       |
| 25      | 535 40 28-58 | PIN 3 * 9.8                 | 19216824760       |
| 26      | 535 40 28-59 | FILTER 105                  | 168T2025220       |
| 27      | 535 40 28-63 | BOLT 10 * 75                | 26106100752       |
| 28      | 505 56 43-01 | IDS VALVE                   | 1A646024800       |
| 29      | 535 40 28-61 | IDS SPRING                  | 1A646024761       |
| 30      | 535 40 28-62 | IDS FILTER 300              | 1A646024790       |
| 31      | 535 40 28-64 | CYLINDER BLOCK (PUMP) KIT   | 19216825111       |
| 32      | 535 40 28-69 | SPRING                      | 1A646025200       |
| 33      | 505 56 45-01 | PUMP SHAFT                  | 1A646025251       |
| 34      | 535 40 28-07 | E-RING 15                   | 19215485310       |
| 35      | 535 40 28-71 | BEARING 6202C3              | 24101062020       |
| 36      | 535 40 28-72 | MOTOR HOUSING               | 19216824210       |
| 37      | 535 40 28-73 | THRUST BEARING 51106        | 19216324240       |
| 38      | 535 40 28-74 | CYLINDER BLOCK KIT          | 187Q0025140       |
| 39      | 535 40 28-79 | WASHER 12 * 24 * 1          | 19216825230       |
| 40      | 502 45 17-01 | MOTOR SHAFT                 | 1A646025271       |
| 41      | 535 40 28-81 | SNAP RING S15               | 19215425310       |
| 42      | 502 45 18-01 | BRAKE DISC/MOTOR GEAR (11T) | 1A646025400       |
| 43      | 535 40 28-83 | BEARING 6202 RSR C3         | 168T2025280       |
| 44      | 535 40 28-84 | THRUST METAL                | 19216327051       |
| 45      | 502 45 52-01 | SWASH PLATE COMPLETE        | 168T2084700       |
| 46      | 502 45 31-01 | PUMP THRUST BEARING         | 1A646088150       |
| 49      | 502 45 22-01 | CONTROL SHAFT               | 1A646029911       |
| 50      | 502 45 23-01 | FULCRUM                     | 168T2029920       |
| 51      | 505 56 47-01 | TORSION SPRING HEAVY        | 168T2029800       |
| 52      | 535 41 49-51 | CONTROL ARM A               | 168T2029740       |
| 53      | 505 56 48-01 | CONTROL LEVER               | 1A646029400       |
| 54      | 535 40 28-91 | JERKY PLATE                 | 168T2029350       |

| KEY NO. | PART NO.       | DESCRIPTION                     | TUFF TORQ PART NO. |
|---------|----------------|---------------------------------|--------------------|
| 55      | 535 40 28-13   | WASHER 12                       | 22137120000        |
| 56      | 502 45 24-01   | COTTER PIN 1/8" * 3/4"          | 1A646029940        |
| 57      | 502 46 18-01   | SPRING PIN 6 * 36               | 22351060036        |
| 58      | 535 40 28-09   | ROLL PIN 6 * 40                 | 22351060040        |
| 59      | 535 40 28-14   | O-RING P14                      | 24311000140        |
| 60      | 506 95 66-01   | NUT 12                          | 26776120002        |
| 61      | 535 40 28-99   | DIFF GEAR KIT                   | 1A646031570        |
| 62      | 535 41 46-04   | FINAL GEAR (54T)                | 1A646033520        |
| 63      | 535 41 46-05   | FINAL PINION COLLAR             | 1A646033250        |
| 64      | 535 41 46-06   | REDUCTION SHAFT                 | 1A646088820        |
| 65      | 502 46 07-01   | WASHER 12 * 32 * 3.2            | 19216833420        |
| 66      | 502 45 26-01   | REDUCTION GEAR (37T)            | 1A646033450        |
| 67      | 502 45 27-01   | FINAL PINION GEAR (10T)         | 1A646033531        |
| 68      | 535 41 46-10   | AXLE SHAFT, LEFT                | 1A646034111        |
| 69      | 535 41 46-11   | AXLE SHAFT, RIGHT               | 1A646034121        |
| 70      | 535 41 46-12   | THRUST WASHER                   | 19216334261        |
| 71      | 535 41 46-13   | RING 17                         | 19216834270        |
| 72      | 535 40 28-37   | SEAL 19 * 32 * 8                | 19216334280        |
| 73      | 535 41 46-14   | BUSHING                         | 19216834350        |
| 74      | 535 40 28-43   | BUSHING 19.05                   | 168T2034240        |
| 75      | 535 41 46-16   | BRAKE SHOE                      | 1A646036121        |
| 76      | 535 40 28-38   | BRAKE LEVER                     | 1A646036160        |
| 77      | 535 41 46-17   | BRAKE SHAFT                     | 1A646036171        |
| 78      | 535 40 28-39   | BRAKE RETURN SPRING             | 168T2036180        |
| 79      | 535 41 46-18   | BRAKE ACTUATOR                  | 1A646036200        |
| 80      | 535 40 28-40   | SPRING PIN 5 * 32               | 22351050032        |
| 81      | 535 41 46-19   | O-RING 1A P12                   | 24311000120        |
| 82      | 535 40 28-41   | SPRING PIN 4 * 16               | 22351040016        |
| 83      | 506 98 66-01   | SPLINE COLLAR                   | 1A646025300        |
| 84      | 502 45 19-01   | PULLEY B                        | 1A646025810        |
| 85      | 506 98 68-01   | FAN, BLACK                      | 1A646083070        |
| 86      | 506 98 65-01   | WAVE WASHER                     | 1A646083060        |
| 87      | 735 31 15-00   | SNAP RING                       | 19215489090        |
| 90      | 535 40 28-16   | SPRING PIN 3.0A * 20            | 22351030020        |
| 91      | 535 40 28-46   | OIL SEAL 16 * 22 * 03           | 1A646024440        |
| 95      | 535 40 28-33   | SPRING PIN 3.0A * 16            | 22351030016        |
| 96      | 505 56 50-01   | ROLL PIN 3.                     | 22351035040        |
| 99      | Included # 200 | SEALANT                         | 1A646099500        |
| 115     | 505 56 51-01   | SWITCH                          | 1A632086550        |
| 116     | 505 56 52-01   | SWITCH BRACKET                  | 1A646083250        |
| 117     | 505 56 54-01   | SCREW 8 * 20                    | 26476080202        |
| 118     | 532 40 33-19   | BELT KEEPER                     | 1A646083300        |
| 119     | 505 56 58-01   | SCREW                           | 26476080162        |
| 200     | 502 45 33-01   | K46 & T40 SEAL KIT (ALL MODELS) | 1A646099140        |
| 201     | 502 45 35-01   | REPAIR KIT K46                  | 1A646099600        |