

JIG SAW

JS-60, JSE-60

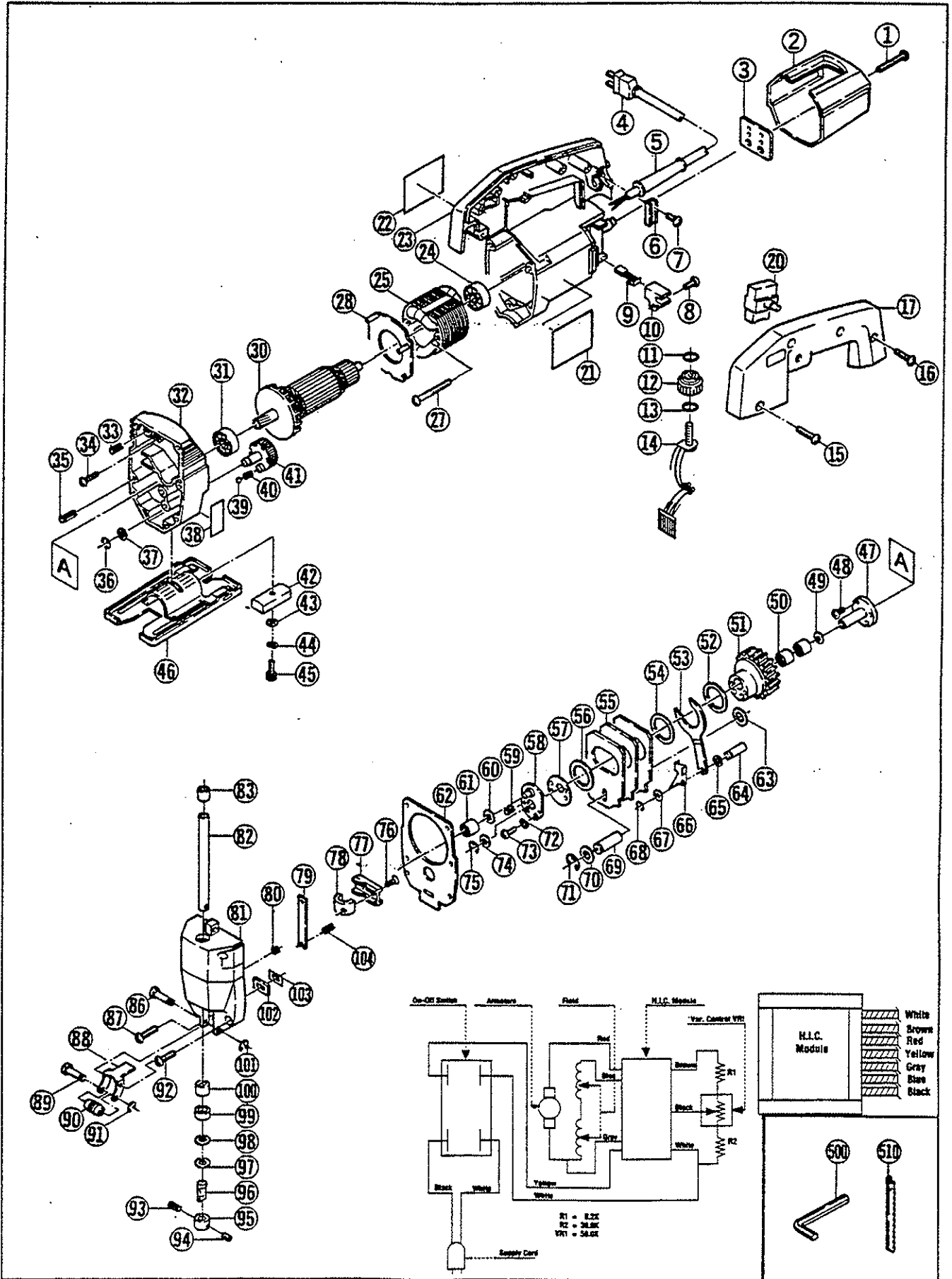

PARTS LIST FOR AFTER SALES SERVICE MODEL JS60, JSE60

PART NO.	DESCRIPTION	MODEL	QTY	REF	PART NO.	DESCRIPTION	MODEL	QTY
1	9060430	TAPPING SCREW (B) M4X30		1 58	6080054	CRANK PLATE		
2	6802370	TAIL COVER		1 59	9403008	SPRING PIN		1
3	6370025	WRENCH SUPPORTER		1 60	6900103	WASHER		2
4	6520331	CORD ASS'Y AWG#18X2X2		1 61	6750011	NEEDLE BEARING		1
5	6560131	CORD HOLDER		1 62	6930012	PACKING		1
6	6560057	CORD CLAMP		1 63	6900102	WASHER		1
7	9060414	TAPPING SCREW (B) M4X14		4 64	6120058	GUIDE PIN		1
8	9060414	TAPPING SCREW (B) M4X14		2 65	6900102	WASHER		2
9	6540173	CARBON BRUSH SET		1 66	6150221	FORK		1
10	6570016	BRUSH HOLDER		2 67	6900102	WASHER		1
11	9760016	O-RING P-16	JSE60	1 68	9500400	RETAINING RING E-4		1
12	6832053	DIAL		1 69	6120058	GUIDE PIN		1
13	9760016	O-RING P-16	JSE60	1 70	6900102	WASHER		1
14	6430019	SPEED CNTRL CIRCUIT MOD.	JSE60	1 71	9500400	RETAINING RING E-4		1
15	9060540	TAPPING SCREW (B) M5X40		1 72	9550400	SPRING WASHER M4		2
16	9060420	TAPPING SCREW (B) M4X20		3 73	6130142	PHILLIPS PAN SCREW M4X14		2
17	6832056	HANDLE COVER	JS60	1 74	6900104	WASHER		2
---	6832057	HANDLE COVER	JSE60	1 75	9500700	RETAINING RING E-7		1
20	6550225	TRIGGER SWITCH		1 76	9140410	PHILLIPS FLAT SCREW M4X10		2
21	6920161	"RYOBI" MARK	JS60	1 77	6220008	SPINDLE HOLDER		1
---	6920162	"RYOBI" MARK	JSE60	1 78	6220009	BRACKET		1
22	6910399	NAME PLATE	JS60	1 79	6150215	SPINDLE GUIDE		2
---	6910385	NAME PLATE	JSE60	1 80	6180031	COMPRESSION SPRING		4
23	6802373	MOTOR HOUSING		1 81	6820132	GEAR CASE COVER		1
24	9840627	BALL BEARING #627LLB		1 82	6100034	SPINDLE		1
25	6500221	FIELD COIL		1 83	6760028	OILLESS METAL		1
2	960450	TAPPING SCREW (B) M4X50		2 86	6120060	ROLLER PIN		1
28	490047	FAN CASING		1 87	9060530	TAPPING SCREW (B) M5X30		1
30	6030243	ARMATURE		1 88	6150209	ROLLER HOLDER		1
31	622274001	BALL BEARING #608LLB		1 89	6120059	ROLLER PIN		1
32	6820129	GEAR CASE		1 90	6220007	ROLLER		1
33	9405025	SPRING PIN		2 91	9500300	RETAINING RING E-3		1
34	9060520	TAPPING SCREW (B) M5X20		2 92	9040425	TAPPING SCREW (S) M4X25		4
35	9403008	SPRING PIN		2 93	9402506	SPRING PIN		1
36	9500600	RETAINING RING E-6		1 94	9280508	CLAMP SCREW		1
37	6900284	THRUST WASHER		1 95	6220006	BLADE HOLDER		1
38	6920164	SELECTION LABEL		1 96	6220004	HOLDER PLATE		1
39	6290055	STEEL BALL 5/32"		1 97	6900108	WASHER		1
40	6180032	COMPRESSION SPRING		1 98	6900106	WASHER		1
41	6360477	ORBITAL DIAL		1 99	6900107	FELT		1
42	6320020	BASE PLATE HOLDER		1 100	6760027	OILLESS METAL		1
43	9570500	WASHER		1 101	9500300	RETAINING RING E-3		1
44	9550500	SPRING WASHER		2 102	6390012	FELT		1
45	9220520	HEX SKT HEAD BOLT M5X20		1 103	6150206	DUST PLATE		1
46	6010038	BASE PLATE		1 104	9403020	SPRING PIN		4
47	6110036	GEAR SHAFT		1 --	6530134	TIGHTENING BAND		1
48	9040410	TAPPING SCREW (S) M4X10		4 --	6530209	FASTEN CONNECTOR	JS60	2
49	6900109	WASHER		1 --	6530211	SLEEVE COVER	JS60	2
50	6750026	NEEDLE BEARING		2 --	6560002	CONNECTOR		2
51	6200032	FINAL GEAR		1 --	9674320	LEAD WIRE	JS60	1
52	6900110	WASHER		1				
53	6150218	FORK		1				
54	6900110	WASHER		1				
55	50203	BALANCING WEIGHT		3 500	6241143	2.5" HEX KEY WRENCH		1
56	.00110	WASHER		1 --	6241083	4" HEX KEY WRENCH		1
57	6900111	WASHER		1 510	968914001	JIG SAW BLADE SET		1