

ROUTER

6302
6702
6902
513T6/T7

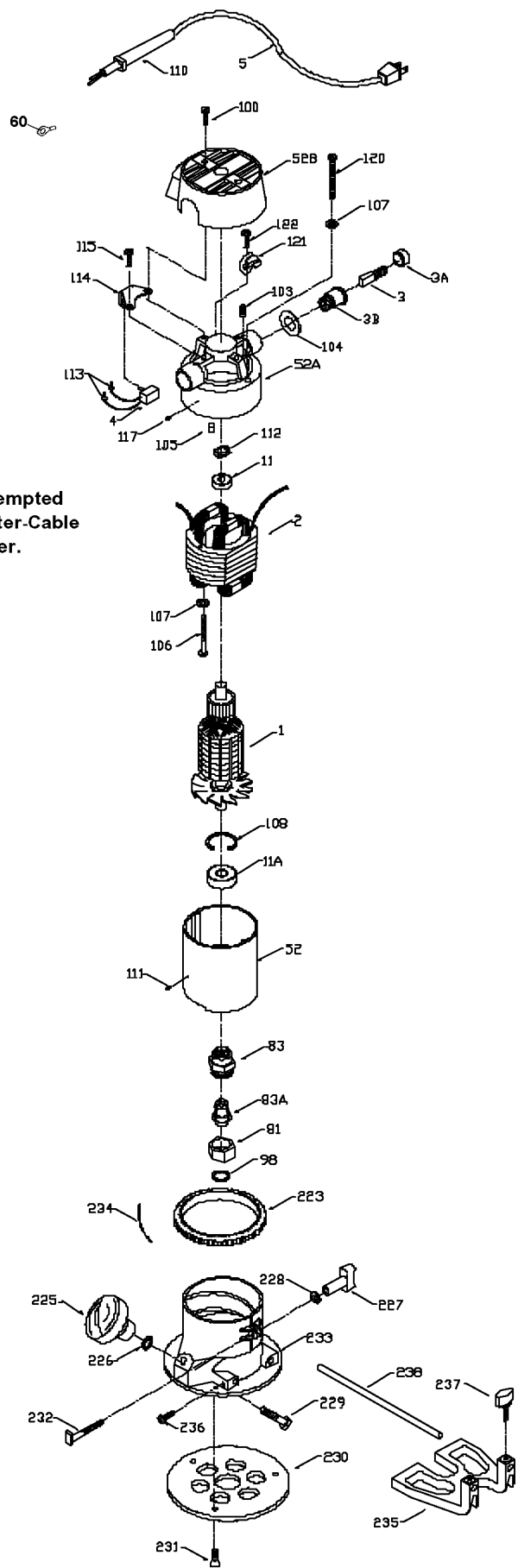

WARNING: Electrical repairs should only be attempted by trained repairmen. Contact the nearest Porter-Cable Service Center or other competent repair center.

Parts List for J-630 Type ALL TYPES

| Item Number | Part Number | Description | Qty Required |
|-------------|-------------|---------------------|--------------|
| 1 | 874588 | ARMATURE-220 | 1 |
| 1 | 903660 | ARMATURE | 1 |
| 1 | 000000-00 | No Longer Available | 1 |
| 1 | 683459 | ARMATURE 115V | 1 |
| 1 | 000000-00 | No Longer Available | 1 |
| 1 | 682058 | ARMATURE 115V | 1 |
| 1 | 000000-00 | No Longer Available | 1 |
| 1 | 000000-00 | No Longer Available | 1 |
| 1 | 874299 | FAN | 1 |
| 1 | 000000-00 | No Longer Available | 1 |
| 2 | 874589 | FIELD-220 | 1 |
| 2 | 000000-00 | No Longer Available | 1 |
| 2 | 000000-00 | No Longer Available | 1 |
| 2 | 000000-00 | No Longer Available | 1 |
| 2 | 694210 | FIELD | 1 |
| 2 | 699326 | FIELD | 1 |
| 2 | 803104 | LEAD | 1 |
| 3 | N031652 | BRUSH | 2 |
| 3 | 803483 | BRUSH CAP | 2 |
| 3 | 873497 | BRUSH HOLDER | 2 |
| 4 | 842606SV | SWITCH | 1 |
| 4 | 876320 | SWITCH. | 1 |
| 5 | 879758 | CORD-EURO | 1 |
| 5 | A11126 | CORDSET | 1 |
| 5 | 879182 | CORD | 1 |
| 11 | 855284 | BEARING | 3 |
| 11 | 878064SV | BEARING | 3 |

Parts List for J-630 Type ALL TYPES

| Item Number | Part Number | Description | Qty Required |
|-------------|-------------|----------------------|--------------|
| 11 | 858464 | BEARING | 3 |
| 52 | 904663 | CASE-FRONT | 1 |
| 52 | 903967SV | CASING & PINS FRONT | 1 |
| 52 | 899192SV | REAR HOUSING | 1 |
| 52 | 888727 | MOTOR HOUSING CAP | 1 |
| 60 | 849314 | TERM | 1 |
| 81 | 875893 | COLLET NUT | 1 |
| 83 | 872793 | CHUCK | 1 |
| 83 | 42999 | 1/4 INCH COLLET ASSY | 1 |
| 83 | 42975 | 3/8 INCH COLLET ASSY | 1 |
| 83 | 42975 | 3/8 INCH COLLET ASSY | 1 |
| 83 | 42950 | 1/2 INCH COLLET ASSY | 1 |
| 83 | 876669 | COLLET 1/4 INCH | 1 |
| 83 | 876670 | COLLET 3/8 INCH | 1 |
| 83 | 876671 | COLLET 1/2 INCH | 1 |
| 98 | 823030 | SNAP-RING | 10 |
| 100 | 878813 | SCREW | 10 |
| 103 | 804360 | SCREW | 10 |
| 103 | 803632 | SET-SCREW | 10 |
| 104 | 803496 | WASHER | 10 |
| 105 | 842597 | PLUG | 1 |
| 106 | 863393 | SCREW | 10 |
| 106 | 681260 | SCREW & WASHER | 10 |
| 106 | 881082 | SCREW MACHINE STEEL | 10 |
| 106 | 838312 | SCREW | 10 |
| 107 | 802430 | LOCKWASHER | 10 |
| 108 | 802426 | RING | 10 |

Parts List for J-630 Type ALL TYPES

| Item Number | Part Number | Description | Qty Required |
|-------------|-------------|-------------------|--------------|
| 110 | 901266 | STRAIN RELIEVER | 1 |
| 111 | 800835 | PIN | 10 |
| 112 | 842610 | SPRING-PRELOAD | 10 |
| 113 | 682063 | CONNECTOR VS | 1 |
| 114 | 876396 | BRACKET | 1 |
| 114 | 842598 | BRACKET SWITCH | 1 |
| 115 | 802764 | SCREW | 10 |
| 117 | 801374 | SCREW | 10 |
| 120 | 681260 | SCREW & WASHER | 10 |
| 121 | 874137 | CORD CLAMP | 1 |
| 122 | 877817 | SCREW | 10 |
| 223 | 872998 | DEPTH RING | 1 |
| 225 | 803674 | KNOB | 1 |
| 225 | 800995 | BASE KNOB | 1 |
| 226 | 801821 | WASHER | 10 |
| 227 | 874582 | CLAMP KNOB | 1 |
| 228 | 823374 | WASHER | 10 |
| 229 | 802306 | HEX HEAD SCREW | 1 |
| 230 | 875807 | SUB BASE | 1 |
| 230 | 42186 | ROUTER SUB-BASE | 1 |
| 231 | 874117 | SCREW | 10 |
| 231 | 688860 | SCREW | 10 |
| 232 | 685526 | SCREW | 10 |
| 233 | 5140096-05 | SUB BASE | 1 |
| 233 | 886264 | BASE HOUSING | 1 |
| 234 | 800869 | SPRING | 3 |
| 235 | 42160 | ROUTER EDGE GUIDE | 1 |

Parts List for J-630 Type ALL TYPES

| Item Number | Part Number | Description | Qty Required |
|-------------|-------------|---------------------|--------------|
| 236 | 803160 | SCREW | 10 |
| 237 | 882810 | KNOB | 1 |
| 238 | 824588 | ROD GUIDE | 1 |
| 238 | 824588 | ROD GUIDE | 1 |
| 239 | 849314 | TERM | 1 |
| 240 | 695474 | CUTTER SHAFT ASSY | 1 |
| 241 | 696696 | SCREW | 10 |
| 856 | A22709 | OPEN-END WRENCH | 1 |
| 856 | 883356 | BIT | 1 |
| 856 | A22709 | OPEN-END WRENCH | 1 |
| 856 | 683157 | WRENCH OPEN END | 1 |
| 856 | 683157 | WRENCH OPEN END | 1 |
| 861 | 000000-00 | No Longer Available | 1 |
| 861 | 000000-00 | No Longer Available | 1 |
| 861 | 902829 | CARRYING CASE | 1 |
| 861 | 000000-00 | No Longer Available | 1 |