

Percussion Drill - 0 601 141 656 - HD6876 TYPE 1

| Item | Part Number | Description | Illustration | Price | Quantity | Price Group |
|------|---------------|--|--------------|-------|----------|-------------|
| 1 | 2 605 104 450 | Housing Section GRAY | 1 | -,- | 1 | - |
| 2 | 2 604 220 439 | Field 110-115V | 1 | -,- | 1 | 31 |
| 3 | 2 604 010 860 | Armature 115-120V | 1 | -,- | 1 | 40 |
| 3/60 | 2 606 610 029 | Fan | 1 | -,- | 1 | 11 |
| 4 | 2 607 200 332 | On-Off Switch | 1 | -,- | 1 | 37 |
| 5 | 2 604 460 188 | Power supply cord USA/CDN 2,68m 2 x 0,82mm SJ 18/2 | 1 | -,- | 1 | 26 |
| 6 | 2 600 707 059 | Grommet Ø6,9 MM | 1 | -,- | 1 | 13 |
| 6 | 2 600 707 060 | Grommet Ø11,6-Ø12,5x84 MM | 1 | -,- | 1 | 13 |
| 6 | 2 600 707 061 | Grommet Ø8,8 MM | 1 | -,- | 1 | 11 |
| 7 | 2 601 035 001 | Cable Clip | 1 | -,- | 1 | 11 |
| 9 | 2 601 118 493 | Manufacturer's nameplate SUNNY SIDE | 1 | -,- | 1 | 13 |
| 16 | 2 609 992 627 | Brush Plate | 1 | -,- | 1 | 26 |
| 18 | 2 603 410 001 | Socket head cap screw M3x6,5-4.8 | 1 | -,- | 2 | 11 |
| 19 | 2 910 611 019 | Tapping Screw DIN 7981-ST3,9x16-C-H | 1 | -,- | 2 | 13 |
| 20 | 2 601 118 494 | Reference Plate SHADOW SIDE | 1 | -,- | 1 | 13 |
| 25 | 2 603 490 019 | Torx Oval-Head Screw 3x30 | 1 | -,- | 2 | 10 |
| 27 | 2 603 490 018 | Torx Oval-Head Screw 3x18 | 1 | -,- | 4 | 10 |
| 28 | 2 603 429 005 | Socket head cap screw | 1 | -,- | 2 | 11 |
| 29 | 2 601 022 000 | Damping Plate | 1 | -,- | 1 | 11 |
| 30 | 2 606 135 044 | Drilling Spindle 1/2", SW 17 INT. LEFTH. THREAD | 1 | -,- | 1 | 28 |
| 31 | 2 600 118 001 | Locking Washer 0,6 MM | 1 | -,- | 2 | 11 |
| 31 | 2 600 118 002 | Locking Washer 0,8 MM | 1 | -,- | 1 | 11 |
| 31 | 2 600 118 006 | Locking Washer 0,3 MM | 1 | -,- | 1 | 11 |
| 32 | 2 604 616 002 | Compression Spring | 1 | -,- | 1 | 11 |
| 33 | 1 900 905 163 | Deep-Groove Ball Bearing 17x35x10 | 1 | -,- | 1 | 23 |
| 34 | 2 606 317 045 | Cylindrical Gear Z=48 | 1 | -,- | 1 | 27 |
| 35 | 2 606 317 037 | Cylindrical Gear Z=36 | 1 | -,- | 1 | 30 |
| 36 | 2 600 101 515 | Shim 1,0 MM | 1 | -,- | 2 | 12 |
| 37 | 2 916 650 006 | Spring retaining ring DIN 471-15x1-FSt | 1 | -,- | 1 | 11 |
| 39 | 2 600 101 671 | Retaining Washer | 1 | -,- | 1 | 11 |
| 40 | 2 602 300 028 | Flat Key | 1 | -,- | 2 | 15 |
| 42 | 2 600 190 052 | Catch Disk | 1 | -,- | 1 | 21 |

| Item | Part Number | Description | Illustration | Price | Quantity | Price Group |
|--------|---------------|--|--------------|-------|----------|-------------|
| 44 | 1 903 230 010 | Ball DIN 5401-5,5MM-III-ST | 1 | -,- | 1 | 10 |
| 45 | 2 601 990 001 | Indexing Disk BLACK | 1 | -,- | 1 | 11 |
| 46 | 2 601 074 003 | Pressure Plate | 1 | -,- | 1 | 11 |
| 52 | 2 600 100 607 | Shim 0,3 MM | 1 | -,- | 2 | 11 |
| 53 | 2 600 914 010 | Needle bearing Ø6 MM | 1 | -,- | 2 | 14 |
| 54 | 2 600 400 027 | Bearing Sleeve | 1 | -,- | 1 | 16 |
| 56 | 2 602 033 005 | Control Fork | 1 | -,- | 1 | 11 |
| 57 | 2 602 026 091 | Rotary Head | 1 | -,- | 1 | 17 |
| 58 | 2 600 590 006 | Ratchet Cap | 1 | -,- | 1 | 11 |
| 62 | 2 601 335 001 | Driver Pin | 1 | -,- | 1 | 12 |
| 64 | 2 600 100 618 | Shim washer | 1 | -,- | 1 | 11 |
| 67 | 2 600 190 057 | Catch Disk | 1 | -,- | 1 | 23 |
| 69 | 2 600 108 000 | Felt Disc | 1 | -,- | 1 | 11 |
| 70 | 2 600 500 014 | Cupped Washer | 1 | -,- | 1 | 11 |
| 71 | 1 900 210 117 | O-Ring 18x3 MM | 1 | -,- | 1 | 15 |
| 72 | 2 916 660 008 | Spring retaining ring DIN 472-24x1,2 MM | 1 | -,- | 1 | 11 |
| 73 | 2 600 400 008 | Receptacle | 1 | -,- | 1 | 11 |
| 75 | 1 900 210 000 | O-Ring 5,0x1,5 MM | 1 | -,- | 2 | 11 |
| 76 | 2 601 005 011 | Felt Strip | 1 | -,- | 1 | 11 |
| 77 | 2 601 005 016 | Felt Strip | 1 | -,- | 1 | 11 |
| 82 | 2 603 421 208 | Countersunk-Head Screw M6x38/12(Ø11) LEFTHAND THREADS | 1 | -,- | 1 | 11 |
| 82 | 2 603 421 209 | Countersunk-Head Screw M6x31 MM LEFTHAND THREADS | 1 | -,- | 1 | 11 |
| 86 | 2 601 110 580 | Sticker | 1 | -,- | 1 | 11 |
| 89 | 2 604 448 147 | Connecting Cable L=85 MM WHITE | 1 | -,- | 1 | 11 |
| 90 | 2 604 448 060 | Cable L=173 MM WHITE | 1 | -,- | 1 | 13 |
| 91 | 2 604 448 045 | Cable L=98 MM BLACK | 1 | -,- | 1 | 11 |
| 92 | 2 604 448 034 | Connecting Cable L=88 MM WHITE | 1 | -,- | 1 | 11 |
| 93 | 2 604 448 132 | Connecting Cable L=103 MM BLUE | 1 | -,- | 1 | 11 |
| 94 | 2 604 448 115 | Connecting Cable L=73 MM WHITE | 1 | -,- | 2 | 11 |
| 653 | 2 602 025 057 | Auxiliary Handle BLACK | 1 | -,- | 1 | 25 |
| 653/20 | 2 911 001 211 | Hex Screw M6x45 DIN 931-8.8 | N/A | -,- | 1 | 11 |
| 653/30 | 2 915 191 006 | Wing Nut M6 DIN 315-G-GTW-40 | N/A | -,- | 1 | 11 |
| 654 | 2 603 101 025 | Depth-Gauge | 1 | -,- | 1 | 12 |
| 655 | 2 600 510 004 | Capsule | 1 | -,- | 1 | 11 |
| 780 | 1 608 571 069 | Chuck Ø1,5-13 MM, 1/2" | 1 | -,- | 1 | 32 |
| 780/1 | 2 608 572 034 | Keyless Chuck Ø 2-13 MM,1/2" | 1 | -,- | 1 | - |
| 780/7 | 2 607 950 007 | Chuck Wrench SG2 | 1 | -,- | 1 | 18 |
| 808 | 1 601 106 032 | Nameplate 26x52 MM | 1 | -,- | 1 | 13 |
| 813 | 2 600 917 902 | Needle bearing | 1 | -,- | 1 | 20 |
| 814 | 2 600 905 039 | Deep-Groove Ball Bearing 9x24x7 | N/A | -,- | 1 | 24 |
| 816/04 | 2 604 321 916 | Carbon-Brush Set | 1 | -,- | 1 | 19 |
| 816/06 | 2 601 329 051 | Ratchet Cap | 1 | -,- | 2 | 11 |
| 822 | 2 607 200 231 | Change-Over Switch | 1 | -,- | 1 | 25 |
| 823 | 2 912 401 020 | Tapping Screw DIN 7981-3,9x19-C-Z-ST | N/A | -,- | 9 | 10 |
| 849 | 2 606 309 913 | Toothed Shaft Z= 10/29/22 | 1 | -,- | 1 | 31 |
| 863 | 2 916 080 007 | Locking Washer DIN 6799-4-FSt | 1 | -,- | 1 | 10 |
| 866 | 2 605 807 928 | Bearing Bracket | 1 | -,- | 1 | 31 |

Illustration - Type E

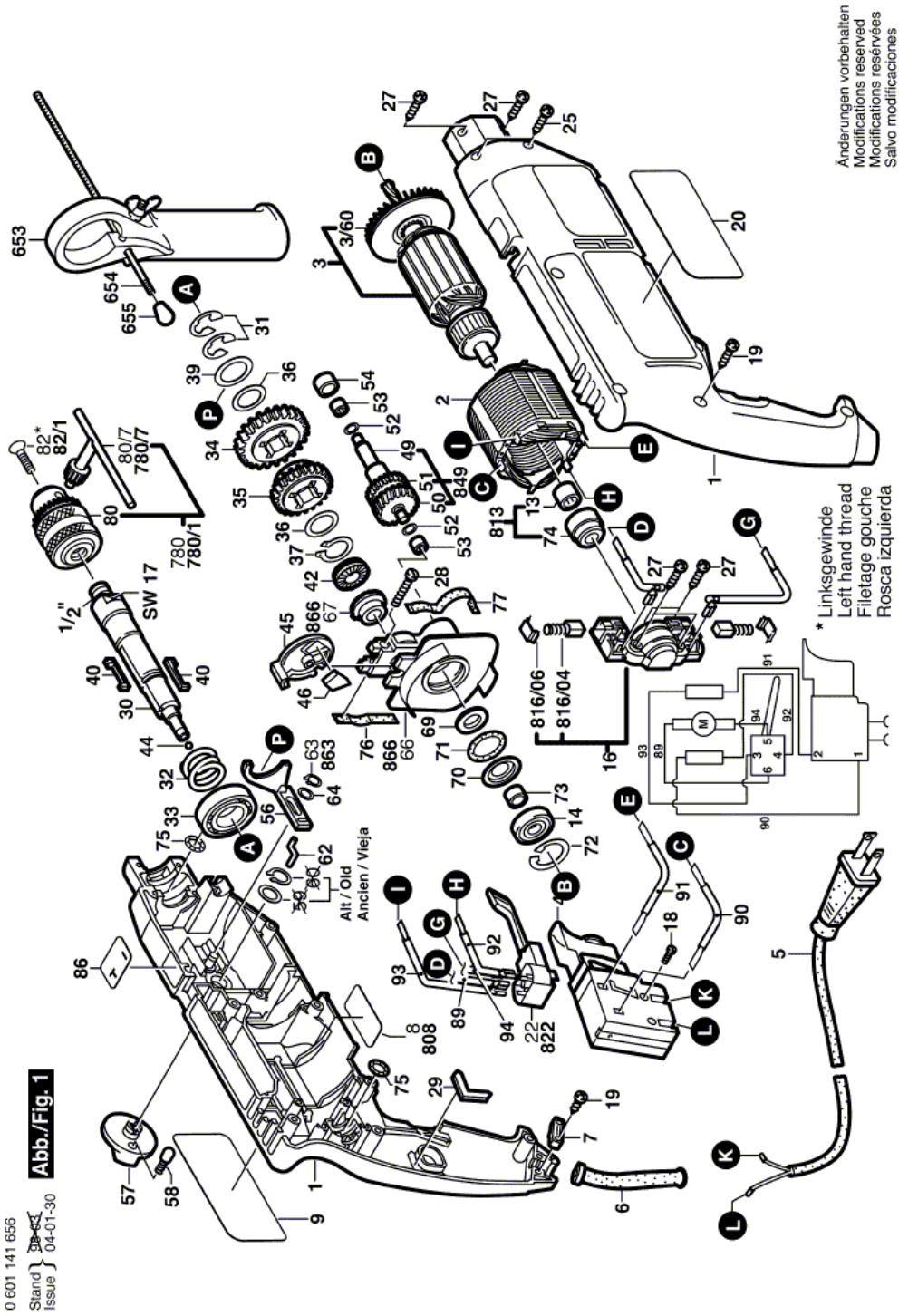

Information subject to change without further notice.