

3 SCREW ON HAND TIGHT

2  
 33  
 5  
 7  
 6 LUBE WITH LIGHT OIL OR SOAP  
 PRIOR TO INSTALLATION  
 7 LUBE WITH LIGHT OIL OR SOAP  
 PRIOR TO INSTALLATION

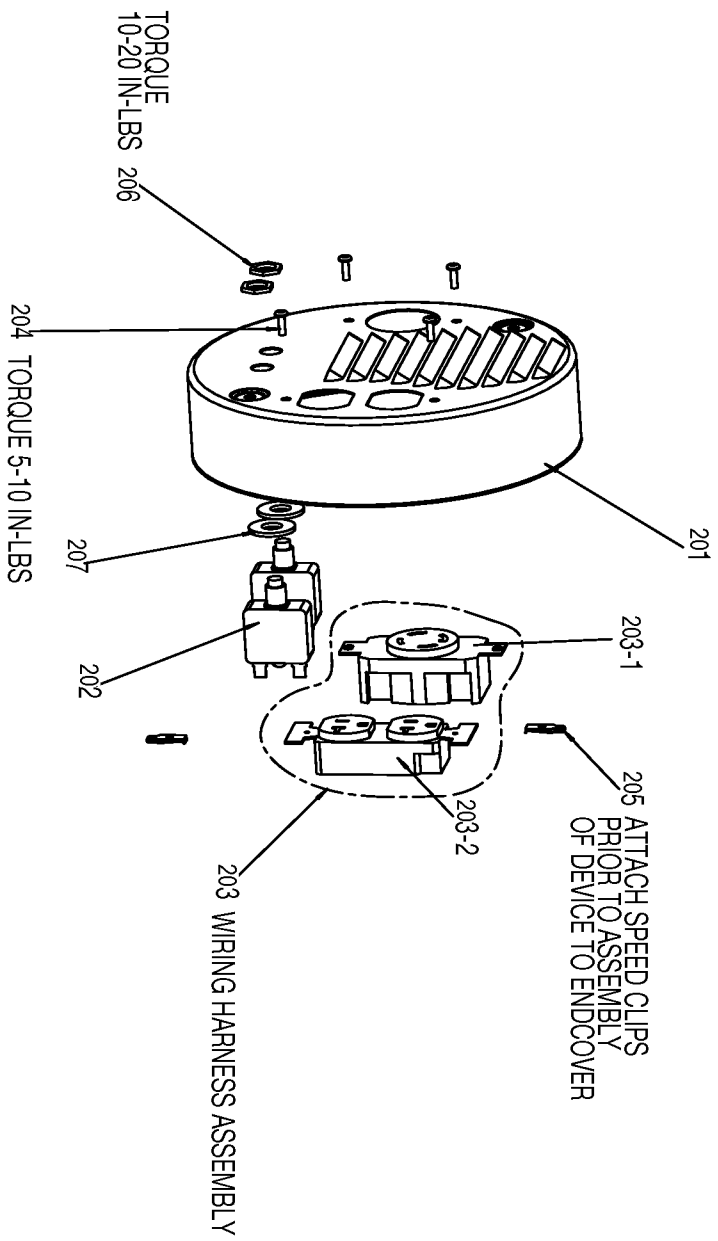

## Parts List for GT5251 Type 1

| Item Number | Part Number | Description          | Qty Required |
|-------------|-------------|----------------------|--------------|
| 1           | 91895680    | SCREW .250-20X.750 H | 1            |
| 2           | Z-GS-0795   | TANK FUEL 7G SS      | 1            |
| 3           | GS-0443     | CAP FUEL TANK        | 1            |
| 4           | Z-A14582    | HOSE FUEL            | 1            |
| 5           | GS-0227     | CLAMP FUEL .50       | 1            |
| 6           | N103455     | GROMMET              | 1            |
| 7           | GS-0437     | DRAIN COCK           | 1            |
| 8           | 000000-00   | No Longer Available  | 1            |
| 8           | GS-0872     | RESISTOR 10K OHM     | 2            |
| 8           | GS-0871     | DIODE 10AMP 1000V    | 2            |
| 10          | SSF-553-1   | SCREW #10-24X.563 TH | 1            |
| 11          | GS-0033     | ISOLATOR VIBRATION 1 | 1            |
| 12          | GS-0746     | SPACER ENGINE TECUMS | 1            |
| 14          | GS-0117     | LUG GROUND           | 1            |
| 15          | SS-12-CD    | SCREW .313-18X.750 H | 1            |
| 16          | SSF-3121-ZN | SCREW .313-18X1.75 H | 1            |
| 17          | SSF-8150    | NUT .312-18 UNC HEX  | 1            |
| 18          | SSF-3140-ZN | SCREW .375-16X1.00 H | 1            |
| 19          | N017772     | LOCK WASHER          | 1            |
| 20          | GS-0118     | STRAP GROUND         | 1            |
| 21          | 000000-00   | No Longer Available  | 1            |
| 22          | 000000-00   | No Longer Available  | 1            |
| 25          | SSF-8111-ZN | NUT .375-16 HEX WHIZ | 1            |
| 30          | GS-0513     | FUEL FILTER TEC 8 &  | 1            |
| 33          | SSN-632     | WASHER .875 OD .375  | 1            |
| 35          | SSN-1014-ZN | WASHER .339/.344 ID  | 1            |
| 202         | D21508      | BREAKER CIRCUIT      | 1            |

## Parts List for GT5251 Type 1

| Item Number | Part Number | Description          | Qty Required |
|-------------|-------------|----------------------|--------------|
| 203         | 000000-00   | No Longer Available  | 1            |
| 203         | GS-0445     | RECEPTACLE 4 PRONG T | 1            |
| 203         | GS-0019     | RECEPTACLE 120V 20A  | 1            |
| 204         | SSF-583     | SCREW #6-32X.500 PAN | 1            |
| 205         | SSF-584     | NUT #6-32 SPEED SELF | 1            |
| 206         | SSF-595     | NUT .438-28 UNEF HEX | 1            |
| 207         | SS-1525-CD  | WASHER WRT 3/8       | 1            |