



**BOSCH**

# Diamond Drilling Machine

GDB 1600 WE | 0 601 189 643

---

## Table of Content

Spare parts list.....	2
Illustration - Type.....	6

**Spare parts list**

<b>Item</b>	<b>Part Number</b>	<b>Description</b>
3/50	3 606 610 002	Fan
4	3 607 200 074	Switch
4/10	2 910 011 082	Socket head cap screw      DIN 84-AM3,5x6-5.8
6	3 600 703 011	Grommet      Ø9,2-Ø12x120 MM
7	1 601 302 013	Fastening Clamp
9	3 601 110 511	Manufacturer's nameplate
9/1	3 601 110 434	Reference Plate      SHADOW SIDE
9/2	3 601 110 513	Reference Plate
12	3 607 328 013	Suppression Filter
13	2 600 905 032	Ball Bearing      7x19x6
14	3 600 905 131	groove ball bearing      9x26x8
16	3 604 336 012	Brush Holder
17	1 607 233 156	Speed governor      220-240V
18	3 600 460 006	Segmented Ring
19	3 605 500 153	Cover
20	2 910 211 020	Tapping Screw      DIN 7971-BZ3,9x19
21	1 604 613 006	Compression Spring
23	3 605 500 063	Sealing cap      BLUE
24	2 910 211 019	Tapping Screw      DIN 7971-ST3,9x16-F
25	2 910 021 118	Socket head cap screw      DIN 84-AM4x8-8.8
26	1 600 502 011	Intermediate Ring
28	3 606 135 006	Drilling Spindle
29	3 600 283 042	Rotary shaft lip seal      17X32X7
30	1 600 300 090	Intermediate Ring
32	3 605 500 156	Bearing cover
33	2 910 211 018	Tapping Screw      DIN 7971-ST3,9x13-F
34	3 600 499 016	Air-Deflector Ring
35	3 601 025 003	Wire Guide
36	3 603 435 039	Lens Head Screw
38	3 604 652 001	Spiral Spring
39	2 910 211 239	Tapping Screw      DIN 79-4,8x45-C-ST
40	3 604 411 040	Thread-forming tap. Screw
43	3 604 460 068	Connecting Cable      L=160 MM
44	3 604 438 031	Connecting Cable
45	3 604 414 049	Earth Conductor      L=415 MM

**Spare parts list**

<b>Item</b>	<b>Part Number</b>	<b>Description</b>
47	1 604 477 001	Blade terminal
48	3 603 231 008	Rotary Knob
50	2 917 550 099	Straight Pin     DIN 6325-4m6x20
51	1 903 230 013	Ball     DIN 5401-Ø7MM-III-ST
52	2 600 910 001	Needle-Roller Bearing     Ø14 MM
54	1 600 910 018	Needle bearing     Ø8xØ12x8 MM
55	1 600 100 617	Shim     0,5 MM     THICK
57	3 600 100 083	Shim
59	1 610 910 088	Needle bearing
61	3 606 317 047	Cylindrical Gear     Z=34
62	3 606 317 048	Cylindrical Gear     Z=45
63	3 602 317 037	Wedge
64	3 604 610 048	Compression Spring
65	3 601 015 009	Seal
66	3 600 101 051	Carrier
67	3 602 317 050	Guide Key
68	3 604 610 049	Compression Spring
69	2 917 800 032	Coiled Spring Pin     DIN 7343-4x2
71	2 917 500 121	Straight Pin     5 H 8x18 DIN 7
72	1 900 900 273	groove ball bearing     6003 Y DIN 625
73	2 916 650 008	Spring retaining ring     DIN 471 17x1 MM
77	2 600 590 006	Ratchet Cap
87	3 600 210 028	O-Ring     6,0x2,0 MM
88	3 600 210 115	O-Ring     12,5x2,5 MM
92	3 600 707 022	Shrinkable Tube
93	3 600 400 028	Spacer Sleeve
94	3 600 400 025	Plain Washer
95	3 600 400 026	Spacer Sleeve
96	3 603 414 022	Socket head cap screw     M4x103 MM
97	3 601 016 003	Contact Sheet
98	3 603 100 033	Bolt
99	2 916 031 006	Toothed lock washer
100	3 603 100 034	Threaded Insert
101	3 602 319 041	Socket-Terminal Strip     1x1,5 MM
102	3 601 119 070	Reference Plate

**Spare parts list**

<b>Item</b>	<b>Part Number</b>	<b>Description</b>
801	3 605 108 181	Motor Housing BLUE
802	3 604 220 154	Field 220-240V
803	3 604 010 088	Armature 220-240V
805	3 604 460 178	Power supply cord
808	1 601 11A 3H7	Nameplate
810	3 607 014 003	Carbon-Brush Set
822	3 605 806 184	Spindle Bearing
827	3 605 133 019	Handle BLACK
831	3 600 290 070	Rotary shaft lip seal
837	3 607 030 438	Intermediate Bearing
841	3 602 329 036	Holding Plate
846	3 604 441 010	Connecting Cable L=170 MM WHITE
851	2 916 060 005	Spring Washer DIN 137-A 4-ST
856	3 606 309 054	Spur Wheel Clutch
890	1 601 030 022	Tab Washer
206	3 600 905 114	groove ball bearing 30x47x9
207	3 606 319 030	Carrier
208	3 603 130 009	Hollow Shaft 1 1/4", R 1/2"
209	3 604 610 155	Compression Spring
212	2 916 650 017	Spring retaining ring DIN 471 30x1,5 MM
213	3 600 224 050	Retaining ring
220	3 600 283 041	Rotary shaft lip seal 30X42X6
224	3 603 100 037	Retaining Pin
225	3 605 102 084	Housing
226	3 600 700 053	Sight Glass
227	3 605 510 041	Impeller Wheel
228	3 600 210 112	O-Ring 25,0x2,65 MM
229	3 600 210 114	O-Ring 33,0x2,5 MM
230	3 600 100 082	Plain Washer
231	3 602 380 011	Isolating Valve
232	3 600 760 107	Flexible Connection
232/60	1 609 351 000	O-Ring 11x2,5 MM
235	2 917 550 077	Straight Pin DIN 6325-3M6x12
236	3 603 386 057	Self-locking nut M5
237	3 600 109 014	Sealing Disc

**Spare parts list**

Item	Part Number	Description
238	3 600 224 056	Spring retaining ring
651	3 602 025 014	Auxiliary Handle M14 BLACK
654	1 615 438 373	Carrying Case
715	2 608 598 044	Lengthening Piece R 1/2"
716	2 608 598 045	Lengthening Piece 1 1/4"
726	0 601 190 025	Drill Stand
727	2 609 390 313	pilot drilling guide
734/8	3 603 386 050	Hose Coupling 1/2"
758	2 609 390 308	Calibrating Unit
759	2 609 390 315	Sharpening Stone
760	1 609 202 230	Air Hose Ø 35 MM, L=5 M
761	0 601 989 103	All Purpose Vacuum Clean
811	3 603 349 003	Star Knob
823	3 600 300 055	Clamp Bushing
852	3 607 031 573	Flushing Jet 1 1/4", R 1/2"
852/1	3 607 031 574	Extractor Head 1 1/4", R 1/2"
899	1 600 190 043	Glide ring Ø32,2xØ41x1 MM

Illustration - Type - E

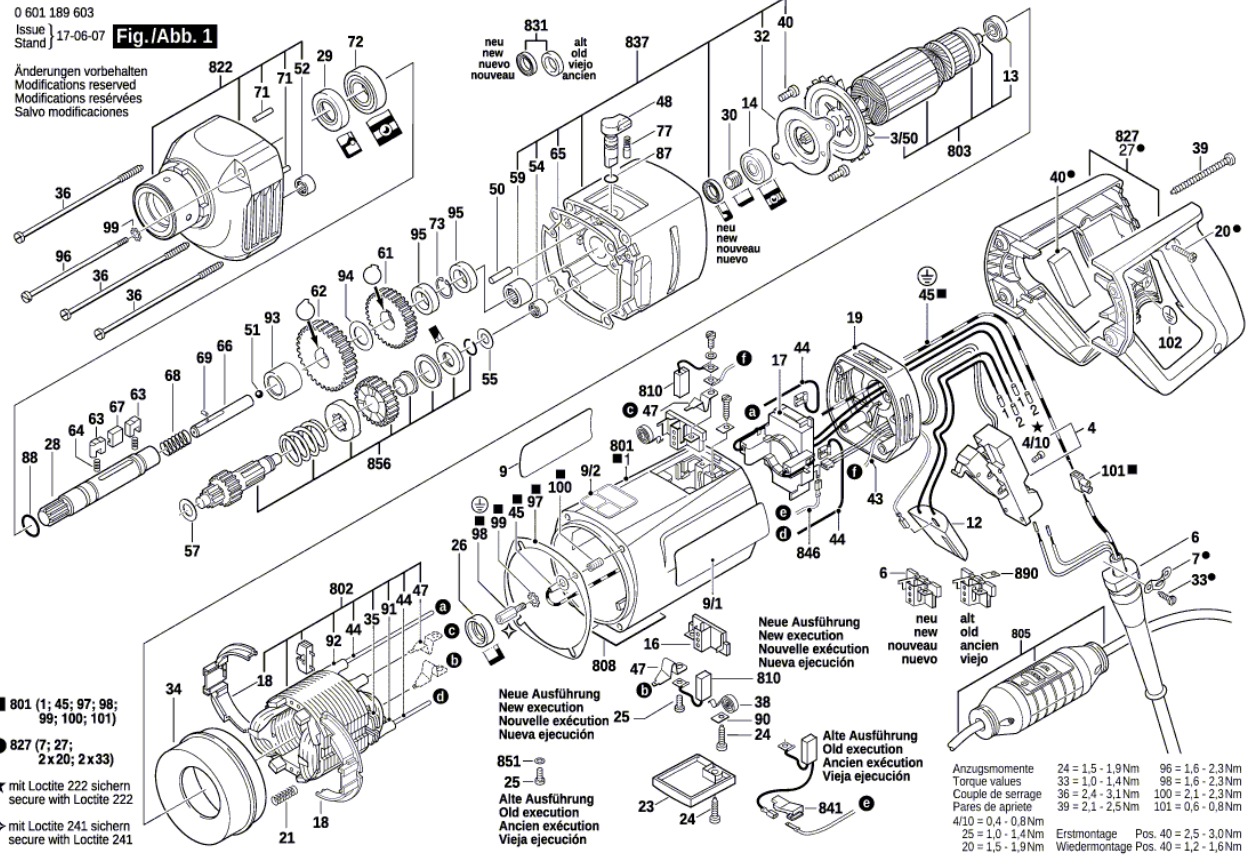

Illustration - Type - E

