



**BOSCH**

# Slide Mitre Saw

GCM 10 MX | 3 601 M29 080

---

## Table of Content

Spare parts list.....	2
Illustration - Type.....	6

## Spare parts list

Item	Part Number	Description	Illustration	Price	Quantity	Price Group
1	1 619 PA7 071	Motor Housing	1	-	1	
2	1 619 PA6 835	Field 220-240V	1	-	1	
4	1 619 PA6 703	Switch	1	-	1	
5	1 619 PA7 073	Power supply cord	1	-	1	
6	1 619 PA7 081	Grommet	1	-	1	
7	1 609 203 J01	Fastening Clamp	1	-	1	
12	1 619 PA7 095	Suppression Capacitor	1	-	1	
16	1 619 PA6 920	Brush Holder	1	-	2	
19	1 619 PA7 002	Pan head screw	1	-	4	
30	1 619 PA6 932	Spring Washer	1	-	4	
31	1 619 PA6 933	Plain Washer	1	-	6	
41	1 619 PA6 942	Nut	1	-	1	
42	1 619 PA6 943	Set screw	1	-	1	
43	1 619 PA6 944	Pivot Shaft	1	-	1	
44	1 619 PA6 945	Self-locking nut	1	-	1	
46	1 619 PA6 946	Guard Plate	1	-	1	
48	1 619 PA6 948	Torsion Spring	1	-	1	
49	1 619 PA6 949	Special Screw	1	-	1	
50	1 619 PA6 950	Protective Cover	1	-	1	
51	1 619 PA6 951	Guard Plate	1	-	1	
52	1 619 PA6 952	Special Screw	1	-	1	
53	1 619 PA6 953	Bushing	1	-	1	
54	1 619 PA6 954	Linkage	1	-	1	
55	1 619 PA6 955	Bushing	1	-	2	
56	1 619 PA6 956	Plain Washer	1	-	2	
57	1 619 PA6 957	Pan head screw	1	-	1	
58	1 619 PA6 958	Special Screw	1	-	1	
59	1 619 PA6 959	Bearing Block	1	-	1	
60	1 619 PA6 960	Plain Washer	1	-	2	
61	1 619 PA6 961	Self-locking nut	1	-	1	
62	1 619 PA6 962	Locking nut	1	-	1	
63	1 619 PA6 963	Lever	1	-	1	
67	1 619 PA6 966	Plain Washer	1	-	3	
69	1 619 PA6 968	Pan head screw	1	-	2	
70	1 619 PA6 969	Detent Pin	1	-	1	

\* Prices shown are suggested retail prices

## Spare parts list

Item	Part Number	Description	Illustration	Price	Quantity	Price Group
71	1 619 PA6 970	O-Ring	1	-	1	
72	1 619 PA6 971	Pivot Shaft	1	-	1	
73	1 619 PA6 972	Scale	1	-	1	
74	1 619 P03 482	Bolt	1	-	1	
75	1 619 PA7 349	Set screw	1	-	1	
76	1 619 PA6 973	Clamping Flange	1	-	1	
78	1 619 PA7 034	Nut	1	-	1	
79	1 619 PA6 975	Pan head screw	1	-	2	
80	1 619 PA6 976	Bearing cover	1	-	1	
84	1 619 PA6 980	Helical Gear	1	-	1	
85	1 619 PA6 981	Pan head screw	1	-	1	
86	1 619 PA6 982	Spring retaining ring	1	-	1	
87	1 619 PA6 983	Dust Separator	1	-	1	
88	1 619 PA6 984	Needle bearing	1	-	1	
89	1 619 PA6 985	Safety Guard	1	-	1	
90	1 619 PA6 986	Bushing	1	-	1	
91	1 619 PA6 987	Hex Screw	1	-	1	
92	1 619 PA6 988	Spacer Pin	1	-	1	
93	1 619 PA6 989	Set screw	1	-	1	
94	1 619 PA6 990	Nut	1	-	1	
95	1 619 PA6 991	Hex Screw	1	-	1	
96	1 619 PA6 992	Rubber Ring	1	-	1	
97	1 619 PA6 993	Air-Deflector Ring	1	-	1	
98	1 619 PA6 994	Pan head screw	1	-	2	
99	1 619 PA6 995	Handle	1	-	1	
100	1 619 PA6 996	shaft lock	1	-	1	
101	1 619 PA6 997	Trigger	1	-	1	
102	1 619 PA6 998	Pan head screw	1	-	2	
103	1 619 PA6 999	Brush-Cover	1	-	2	
104	1 619 PA7 000	Pan head screw	1	-	7	
105	1 619 PA7 001	Plain Washer	1	-	9	
107	1 619 PA7 003	Set screw	1	-	2	
108	1 619 PA7 004	Compression Spring	1	-	1	
109	1 619 PA7 005	Torsion Spring	1	-	1	
110	1 619 PA7 006	Locking Lever	1	-	1	

\* Prices shown are suggested retail prices

## Spare parts list

Item	Part Number	Description	Illustration	Price	Quantity	Price Group
111	1 619 PA7 007	Special Screw	1	-	1	
112	1 619 PA7 008	Compression Spring	1	-	1	
113	1 619 PA7 009	Spring Holder	1	-	1	
114	1 619 PA7 010	Positioning Pin	1	-	1	
138	1 619 PA7 020	Plug Connector	1	-	1	
139	1 619 PA7 021	Bushing	1	-	1	
140	1 619 PA7 022	Parallel Key	1	-	1	
141	1 619 PA7 023	Clamping Flange	1	-	1	
142	1 619 PA7 024	Rivet	1	-	4	
147	1 619 PA7 029	Plain Washer	1	-	1	
148	1 619 PA7 030	Spacer	1	-	1	
803	1 619 PA7 056	Armature 220-240V	1	-	1	
810	1 619 PA7 057	Carbon-Brush Set	1	-	1	
847	1 619 PA7 058	Special Screw	1	-	1	
881	1 619 PA7 032	Spindle	1	-	1	
22	1 619 PA6 924	Mitre Fence	2	-	1	
23	1 619 PA6 925	Mitre Fence	2	-	1	
24	1 619 PA6 926	Wing Screw	2	-	1	
25	1 619 PA6 927	Set screw	2	-	2	
26	1 619 PA6 928	Plain Washer	2	-	4	
27	1 619 PA6 929	Hex Socket Head Cap Screw	2	-	4	
28	1 619 PA6 930	Table	2	-	1	
29	1 619 PA6 931	Pan head screw	2	-	2	
32	1 619 PA6 934	Cover	2	-	1	
33	1 619 PA6 935	Knob	2	-	1	
34	1 619 PA6 921	Spring Washer	2	-	4	
35	1 619 PA6 936	Plain Washer	2	-	1	
36	1 619 PA6 937	Self-locking nut	2	-	1	
37	1 619 PA6 938	Insert	2	-	1	
38	1 619 PA6 939	Countersunk-Head Screw	2	-	4	
39	1 619 PA6 940	Nut	2	-	1	
40	1 619 PA6 941	Pointer	2	-	1	
45	1 619 PA6 922	Scale	2	-	1	
64	1 619 PA6 964	Hex Screw	2	-	3	
65	1 619 PA6 965	Base	2	-	1	

\* Prices shown are suggested retail prices

## Spare parts list

Item	Part Number	Description	Illustration	Price	Quantity	Price Group
66	1 619 PA6 923	Sliding Plate	2	-	3	
68	1 619 PA6 967	Spring Washer	2	-	1	
129	1 619 PA7 011	Angle Plate	2	-	1	
130	1 619 PA7 012	Spring Washer	2	-	5	
131	1 619 PA7 013	Hex Socket Head Cap Screw	2	-	3	
132	1 619 PA7 014	Locking Plate	2	-	1	
133	1 619 PA7 015	Bracket	2	-	1	
134	1 619 PA7 016	Push rod	2	-	1	
135	1 619 PA7 017	Locking Bar	2	-	1	
136	1 619 PA7 018	Locking pin	2	-	1	
137	1 619 PA7 019	Compression Spring	2	-	1	
144	1 619 PA7 026	Spring Washer	2	-	1	
145	1 619 PA7 027	Pan head screw	2	-	2	
146	1 619 PA7 028	Holder	2	-	1	
651	1 619 PA7 036	Hexagon Socket Wrench	2	-	1	
652	1 619 PA7 037	Clamp	2	-	1	
653	1 619 PA7 046	Support Plate	2	-	1	
654	1 619 PA7 051	Dust Bag	2	-	1	
655	1 619 PA6 916	Extension Stand	2	-	2	

\* Prices shown are suggested retail prices

Illustration - Type - E

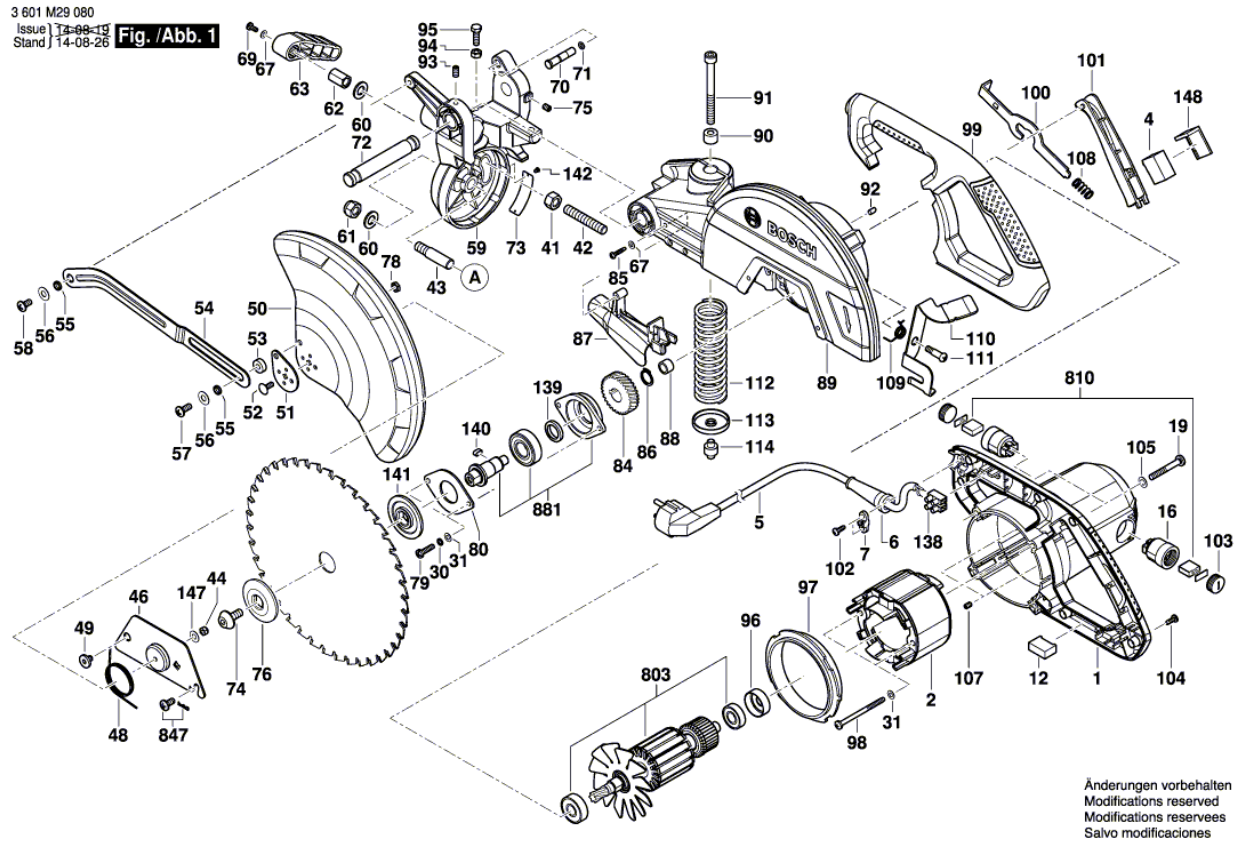

Illustration - Type - E

