

TORQUE 60-70 IN-LBS 32

3 SCREW ON HAND TIGHT

1 TORQUE 20-25 IN-LBS

FUEL LINE MUST NOT CONTACT ANY ENGINE LINKAGES.

25 TORQUE 96-120 IN-LBS

17 TORQUE IF 120-144 IN-LBS

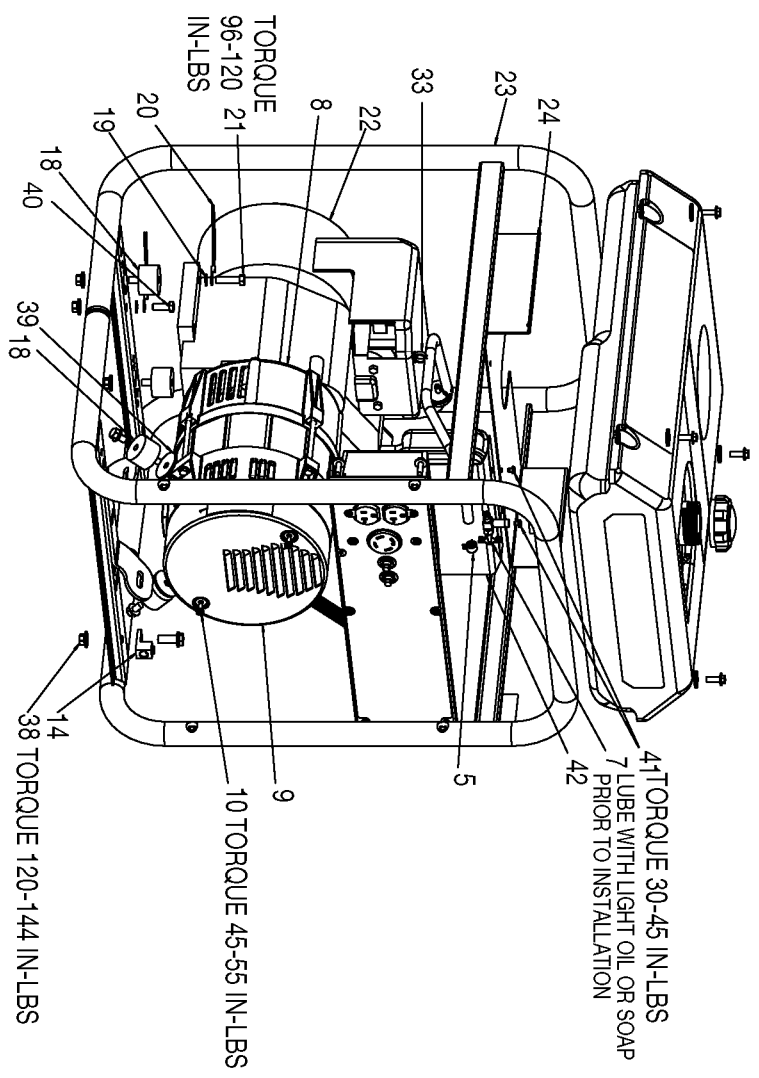

41 TORQUE 30-45 IN-LBS
 7 LUBE WITH LIGHT OIL OR SOAP
 PRIOR TO INSTALLATION

9 10 TORQUE 45-55 IN-LBS

14 38 TORQUE 120-144 IN-LBS

18 96-120 IN-LBS
 19 TORQUE 96-120 IN-LBS
 20 TORQUE 96-120 IN-LBS
 21 TORQUE 96-120 IN-LBS
 22 TORQUE 96-120 IN-LBS

23 TORQUE 96-120 IN-LBS
 24 TORQUE 96-120 IN-LBS
 33 TORQUE 96-120 IN-LBS

42 TORQUE 30-45 IN-LBS

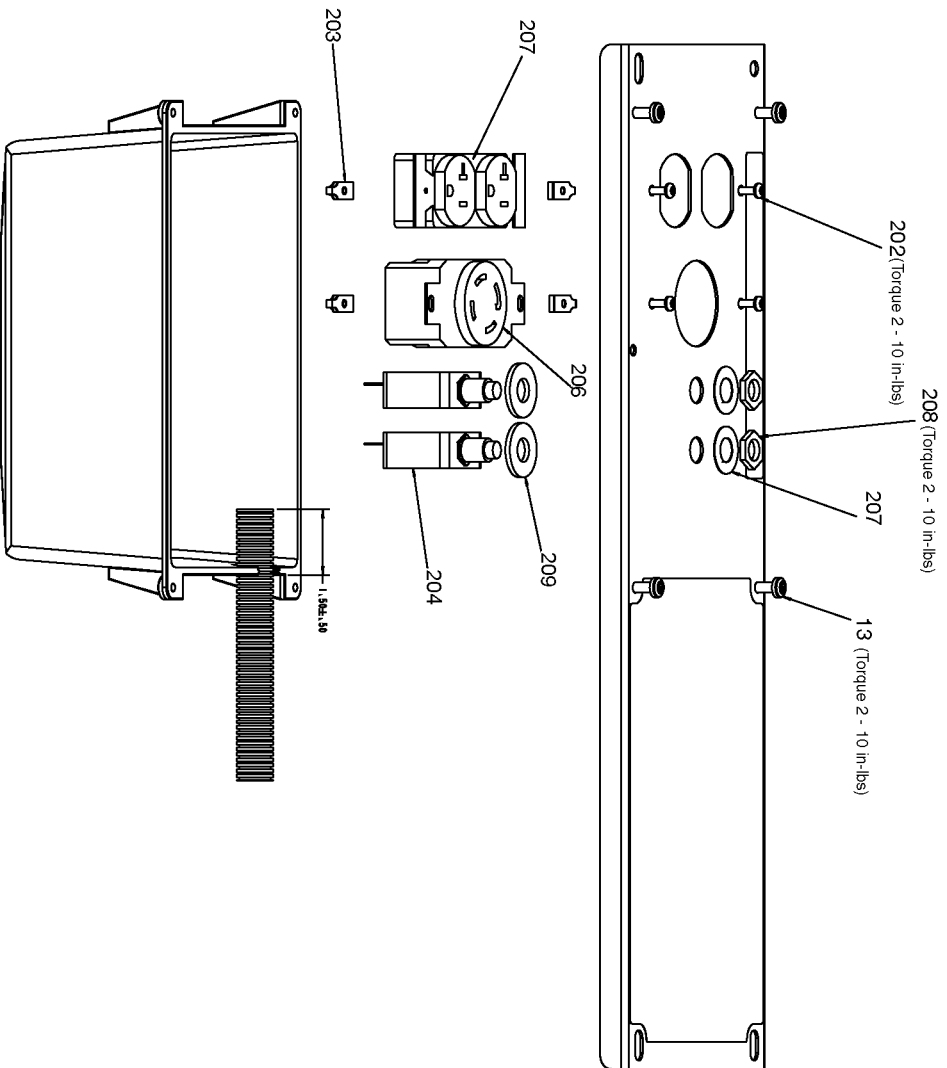

Parts List for GBO5250-WK Type 2

Item Number	Part Number	Description	Qty Required
1	91895680	SCREW .250-20X.750 H	1
2	Z-GS-0795	TANK FUEL 7G SS	1
3	GS-0443	CAP FUEL TANK	1
4	Z-A14582	HOSE FUEL	1
5	GS-0227	CLAMP FUEL .50	1
6	N103455	GROMMET	1
7	GS-0437	DRAIN COCK	1
8	Z-D26598	ASSY GEN 2.759 120/2	1
9	GS-0077	COVER END BLANK	1
10	SSF-553-1	SCREW #10-24X.563 TH	1
13	SSF-3156	SCREW #10-9X.500 THD	1
14	GS-0117	LUG GROUND	1
16	SSN-632	WASHER .875 OD .375	1
17	SSF-8150	NUT .312-18 UNC HEX	1
18	GS-0033	ISOLATOR VIBRATION 1	1
19	N017772	LOCK WASHER	1
20	GS-0118	STRAP GROUND	1
21	5140123-06	SCREW	1
22	000000-00	No Longer Available	1
25	000000-00	No Longer Available	1
32	000000-00	No Longer Available	1
33	GS-0763	CLIP SNAP-IN FUEL LI	1
38	SSF-8111-ZN	NUT .375-16 HEX WHIZ	1
39	SSN-1014-ZN	WASHER .339/.344 ID	1
40	D22311	SCREW .313-18X.875 U	1
201	000000-00	No Longer Available	1
202	SSF-583	SCREW #6-32X.500 PAN	1

Parts List for GBO5250-WK Type 2

Item Number	Part Number	Description	Qty Required
203	SSF-584	NUT #6-32 SPEED SELF	1
204	D21508	BREAKER CIRCUIT	1
206	GS-0445	RECEPTACLE 4 PRONG T	1
207	GS-0019	RECEPTACLE 120V 20A	1
208	SSF-595	NUT .438-28 UNEF HEX	1
209	SS-1525-CD	WASHER WRT 3/8	1
210	D25706	COVER PANEL MINI W/C	1
211	GS-0605	PANEL WIRE HARNESS G	1