

GRINDER

G-1155C(K)

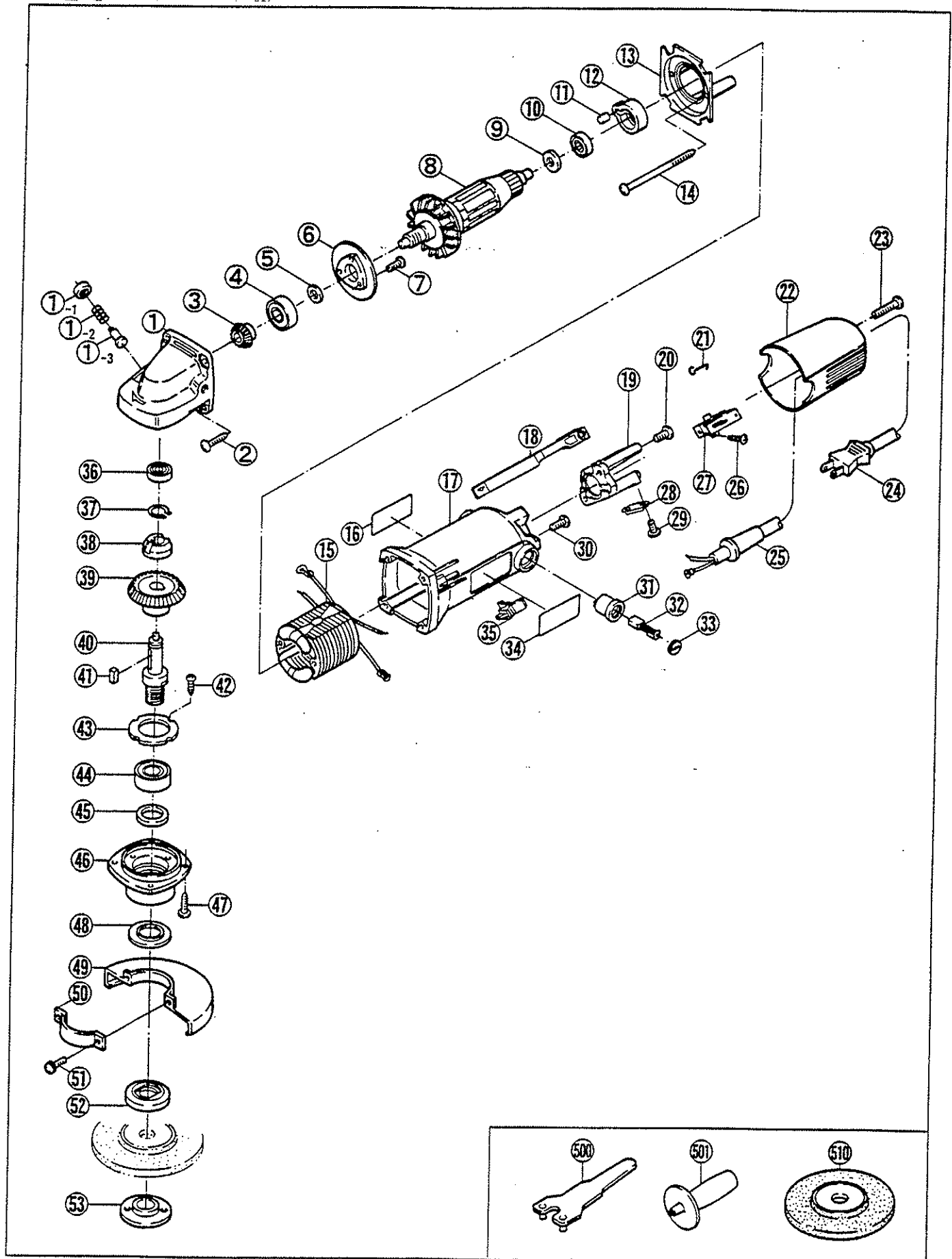

PARTS LIST FOR AFTER SALES SERVICE MODEL G1155C(K)

F	PART NO.	DESCRIPTION	QTY	REF	PART NO.	DESCRIPTION	QTY
1	6080101	GEAR CASE	1	30	9060410	TAPPING SCREW (B) M4X10	2
1-1	6360134	LOCK BUTTON	1	31	6570048	BRUSH HOLDER	2
1-2	6180138	COMPRESSION SPRING	1	32	6540533	CARBON BRUSH SET	1
1-3	6120103	STOPPER PIN	1	33	6570070	BRUSH CAP	2
2	9060518	TAPPING SCREW (B) M5X18	4	34	6920347	"RYOBI" MARK	1
3	6200094	PINION GEAR	1	35	6360133	SWITCH BUTTON	1
4	9840608	BALL BEARING #608LLB	1	36	9840626	BALL BEARING #626LLB	1
5	6900279	COLLAR	1	37	9511200	RETAINING RING S-12	1
6	6151097	CLAMP PLATE	1	38	6290027	STOPPER COLLAR	1
7	9040412	TAPPING SCREW (S) M4X12	3	39	6200093	BEVEL GEAR	1
8	6031052	ARMATURE	1	40	6110084	SPINDLE	1
9	6930023	DUST SEAL	1	41	6100226	PARALLEL KEY	1
10	9840626	BALL BEARING #626LLB	1	42	9040410	TAPPING SCREW (S) M4X10	4
11	6120082	RUBBER KNOCK	1	43	6151088	CLAMP PLATE	1
12	6290028	BEARING HOUSE	1	44	9896201	BALL BEARING #6201LLH	1
13	6490174	FAN CASING	1	45	6900231	FELT WASHER	1
14	9060480	TAPPING SCREW (B) M4X80	2	46	6820315	GEAR CASE COVER	1
15	6500811	FIELD COIL	1	47	9040416	TAPPING SCREW (S) M4X16	4
16	6911414	NAME PLATE	1	48	6151094	DUST COVER	1
17	6800810	MOTOR HOUSING	1	49	6880487	WHEEL GUARD	1
18	6360132	SWITCH LEVER	1	50	6151091	FIXING PLATE	1
19	6590166	CONNECTOR BLOCK	1	51	9020520	PHILLIPS PAN SCREW M5X20	2
	9060420	TAPPING SCREW (B) M4X20	2	52	6940231	FLANGE	1
	6290026	SWITCH LEVER HOOK	1	53	6940265	CLAMP NUT	1
22	6800819	MOTOR COVER	1	---	6560002	CONNECTOR	1
23	9060420	TAPPING SCREW (B) M4X20	2	---	6560043	TERMINAL	1
24	6520331	CORD ASS'Y AWG#18X2X2	1				
25	6560044	CORD HOLDER 10	1				
26	9060412	TAPPING SCREW (B) M4X12	1	500	6240403	LOCK-NUT WRENCH 35	1
27	6550216	TOGGLE SWITCH	1	501	6830679	SIDE HANDLE M10	1
28	6560057	CORD CLAMP	1	510	4680102	4-1/2" GRINDING WHEEL #24	1
29	9060412	TAPPING SCREW (B) M4X12	2	---	6770157	STEEL CASE G1155CK	1

SERVICE NOTES: