

## Screwdriver - 0 601 411 734 - ELECTRONIC

www.powertools-aftersaleservice.com



**BOSCH**

Item	Part Number	Description	Illustration	Price	Quantity	Price Group
4	2 600 900 008	Deep-Groove Ball Bearing Ø 8 MM	1	-,-	1	27
5	2 600 910 000	Needle bearing	1	-,-	1	18
6	2 600 224 010	Retaining ring	1	-,-	1	-
7	1 903 230 006	Ball DIN 5401-3,5 MM-III-ST	1	-,-	19	10
8	2 600 516 010	Capsule	1	-,-	1	33
12	2 600 103 016	Supporting Disc	1	-,-	1	20
17	2 600 910 006	Needle bearing Ø7 MM	1	-,-	1	15
18	2 600 910 007	Needle bearing	1	-,-	1	-
19	2 600 460 902	Depth-Gauge	1	-,-	1	-
20	2 604 611 040	Compression Spring	1	-,-	1	11
22	2 600 210 029	O-Ring 27,0x2,0 MM	1	-,-	1	-
23	2 601 310 008	Holding Spring	1	-,-	1	-
24	2 603 132 002	Pressure Spindle	1	-,-	1	11
25	2 604 601 014	Ratchet Spring	1	-,-	1	-
26	2 600 114 028	Spherical Washer	N/A	-,-	1	-
27	1 903 230 007	Ball DIN 5401-4 MM-III-ST	1	-,-	20	10
28	1 903 230 011	Ball DIN 5401-6 G28	1	-,-	8	10
30	2 606 445 008	Drive Bushing	1	-,-	1	41
31	2 604 619 010	Compression Spring	1	-,-	1	15
32	2 600 501 032	Retaining snap ring	1	-,-	1	27
33	2 604 601 015	Spring retaining ring	N/A	-,-	1	14
35	2 600 914 010	Needle bearing Ø6 MM	1	-,-	2	14
36	2 600 100 607	Shim 0,3 MM	1	-,-	2	11
41	2 603 435 018	Headless Screw	1	-,-	2	11
42	2 603 435 017	Headless Screw	1	-,-	2	13
48	2 600 108 077	Felt Washer	1	-,-	1	11
49	2 600 500 002	Cupped Washer	1	-,-	1	11
50	2 600 905 021	Deep-Groove Ball Bearing 9x24x7	1	-,-	1	21
53	2 916 660 008	Spring retaining ring DIN 472-24x1,2 MM	1	-,-	1	11
54	2 600 400 008	Receptacle	1	-,-	1	11
55	2 605 104 116	Motor Housing BLUE	1	-,-	1	31
56	2 601 328 033	Cover Disc	1	-,-	1	13
57	2 603 490 017	Torx Oval-Head Screw 3x10	1	-,-	4	10

Item	Part Number	Description	Illustration	Price	Quantity	Price Group
58	2 604 220 440	Field 115V	1	-,-	1	32
59	2 604 448 005	Cable L=130 MM WHITE	1	-,-	4	11
60	2 604 465 071	Suppressor Box L=93/85 MM	1	-,-	2	19
62	1 900 905 018	Deep-Groove Ball Bearing 7x22x7	1	-,-	1	29
64	2 607 200 206	Change-Over Switch	1	-,-	1	26
65	2 604 337 003	Brush Holder	1	-,-	2	12
66	2 607 200 138	On-Off Switch	1	-,-	1	44
67	2 601 035 001	Cable Clip	1	-,-	1	11
68	2 910 211 019	Tapping Screw DIN 7971-ST3,9x16-F	1	-,-	2	10
70	2 605 132 040	Housing Cover BLUE	1	-,-	1	21
71	2 910 211 021	Tapping Screw DIN 7971-ST3,9x22-F	1	-,-	3	10
72	2 604 460 109	Power supply cord	1	-,-	1	-
73	2 600 703 013	Grommet Ø7,6-Ø8,2x95 MM	1	-,-	1	13
78	2 601 110 244	Sticker	1	-,-	1	15
79	2 601 110 203	Sticker	1	-,-	1	16
82	2 603 410 001	Socket head cap screw M3x6,5-4.8	1	-,-	2	11
83	2 603 435 015	Recessed-Head Screw DIN 7981-ST3,5x9,5-F	1	-,-	4	11
84	2 601 110 230	Sticker YELLOW	1	-,-	1	11
85	2 600 101 023	Shim 0,3 MM	1	-,-	1	11
85	2 600 101 022	Shim 0,2 MM	1	-,-	1	11
85	2 600 101 020	Shim 0,5 MM	1	-,-	1	11
87	2 600 150 004	Shim	1	-,-	1	11
90	2 910 211 022	Tapping Screw DIN 7971-BZ3,9x25	1	-,-	1	10
96	2 606 610 049	Fan	1	-,-	1	12
200	2 604 448 016	Connecting Cable L=52MM WHITE	N/A	-,-	1	11
201	2 604 448 034	Connecting Cable L=88 MM WHITE	N/A	-,-	1	11
653	2 600 327 001	Guide Sleeve	N/A	-,-	1	-
654	2 600 327 003	Guide Sleeve	N/A	-,-	1	-
801	2 605 806 969	Gear Housing	1	-,-	1	-
802	2 606 309 905	Toothed Shaft Z= 10	1	-,-	1	38
803	2 606 490 909	Coupling Half	1	-,-	1	-
804	2 606 455 903	Coupling Half	1	-,-	1	45
805	2 600 390 901	Threaded Sleeve	1	-,-	1	-
806	2 600 499 901	Adjusting Sleeve	1	-,-	1	40
807	2 603 124 902	Drive Shaft Z= 48	1	-,-	1	42
808	2 604 321 905	Carbon-Brush Set	1	-,-	1	23
809	2 605 700 930	Intermediate Flange	1	-,-	1	38
810	2 604 010 700	Armature With Fan 115V	1	-,-	1	-
888	1 601 106 032	Nameplate 26x52 MM	1	-,-	1	13

## Product information Screwdriver - 0 601 411 734 - ELECTRONIC

Product No	0 601 411 734
Description	251.704; Screwdriver
DIN-Text	
ID_Text_Ext	0
Trading_Description	ELECTRONIC
Voltage_1	115 V
ID_Country_Product	USA

Illustration - Type E

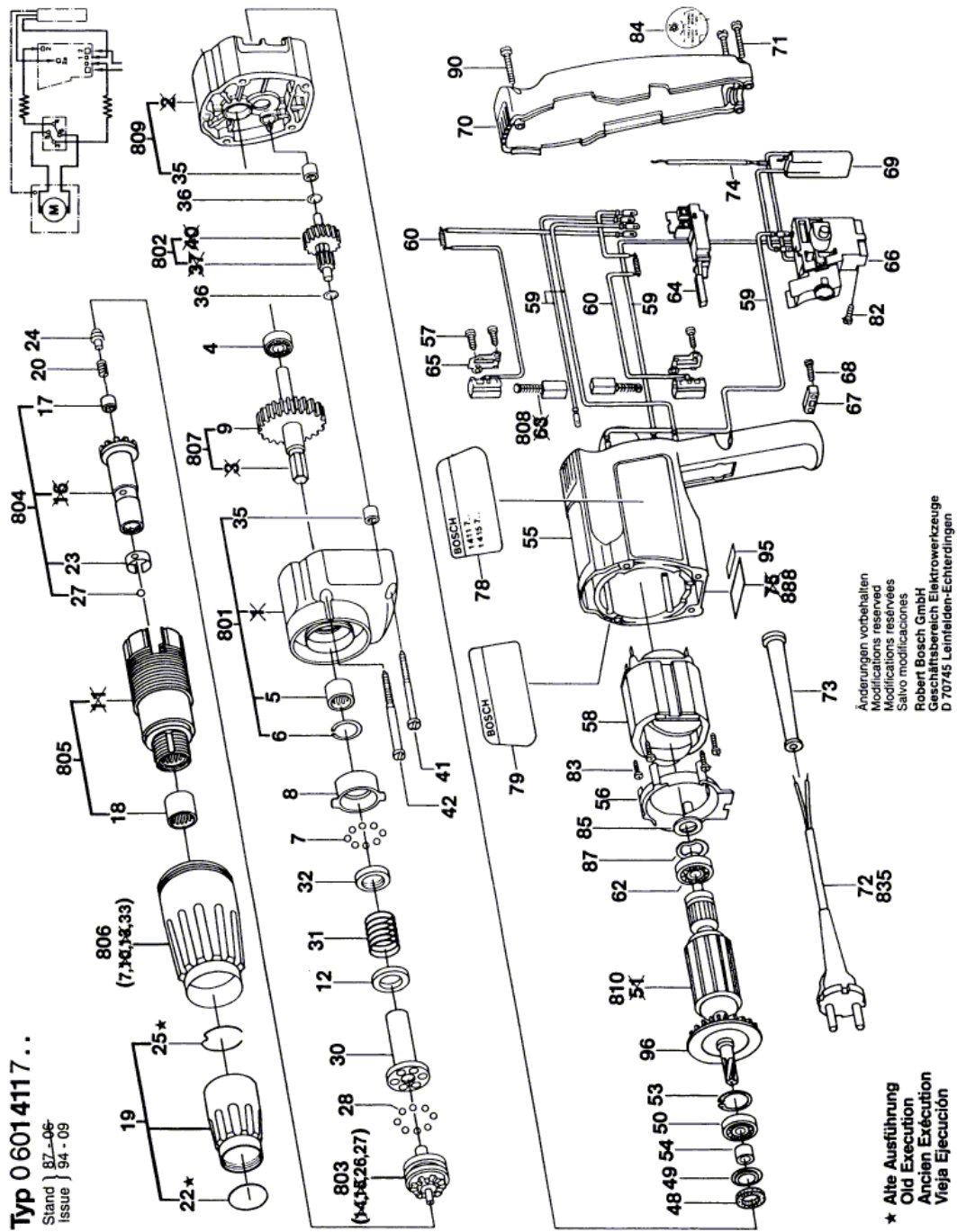

Information subject to change without further notice.