

Screwdriver - 0 601 410 734 - ELECTRONIC

www.powertools-aftersaleservice.com



BOSCH

Item	Part Number	Description	Illustration	Price	Quantity	Price Group
6	2 606 445 005	Drive Bushing		1	-,-	1 38
12	2 916 600 009	Retaining ring 16 DIN 9045		1	-,-	1 10
14	2 600 516 009	Capsule		1	-,-	1 31
15	2 600 460 901	Depth-Gauge		1	-,-	1 -
17	2 600 914 015	Needle bearing		1	-,-	1 19
18	2 600 114 027	Spherical Washer		1	-,-	1 -
19	2 600 103 015	Supporting Disc		1	-,-	2 19
20	2 600 501 031	Retaining snap ring		1	-,-	1 26
21	2 603 132 002	Pressure Spindle		1	-,-	1 11
22	2 604 601 013	Spring retaining ring		1	-,-	1 12
23	2 604 601 012	Stop Spring		1	-,-	1 13
24	1 903 230 003	Ball DIN 5401-2,5MM-III-ST		1	-,-	1 10
25	2 600 210 028	O-Ring 21,0x2,0 MM		1	-,-	1 11
26	2 604 611 040	Compression Spring		1	-,-	1 11
27	2 604 619 009	Compression Spring		1	-,-	1 14
28	1 903 230 006	Ball DIN 5401-3,5 MM-III-ST		1	-,-	2 10
29	1 903 230 004	Ball DIN 5401-3 MM-III-ST		1	-,-	17 10
31	1 903 230 007	Ball DIN 5401-4 MM-III-ST		1	-,-	16 10
32	1 903 230 009	Ball DIN 5401-5 G28		1	-,-	8 10
33	2 601 250 001	Leaf Spring		1	-,-	1 11
35	2 600 550 018	Disc Spring		1	-,-	2 11
37	2 600 914 016	Needle bearing Ø 12 MM		1	-,-	1 15
38	2 600 914 010	Needle bearing Ø6 MM		1	-,-	2 14
39	2 600 100 607	Shim 0,3 MM		1	-,-	2 11
40	2 600 108 000	Felt Disc		1	-,-	1 11
41	2 600 300 049	Seal Bushing		1	-,-	1 13
42	2 600 500 030	Cupped Washer		1	-,-	1 11
44	1 900 905 029	Deep-Groove Ball Bearing 8x22x7		1	-,-	2 26
47	2 605 132 017	Housing Cover BLUE		1	-,-	1 21
48	2 607 200 114	Change-Over Switch		1	-,-	1 29
49	2 604 222 301	Pole Shoe 110-115V		1	-,-	1 -
50	2 604 010 532	Armature 110-115V		1	-,-	1 43
50/10	2 606 610 021	Fan		1	-,-	1 -

Item	Part Number	Description	Illustration	Price	Quantity	Price Group
51	2 914 501 027	Screw and washer assembly DIN 84-BM 4x35-Z4-8.8	1	-,-	3	16
52	2 916 690 003	Spring Lock Washer DIN 128-A4-FST	1	-,-	3	10
53	2 600 119 000	Spring retaining ring	1	-,-	1	11
54	2 601 328 041	Cover Disc	1	-,-	1	14
55	2 601 035 001	Cable Clip	1	-,-	1	11
56	2 604 460 109	Power supply cord	1	-,-	1	-
57	2 600 703 013	Grommet Ø7,6-Ø8,2x95 MM	1	-,-	1	13
58	2 910 211 019	Tapping Screw DIN 7971-ST3,9x16-F	1	-,-	2	10
59	2 910 211 021	Tapping Screw DIN 7971-ST3,9x22-F	1	-,-	2	10
60	2 910 211 020	Tapping Screw DIN 7971-BZ3,9x19	1	-,-	1	10
61	2 607 200 148	Switch	1	-,-	1	-
62	2 603 410 023	Socket head cap screw M3x10 MM	1	-,-	5	11
64	2 600 150 004	Shim	1	-,-	1	11
65	2 600 101 023	Shim 0,3 MM	1	-,-	1	11
65	2 600 101 022	Shim 0,2 MM	1	-,-	1	11
65	2 600 101 020	Shim 0,5 MM	1	-,-	1	11
66	1 900 905 018	Deep-Groove Ball Bearing 7x22x7	1	-,-	1	29
70	2 603 435 016	Tapping Screw 2,2x6,5	1	-,-	2	11
71	2 914 501 011	Screw and washer assembly DIN7985-M3x6-Z1-4.8	1	-,-	2	10
72	2 604 652 003	Spiral Spring	1	-,-	2	11
73	2 916 010 005	Shim	1	-,-	8	-
75	2 604 411 530	Cable	1	-,-	1	11
77	2 604 411 523	Cable	1	-,-	1	11
78	2 604 611 026	Compression Spring	1	-,-	2	11
79	1 903 201 042	Needle Roller DIN 5402-A3x11,8-G2	1	-,-	1	11
80	2 601 110 328	Sticker	1	-,-	1	-
81	2 601 110 099	Manufacturer's nameplate	1	-,-	1	-
82	2 604 411 524	Cable	1	-,-	2	-
83	3 603 133 000	Grooved Nail	1	-,-	2	11
85	2 601 110 230	Sticker YELLOW	1	-,-	1	11
87	1 900 452 012	End Splice DIN 46 228-A1-6	1	-,-	2	10
88	2 600 409 013	Centering Sleeve	1	-,-	3	11
95	1 601 110 449	Nameplate CAUTION	1	-,-	1	11
653	2 608 548 000	Guide Sleeve	N/A	-,-	1	-
654	2 600 326 007	Guide Sleeve	N/A	-,-	1	-
655	2 600 525 029	Knurled Nut	N/A	-,-	1	-
800	2 605 104 954	Motor Housing BLUE	1	-,-	1	31
802	2 605 806 964	Gear Housing BLUE	1	-,-	1	-
803	2 606 311 903	Toothed Shaft Z=10/41	1	-,-	1	36
804	2 606 490 908	Coupling Half	1	-,-	1	43
805	2 606 455 902	Coupling Half	1	-,-	1	43
806	2 600 390 900	Threaded Sleeve	1	-,-	1	-
807	2 600 499 900	Adjusting Sleeve	1	-,-	1	38
808	2 603 124 900	Drive Shaft	1	-,-	1	37
809	2 605 700 925	Bearing Flange	1	-,-	1	30
810	2 604 320 902	Carbon-Brush Set	1	-,-	1	21
888	1 601 106 032	Nameplate 26x52 MM	1	-,-	1	13

Product information Screwdriver - 0 601 410 734 - ELECTRONIC

Product No	0 601 410 734
Description	251.704; Screwdriver
DIN-Text	
ID_Text_Ext	0
Trading_Description	ELECTRONIC
Voltage_1	115 V
ID_Country_Product	USA

Illustration - Type E

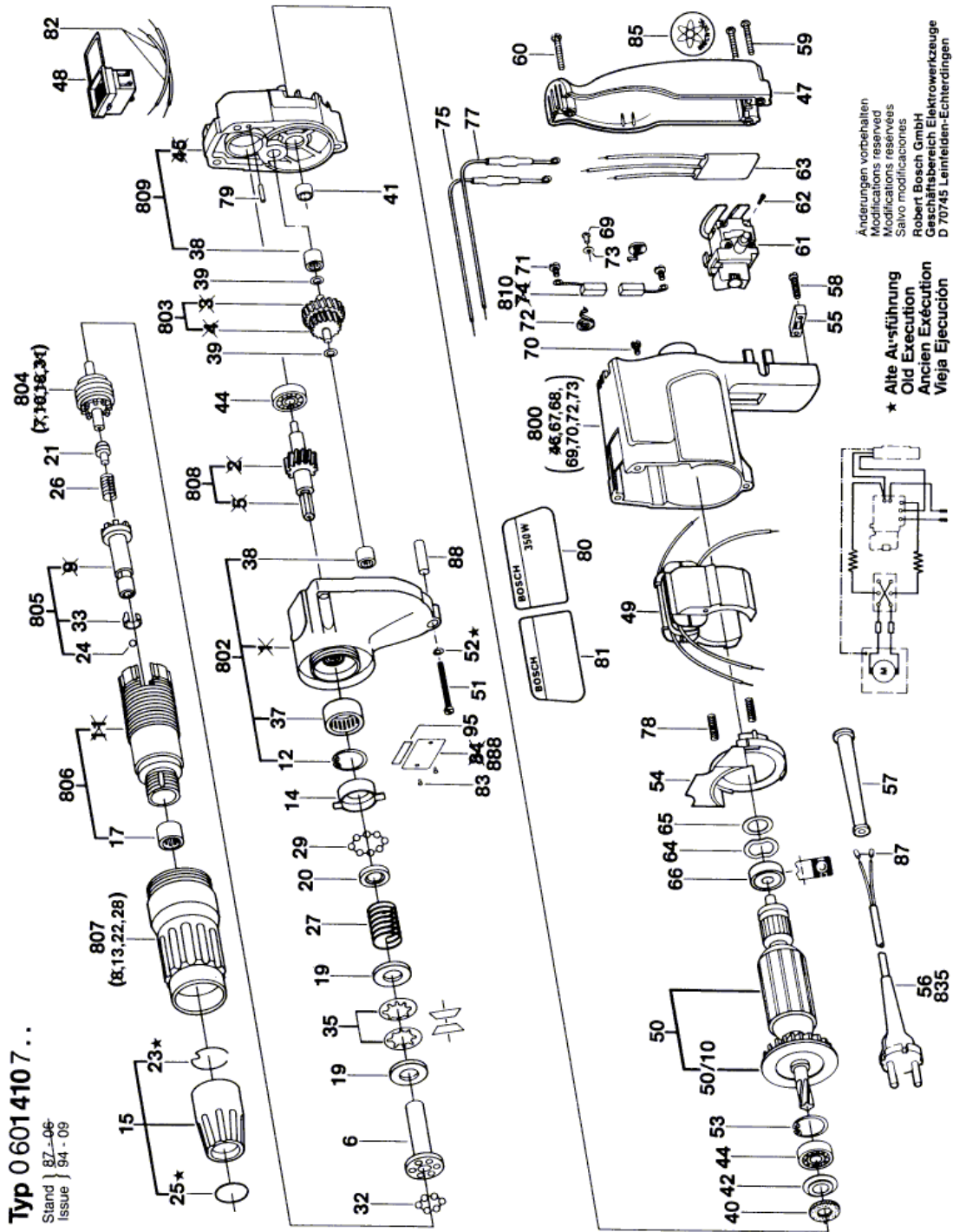

Information subject to change without further notice.