

JV **DUO-FAST** 3
NARROW STAPLERS FASTENERS
Narrow Crown Stapler
DNS-1840
 0521567
 DUO-FAST CORPORATION
 AN ITW COMPANY
 2400 GALVIN DRIVE
 ELGIN, ILLINOIS 60123-7883
 U.S.A.
 05/01 © 2001 DUO-FAST Corporation DNS-186-1840 * Part of Key # 20

TORQUE IN - LBS
 ±5 IN - LBS

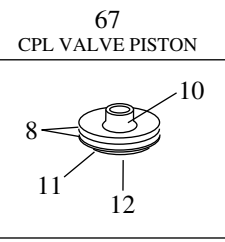
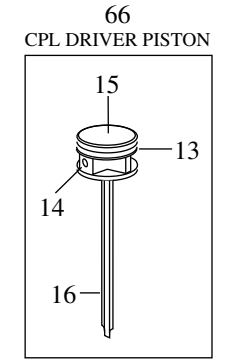

Always Wear
 Safety Glasses

When Using
 Power Tools
 XA-1011 CLEAR
 XA-1022 TINTED

▲ DENOTES CHANGE

TOOLS MUST BE REPAIRED ONLY
 WITH FACTORY AUTHORIZED PARTS
 SIEMPRE REPAIRE LAS HERRAMIENTAS
 SOLAMENTE CON PARTES DE REPUESTO
 AUTORIZADAS POR DUO-FAST

DNS-1840

KEY NO.	PART NO.	QUANTITY	DESCRIPTION	UNIQUE #
1	FAS0666027	4	SCREW M4x25	0535039
2	FAS0128073	1	COVER	0535112
3	FAS0286013	1	SILENCER	0535120
4	FAS0070052	1	BUFFER	0535138
5	FAS0140122	1	CPL. CAP	0535153
6	FAS0166030	1	GASKET	0535146
7	FAS0622135	1	O-RING 402.039	0534982
8	FAS0622140	2	O-RING 2125	0534990
9	FAS0200174	1	SPRING	0535187
10	FAS0300532	1	VALVE PISTON	0535237
11	FAS0166029	1	GASKET	0535245
12	FAS0070051	1	BUFFER	0535252
13	FAS0622119	1	O-RING 130	0535005
14	FAS0662064	1	PIN 4x24	0535260
15	FAS0300524	1	DRIVER PISTON	0535294
16	FAS0186455	1	DRIVER 90 (40) F20T	0535302
17	FAS0104101	1	CYLINDER F20T (40)	0535310
18	FAS0622039	1	O-RING 2112	0535013
19	FAS0280046	1	BUMPER	0535328
20	FAS0700047	1	CYLINDER RING KIT	1012001
*21	FAS0622041	1	O-RING 2137	0535021
22	FAS0544036	1	SPECIAL SCREW	0535047
23	FAS0400154	1	SAFETY (40)	0535344
24	FAS0410033	1	PUSHER 90/SN	0535351
25	FAS0666023	2	SCREW M4x16	0535054
26	FAS0660004	7	WASHER 4	0535369
27	FAS0440081	2	PUSHER BLOCK 90/97A/SN	0535377
28	FAS0340097	2	LIMITING INSERT 90(30/40)	0535385
29	FAS0667021	2	SCREW M5x12 AUTOBLOCK	0535062
30	FAS0070048	1	BUFFER	0535393
31	FAS0145172	1	BASIC SLIDER 90 (30)	0535401
32	FAS0430010	1	BAR RETAINER	0535419
33	FAS0610003	1	STOP RING 5	0535427
34	FAS0200038	1	SPRING	0535195
35	FAS0085003	1	GUIDE BAR	0535435
36	FAS0544031	4	SCREW M5x7mm AUTOBLOCK	0535070
37	FAS0200145	1	SPRING	0535229
38	FAS0184063	1	CATCH	0535443

KEY NO.	PART NO.	QUANTITY	DESCRIPTION	UNIQUE #	
39	FAS0668032	1	SCREW M5x14	0535088	
40	FAS0662019	2	PIN 4x26	0535278	
41	FAS0172386	1	LOADER 90/ES	0535450	
42	FAS0080136	1	DRIVER REST	0535468	
43	FAS0168334	1	DRIVER PLATE 90(40) WS	0535476	
44	FAS0200178	1	SPRING	0535203	
45	FAS0128074	1	SAFETY COVER	0535484	
46	FAS0666024	2	SCREW M4x18	0535096	
47	FAS0138316	1	BODY R20T	0535492	
48	FAS0622122	2	O-RING 230.708	0534917	
49	FAS0140133	1	TRIGGER VALVE	0535500	
50	FAS0200180	1	SPRING	0535211	
51	FAS0622094	3	O-RING 2007	0534958	
52	FAS0288245	1	STUD C/T	0535518	
53	FAS0090036	1	BUSHING	0535526	
54	FAS0288172	1	PIN 4x26	0535278	
55	FAS0667022	1	SCREW M4x12 AUTOBLOCK	0535104	
56	FAS0164076	1	CLP. TRIGGER C.T.	0535534	
57	FAS0348012	1	STOP RING	0535542	
58	FAS0294102	1	TRIGGER PLATE	0535559	
59	FAS0166026	1	GASKET	0535161	
60	FAS0662042	1	PIN 3x26	0535286	
61	FAS0184062	1	QUICK RELEASE CATCH	0535567	
62	FAS0650005	1	SELF-LOCKING NUT M5	0535575	
63	FAS0166028	1	GASKET	0535179	
64	FAS0154027	1	MODULAR ADAPTER	0535583	
65	FAS0666024	3	SCREW M4x18	0535096	
66	FAS0300554	1	CPL. DRIVER/PISTON 90 (40)	0535633	
67	FAS0300420	1	CPL. VALVE PISTON	0535641	
68	FAS0288253	1	STUD	0537258	
69	XH-108-75	1	WARNING LABEL	0337444	
70	XH-108-52	1	CYCLE LABEL	0529610	
*71	FAS166034	1	SEAL	1011902	
	* Part of	FAS0700047	1	Cylinder Ring Kit	1012001

5/01 (3) JV
DNS-1840