

FORM : TL **DUO-FAST** 1

18 GAUGE PINNER

DBN-4450

0536276

DUO-FAST CORPORATION

13951 S. QUALITY DRIVE, HUNTLEY, ILLINOIS, 60142-6700

U.S.A. PRINTED IN U.S.A.

4/97

TOOLS MUST BE REPAIRED ONLY
WITH FACTORY AUTHORIZED PARTS

SIEMPRE REPARE LAS HERRAMIENTAS
SOLAMENTE CON PARTES DE REPUESTO
AUTORIZADAS POR DUO-FAST

Always Wear
Safety Glasses



When Using
Power Tools
XA-1011 CLEAR
XA-1022 TINTED

62
CPL DRIVER PISTON

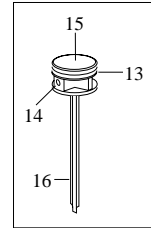

63
CPL VALVE PISTON

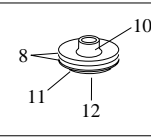

KEY NO.	PART NO.	QTY	PART NAME	ITEM CD	KEY NO.	PART NO.	QTY	PART NAME	ITEM CODE
1	FAS0666027	4	SCREW M4x25	0535039	39	FAS0168336	1	DRIVER PLATE GN(40) WS	0535880
2	FAS0128073	1	COVER	0535112	40	FAS0200178	1	SPRING	0535203
3	FAS0286013	1	SILENCER	0535120	41	FAS0128074	1	SAFETY COVER	0535484
4	FAS0070052	1	BUFFER	0535138	42	FAS0666024	3	SCREW M4x18	0535096
5	FAS0140122	1	CPL. CAP	0535153	43	FAS0138316	1	BODY R20T	0535492
6	FAS0166030	1	GASKET	0535146	44	FAS0622122	2	O-RING 230.708	0534917
7	FAS0622135	1	O-RING 402.039	0534982	45	FAS0140133	1	TRIGGER VALVE	0535500
8	FAS0622140	3	O-RING 2125	0534990	46	FAS0200180	1	SPRING	0535211
9	FAS0200174	1	SPRING	0535187	47	FAS0622094	3	O-RING 2007	0534958
10	FAS0300532	1	VALVE PISTON	0535237	48	FAS0288245	1	STUD C/T	0535518
11	FAS0166029	1	GASKET	0535245	49	FAS0090036	1	BUSH	0535526
12	FAS0070051	1	BUFFER	0535252	50	FAS0288172	1	PIN	0535807
13	FAS0622119	1	O-RING 130	0535005	51	FAS0667022	1	SCREW M4x12 AUTOBLOCK	0535104
14	FAS0662064	1	PIN 4x24	0535260	52	FAS0164076	1	CLP. TRIGGER C.T.	0535534
15	FAS0300524	1	DRIVER PISTON	0535294	53	FAS0348012	1	STOP RING	0535542
16	FAS0186461	1	DRIVER GN (40) F20T	0535815	54	FAS0294102	1	TRIGGER PLATE	0535559
17	FAS0104101	1	CYLINDER F20T (40)	0535310	55	FAS0166026	1	GASKET	0535161
18	FAS0622039	1	O-RING 2112	0535013	56	FAS0662042	1	PIN 3x26	0535286
19	FAS0280046	1	BUMPER	0535328	57	FAS0650005	1	SELF-LOCKING NUT M5	0535575
20	FAS0060043	1	CYLINDER RING F20T	0535336	58	FAS0166028	1	GASKET	0535179
21	FAS0622041	1	O-RING 2137	0535021	59	FAS0154027	1	MODULAR ADAPTER	0535583
22	FAS0544037	1	SPECIAL SCREW	0535625	60	FAS0660004	3	WASHER 4	0535369
23	FAS0400154	1	SAFETY (40)	0535344	61	FAS0666024	3	SCREW M4x18	0535096
24	FAS0667029	1	SCREW M4x18	0535674	62	FAS0300561	1	CPL. DRIVER/PSTN GN (40)	0535898
25	FAS0080141	1	SLIDER REST GN(40)	0535823	63	FAS0300420	1	CPL. VALVE PISTON	0535641
26	FAS0410180	1	CPL. PUSHER GN(40)	0535831	64	FAS0288253	1	STUD	0537258
27	FAS0200176	1	SPRING	0535708	65	XH-108-52	1	CYCLE LABEL	0529610
28	FAS0144093	1	SLIDER GN(40)	0535849	66	XH-108-75	1	WARNING LABEL	0337444
29	FAS0666059	2	SCREW M4x8 AUTOBLOCK	0535724					
30	FAS0414079	1	SLIDER STOP	0535732					
31	FAS0430057	1	LOADER COVER GN(40)	0535856					
32	FAS0666058	2	SCREW M4x6 AUTOBLOCK	0535757					
33	FAS0184098	1	CATCH	0535765					
34	FAS0420207	1	MAGAZINE BRACKET	0535773					
35	FAS0666021	2	SCREW M4x12	0535906					
36	FAS0668032	1	SCREW M5x14	0535088					
37	FAS0172372	1	LOADER ASSY. GN(40)	0535864					
38	FAS0080140	1	DRIVER REST GN(40)	0535872					