



**800**

**224** / **222** / **223**





150

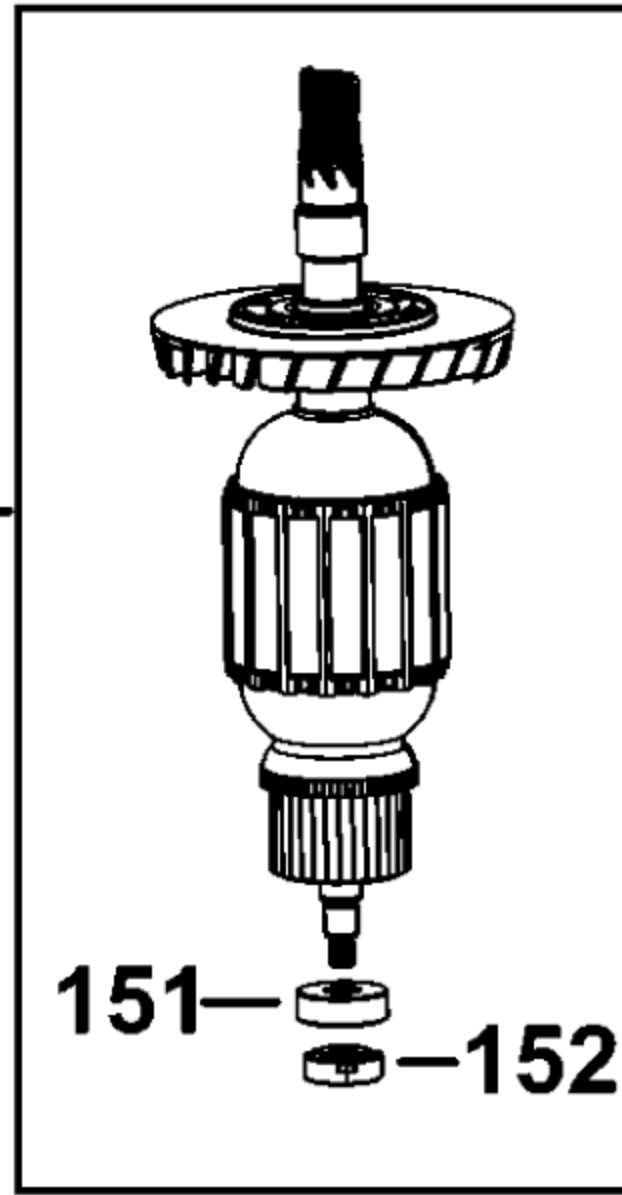

151

152

## Parts List for D25872K Type 1

| Item Number | Part Number | Description    | Qty Required |
|-------------|-------------|----------------|--------------|
| 2           | N551714     | SIDE COVER     | 1            |
| 3           | N551718     | SIDE COVER     | 1            |
| 4           | N481045     | FELT           | 1            |
| 5           | N551711     | TOP COVER      | 1            |
| 6           | N548557     | SCREW          | 20           |
| 7           | N463694     | MODE KNOB      | 1            |
| 9           | N607940     | CAP            | 1            |
| 10          | 330065-08   | SCREW          | 15           |
| 11          | N453525     | DOWEL PIN      | 1            |
| 12          | 323091-01   | PROTECTOR,CORD | 1            |
| 13          | 329301-00   | CLAMP,CORD     | 1            |
| 14          | 330065-05   | SCREW          | 2            |
| 15          | N467531     | SWITCH         | 1            |
| 16          | N453629     | BELLOWS        | 1            |
| 17          | N453630     | BELLOWS        | 1            |
| 18          | N501559     | SPRING         | 1            |
| 19          | N152623     | STOP           | 1            |
| 20          | N551723     | HANDLE PLATE   | 1            |
| 21          | N551946     | HANDLE SET     | 1            |
| 23          | N592371     | CONTROL MODULE | 1            |
| 27          | N389340     | END CAP        | 1            |
| 30          | N518935     | CORDSET        | 1            |
| 31          | 330019-50   | SCREW          | 2            |
| 32          | N585928     | FIELD          | 1            |
| 33          | N580536     | MOTOR HOUSING  | 1            |
| 34          | N449094     | BEARING COVER  | 1            |
| 35          | N425665     | BRUSH HOLDER   | 2            |

## Parts List for D25872K Type 1

| Item Number | Part Number | Description     | Qty Required |
|-------------|-------------|-----------------|--------------|
| 37          | N581444     | BRUSH PAIR KIT  | 1            |
| 38          | N523745     | BRUSH SPRING    | 2            |
| 39          | N405298     | FAN BAFFLE      | 1            |
| 41          | N583768     | MAIN HOUSING    | 1            |
| 43          | N537281     | BUSH            | 1            |
| 44          | N537973     | O-RING          | 1            |
| 46          | N447147     | SEAL            | 1            |
| 50          | N580547     | CRANKSHAFT      | 1            |
| 51          | N580507     | GEAR HOUSING    | 1            |
| 52          | N422626     | SEAL RING       | 1            |
| 53          | 488147-01   | CIRCLIP         | 1            |
| 54          | N110363     | BEARING         | 1            |
| 55          | N110359     | BEARING         | 2            |
| 56          | N362699     | CIRCLIP         | 1            |
| 63          | N580550     | PISTON ASSEMBLY | 1            |
| 70          | N612854     | O-RING          | 1            |
| 71          | N580553     | CYLINDER        | 1            |
| 72          | N481377     | O-RING          | 2            |
| 73          | N580554     | RAM             | 1            |
| 74          | N612854     | O-RING          | 1            |
| 75          | N493644     | O-RING          | 1            |
| 76          | N413144     | BUSH            | 1            |
| 77          | N400500     | DAMPER          | 1            |
| 78          | N389366     | WASHER          | 1            |
| 79          | N580555     | SPINDLE         | 1            |
| 80          | N392234     | WASHER          | 2            |
| 81          | 589223-00   | DAMPER          | 1            |

## Parts List for D25872K Type 1

| Item Number | Part Number | Description    | Qty Required |
|-------------|-------------|----------------|--------------|
| 82          | N580556     | BEAT PIECE     | 1            |
| 83          | N594490     | SEAL           | 1            |
| 84          | N432561     | O-RING         | 1            |
| 85          | N409943     | COVER          | 1            |
| 86          | N504016     | ECCENTRIC      | 1            |
| 87          | N515556     | O-RING         | 1            |
| 88          | N410143     | SLIDER         | 1            |
| 89          | N520791     | SPRING         | 2            |
| 90          | N410898     | CONNECTOR      | 1            |
| 91          | N427022     | CRANK PLATE    | 1            |
| 93          | N455140     | O-RING         | 1            |
| 96          | N409698     | SLIDER         | 1            |
| 98          | N580533     | SLEEVE         | 1            |
| 99          | N497938     | SPRING         | 1            |
| 100         | N580559     | FRONT HOUSING  | 1            |
| 103         | N392582     | SEAL RING      | 1            |
| 104         | N181847     | LOCKING RING   | 1            |
| 105         | N416525     | FRONT COVER    | 1            |
| 106         | N431324     | GASKET         | 1            |
| 107         | N420195     | LOCK BUSHING   | 1            |
| 108         | 949886-32   | SCREW          | 4            |
| 109         | N516486     | GUIDE          | 1            |
| 110         | N520784     | CONICAL SPRING | 1            |
| 111         | N520782     | SPRING         | 1            |
| 112         | N408040     | GUIDE BUSHING  | 1            |
| 113         | N511836     | LOCKING PIECE  | 2            |
| 114         | N511834     | BUSH           | 1            |

## Parts List for D25872K Type 1

| Item Number | Part Number | Description     | Qty Required |
|-------------|-------------|-----------------|--------------|
| 115         | N511805     | DAMPER          | 1            |
| 116         | N468816     | SLEEVE          | 1            |
| 117         | 487244-00   | RUBBER          | 1            |
| 118         | N516487     | WASHER          | 1            |
| 119         | N522784     | SNAP RING       | 1            |
| 120         | 487238-01   | SEAL            | 1            |
| 122         | N448156     | COIL            | 1            |
| 123         | N086775     | SCREW           | 1            |
| 125         | 488065-01   | TRIGGER         | 1            |
| 138         | N520790     | DETENT SPRING   | 1            |
| 140         | N408073     | NEEDLE BEARING  | 1            |
| 141         | N408081     | BUSH            | 1            |
| 150         | N585926     | ARMATURE        | 1            |
| 151         | N110359     | BEARING         | 1            |
| 152         | N466979     | MAGNET          | 1            |
| 165         | N578605     | FELT            | 1            |
| 190         | N602345     | WIRE COVER      | 1            |
| 195         | 330019-04   | SCREW,PLASTITE  | 2            |
| 201         | N551324     | RATING LABEL    | 1            |
| 221         | 487291-00   | KNOB ASSY       | 1            |
| 222         | 479317-00   | LOCK WASHER     | 2            |
| 223         | 479319-00   | CLAMPING INSERT | 2            |
| 224         | 479320-00   | WASHER          | 2            |
| 226         | 487343-00   | BOLT            | 1            |
| 227         | N470872     | FRONT HANDLE    | 1            |
| 300         | N593929     | SERVICE KIT     | 1            |
| 800         | 578970-06   | GREASE          | 1            |

## Parts List for D25872K Type 1

| Item Number | Part Number | Description  | Qty Required |
|-------------|-------------|--------------|--------------|
| 800         | 578970-04   | GREASE       | 1            |
| 837         | 1003974-99  | SERVICE TOOL | 1            |
| 837         | 1003975-99  | SERVICE TOOL | 1            |
| 837         | 1003972-99  | SERVICE TOOL | 1            |
| 837         | 1003973-99  | SERVICE TOOL | 1            |
| 861         | N508182     | KIT BOX      | 1            |