

ELECTRIC TOOL PARTS LIST

■ ANGLE DRILL
Model D 10YA

2000-6-1

(E5-1)

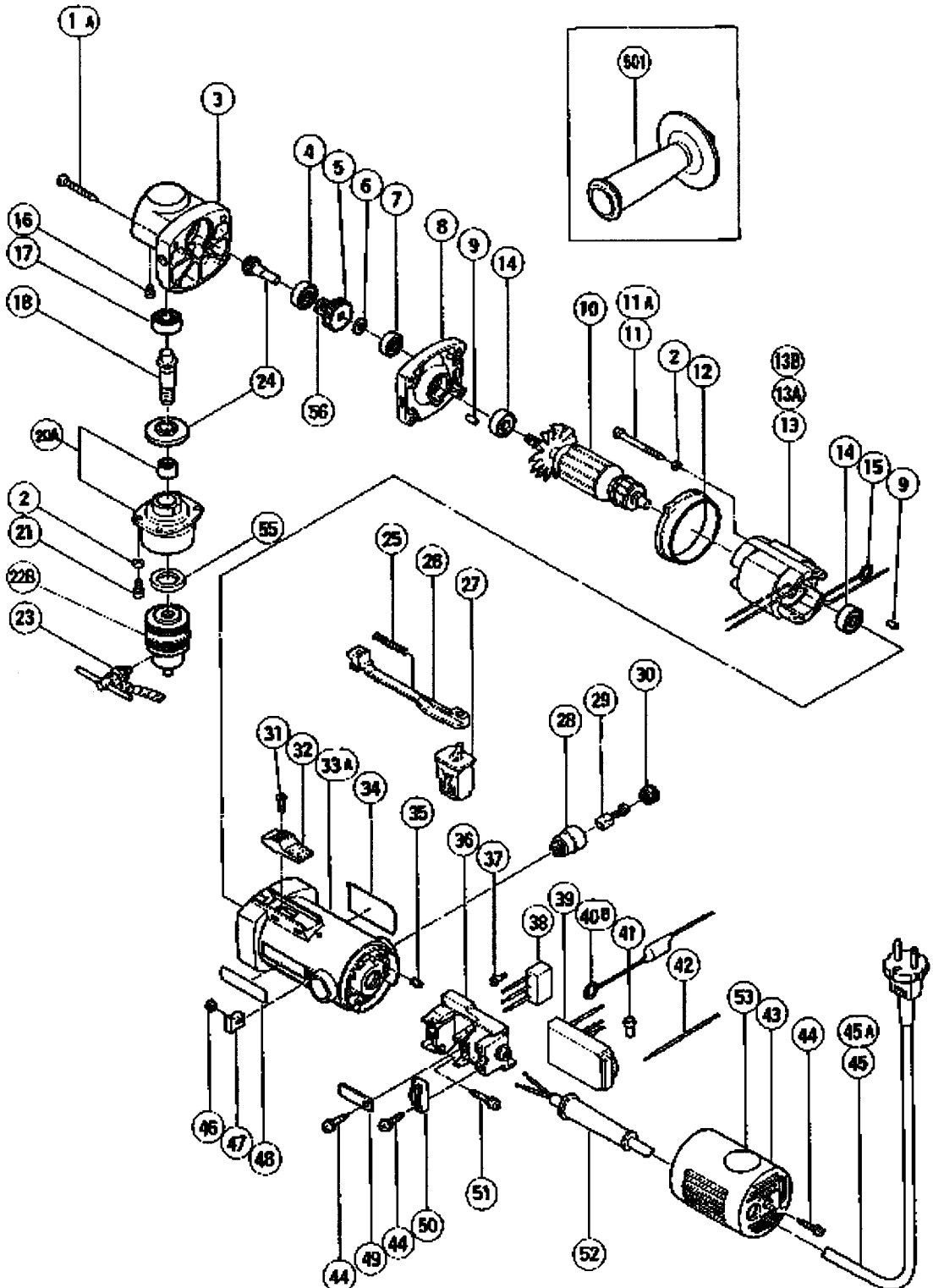

PARTS

D10YA

ITEM No.	CODE No.	DESCRIPTION	No. USED	REMARKS
1A	954-015	TAPPING SCREW D4X35	4	
2	949-453	SPRING WASHER M4 (10 PCS.)	6	
3	985-401	GEAR COVER	1	
4	608-VVM	BALL BEARING 608VVC2PS2L	1	
5	985-410	FIRST GEAR	1	
6	942-928	WASHER (D)	2	
7	626-VVM	BALL BEARING 626VVC2PS2L	1	
8	985-402	INNER COVER	1	
9	931-701	BEARING LOCK	2	
* 10	985-409C	ARMATURE 110V-127V	1	
* 10	985-409E	ARMATURE 220V-230V	1	
* 10	985-409F	ARMATURE 240V	1	
11	949-230	MACHINE SCREW M4X50 (10 PCS.)	2	TILL 4.1987
11A	981-421	HEX. HD. TAPPING SCREW D4X55	2	SINCE 5.1987
12	985-400	FAN GUIDE	1	
* 13	985-408C	STATOR ASS'Y 110V-127V	1	INCLUD.15
* 13	985-408E	STATOR ASS'Y 220V-230V	1	INCLUD.15
* 13	985-408F	STATOR ASS'Y 240V	1	INCLUD.15
* 13A	985-408G	STATOR ASS'Y 220V-230V	1	INCLUD.15 FOR NZL,FRG,FRA,HOL,DEN,FIN,
*				SWE,AUT,SUI,GBR
* 13A	985-408K	STATOR ASS'Y 240V	1	INCLUD.15 FOR AUS
* 13A	985-408J	STATOR ASS'Y 110V	1	INCLUD.15 GBR
* 13B	985-408L	STATOR ASS'Y 240V	1	SINCE 11.1998 INCLUD.15 FOR AUS
14	608-VVM	BALL BEARING 608VVC2PS2L	2	
15	930-630	BRUSH TERMINAL	1	
16	985-414	FLAT FILLISTER HD. SCREW M4X10	2	
17	629-VVM	BALL BEARING 629VVC2PS2L	1	
18	985-403	SPINDLE	1	
20A	315-884	CHUCK COVER ASS'Y	1	
21	949-216	MACHINE SCREW M4X10 (10 PCS.)	4	
22B	950-292	DRILL CHUCK 10TLRA	1	INCLUD.23
23	980-057	CHUCK WRENCH 10TL2	1	
24	981-463	GEAR AND PINION SET	1	
25	963-632	SPRING (B)	1	

*:ALTERNATIVE PARTS

-- 2--

PARTS

D10YA

ITEM No.	CODE No.	DESCRIPTION	No. USED	REMARKS
26	963-631	SLIDE BAR	1	
27	963-633	SWITCH (2P PILLAR TYPE)	1	
28	937-846	BRUSH HOLDER	2	
29	999-021	CARBON BRUSH (1 PAIR)	2	
30	937-847	BRUSH CAP	2	
31	949-323	FLAT HD. SCREW M4X12 (10 PCS.)	1	
32	938-312	SLIDE KNOB (B)	1	
33A	985-420	HOUSING ASS'Y	1	INCLUD.11A,28,35
34		NAME PLATE	1	
35	963-383	HEX. SOCKET SET SCREW M4X8	2	
36	963-635	SWITCH HOLDER	1	
* 37	959-144	TERMINAL 50051 (10 PCS.)	1	FOR NZL,GBR,FRG,FRA,DEN,SWE,HOL,FIN,AUT,
*				SUI
* 38	994-273	NOISE SUPPRESSOR	1	
* 39	985-415	CONTROLLER CIRCUIT 110V-127V	1	
* 39	985-416	CONTROLLER CIRCUIT 220V-240V	1	
* 40A	985-412	BRUSH TERMINAL (W/CHOKE COIL)	1	FOR NZL,GBR,FRA,HOL,DEN,FIN,SWE,AUT
* 40A	985-418	BRUSH TERMINAL (W/CHOKE COIL)	1	FOR SUI
* 40B	317-430	BRUSH TERMINAL (W/CHOKE COIL)	1	FOR AUS
* 41	959-140	CONNECTOR 50091 (10 PCS.)	3	
42		INTERNAL WIRE	1	
* 43	963-636	TAIL COVER	1	
44	930-446	TAPPING SCREW (W/WASHER) D4X16	4	
* 45	500-201Z	CORD	1	(CORD ARMOR D10.1)
* 45	500-439Z	CORD	1	(CORD ARMOR D8.8) NZL,AUS
* 45	500-231Z	CORD	1	(CORD ARMOR D8.8) FOR GBR (110V)
* 45	500-234Z	CORD	1	(CORD ARMOR D8.8) FOR INA,MLT,ITA,FRG,
*				FRA
* 45	500-240Z	CORD	1	(CORD ARMOR D8.8) FOR USA,CAN
* 45	500-245Z	CORD	1	(CORD ARMOR D10.1) FOR SYR
* 45	500-247Z	CORD	1	(CORD ARMOR D10.1) FOR HOL,DEN,FIN,SWE,
*				AUT
* 45	500-248Z	CORD	1	(CORD ARMOR D10.1) FOR SUI
* 45A	500-423Z	CORD	1	(CORD ARMOR D8.8) FOR SIN,KUW

*:ALTERNATIVE PARTS

PARTS

D10YA

ITEM No.	CODE No.	DESCRIPTION	No. USED	REMARKS
* 45A	500-436Z	CORD	1	(CORD ARMOR 8.8) FOR GBR (240V)
46	949-554	NUT M4 (10 PCS.)	2	TILL 4.1987
47	963-341	NUT COVER	2	TILL 4.1987
48	950-565	HITACHI LABEL	1	
49	963-634	SWITCH PLATE	1	
50	960-266	CORD CLIP	1	
51	982-095	TAPPING SCREW (W/WASHER) D4X20	2	
* 52	953-327	CORD ARMOR D8.8	1	
* 52	938-051	CORD ARMOR D10.1	1	
53	962-994	MARK PLATE	1	
55	936-973	FELT PACKING	1	
56	985-413	DISTANCE WASHER	1	

STANDARD ACCESSORIES

ITEM No.	CODE No.	DESCRIPTION	No. USED	REMARKS
501	956-633	SIDE HANDLE	1	

*:ALTERNATIVE PARTS