

REPLACEMENT PARTS

| REF. NO. | PART NO. | DESCRIPTION | REF. NO. | PART NO. | DESCRIPTION |
|----------|-----------------|---|----------------|--|--|
| 1 | 34-154 | Table Insert, Incl: | * | 34-658 | Complete Guard Ass'y, Const. of: |
| 2 | 901-04-461-5297 | Pellet Lck Screw | * | 1086935 | Blade Guard, Const. of: |
| 3 | 422-19-091-0004 | Table | | 1086334 | "See Thru Guard" |
| 4 | 34-862 | Extension Wing, Incl. | 66 | 1087811 | Pin |
| 5 | 904-02-010-1716 | 7/16" Lockwasher | 67 | 1086388 | Push Nut Cap |
| 6 | 901-01-060-0664 | 7/16-20 x 1" Hex Head Screw | 68 | 1086353 | Spring |
| 7 | 902-01-010-1232 | 7/16-20 Hex Nut | 69 | 422-16-047-0001 | Kickback Finger |
| 8 | 422-04-055-0001 | Front Guide Rail | 70 | 422-16-071-0002 | Pin |
| 9 | 422-04-112-5007 | Rear Guide Rail | 71 | 1086387 | Push Nut |
| 10 | 904-01-010-1615 | 3/4-24 Special Screw | 72 | 1086337 | Pivot Bracket |
| 11 | 904-01-010-1615 | 3/8" Flat Washer | 73 | 1086932 | Splitter w/Bushing |
| 12 | 904-02-020-1704 | 3/8" Lockwasher | 74 | 903-01-010-6729 | 5/32 x 11/16" Roll Pin |
| 13 | 902-01-020-1270 | 3/8-24 Hex Nut | 75 | 1086236 | Bracket |
| 14 | 422-04-104-0001 | Spacer | 76 | 1088237 | Shaft |
| 15 | 961-01-010-7462 | Plug | 77 | 422-02-014-0014 | Bracket |
| 16 | 1087906 | Cabinet Assembly, Incl: | 78 | 901-03-010-0757 | 5/16-18 x 3/4" Hex Head Screw |
| 17 | 422-05-089-0002 | Support | 80 | 901-01-060-0611 | 1/4-20 x 1/2" Hex Head Screw |
| 18 | 901-02-050-0707 | 5/16-18 x 1" Fill Head Screw | 81 | 902-02-040-1303 | 1/4" Square Nut |
| 19 | 904-01-010-1620 | 5/16" Flat Washer | 83 | 902-01-120-1034 | 1/4-20 Hex Nut |
| 20 | 422-01-010-1300 | 5/16-18 Hex Nut | 85 | 904-02-020-1702 | 1/4" Lockwasher |
| 21 | 422-02-132-0002 | Nameplate w/Scale | 86 | 422-03-072-0001 | Plate |
| 22 | 1087994 | Rivet | 87 | 422-04-314-0017 | Bracket, Incl: (Current Models Only, See Service Note B) |
| 23 | 901-01-060-0606 | 5/16-18 x 5/8" Hex Head Screw | 88 | 902-03-013-1063 | Tinnerman Nut |
| 24 | 904-01-010-1620 | 5/16" Flat Washer | 89 | 901-03-010-3309 | 1/4-20 x 5/8" Soc Head Screw |
| 25 | 422-02-060-0003 | Handle (Current Models Only) | 90 | 901-01-060-0649 | 5/16-18 x 1" Hex Head Screw |
| 26 | 34-895 | Miter Gage, Const. of: | 91 | 904-01-010-1604 | 1/4" Flat Washer |
| 27 | 422-02-060-0001 | Handknob (Early Models Only) | 92 | 904-02-020-1702 | 1/4" Lockwasher |
| 28 | 904-07-010-5555 | Fiber Washer | 93 | 422-04-314-0017 | Bracket (Early Models Only, See Service Note B) |
| 29 | 901-04-410-4561 | Miter Gage Body | 94 | 901-01-060-0606 | 5/16-18 x 5/8" Hex Head Screw |
| 30 | 902-01-200-1086 | 1/4-28 x 1/4" Headless Set Screw | 95 | 422-03-072-0001 | Plate (Early Models Only) |
| 31 | 901-04-150-9428 | Hex Nut (Early Models Only) | 96 | 901-01-060-0622 | 1/4-20 x 2" Hex Head Screw (Early Models Only) |
| 32 | 901-07-261-3237 | #8-32 x 1/2" Hex Soc Set screw | 97 | 901-01-060-0603 | 1/4-20 x 7/8" Hex Head Screw (Early Models Only) |
| 33 | 422-04-004-0001 | Guide Bar | 98 | 904-02-020-1702 | 1/4" Lockwasher (Early Models Only) |
| 34 | 422-01112-0001 | Pivot Screw | 99 | 901-01-060-0649 | 5/16-18 x 1" Hex Head Screw |
| 35 | 422-01-088-0002 | Stop Link | 100 | 904-01-010-1620 | 5/16" Flat Washer |
| 36 | 422-01-075-0001 | Pointer | 101 | 904-02-010-1703 | 5/16" Lockwasher |
| 37 | 905-04-061-2351 | Steel Pin | 102 | 902-01-010-1300 | 5/16-18 Hex Nut |
| 38 | 901-04-410-4561 | 1/4-28 x 1/4" Headless Set Screw | ** | 424-01-014-0002 | Switch Bracket |
| 39 | 422-04-343-0008 | Rip Fence, Const. of: | * | NOT SHOWN ASSEMBLED | |
| 40 | 951-01-020-7849 | Pointer | ** | NOT SHOWN | |
| 41 | 422-04-105-5001 | Sleeve | SERVICE NOTES: | | |
| 42 | 422-04-312-5008 | Front Calmp, Const. of: | A - | This pin is not knurled, add a drop of Loctite prior to assembly into front clamp shoe, Ref. No. 45. Current models do not have a pin. | |
| 43 | 422-04-012-5005 | Front Calmp Body | B - | Earlier bracket was die cast - current model bracket is sheet metal. | |
| 44 | 422-04-042-5002 | Eccentric | | | |
| 45 | 422-04-071-5004 | Pin | | | |
| 46 | 422-04-111-5002 | Stud | | | |
| 47 | 422-04-351-5002 | Knob and Pinion Assembly | | | |
| 48 | 422-04-327-5002 | Front Clamp Shoe, Incl: | | | |
| 49 | 422-04-071-5000 | Rubber Bushing | | | |
| 50 | 904-08-021-4550 | Pin (Early Models Only, See service Note A) | | | |
| 51 | 928-01-041-4123 | 1/4-20 x 1/4" Soc Set Screw | | | |
| 52 | 931-01-011-4091 | Spring | | | |
| 53 | 928-01-205-5898 | Ball Handle | | | |
| 54 | 928-01-021-5301 | Spring | | | |
| 55 | 901-01-060-0677 | 3/8-28 x 1/2" Hex Head Screw | | | |
| 56 | 904-01-033-1451 | Washer | | | |
| 57 | 901-01-060-0605 | 5/16-18 x 1/2" Hex Head Screw | | | |
| 58 | 904-01-010-1620 | Block | | | |
| 59 | 905-04-071-4459 | Pin | | | |
| 60 | 928-01-041-4118 | Spring | | | |
| 61 | 422-04-027-0001 | Clamp Hook | | | |
| 62 | 422-04-067-5001 | Lever | | | |
| 63 | 422-04-108-5001 | Rod | | | |
| 64 | 901-02-010-0551 | #10-32 x 1/4" Round Hd Screw | | | |
| 65 | 422-04-343-5002 | Fence Body | | | |

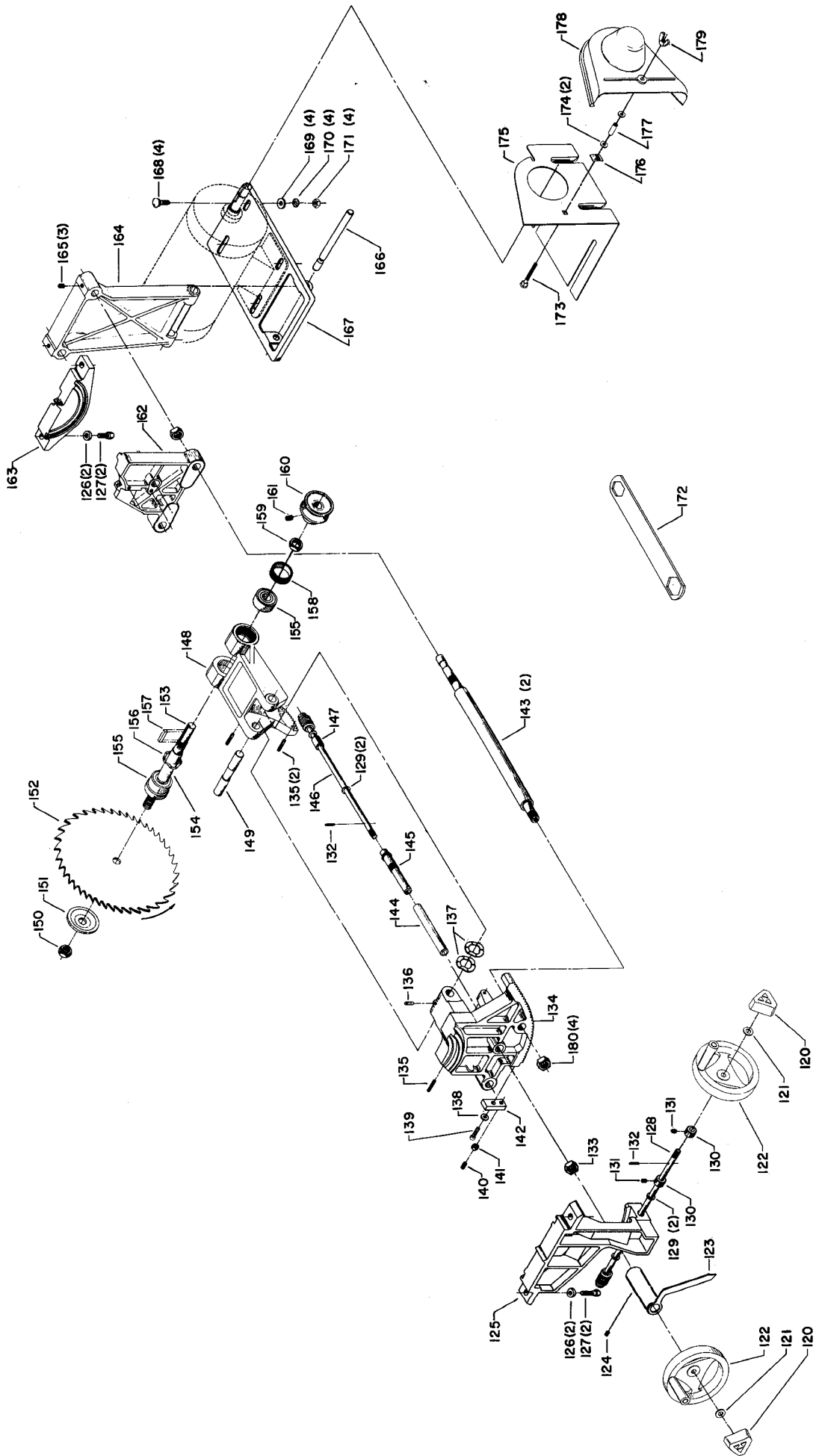

REPLACEMENT PARTS

| REF. NO. | PART NO. | DESCRIPTION | REF. NO. | PART NO. | DESCRIPTION |
|----------|-----------------|----------------------------------|----------|-----------------|-------------------------------------|
| 120 | 422-03-138-0001 | Knob | 160 | 41-023 | Arbor Pulley, Incl: |
| 121 | 904-07-020-5556 | Washer | 161 | 901-04-150-0206 | 5/16-18 x 5/16" Socket Set Screw |
| 122 | 1086491 | Handwheel | 162 | 422-19-095-0002 | Rear Trunnion |
| 123 | 1087911 | Pointer Assy, Incl: | 163 | 422-02-014-0010 | Rear Trunnion Bracket |
| 124 | 901-04-150-0208 | 1/4-20 x 1/4" Socket Set Screw | * | 1087908 | Motor Bracket Assy., Const. of: |
| 125 | 1087233 | Front Trunnion Bracket | 164 | 422-19-014-0002 | Motor Bracket |
| 126 | 904-01-010-1620 | 5/16" Flat Washer | 165 | 901-04-141-9152 | Motor Plate Rod |
| 127 | 901-01-060-0608 | 5/16-18 x 7/8" Hex Head Screw | 166 | 422-03-108-0005 | Motor Plate |
| 128 | 1087893 | Tilt Shaft Assembly, Incl: | 167 | 422-02-089-0005 | 5/16-18 x 3/4" Carriage Bolt |
| ** | 905-01-010-2716 | 1/8 x 9/16" Roll Pin | 168 | 901-11-020-0834 | 5/16" Flat Washer |
| 129 | 904-07-020-5554 | Fiber Washer | 169 | 904-01-010-1620 | 5/16" Ext. Tooth Lockwasher |
| 130 | 426-03-388-0001 | Set Collar, Incl: | 170 | 904-03-030-1656 | 5/16-18 Hex Nut |
| 131 | 901-04-150-0208 | 1/4-20 x 1/4" Socket Set Screw | 171 | 902-01-010-1300 | Wrench |
| 132 | 905-01-010-2711 | 1/8 x 5/8" Roll Pin | 172 | 1087708 | Belt and Pulley Guard, Const. of: |
| 133 | 902-01-200-9846 | Special Nut | * | 34-965 | 1/4-20 x 1 3/4" Carriage Bolt |
| 134 | 422-19-095-0001 | Front Trunnion | 174 | 904-01-010-1614 | 1/4" Flat Washer |
| 135 | 905-01-017-2710 | 3/16 x 7/8" Roll Pin | 175 | 1088314 | Guard Plate |
| 136 | 901-04-141-9152 | 1/4-20 x 5/16" Hex Soc Set Screw | 176 | 1088385 | Speed Nut |
| 137 | 928-06-010-7381 | Spring Washer | 177 | 424-03-017-0003 | Spacer |
| 138 | 904-01-010-1614 | 1/4" Flat Washer | 178 | 1088315 | Guard Cover |
| 139 | 901-03-010-0755 | 1/4-20 x 3/4" Socket Head Screw | 179 | 902-04-010-1402 | 1/4-20 Wing Nut |
| 140 | 901-04-170-0230 | 1/4-20 x 3/4" Socket Set Screw | 180 | 902-01-020-1226 | 5/16-18 Hex Jam Nut |
| 141 | 902-01-120-1034 | 1/4-20 Hex Nut | ** | 41-043 | Motor Pulley |
| 142 | 422-02-088-0001 | Stop Block | ** | 49-034 | V-Belt |
| 143 | 1087895 | Tie Bar | | | |
| 144 | 422-19-104-0001 | Spacer | | | |
| 145 | 422-02-105-0001 | Sleeve | | | |
| 146 | 1087882 | Elevating Shaft, Incl: | | | |
| ** | 905-01-010-2716 | 1/8 x 9/16" Roll Pin | | | |
| 147 | 1087087 | Spacer | ** | 50-315 | Steel Stand, const. of: |
| 148 | 422-02-014-0017 | Arbor Bracket | ** | 436-02-066-0018 | (4) Legs |
| 149 | 952-01-101-3267 | Shaft | ** | 436-02-115-0073 | Shelf |
| 150 | 902-01-200-9848 | 5/8-12 L.H. Arbor Nut | ** | 901-02-030-0408 | (24) 5/16-18 x 3/4" Flat Head Screw |
| 151 | 422-04-103-5001 | Flange | ** | 902-01-010-1300 | (24) 5/16-18 Hex Nuts |
| 152 | 34-105 | 10" Combination Blade | ** | 1086897 | (2) 20" Tie Bars |
| 153 | 422-03-303-0007 | Arbor w/Flange | ** | 1086898 | (2) 22 1/2" Tie Bars |
| 154 | 1087857 | Spacer | * | | NOT SHOWN ASSEMBLED |
| 155 | 1086894 | Bearing | ** | | NOT SHOWN |
| 156 | 928-06-020-7382 | Load Spring | | | |
| 157 | 927-03-010-2662 | Key | | | |
| 158 | 902-07-020-7176 | Spanner Nut | | | |
| 159 | 902-01-200-9847 | Special Nut | | | |

NOT INCLUDED WITH BASIC MACHINE

This parts list is provided to aid in obtaining service parts. Operational and maintenance information is contained in a separate owner's manual which is available through your local service outlet.