

# DUO-FAST

NAIPLERS STAPLERS FASTENERS  
**SUPER SureShot**

## CS-5000

1011916

DUO-FAST CORPORATION  
 AN ITW COMPANY  
 2400 GALVIN DRIVE  
 ELGIN, ILLINOIS 60123-7883  
 U.S.A.

08/02

© 2002 DUO-FAST Corporation

CS-186-5000

\*Part of CT-310-P3

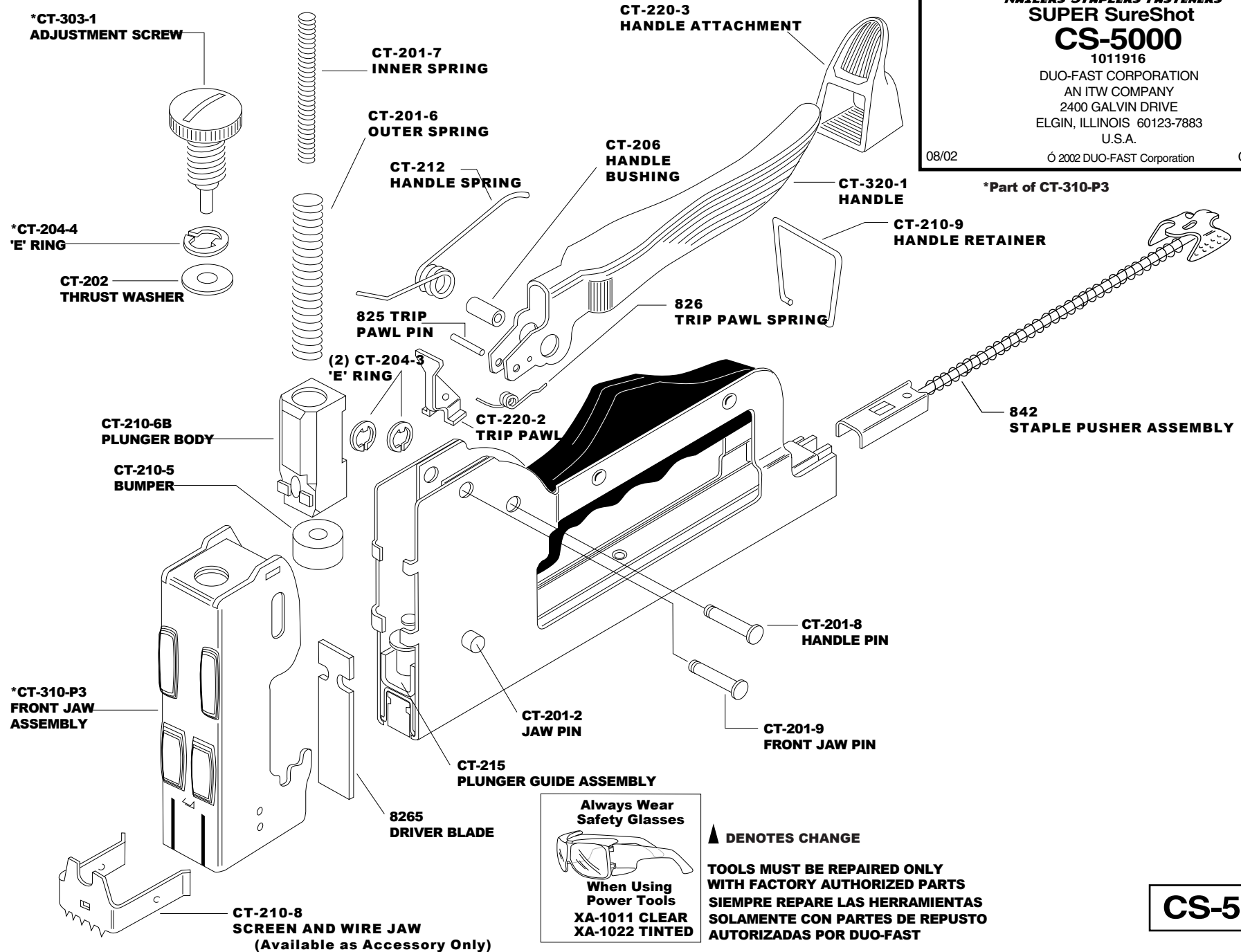

# CS-5000

UPDATE

10/03/2008

DUOF

PARTS CS-5000

63

KEY Nr.	Item code	Old code	Suppl.ref	Item (descr.english)
000	309103	W825	381632	(OBS)PIN,TRIP PAWL 825
000	309104	W826	381640	SPRING,TRIP PAWL 826
000	309105	W8265	386664	DRIVER BLADE 8265
000	309111	W842	381905	PUSHER ASSY. 842
000	309479	WCT2012	437814	PIN,JAW (CS-5000) CT-201-2
000	309482	WCT2016	437855	SPRING,OUTER CT-201-6
000	309483	WCT2017	437863	SPRING,INNER CT-201-7
000	309484	WCT2018	441790	PIN,HANDLE CT-201-8
000	309485	WCT2019	178111	PIN,FRONT JAW CT-201-9
000	309486	WCT202	437871	WASHER,THRUST CT-202
000	309488	WCT206	437897	BUSHING,HANDLE (CS-5000) CT-206
000	309491	WCT2106B	236588	BODY,PLUNGER CT-210-6B
000	309493	WCT2109	178129	RETAINER,HANDLE (CS-5000) CT-210-9
000	309495	WCT212	437947	SPRING,HANDLE CT-212
000	309496	WCT215	438275	(OBS)GUIDE,PLUNGER ASSY. CT-215
000	309498	WCT2202	437962	PAWL,TRIP CT-220-2
000	309499	WCT2203	455733	ATTACHMENT,HANDLE CT-220-3
000	392851	WCT2105	442434	BUMPER (CT-859A,CS-5000) CT-210-5
000	615072	WCT2044	437830	E-RING CT-204-4
000	615281	WCT3031	1011912	SCREW,ADJUSTMENT CT-303-1
000	615404	WCT2043	437822	E-RING CT-204-3
<b>Count:</b>	<b>21</b>			

<u>UNIQUE #</u>	<u>PART NO.</u>	<u>DESCRIPTION</u>	<u>REPLACES</u>
0381632	825	TRIP PAWL PIN	_____
0381640	826	TRIP PAWL SPRING	_____
0381905	842	STAPLE PUSHER ASSEMBLY	_____
0386664	8265	DRIVER BLADE	_____
0437814	CT-201-2	JAW PIN	_____
0437855	CT-201-6	OUTER SPRING	_____
0437863	CT-201-7	INNER SPRING	_____
0441790	CT-201-8	HANDLE PIN	_____
0178111	CT-201-9	FRONT JAW PIN	_____
0437871	CT-202	THRUST WASHER	_____
0437822	CT-204-3	E-RING	_____
0437830	CT-204-4	E-RING	_____
0437897	CT-206	HANDLE BUSHING	_____
0442434	CT-210-5	BUMPER	_____
0236588	CT-210-6B	PLUNGER BODY	_____
0178129	CT-210-9	HANDLE RETAINER	_____
0437947	CT-212	HANDLE SPRING	_____
0438275	CT-215	PLUNGER GUIDE ASSEMBLY	_____
0437962	CT-220-2	TRIP PAWL	_____
0455733	CT-220-3	HANDLE ATTACHMENT	_____
1011912	CT-303-1	ADJUSTMENT SCREW	_____
1011913	CT-320-1	HANDLE	_____
1011917	XH-108-80	MODEL LABEL	_____
<b>ACCESSORIES</b>			
0440925	CT-210-8	SCREEN AND WIRE JAW	_____
1014271	* CT-310-P3	* FRONT JAW ASSEMBLY	<u>CT-310-4</u>

\* = NEW PART

> = PART CHANGE