

ELECTRIC TOOL PARTS LIST

■ CIRCULAR SAW
Model C 7SA

1990 · 10 · 20
C 7SA(E4)

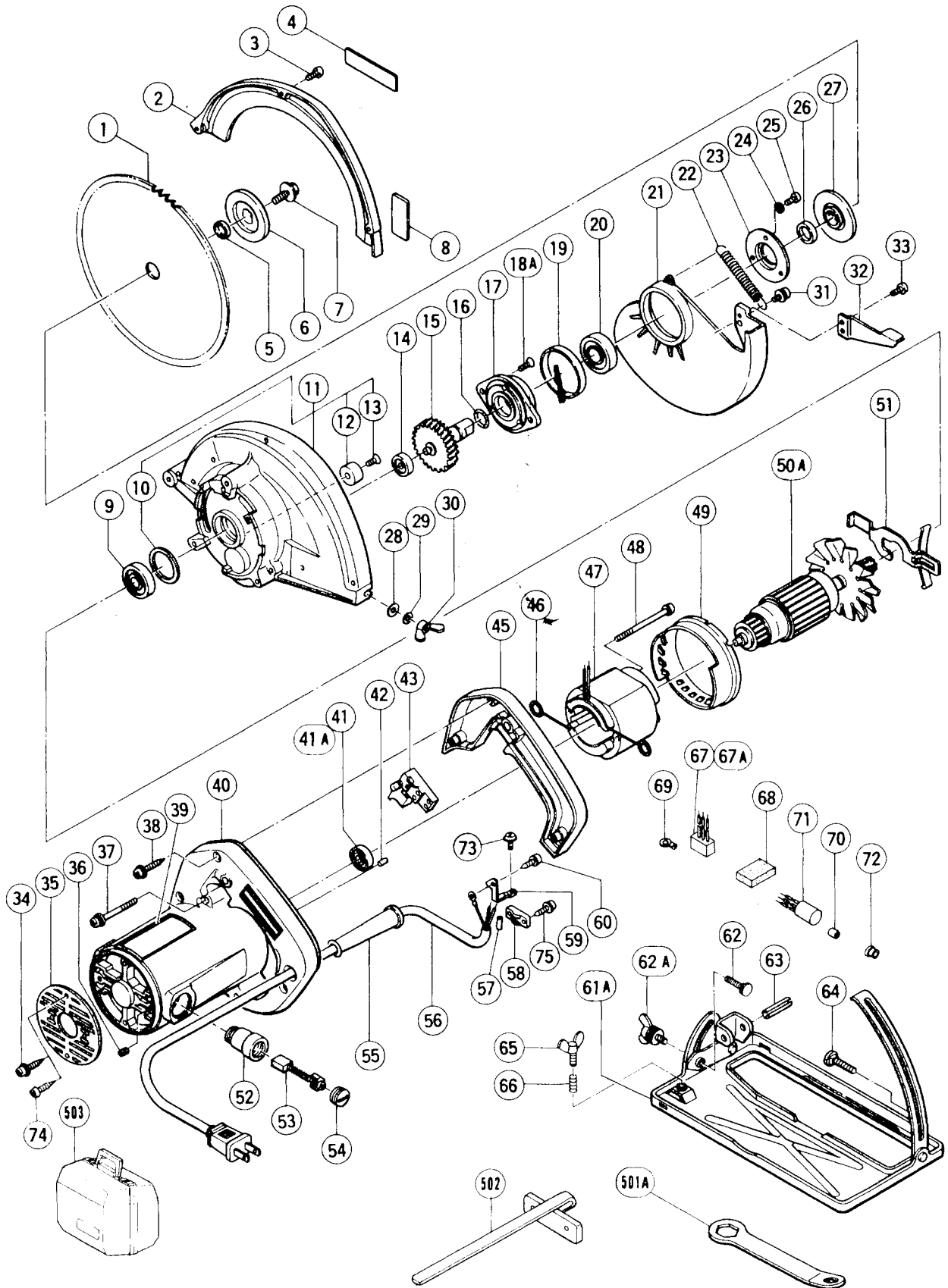

PARTS

C 7SA

ITEM NO.	CODE NO.	DESCRIPTION	NO. USED	REMARKS	
*	1	879-139	SAW BLADE (COMBINATION) 185MM - D19 HOLE	1	
*	1	990-090	SAW BLADE (COMBINATION) 185MM - D16 HOLE	1	
	2	990-095	SAW COVER ASS'Y	1	INCLUD.4
	3	949-219	MACHINE SCREW M4X16 (10 PCS.)	3	
	4	983-865	HITACHI LABEL	1	
*	5	990-100	RING D15.9/I.D14.5	1	FOR USA,CHI,CAN
	6	957-064	WASHER (B)	1	
	7	957-749	BOLT (W/WASHER)	1	
	8	958-052Z	CAUTION PLATE (ENGLISH)	1	TILL 1.1987
	9	600-1VV	BALL BEARING 6001VVMCPS2L	1	
	10	958-130	RUBBER RING	1	
*	11	990-094	GEAR COVER ASS'Y	1	INCLUD.10,12,13
*	11	990-110	GEAR COVER ASS'Y	1	INCLUD.10,12,13 FOR CAN
	12	961-729	CUSHION	1	
	13	949-794	FLAT HD. SCREW M6X20 (10 PCS.)	1	
	14	954-612	METAL	1	
*	15	957-059	SPINDLE GEAR	1	
*	15	990-096	SPINDLE GEAR	1	FOR USA,CHI,CAN
	16	873-095	O - RING (P - 16)	1	
	17	940-867	BEARING HOLDER	1	
	18A	990-299	SEAL LOCK FLAT HD. SCREW M5X10	2	
	19	961-807Z	BUSHING	1	
	20	620-2VV	BALL BEARING 6202VVMCPS2S	1	
	21	990-097	SAFETY COVER	1	
	22	957-062	RETURN SPRING	1	
	23	940-868	BEARING CAP	1	
	24	949-453	SPRING WASHER M4 (10 PCS.)	3	
	25	949-218	MACHINE SCREW M4X10 (10 PCS.)	3	
	26	961-366	DISTANCE PIECE	1	
*	27	963-757Z	WASHER (A)	1	FOR D19 HOLE
*	27	990-099	WASHER (A)	1	FOR D16 HOLE FOR USA,CHI,CAN
	28	949-425	WASHER M6 (10 PCS.)	1	
	29	949-455	SPRING WASHER M6 (10 PCS.)	1	
	30	949-313	WING NUT M6 (10 PCS.)	1	
	31	986-723	MACHINE SCREW (W/WASHERS) M4X8	1	
	32	990-098	LEVER	1	
	33	949-215	MACHINE SCREW M4X8 (10 PCS.)	1	
*	34	930-446	TAPPING SCREW (W/WASHER) D4X16	2	EXCEPT FOR CAN
*	35	990-093	TAIL COVER	1	
*	35	990-109	TAIL COVER	1	FOR CAN
	36	962-782	HEX. SOCKET SET SCREW M5X6	2	
	37	990-105	MACHINE SCREW (W/WASHERS) M5X45	3	
	38	956-636	TAPPING SCREW (W/WASHER) D4X25	3	
	39		NAME PLATE	1	
	40	954-580H	HOUSING ASS'Y (GREEN)	1	INCLUD.3652
	41	627-VVM	BALL BEARING 627VVMC2EPS2S	1	TILL 9.1986
	41A	608-VVM	BALL BEARING 608VVMC2EPS2L	1	SINCE 10.1986
	42	931-701	BEARING LOCK	1	
	43	963-756Z	SWITCH (2P PILLAR TYPE) W/SAFETY LOCK	1	
	45	954-585H	HANDLE COVER (GREEN)	1	
	46	930-703	BRUSH TERMINAL	2	

*: ALTERNATIVE PARTS

10 - 90

PARTS

C 7SA

ITEM NO.	CODE NO.	DESCRIPTION	NO. USED	REMARKS
* 47	958-128J	STATOR ASS'Y 115V	1	INCLUD.46
* 47	990-106E	STATOR ASS'Y 220V - 230V	1	INCLUD.46
* 47	990-106F	STATOR ASS'Y 240V	1	INCLUD.46
* 47	990-106G	STATOR ASS'Y 230V	1	INCLUD.46 FOR SAF
* 47	990-106H	STATOR ASS'Y 230V	1	INCLUD.46 FOR NZL
48	943-430	MACHINE SCREW (W/SP.WASHER) M5X60	2	
49	987-940	FAN GUIDE	1	
* 50A	990-112U	ARMATURE ASS'Y 115V	1	INCLUD.9,41A
* 50A	990-112E	ARMATURE 220V - 230V	1	
* 50A	990-112F	ARMATURE 240V	1	
* 50A	990-112G	ARMATURE 230V	1	FOR SAF
51	987-981	LOCK LEVER	1	
52	957-051	BRUSH HOLDER	2	
53	999-043	CARBON BRUSH (1 PAIR)	2	
54	935-829	BRUSH CAP	2	
* 55	953-327	CORD ARMOR D8.8	1	
* 55	938-051	CORD ARMOR D10.1	1	
* 56	500-201Z	CORD	1	(CORD ARMOR D10.1)
* 56	500-223Z	CORD	1	(CORD ARMOR D10.1) FOR SIN
* 56	500-226Z	CORD	1	(CORD ARMOR D8.8) FOR NZL
* 56	500-245Z	CORD	1	(CORD ARMOR D10.1) FOR SYR
* 56	500-409Z	CORD	1	(CORD ARMOR D8.8) FOR INA
* 56	500-413Z	CORD	1	(CORD ARMOR D10.1) FOR USA,CAN
* 56	958-271Z	CORD	1	(CORD ARMOR D8.8) FOR SAF
57	981-373	TUBE (D)	2	
58	937-631	CORD CLIP	1	
* 59	990-103	EARTH PLATE	1	FOR USA
* 59	990-108	EARTH PLATE	1	FOR CAN
* 60	990-104	TAPPING SCREW (W/SP.WASHER) D4X12	1	FOR USA,CAN
* 61A	990-101	BASE ASS'Y	1	INCLUD.62A
* 61A	957-060	BASE ASS'Y	1	INCLUD.62A,65,66 FOR NZL
62	942-808	BOLT (SQUARE) M6X20	1	TILL 7.1985
62A	990-316	WING BOLT (W/WASHERS) M6	1	SINCE 8.1985
63	949-515	ROLL PIN D6X30 (10 PCS.)	1	
64	957-073	BOLT (SQUARE) M6X25	1	
* 65	941-055	WING BOLT M6X15	1	FOR NZL
* 66	941-056	SPRING	1	FOR NZL
* 67	500-262Z	NOISE SUPPRESSOR	1	FOR SAF
* 67A	994-273	NOISE SUPPRESSOR	1	FOR NZL
* 68	930-153	SUPPORT (B)	1	FOR NZL,SAF
* 69	961-419Z	TERMINAL	1	FOR NZL,SAF
* 70	981-373	TUBE (D)	2	FOR NZL,SAF
* 71	980-685	CHOKE COIL	1	FOR NZL
* 72	959-140	CONNECTOR 50091 (10 PCS.)	1	FOR NZL
* 73	958-523	MACHINE SCREW (W/SP.WASHER) M4X8	1	FOR CAN
* 74	982-034	TAPPING SCREW (W/WASHER) D4X12	2	FOR CAN
75	984-750	TAPPING SCREW (W/FLANGE) D4X16	2	

STANDARD ACCESSORIES

C 75A

ITEM NO.	CODE NO.	DESCRIPTION	NO. USED	REMARKS	
* 501A	957-421	WRENCH (HEX. SOCKET 10/19.2MM)	1		
* 502	984-984	GUIDE	1	FOR NZL	

OPTIONAL ACCESSORIES

ITEM NO.	CODE NO.	DESCRIPTION	NO. USED	REMARKS	
601	990-091	GUIDE ASS'Y	1	INCLUD.602,603	
602	941-055	WING BOLT M6X15	1		
603	941-056	SPRING	1		
604	990-092	SIDE HANDLE ASS'Y	1	INCLUD.605-610	
605	957-071	PLATE	1		
606	949-458	SPRING WASHER M10 (10 PCS.)	1		
607	949-560	NUT M10 (10 PCS.)	1		
608	949-237	MACHINE SCREW M5X12 (10 PCS.)	2		
609	949-454	SPRING WASHER M5 (10 PCS.)	2		
610	981-828	SIDE HANDLE	1		