

TORQUE TO 60-70 IN-LBS

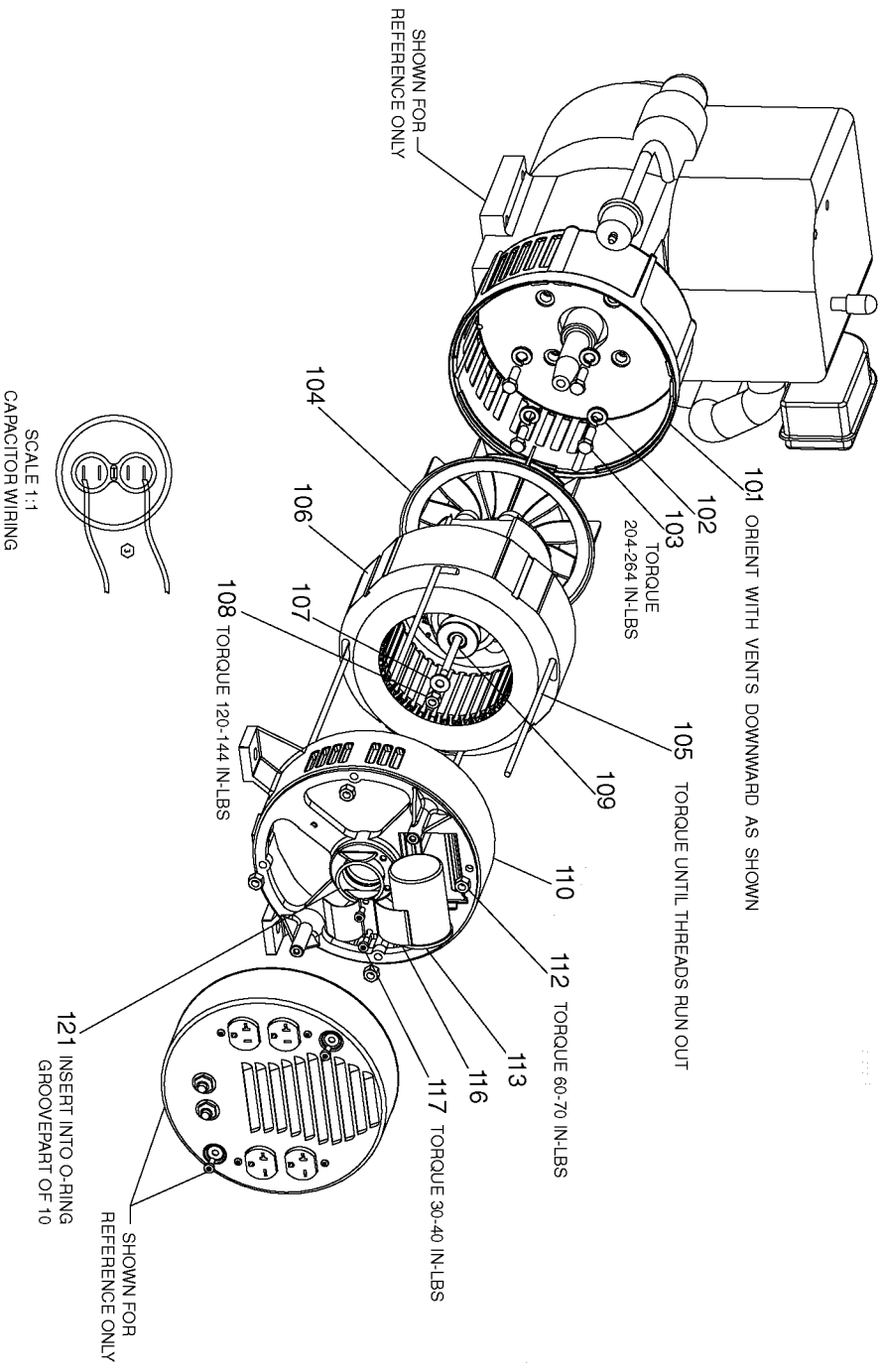

## Parts List for BS600-W Type 1

Item Number	Part Number	Description	Qty Required
1	Z-GS-0795	TANK FUEL 7G SS	1
5	GS-0433	ISOLATOR	1
6	GS-0033	ISOLATOR VIBRATION 1	1
7	D22311	SCREW .313-18X.875 U	1
10	95829230	SCREW .313-18X1.50 H	1
11	SSF-8150	NUT .312-18 UNC HEX	1
12	SS-12-CD	SCREW .313-18X.750 H	1
13	N017772	LOCK WASHER	1
14	GS-0118	STRAP GROUND	1
16	000000-00	No Longer Available	1
17	000000-00	No Longer Available	1
20	GS-0443	CAP FUEL TANK	1
22	91895680	SCREW .250-20X.750 H	1
25	GS-0117	LUG GROUND	1
30	SSF-553-1	SCREW #10-24X.563 TH	1
31	GS-0077	COVER END BLANK	1
33	Z-A14582	HOSE FUEL	1
34	GS-0227	CLAMP FUEL .50	1
35	GS-0437	DRAIN COCK	1
36	N103455	GROMMET	1
42	SSF-575	NUT .250-20 HEX W/KE	1
43	330016-13	WASHER	1
44	000000-00	No Longer Available	1
45	000000-00	No Longer Available	1
49	SSN-632	WASHER .875 OD .375	1
52	000000-00	No Longer Available	1
101	000000-00	No Longer Available	1

## Parts List for BS600-W Type 1

Item Number	Part Number	Description	Qty Required
102	SSN-619	WASHER .375 SPRING L	1
103	SSF-577	SCREW .375-16X1.00 H	1
104	Z-D26598	ASSY GEN 2.759 120/2	1
104	D27092	KIT SERVICE FOCUS MO	1
105	000000-00	No Longer Available	1
106	Z-D26598	ASSY GEN 2.759 120/2	1
106	D27092	KIT SERVICE FOCUS MO	1
107	330016-13	WASHER	1
108	SSF-576	NUT .313-24 HEX W/KE	1
109	000000-00	No Longer Available	1
110	Z-GS-0861	KIT ORING BEARING SU	1
112	SSF-575	NUT .250-20 HEX W/KE	1
113	GS-0592	CAPACITOR 35uF 3% 37	1
116	GS-0595	BRACKET CAPACITOR 2.	1
117	SSF-553-1	SCREW #10-24X.563 TH	1
121	GS-0862	O-RING ROTOR BEARING	1
141	GS-0455	RECEPTACLE 4 PRONG 3	1
142	D21508	BREAKER CIRCUIT	1
143	Z-D20573	BREAKER CIRCUIT 125/	1
144	GS-0045	SWITCH FULL POWER	1
145	GS-0046	SWITCH OFF - ON / ST	1
146	GS-0644	RECEPTACLE GFCI 120V	1
148	SSF-595	NUT .438-28 UNEF HEX	1
149	SSF-583	SCREW #6-32X.500 PAN	1
150	SSF-3156	SCREW #10-9X.500 THD	1
151	SSF-584	NUT #6-32 SPEED SELF	1
153	000000-00	No Longer Available	1

## Parts List for BS600-W Type 1

Item Number	Part Number	Description	Qty Required
154	D26113	CLAMP MOLDED STRESS	1