



SERVICE PARTS LIST

BULLETIN NO.
54-02-1100

SPECIFY CATALOG NO. AND SERIAL NO. WHEN ORDERING PARTS		REVISED BULLETIN	DATE
500 LB. ELECTRIC WIRE ROPE			Oct. '90
CATALOG NO.	9555	SERIAL NUMBER	4-86
		WIRING INSTRUCTION 58-01-0976	

00
0

EXAMPLE:
Component Parts (Small #) Are Included
When Ordering The Assembly (Large #).

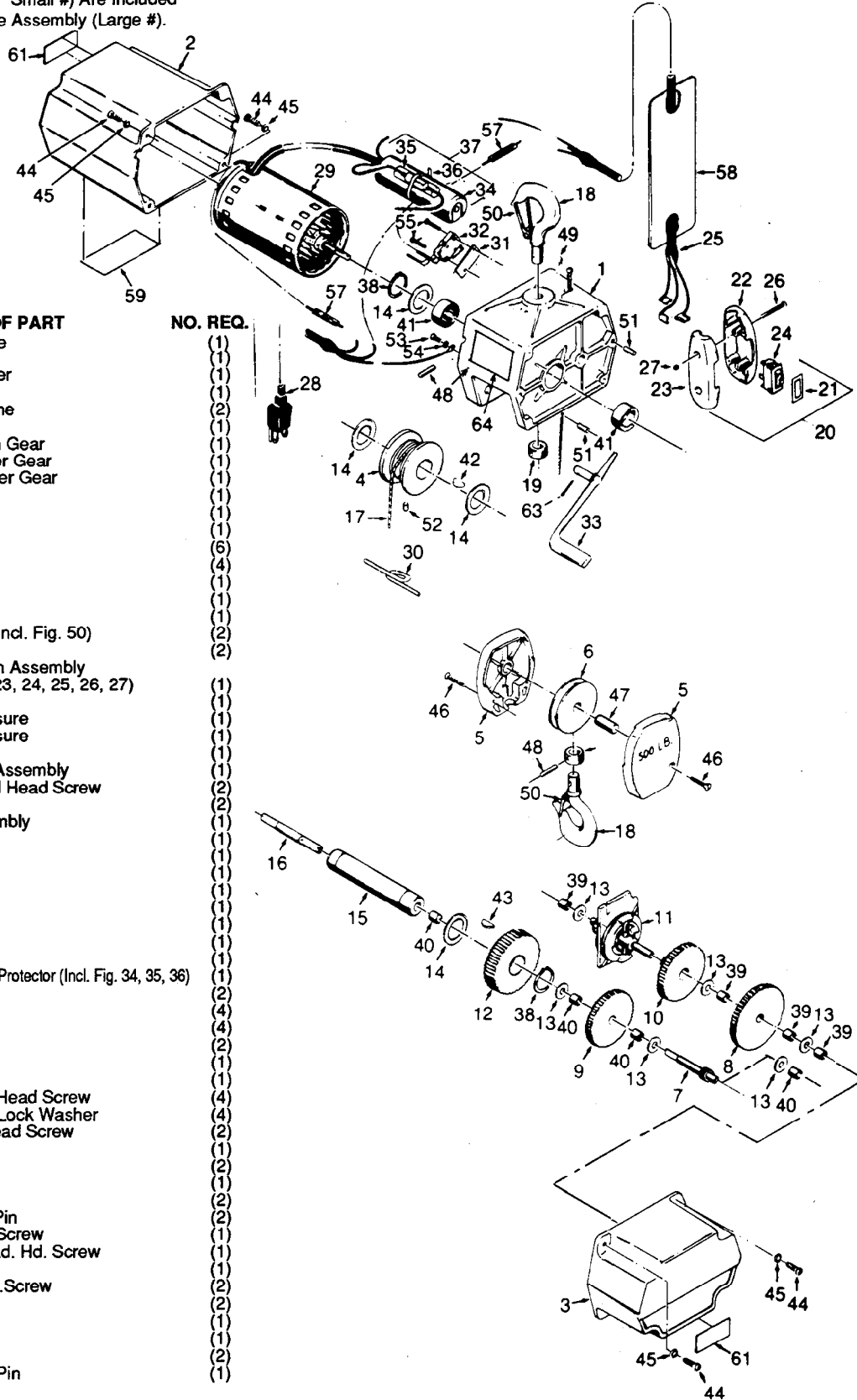

FIG.	PART NO.	DESCRIPTION OF PART	NO. REQ.
1	43-40-0215	Suspension Frame	(1)
2	42-92-0655	Control Cover	(1)
3	42-92-0660	Transmission Cover	(1)
4	43-11-0050	Drum	(1)
5	43-40-0220	Bottom Block Frame	(2)
6	45-11-0100	Sheave	(1)
7	32-60-2290	High Speed Pinion Gear	(1)
8	32-60-2295	High Speed Cluster Gear	(1)
9	32-60-2300	Intermediate Cluster Gear	(1)
10	32-06-0020	Load Brake Gear	(1)
11	14-04-0020	Brake Assembly	(1)
12	32-60-2305	Output Gear	(1)
13	45-88-8070	Thrust Washer	(6)
14	45-88-8075	Thrust Washer	(4)
15	36-90-0110	Drum Shaft	(1)
16	42-90-0230	Drive Coupling	(1)
17	14-05-0010	Cable Assembly	(1)
18	14-36-0150	Hook With Latch (Incl. Fig. 50)	(2)
19	42-76-0420	Hook Collar	(2)
20	23-37-0130	Pushbutton Station Assembly	(1)
21	10-37-0020	Up-Down Label	(1)
22	22-12-0210	Pushbutton Enclosure	(1)
23	22-12-0220	Pushbutton Enclosure	(1)
24	23-66-1530	Rocker Switch	(1)
25	22-60-2910	Pushbutton Cord Assembly	(1)
26	06-81-3350	#4-48 x 1-1/4 Oval Head Screw	(2)
27	06-57-1000	#4-48 Locknut	(2)
28	22-64-2840	Power Cord Assembly	(1)
29	23-30-0200	Motor	(1)
30	43-56-0410	Cable Guide	(1)
31	43-86-0120	Insulator	(1)
32	23-66-1540	Switch	(1)
33	31-92-0260	Paddle	(1)
34	22-33-0310	Capacitor	(1)
35	22-89-0200	Thermal Fuse	(1)
36	45-56-0220	Tie Strap	(1)
37	22-33-0320	Capacitor W/Thermal Protector (Incl. Fig. 34, 35, 36)	(1)
38	34-60-2460	Retaining Ring	(2)
39	42-24-0405	Bearing	(4)
40	42-24-0410	Bearing	(4)
41	02-04-5070	Bearing	(2)
42	06-42-3710	Woodruff Key	(1)
43	06-42-3760	Woodruff Key	(1)
44	06-81-5695	#10-24 x 5/8 Pan Head Screw	(4)
45	06-97-3500	#10-24 Split Ring Lock Washer	(4)
46	06-95-0358	#10-24 x 1 Flat Head Screw	(2)
47	06-65-3630	1/2 x 1 Dowel Pin	(1)
48	44-60-0980	Hook Pin	(2)
49	44-68-0520	Plug	(1)
50	14-47-0570	Latch Kit	(2)
51	06-65-3625	3/16 x 1/2 Dowel Pin	(2)
52	06-83-1200	5/16-18 x 1/4 Set Screw	(1)
53	06-81-4570	#8-32 x 3/8 Phil. Rd. Hd. Screw	(1)
54	45-88-8080	#8 Flat Washer	(1)
55	06-81-4460	#4-40x3/4 Rd. Hd.Screw	(2)
57	22-56-0545	Connector	(2)
58	10-98-6570	Warning Label	(1)
59	10-98-6575	Warning Label	(1)
61	10-37-0030	Capacity Label	(2)
63	44-60-1010	1/16 x 3/4 Cotter Pin	(1)