



## Parts List for #709209 Folding Adjustable Roller Stand

Use the photo at right to assist in assembling the stand.

### Tools Required for Assembly:

- Cross-Point Screwdriver – [used on screw #9]
- 10mm (or adjustable) wrench – [used to hold nut #10]
- Rubber mallet – [used to install caps #6]
- 5mm hex key (provided) – [used on screw #8]

Notes: The Sliding Post (#2) may have holes through one end. These were used for the manufacturing process and will not be used during operation of the stand; rotate them out of the way of the locking screws. The roller (#5) has a spring shaft, and can be removed from the frame by pressing in one end of the shaft.

Index No.	Part No.	Description	Qty.
1	874701	Base	1
2	874702	Sliding Post	1
3	874703	Support Leg	1
4	874705	Roller Support	1
5	874706	Roller	1
6	874707	Cap	4
7	874108	Knob	1
8	TS-0207021	Socket Head Cap Screw, 1/4"-20 x 1/2"	1
9	874109	Pan Head Machine Screw, 1/4"-20 x 2"	1
10	35102C	Cap Nut, 1/4"-20	1
11	6290810	Hex Key 5mm (not shown)	1

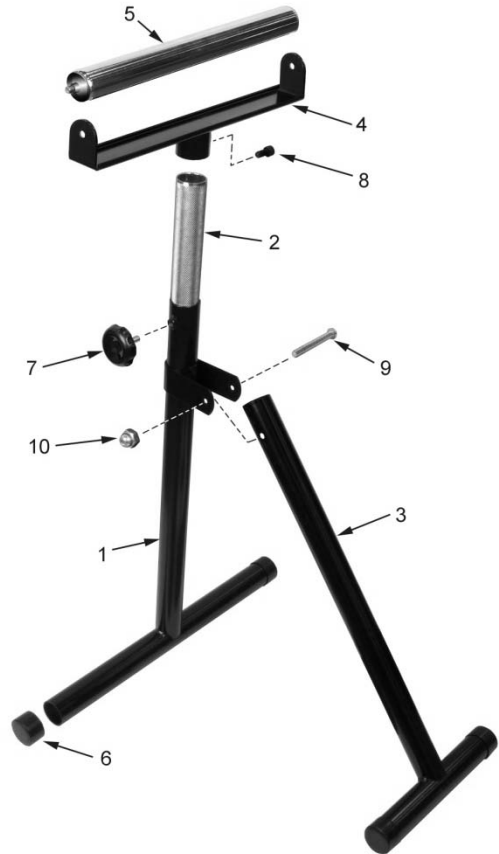

### Specifications

Stock Number .....	709209
Loading Capacity .....	200 lbs. (90kg)
Minimum Height, floor to top of Roller .....	25-1/2 in. (648mm)
Maximum Height, floor to top of Roller .....	42 in. (1067mm)
Roller Diameter .....	1-3/8 in. (35mm)
Roller Length .....	12-1/2 in. (320mm)
Spring Shaft Diameter .....	1/4 in. (6.35mm)
Net Weight .....	11 lbs. (5kg)
Shipping Weight .....	13.2 lbs. (6kg)

The above specifications were current at time of publication, but because of our policy of continuous improvement, JET reserves the right to change specifications at any time and without prior notice, without incurring obligations.

To order parts or reach our service department, call 1-800-274-6848 Monday through Friday (see our website for business hours). Having the Model Number and Serial Number of your product available when you call will allow us to serve you quickly and accurately.

### JET

427 New Sanford Road  
 LaVergne, Tennessee 37086  
 Ph.: 800-274-6848  
 www.jettools.com

**Part No. M-709209A**  
 Revision B 01/2014  
 Copyright © 2014 JET