



SERVICE PARTS LIST

BULLETIN NO.
54-42-0098

SPECIFY CATALOG NO. AND SERIAL NO. WHEN ORDERING PARTS		REVISED BULLETIN 54-42-0097	DATE Nov. '96
MAGNUM SCREW-SHOOTER			
CATALOG NO. 6793-1	STARTING SERIAL NO. 695B	WIRING INSTRUCTION 58-01-1650	

EXAMPLE:
Component Parts
(Small #) Are
Included When
Ordering The
Assembly (Large #).

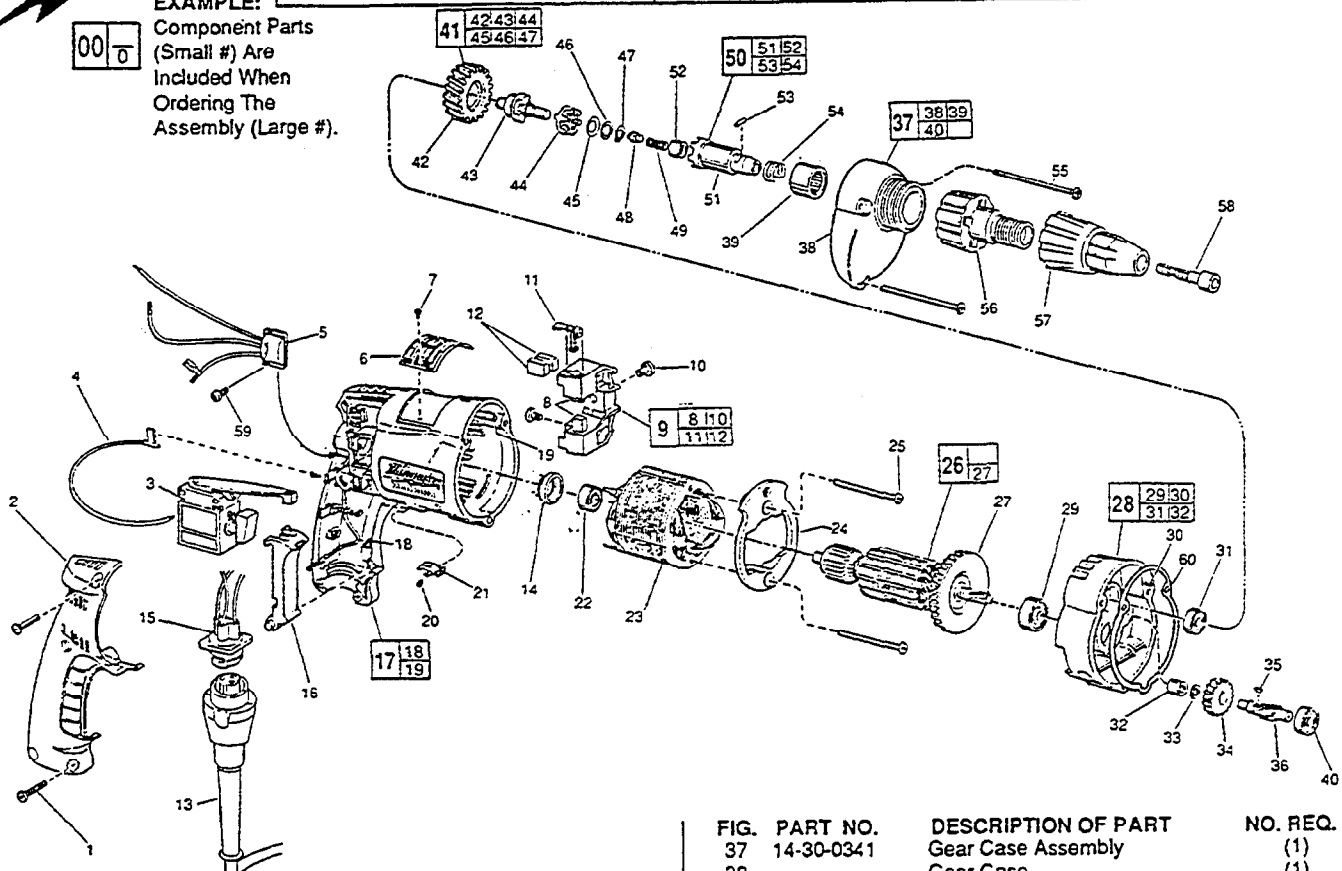

FIG.	PART NO.	DESCRIPTION OF PART	NO.	REQ.
	1	06-82-7266	7-18 x 11/16" Plastite T-20	(5)
	2	31-15-0402	Handle Cover	(1)
*	3	23-66-1666	Reversing Switch	(1)
*	4	23-94-6247	2-1/4" Lead Assembly	(1)
*	5	14-20-0795	Remote Electronic Assembly	(1)
	6	12-99-0081	Nameplate Blank	(1)
	7	06-72-1720	Nameplate Rivet	(2)
	8	22-16-0275	Carbon Brush	(2)
	9	22-22-0351	BrushHolder Assembly	(1)
	10	31-75-0040	Brush Holder Screw	(2)
	11	22-20-0345	Brush Spring Assembly	(2)
	12	22-16-0275	Carbon Brush (Spares)	(2)
	13	48-76-4008	Cord Set	(1)
	14	22-72-0100	Bearing Cup	(1)
*	15	22-56-0807	Pin Housing Assembly	(1)
*	16	45-72-0081	Trigger	(1)
	17	14-38-0540	Motor Housing Assembly	(1)
	18	23-94-9960	Ground Wire Assembly	(1)
	19	44-60-1290	Grounding Pin	(1)
	20	40-50-0085	Lock Button Spring	(1)
	21	42-42-0460	Lock Button	(1)
	22	02-04-0645	Ball Bearing	(1)
	23	18-11-0075	120 Volt Field	(1)
	24	42-14-0390	Baffle	(1)
	25	06-82-7398	7-18 x 2-1/16" Pan Hd. Plastite T-20	(2)
	26	16-10-0800	120 Volt Armature Assembly	(1)
	27	22-84-0880	Fan Assembly	(1)
	28	14-13-0501	Diaphragm Assembly	(1)
	29	02-04-0847	Ball Bearing	(1)
	30	06-65-0880	Ground Pin	(1)
	31	02-04-0645	Ball Bearing	(1)
	32	02-50-1620	Needle Bearing	(1)
	33	45-88-7721	Heat Treated Washer	(1)
	34	32-40-1815	Intermediate Gear	(1)
	35	06-42-0400	Woodruff Key	(1)
	36	36-66-4280	Intermediate Pinion	(1)

FIG.	PART NO.	DESCRIPTION OF PART	NO.	REQ.
	37	14-30-0341	Gear Case Assembly	(1)
	38		Gear Case	(1)
	39	02-50-4050	Needle Bearing	(1)
	40	02-04-0640	Ball Bearing	(1)
	41	42-10-4030	Clutch Gear Assembly	(1)
	42	32-75-2940	Spindle Gear	(1)
	43	36-14-0680	Gear Shaft	(1)
	44	42-70-5030	Drive Clutch	(1)
	45	45-88-0705	Spring Washer	(1)
	46	45-88-0550	Flat Washer	(1)
	47	34-60-0510	External Retaining Ring	(1)
	48	44-60-0500	Thrust Pin	(1)
	49	40-50-0080	Separator Spring	(1)
	50	14-73-0120	Chuck Shaft Assembly	(1)
	51	42-66-6770	Chuck Shaft	(1)
	52	02-50-1615	Needle Bearing	(1)
	53	02-55-0150	Loose Roller Bearing	(1)
	54	40-50-1450	Bit Retaining Spring	(1)
	55	06-82-7411	7-18 x 2-3/16" Pan Hd. T-20	(3)
	56	48-32-2500	Bit Housing	(1)
	57	49-26-0250	Locator 1/4" Hex Socket	(1)
		49-26-0312	Locator 5/16" Hex Socket	(1)
		49-26-0375	Locator 3/8" Hex Socket	(1)
	58	49-66-3016	5/16" Socket Extension - Magnetic	(1)
	59	06-82-7212	4-20 x 1/4" Pan Hd. Plastite T-10	(2)
	60	43-44-0913	Gasket	(1)
*		23-94-6232	4" Lead Assembly	(1)
*		23-94-6237	4-1/8" Lead Assembly	(1)
*		23-94-6242	3-3/8" Lead Assembly	(1)
		10-98-5986	Warning Label	(1)

FIG. LUBRICATION
38 1-1/2 Oz. Type "E" Grease, No. 49-08-4122.
Place Grease Near Intermediate Shaft Ball
Bearing in Gear Case.

MILWAUKEE ELECTRIC TOOL CORPORATION
13135 W. LISBON RD., BROOKFIELD, WI 53005