



SERVICE PARTS LIST

BULLETIN NO.
55-42-0361

SPECIFY CATALOG NO. AND SERIAL NO. WHEN ORDERING PARTS		REVISED BULLETIN 55-42-0360	DATE Jan. 2000
ADJUSTABLE TORQUE SCREWDRIVER			
CATALOG NO. 6783-50	STARTING SERIAL NO.	471B	
		WIRING INSTRUCTION 58-03-0028	

EXAMPLE:

00	0
----	---

 Component Parts (Small #) Are Included When Ordering The Assembly (Large #).

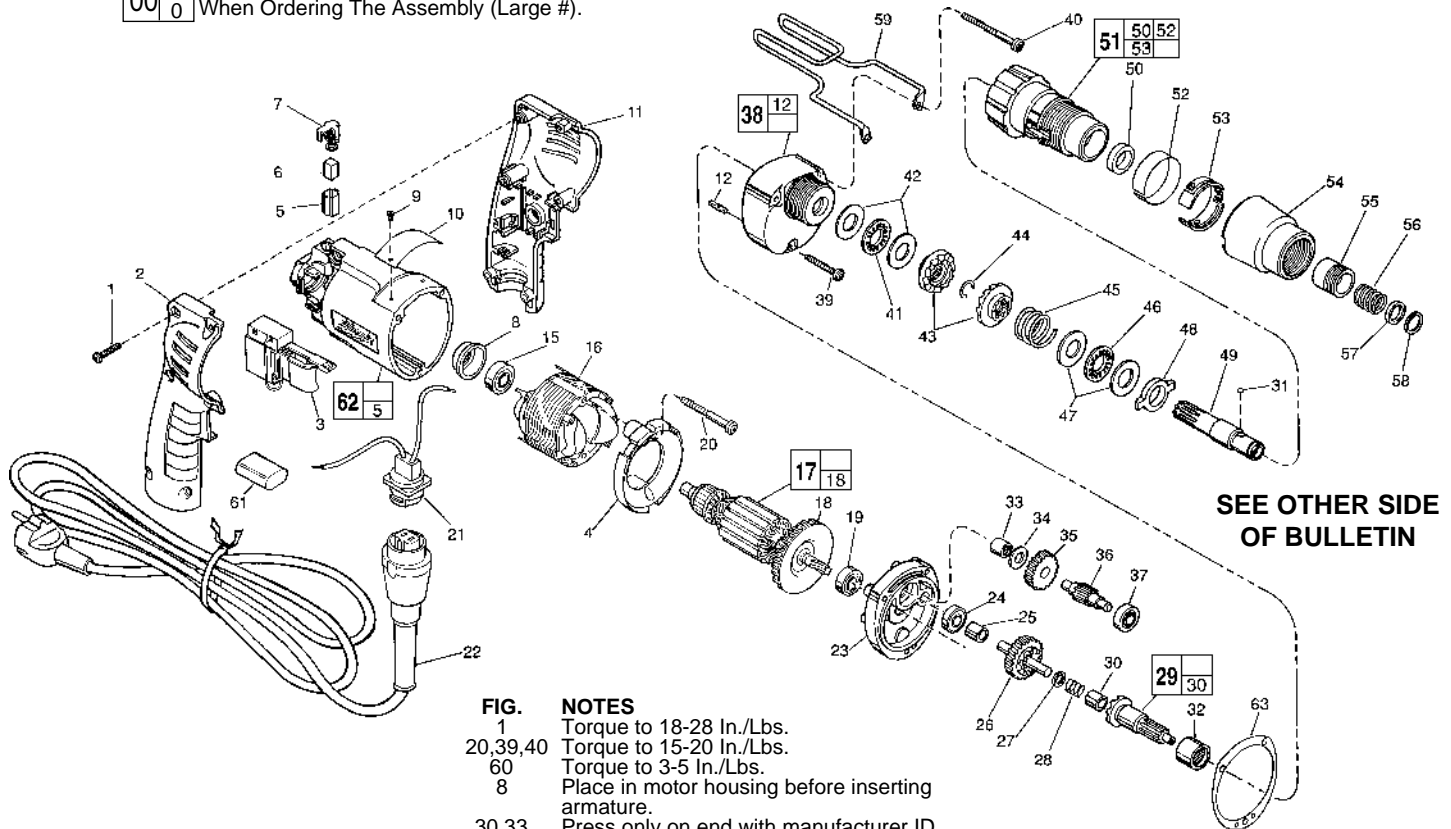

SEE OTHER SIDE OF BULLETIN

- FIG. NOTES**
- 1 Torque to 18-28 In./Lbs.
 - 20,39,40 Torque to 15-20 In./Lbs.
 - 60 Torque to 3-5 In./Lbs.
 - 8 Place in motor housing before inserting armature.
 - 30,33 Press only on end with manufacturer ID.
 - 33 Press flush to casting surface.
 - 30 Press 11/64" from clutch face.
 - 15, 19,24 Seal towards armature.

FIG. PART NO.	DESCRIPTION OF PART	NO. REQ.	FIG. PART NO.	DESCRIPTION OF PART	NO. REQ.
1	06-82-7284 8-16 x 3/4" Pan Hd. Slit. Plast. T-20	(6)	39	06-82-7344 7-18 x 1-1/2" Pan Hd. Slit. Plast. T-20	(1)
★ 2	31-44-1845 Right Handle Half	(1)	40	06-82-7464 7-18 x 2-3/4" Pan Hd. Slit. Plast. T-20	(2)
3	23-66-2075 TSC Switch	(1)	41	02-80-1200 Thrust Bearing	(1)
★ 3	4931 3648 01 Atlas Copco TSC Switch (Australia)	(1)	42	45-88-0510 Thrust Bearing Washer	(2)
4	42-14-0380 Baffle	(1)	43	42-70-5016 Drive Clutch	(2)
5	22-20-0830 Brush Tube	(2)	44	34-60-0545 Retaining Ring	(1)
6	22-16-0375 Carbon Brush	(2)	45	40-50-8000 Clutch Spring	(1)
7	23-52-1570 Brush Spring Assembly	(2)	46	02-80-6020 Thrust Bearing	(1)
8	22-72-0100 Bearing Cup	(1)	47	45-88-7150 Thrust Bearing Washer	(2)
9	06-72-1700 Nameplate Rivet	(2)	48	44-90-4280 Adjustment Ring	(1)
10	12-77-2800 Service Nameplate	(1)	49	42-66-0676 Chuck Shaft	(1)
★ 11	31-44-1840 Left Handle Half	(1)	50	45-06-0106 Oil Seal	(1)
12	06-65-0825 1/8 x 1/2 Groove Pin No. 5	(1)	51	14-08-0190 Clutch Housing Assembly	(1)
15	02-04-0645 Ball Bearing	(1)	52	10-79-3100 Torque Setting Label	(1)
16	18-12-0150 230 V. Field	(1)	53	42-16-0140 Adjustment Band	(1)
17	16-14-0690 230 V. Armature	(1)	54	42-76-0460 Adjustment Collar	(1)
18	22-84-0880 Fan Assembly	(1)	55	42-76-0390 Locking Collar	(1)
19	02-04-0851 Ball Bearing	(1)	56	40-50-8005 Compression Spring	(1)
20	06-82-7203 7-18 x 2-1/8" Pan Hd. Slit. Plastite T-20	(2)	57	45-36-1300 Spacer	(1)
★ 21	22-56-0696 Blade Housing Assembly	(1)	58	34-60-2390 Retaining Ring	(1)
★ 22	48-76-5012 Quik-Lok Cord Set	(1)	59	42-70-5080 Belt Clip	(1)
★ 22	22-64-0684 Quik-Lok Cord Set (Australia)	(1)	61	14-20-0530 Suppressor Assembly	(1)
23	28-28-1961 Diaphragm	(1)	62	14-38-0591 Motor Housing Assembly	(1)
24	02-04-0645 Ball Bearing	(1)	63	43-44-0925 Gasket	(1)
25	45-36-1280 Spacer	(1)	★ 49-66-3031 10mm Hex Socket	(1)	
26	32-10-4045 Clutch Gear Assembly	(1)			
27	45-88-0712 Thrust Washer	(1)			
28	40-50-6600 Separator Spring	(1)			
29	14-73-0250 Clutch Shaft Assembly	(1)			
30	02-50-2400 Needle Bearing	(1)			
31	02-02-0130 Steel Ball	(1)			
32	02-50-4225 Needle Roller Bearing	(1)			
33	02-50-2410 Needle Bearing	(1)			
34	45-88-7990 Thrust Washer	(1)			
35	32-40-1612 Intermediate Gear	(1)			
36	36-66-4101 Intermediate Pinion Shaft	(1)			
37	02-04-0640 Ball Bearing	(1)			
38	14-30-0600 Gear Case Assembly	(1)			

- FIG. LUBRICATION**
- 38 1-1/2 Oz. Type "E" Grease, No. 49-08-4122.
 - 43 1/16 Oz. Type "F" Grease, No. 49-08-4160 On Clutch Faces.
 - 41,46,50 Apply Small Amount Of "F" Grease, No. 49-08-4160.
 - 48 Apply Small Amount Of "F" Grease, No. 49-08-4160 On Tabs.

PARTS LIST IN ORDER OF ASSEMBLY ADJUSTABLE TORQUE SCREWDRIVER CAT. NO. 6583-50 AND 6783-50

Clutch gear and other gears identical to 6798-50 positive drive model.

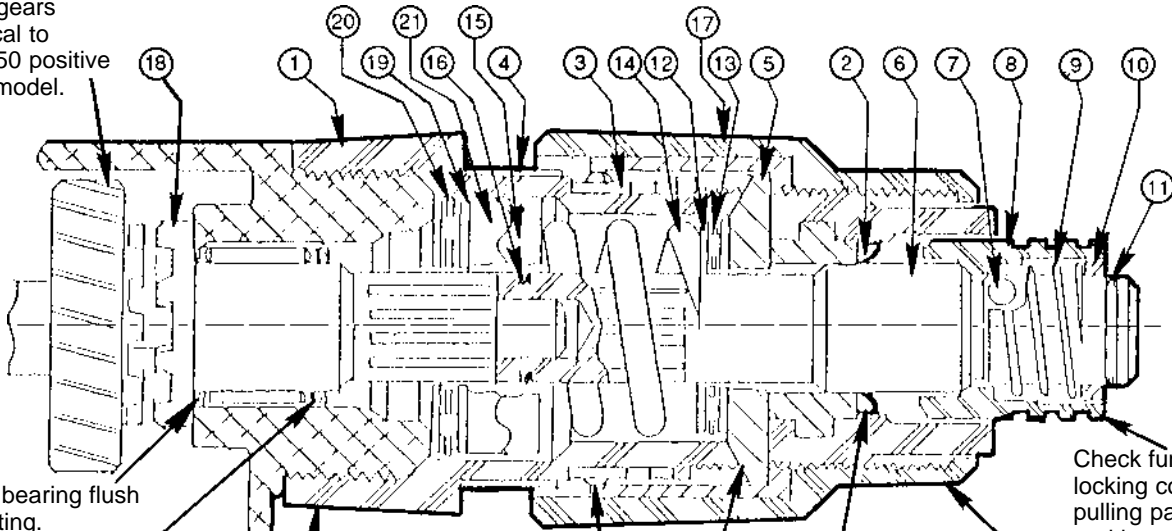

Press bearing flush to casting. Single seal bearing seal towards front.

Clutch Housing Assembly No. 14-08-0190 should be tightened to 45-55 in./lbs.

Dimples on adjustment band (Item #3) must be positioned to rear in slot.

Bevel must be toward rear of tool.

Oil seal mounted flush with inside surface and lip must face gear case.

Check function of locking collar by pulling part forward and inserting 1/4" power shank bit.
For ease of assembly, turn adjustment collar to lowest possible setting.

LUBRICATION

Apply 1/16 oz. Type "F" Grease on clutch faces of drive clutch (#15 & #21). Apply small amount of Type "F" Grease on thrust bearings (#13 & #20, oil seal lip #2 and tabs of adjustment ring #5).

Drive clutches must slide back and forth freely on shaft splines. Defective splines that stick will not function properly.

	ITEM NO.	PART NO.	DESCRIPTION	
Clutch Housing Assembly No. 14-08-0190	1	43-76-0550	Clutch Housing (Includes Bushing No. 42-40-0920)	} Clutch Sub-Assembly
	2	45-06-0106	Oil Seal	
	3	42-16-0140	Adjustment Band	
4	10-79-3100	Torque Setting Label		
5	44-90-4280	Adjustment Ring		
6	42-66-0676	Chuck Shaft		
Sub-Assembly	7	02-02-0130	Steel Ball	
	8	42-76-0390	Locking Collar	
	9	40-50-8005	Spring	
	10	45-36-1300	Spacer	
	11	34-60-2390	Retaining Ring	
	12	45-88-7150	Thrust Washers (2 each) (Place on each side of Item #13)	
	13	02-80-6020	Thrust Bearing	
	14	40-50-8000	Clutch Spring	
	15	42-70-5016	Drive Clutch	
	16	34-60-0545	Retaining Ring	
	17	42-76-0460	Adjustment Collar (Includes Insert No. 43-84-0740)	} Not In Order Of Assembly
	18	14-73-0250	Clutch Shaft Assembly (Includes Clutch Shaft No. 36-14-0661 and Needle Bearing No. 02-50-2400)	
	19	45-88-0510	Thrust Bearing Washers (2 each) (Place on each side of Item #20)	
	20	02-80-1200	Thrust Bearing	
	21	42-70-5016	Drive Clutch	