

SERVICE PARTS LIST

MAGNUM SCREW-SHOOTER

Catalog No. 6754-1

Starting
Serial No. **572-1001**

BUL. 54-42-5525

REVISED BUL. DATE
May '78

WIRING INSTRUCTIONS
58-01-0120

Specify Catalog and Serial No. when ordering parts

0-4000 R.P.M.
4.5 AMPS

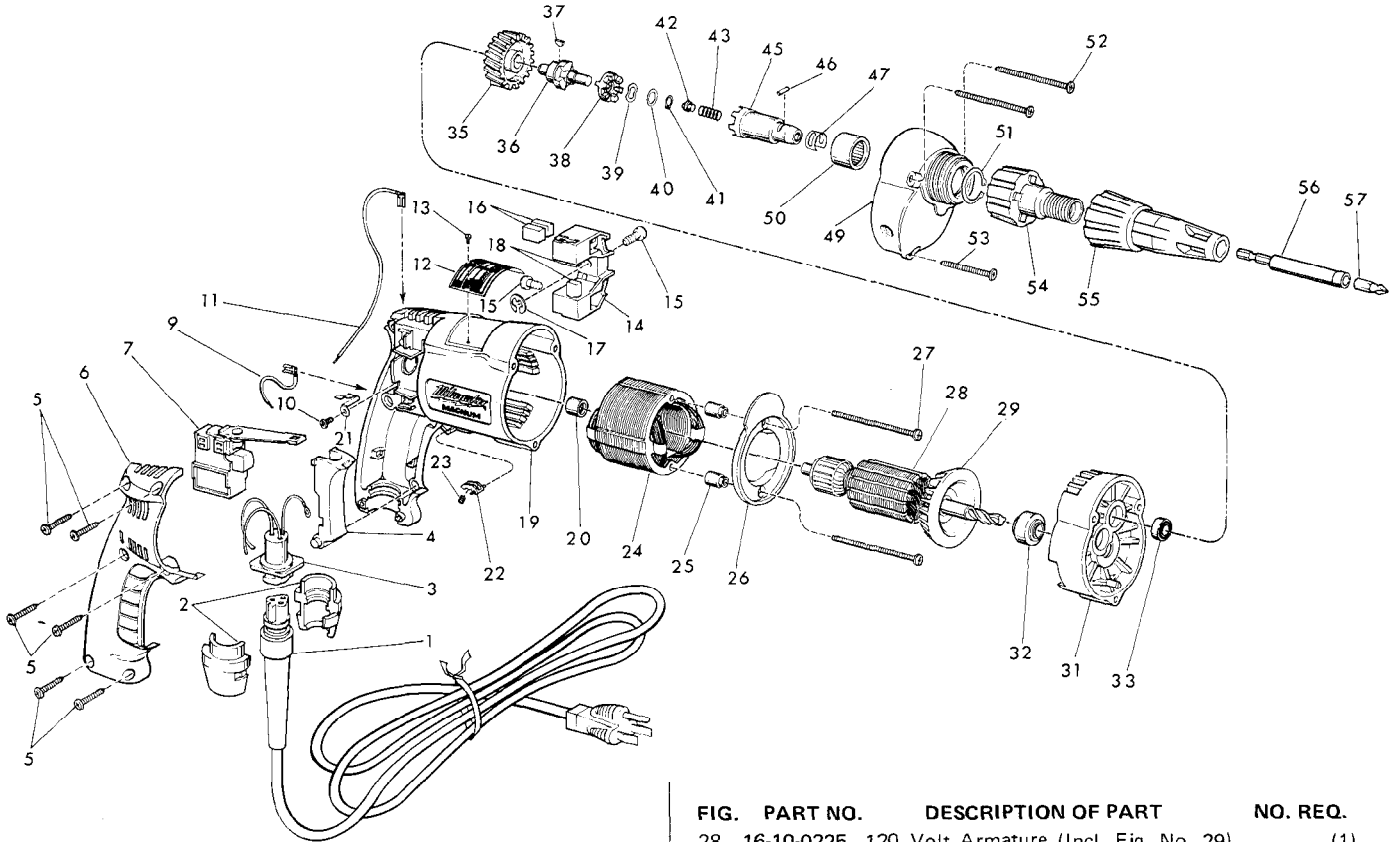

| FIG. | PART NO. | DESCRIPTION OF PART | NO. REQ. |
|------|------------|---|----------|
| 1 | 48-76-3008 | Cord Set (Includes Fig. No. 2) | (1) |
| 2 | 44-40-0440 | Cord Nut | (2) |
| 3 | 22-56-0300 | Pin Housing Assembly | (1) |
| 4 | 45-72-0080 | Trigger | (1) |
| 5 | 06-95-0220 | 8-18x3/4 Pan Hd. Thread Form Screw | (6) |
| 6 | 31-15-0100 | Handle Cover | (1) |
| 7 | 23-66-0980 | Reversing Speed Control Switch | (1) |
| 8 | 12-98-7081 | Caution Plate (Not Shown) | (1) |
| 9 | 23-94-9625 | 2-1/4" Lead Assembly | (1) |
| 10 | 06-95-5100 | 6-32x1/4 Phillip Pan Hd. Screw | (1) |
| 11 | 23-94-9630 | 7" Lead Assembly | (1) |
| 12 | 12-99-0080 | Nameplate Blank | (1) |
| 13 | 06-85-0200 | Nameplate Screw | (2) |
| 14 | 22-22-0350 | Brush Holder Assy. (Incl. Fig. Nos. 15 thru 17) | (1) |
| 15 | 31-75-0010 | Brush Holder Screw | (2) |
| 16 | 22-16-0270 | Carbon Brush (Spares) | (2) |
| 17 | 34-60-0500 | 1/4" Ext. Retaining Ring | (1) |
| 18 | 22-16-0270 | Carbon Brush | (2) |
| 19 | 14-38-0300 | Motor Housing Assy. (Incl. Fig. Nos. 20 & 21) | (1) |
| 20 | 02-50-2025 | Needle Thrust Bearing | (1) |
| 21 | 23-74-0530 | Ground Terminal | (1) |
| 22 | 42-42-0150 | Lock Button | (1) |
| 23 | 40-50-0085 | Lock Button Spring | (1) |
| 24 | 18-10-0040 | 120 Volt Field | (1) |
| 25 | 45-36-0810 | Baffle Spacer | (2) |
| 26 | 31-05-0060 | Baffle | (1) |
| 27 | 06-95-0280 | 8-18x2-3/8 Pan Hd. Thread Form Screw | (2) |
| 28 | 16-10-0225 | 120 Volt Armature (Incl. Fig. No. 29) | (1) |
| 29 | 22-84-0650 | Fan Assembly | (1) |
| 30 | 14-13-0310 | Diaphragm Assy. (Fig. Nos. 31 thru 33) | (1) |
| 31 | 31-20-0035 | Diaphragm | (1) |
| 32 | 02-04-0885 | Ball Bearing | (1) |
| 33 | 02-08-0215 | Ball Bearing | (1) |
| 34 | 32-10-0200 | Clutch Gear Assy. (Fig. Nos. 35 thru 41) | (1) |
| 35 | 32-75-2825 | Spindle Gear | (1) |
| 36 | 36-14-0081 | Gear Shaft | (1) |
| 37 | 06-42-0400 | Woodruff Key | (1) |
| 38 | 42-70-5030 | Drive Clutch | (1) |
| 39 | 45-88-0700 | Shakeproof Spring Washer | (1) |
| 40 | 45-88-5240 | Flat Washer | (1) |
| 41 | 34-60-0510 | External Retaining Ring | (1) |
| 42 | 44-60-0500 | Thrust Pin | (1) |
| 43 | 40-50-0080 | Separator Spring | (1) |
| 44 | 14-73-0090 | Chuck Shaft Assy. (Fig. Nos. 45 thru 47) | (1) |
| 45 | 42-66-0510 | Chuck Shaft | (1) |
| 46 | 02-55-0150 | Loose Roller Bearing | (1) |
| 47 | 40-50-1450 | Bit Retaining Spring | (1) |
| 48 | 14-30-0030 | Gear Case Assy. (Fig. Nos. 49 thru 51) | (1) |
| 49 | 31-40-0035 | Gear Case | (1) |
| 50 | 02-50-4050 | Needle Bearing | (1) |
| 51 | 34-80-0800 | Internal Retaining Ring | (1) |
| 52 | 06-95-0270 | 8-18x2-1/8 Pan Hd. Thread Form Screw | (2) |
| 53 | 06-95-0250 | 8-18x1-5/8 Pan Hd. Thread Form Screw | (1) |
| 54 | 48-32-2505 | Bit Housing | (1) |
| 55 | 49-26-1026 | Locator Assembly | (1) |
| 56 | 48-32-3025 | Magnet Bit Holder 1/4 Hex | (1) |
| 57 | 48-32-1050 | Insert Bit No. 2 Phil 1/4 H | (1) |