



SERVICE PARTS LIST

BUL. 54-42-4051

SCREWDRIVER

REVISED BUL. 6135-2 DATE Feb. '68

Catalog No. 6620-1

Starting Serial No. **135-1141**

WIRING INSTR.

Both Model and Serial No. must be furnished to obtain correct parts.

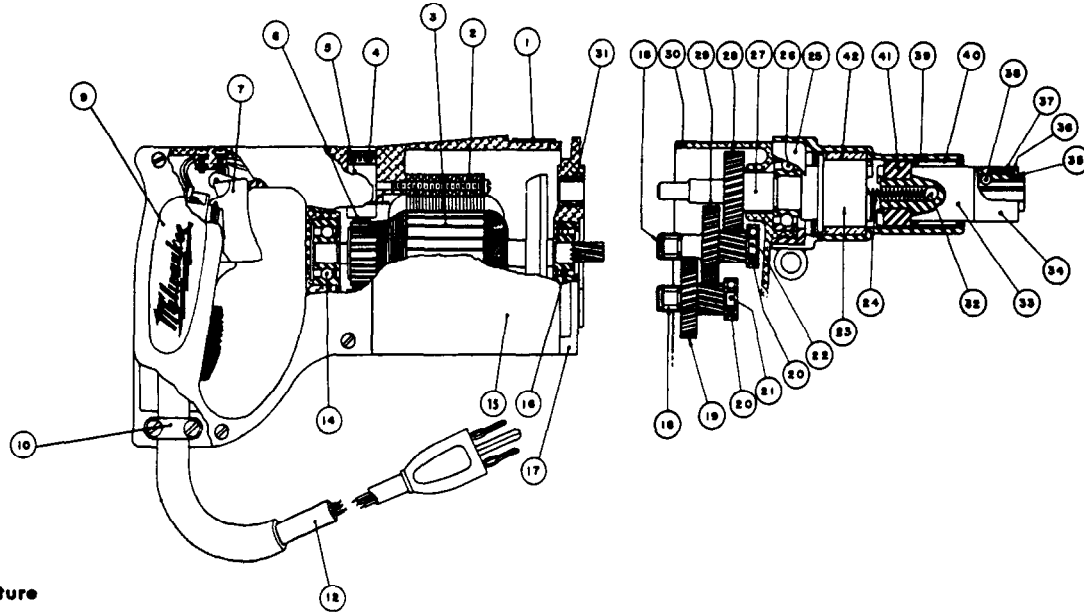

230V Motor
16-46-1190 Armature
18-46-1041 Field

CORRECTS & SUPERCEDES
SERVICE BULLETIN 6135-2
DATED 6/1/62

| FIG. | PART NO. | DESCRIPTION OF PART |
|------|------------|---------------------------|
| 1 | 12-98-0800 | Name Plate |
| 2 | 18-42-1041 | Field Assembly |
| 3 | 16-42-1210 | Armature Assembly |
| 4 | 23-44-0060 | Brush Retaining Screw |
| 5 | 22-22-0080 | Brush Holder Assembly |
| 6 | 22-18-0100 | Carbon Brush Assembly |
| * 7 | 23-66-0485 | Switch |
| * 9 | 28-20-3601 | Handle Cover |
| 10 | 28-17-0400 | Cord Clamp Strap |
| 12 | 22-64-0170 | Cord Set |
| 14 | 02-04-0970 | Ball Bearing |
| * 15 | 28-50-4488 | Motor Housing |
| 16 | 02-04-0940 | Ball Bearing |
| 17 | 28-28-0661 | Diaphragm |
| 18 | 02-50-1640 | Needle Bearing |
| 19 | 32-40-1241 | Intermediate Gear |
| 20 | 02-04-0640 | Ball Bearing |
| 21 | 36-66-2801 | Intermediate Pinion Shaft |
| 22 | 36-66-2901 | Intermediate Pinion Shaft |
| 23 | 43-90-0060 | Driving Jaw |

ILLUSTRATED PARTS

| FIG. | PART NO. | DESCRIPTION OF PART |
|--------|------------|-----------------------------------|
| 24 | 40-50-0900 | Separating Spring |
| 25 | 42-52-0071 | Bearing Cap |
| 26 | 02-04-1560 | Ball Bearing |
| (2) 27 | 38-50-3601 | Spindle |
| (2) 28 | 32-75-2061 | Spindle Gear |
| (2) 29 | 32-75-2041 | Spindle Gear |
| 30 | 28-14-0961 | Gear Case |
| 31 | 02-50-2110 | Needle Bearing |
| 32 | 02-02-0250 | Ball |
| 33 | 42-66-0165 | Chuck Assembly |
| 34 | 42-76-0090 | Bit Retaining Collar |
| 35 | 34-60-1300 | Collar Stop Washer Retaining Ring |
| 36 | 45-88-0070 | Collar Stop Washer |
| 37 | 40-50-1000 | Collar Stop Spring |
| 38 | 02-02-0180 | Bit Retaining Ball |
| (2) 39 | 02-50-6440 | Needle Bearing |
| (2) 40 | 45-22-0070 | Sleeve Assembly |
| 41 | 43-90-0050 | Chuck Jaw |
| 42 | 42-24-0080 | Driving Jaw Bearing |

MISCELLANEOUS PARTS NOT SHOWN

| PART NO. | DESCRIPTION OF PART | PART NO. | DESCRIPTION OF PART | QUANTITY |
|------------|------------------------------------|----------------|--|----------|
| 34-80-2800 | Driving Jaw Retaining Ring | 06-81-5790 | 6-32x1/4 Fil. Hd. Sw. Mtg. Sems | (2) |
| 43-62-0161 | Handle | 23-86-0110 | Brush Holder Insul. Washer | (2) |
| 48-30-3250 | Bit and Finder | 06-81-6100 | 8-32x7/16 Fil.Hd.Sems Cord Clamp Strap | (2) |
| 48-30-3275 | Bit and Finder | 06-81-8625 | 6-32x1/4 Rd.Hd. Ground Screw (Brass) | |
| 48-30-3300 | Bit and Finder | 06-81-6350 | 8-32x1 Fil.Hd. Gear Case Screws (Sem) | (2) |
| 48-32-2070 | Square Driver (For Sockets) | 06-81-6650 | 8-32x1 1/2 Fil.Hd. Gear Case Screws (Sem) | (2) |
| 06-75-0500 | 3/8"-16x1 Long Cap Screw | 06-81-6600 | 8-32x1 1/2 Fil.Hd. Field Screws (Sem) | (2) |
| 49-96-4060 | 9/16 Open End Wrench | 06-83-2650 | 1/4-20x3/8 Hd'less Brush Holder Set Screws | (2) |
| 06-42-0800 | Woodruff Keys | (3) 06-81-3700 | 8-32x7/8 Oval Hd. Handle Cover Screws | (4) |
| 06-81-8400 | 4-40x1/4" Rd.Hd. Name Plate Screws | (2) | | |

Numbers in brackets indicate number required.