



# SERVICE PARTS LIST

**BULLETIN NO.**  
**54-42-6003**

|  |                                 |  |                    |
|--|---------------------------------|--|--------------------|
| SPECIFY CATALOG NO. AND SERIAL NO. WHEN ORDERING PARTS |                                 | REVISED BULLETIN<br>54-42-6002                   | DATE<br>Sept. 2013 |
| <b>ADJUSTABLE TORQUE SCREWDRIVER</b>                   |                                 |  |                    |
| CATALOG NO. <b>6580-20</b>                             | STARTING SERIAL NO. <b>098D</b> | WIRING INSTRUCTION<br><b>See Pages 3 &amp; 4</b> |                    |

**EXAMPLE:**  
Component Parts (Small #)  
Are Included When Ordering  
The Assembly (Large #).

★ = Part number change from previous service parts list.

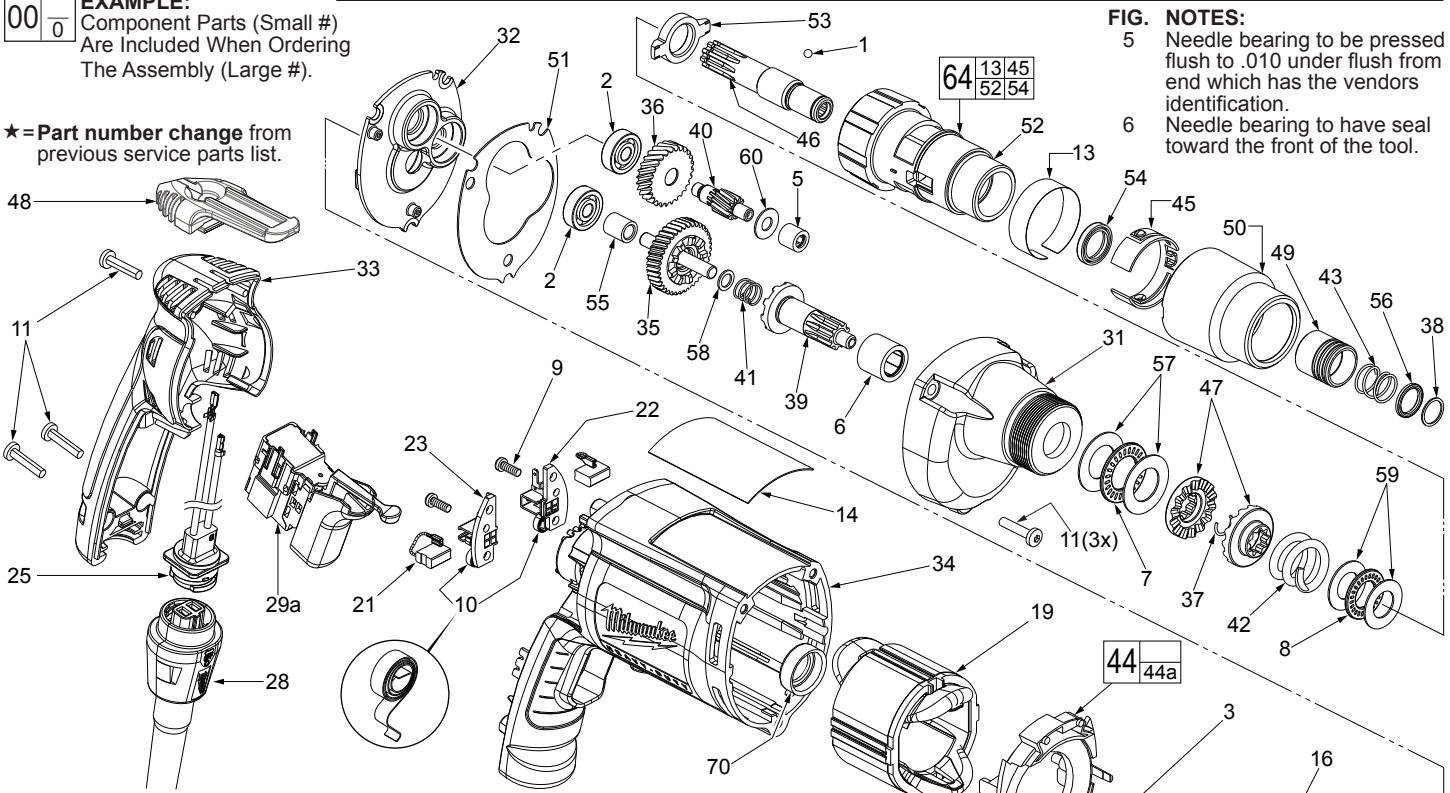

**FIG. NOTES:**  
5 Needle bearing to be pressed flush to .010 under flush from end which has the vendors identification.  
6 Needle bearing to have seal toward the front of the tool.

| FIG. | PART NO.   | DESCRIPTION OF PART                   | NO. REQ. |
|------|------------|---------------------------------------|----------|
| 1    | 02-02-0130 | Steel Ball                            | (1)      |
| 2    | 02-04-0640 | Ball Bearing                          | (2)      |
| 3    | 02-04-0645 | Ball Bearing                          | (1)      |
| 4    | 02-04-0852 | Ball Bearing                          | (1)      |
| 5    | 02-50-2400 | Needle Bearing                        | (1)      |
| 6    | 02-50-3245 | Needle Roller Bearing                 | (1)      |
| 7    | 02-80-1200 | Thrust Needle Bearing                 | (1)      |
| 8    | 02-80-6020 | Thrust Bearing                        | (1)      |
| 9    | 05-88-1610 | M3.5 x 10 Pan Hd. Plastite T-10 Scr   | (2)      |
| 10   | 23-52-1610 | Brush Spring                          | (2)      |
| 11   | 06-82-7275 | 7-18 x 3/4 Slotted Plastite Torx T-20 | (6)      |
| 13   | 10-79-3100 | Torque Setting Label                  | (1)      |
| 14   | 12-99-2665 | Service Nameplate                     | (1)      |
| 16   | 16-10-2205 | Armature                              | (1)      |
| 19   | 18-07-7210 | Field                                 | (1)      |
| 21   | 22-18-1310 | Brush Assembly                        | (2)      |
| 22   | 22-20-0090 | Left Brush Holder                     | (1)      |
| 23   | 22-20-0095 | Right Brush Holder                    | (1)      |
| 25   | 22-56-1000 | Blade Housing Assembly                | (1)      |
| 28   | 48-76-5010 | Quik-Lok Cord Set                     | (1)      |
| 29a  | 23-66-2605 | Defond Switch (See page 3 wiring)     | (1)      |
| 29b  | 23-66-2585 | Marquardt Switch (See page 4 wiring)  | (1)      |
| 31   | 28-14-2405 | Gearcase                              | (1)      |
| 32   | 28-28-2315 | Diaphragm                             | (1)      |
| 33   | 31-15-2030 | Handle Halve                          | (1)      |
| ★34  | 31-50-0524 | Motor Housing                         | (1)      |
| 35   | 32-10-4055 | Clutch Gear Assembly                  | (1)      |
| 36   | 32-40-0100 | Intermediate Gear                     | (1)      |
| 37   | 34-60-0545 | Retaining Ring                        | (1)      |
| 38   | 34-60-2390 | Retaining Ring                        | (1)      |
| 39   | 36-14-0665 | Clutch Shaft Assembly                 | (1)      |
| 40   | 36-66-0105 | Intermediate Shaft                    | (1)      |
| 41   | 40-50-6600 | Separator Spring                      | (1)      |
| 42   | 40-50-8000 | Clutch Spring                         | (1)      |
| 43   | 40-50-8005 | Compression Spring                    | (1)      |
| 44   | 42-14-0460 | Baffle Assembly                       | (1)      |
| 44a  | 45-30-0030 | Slug (Not Shown)                      | (2)      |
| 45   | 42-16-0140 | Adjustment Band                       | (1)      |
| 46   | 42-66-0676 | Chuck Shaft                           | (1)      |
| 47   | 42-70-5016 | Drive Clutch                          | (2)      |
| 48   | 42-70-5280 | Belt Clip                             | (1)      |
| 49   | 42-76-0390 | Locking Collar                        | (1)      |
| 50   | 42-76-0460 | Adjustment Collar                     | (1)      |
| 51   | 43-44-0985 | Gasket                                | (1)      |
| 52   | 43-76-0550 | Clutch Housing                        | (1)      |
| 53   | 44-90-4280 | Adjustment Ring                       | (1)      |

Cat. No. 31-53-0205  
Lock Button Plug

| FIG. | PART NO.   | DESCRIPTION OF PART                    | NO. REQ. |
|------|------------|--|----------|
| 54   | 45-06-0106 | Oil Seal                               | (1)      |
| 55   | 45-36-1280 | Spacer                                 | (1)      |
| 56   | 45-36-1300 | Spacer                                 | (1)      |
| 57   | 45-88-0510 | Thrust Bearing Washer                  | (2)      |
| 58   | 45-88-0712 | Thrust Washer                          | (1)      |
| 59   | 45-88-7150 | Thrust Washer                          | (2)      |
| 60   | 45-88-7990 | Thrust Washer                          | (1)      |
| 64   | 14-08-0190 | Clutch Housing Assembly                | (1)      |
| ★70  | 43-86-0125 | Bearing Cup                            | (1)      |
|      | 23-94-0490 | White Leadwire Assy. (See pages 3 & 4) | (1)      |
|      | 23-94-0495 | Red Leadwire Assy. (See pages 3 & 4)   | (1)      |

**LUBRICATION (Type "L" Grease, No. 49-08-4170)**  
• Place 1.8 gm. (.06 oz.) of grease on the drive clutch surfaces (47).

• Equally distribute 1.8 gm. (.06 oz.) of grease on the thrust bearings (7 and 8), oil seal (54) and the tabs of the adjustment ring (53).

**LUBRICATION (Type "Y" Grease, No. 49-08-5270)**  
• Equally distribute 1.5 gm. (.05 oz.) of grease on the lugs of the clutch gear (35), clutch shaft (39), separator spring (41) and the thrust washer (58).

• In the gearcase (31), place 3.6 gm. (.13 oz.) of grease in the counterbore above the inserted intermediate needle bearing (5).

• Place 13 gm. (.46 oz.) of grease at the armature pinion location in the gearcase (31) and fill to the top of the intermediate gear (36).

**Before assembly, lightly coat all press fit areas with lightweight spindle oil.**

Clutch gear and other gears are identical to other positive drive models.

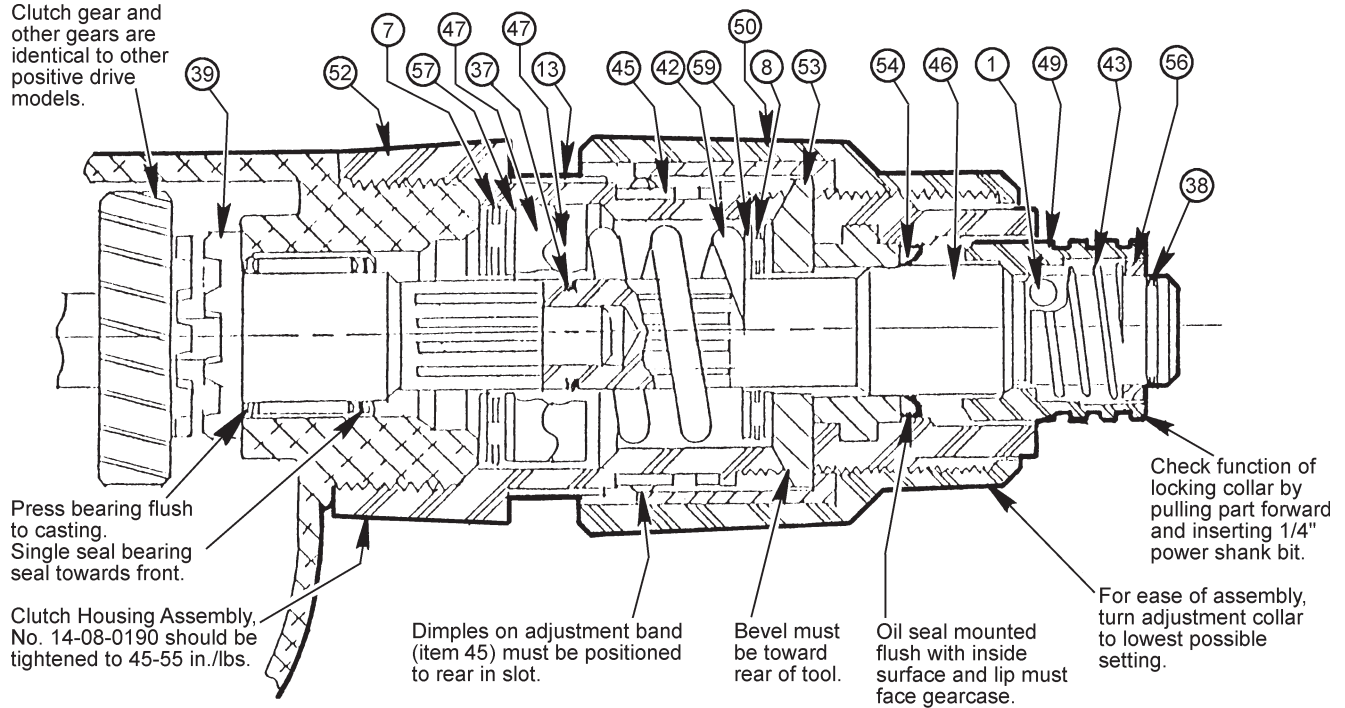

**Lubrication**

Drive clutches must slide back and forth freely on shaft splines. Defective splines that stick will not function properly.

Apply 1/16 oz. Type "L" grease, No. 49-08-4170, on clutch faces of drive clutch (#47). Apply a small amount of "L" grease on thrust bearings (#7 and #8), oil seal lip (#54) and tabs of adjustment ring (#53).

| ORDER OF ASSEMBLY                         | ITEM NUMBER | PART NUMBER | DESCRIPTION  |
|---|-------------|-------------|--|
| Clutch Housing Assembly<br>No. 14-08-0190 | 1           | 64          | 14-08-0190   |
|   | 2           | 54          | 45-06-0106   |
|   | 3           | 45          | 42-16-0140   |
|   | 4           | 13          | 10-79-3100   |
|   | 5           | 53          | 44-90-4280   |
|   | 6           | 46          | 42-66-0676   |
|   | 7           | 1           | 02-02-0130   |
|   | 8           | 49          | 42-76-0390   |
|   | 9           | 43          | 40-50-8005   |
|   | 10          | 56          | 45-36-1300   |
|   | 11          | 38          | 34-60-2390   |
|   | 12          | 59          | 45-88-7150   |
|   | 13          | 8           | 02-80-6020   |
|   | 14          | 42          | 40-50-8000   |
|   | 15          | 47          | 42-70-5016   |
|   | 16          | 37          | 34-60-0545   |
|   | 50          | 42-76-0460  | Adjustment Collar (Includes insert No. 43-84-0740)                                 |
|   | 39          | 36-14-0665  | Clutch Shaft Assembly  |
|   | 57          | 45-88-0510  | Thrust Bearing Washers (2 each)<br>(Place on each side of Item #7, Thrust Bearing) |
|   | 7           | 02-80-1200  | Thrust Bearing   |
|   | 47          | 42-70-5016  | Drive Clutch   |

Clutch Sub-Assembly

Not In Order Of Assembly

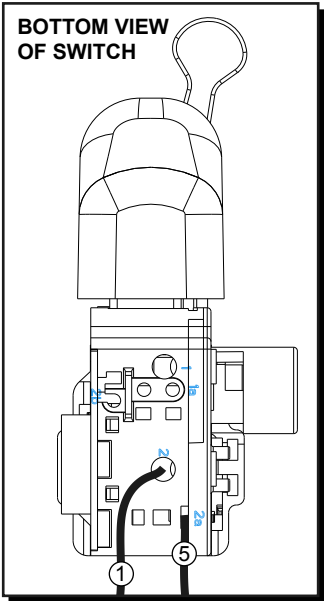

**BOTTOM VIEW OF SWITCH**

**DEFOND SWITCH**

● = WIRE TRAPS or GUIDES

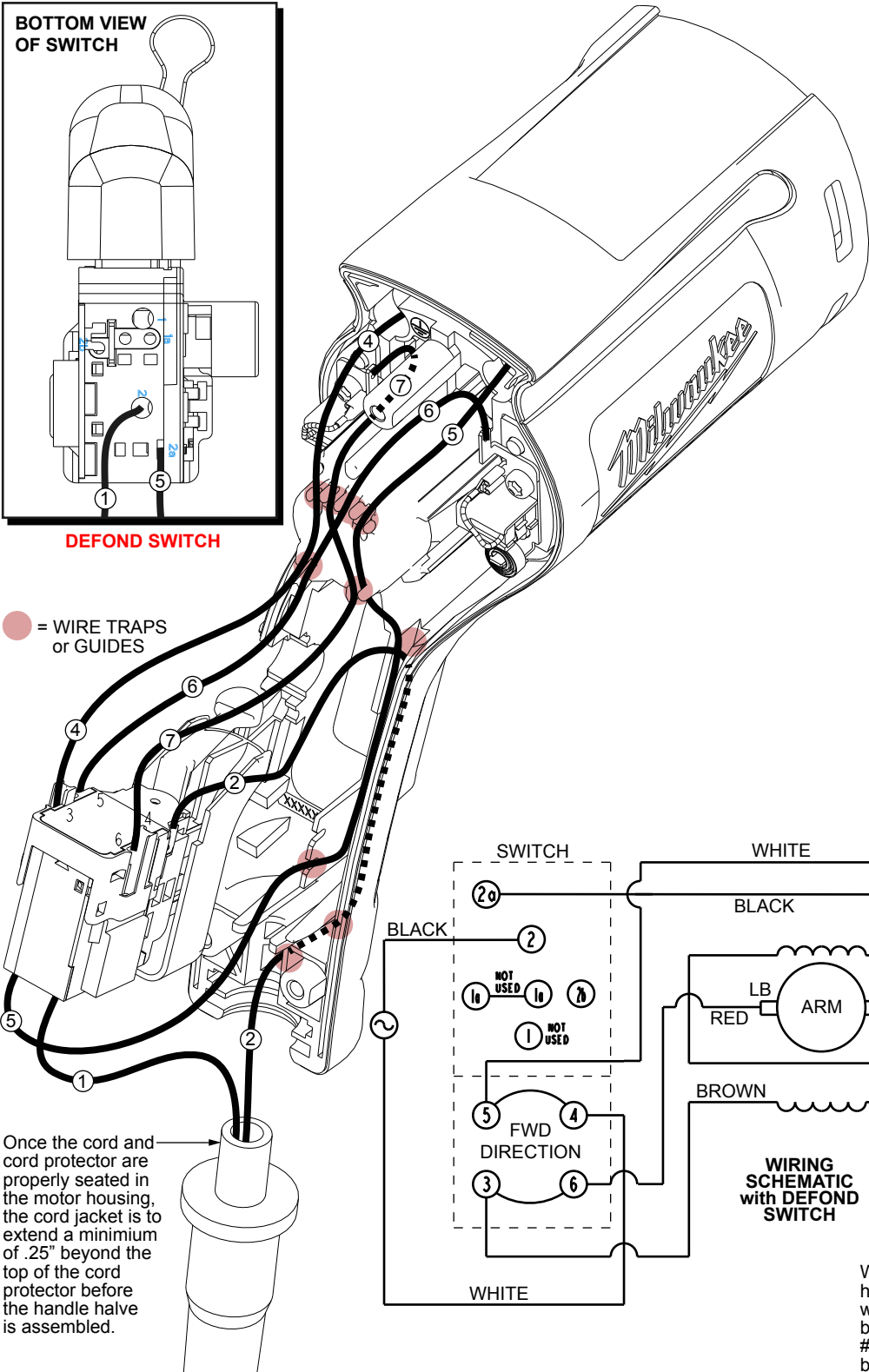

Once the cord and cord protector are properly seated in the motor housing, the cord jacket is to extend a minimum of .25" beyond the top of the cord protector before the handle half is assembled.

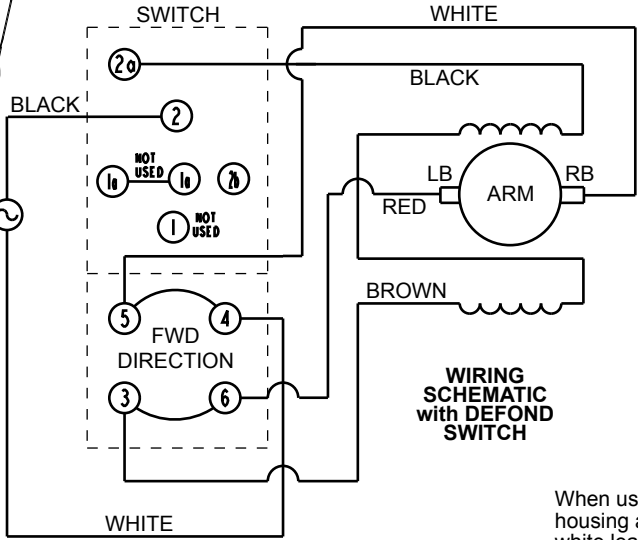
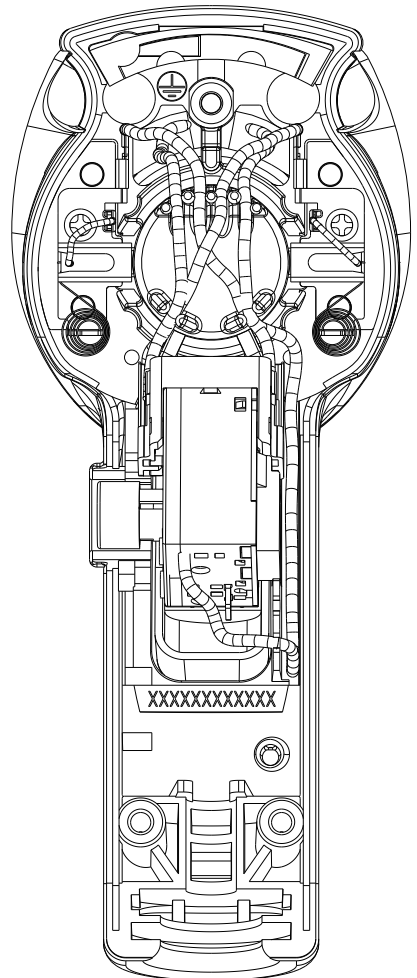

**AS AN AID TO REASSEMBLY, TAKE NOTICE OF WIRE ROUTING AND POSITION IN WIRE GUIDES AND TRAPS WHILE DISMANTLING TOOL.**

**BE CAREFUL AND AVOID PINCHING WIRES BETWEEN HANDLE HALVES WHEN ASSEMBLING.**

**WIRING SCHEMATIC with DEFOND SWITCH**

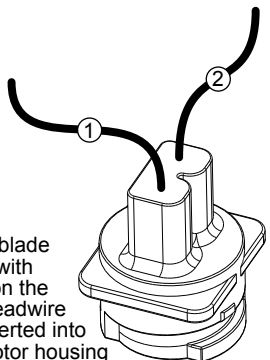

When used, orient blade housing assembly with white leadwire #2 on the bottom and black leadwire #1 on top when inserted into bottom cavity of motor housing

**WIRING SPECIFICATIONS**

| Wire No. | Wire Color | Origin or Gauge | Length | Terminals, Connectors and 1 or 2 End Wire Preparation                                      |
|----------|------------|-----------------|--------|--|
| 1        | Black      | *               | ----   | *Component of cord set, pin hsg. assy. or blade hsg. assy. Connect to #2 on switch bottom. |
| 2        | White      | *               | ----   | *Component of cord set, pin hsg. assy. or blade hsg. assy. Connect to #4 on switch top.    |
| 4        | Brown      | Field           | ----   | Component of field. Connect to #3 on switch top.   |
| 5        | Black      | Field           | ----   | Component of field. Connect to #2a on switch bottom.                                       |
| 6        | White      | 23-94-0490      | ----   | Leadwire assembly. Connect to right brush holder and #5 on switch top.                     |
| 7        | Red        | 23-94-0495      | ----   | Leadwire assembly. Connect to left brush holder and #6 on switch top.                      |

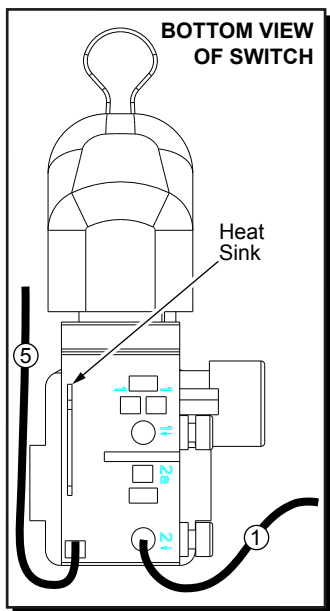

**MARQUARDT SWITCH**

● = WIRE TRAPS or GUIDES

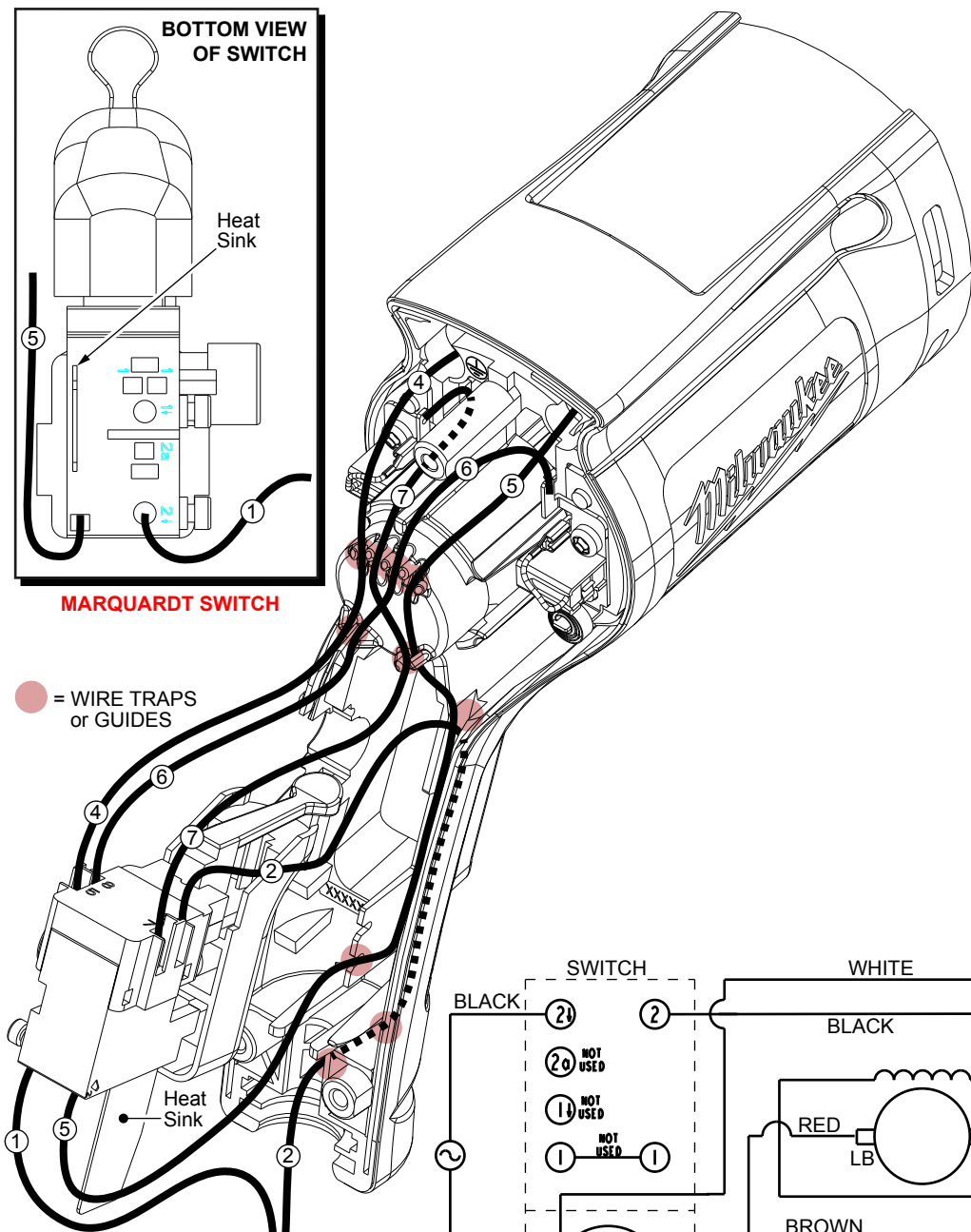

Once the cord and cord protector are properly seated in the motor housing, the cord jacket is to extend a minimum of .25" beyond the top of the cord protector before the handle half is assembled.

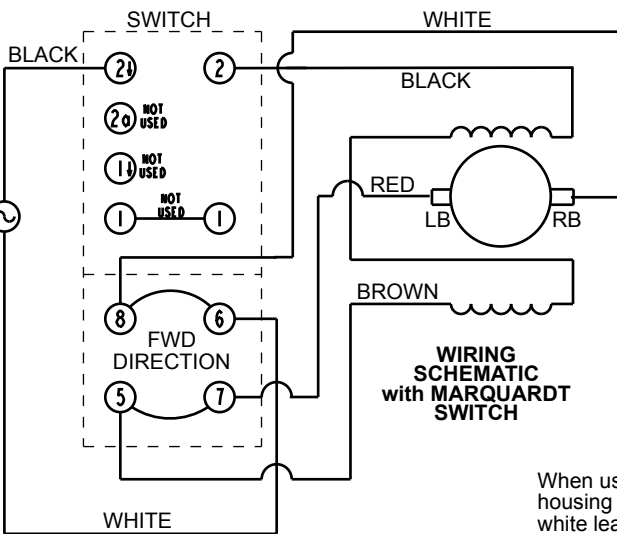
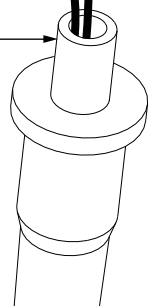

AS AN AID TO REASSEMBLY, TAKE NOTICE OF WIRE ROUTING AND POSITION IN WIRE GUIDES AND TRAPS WHILE DISMANTLING TOOL.

BE CAREFUL AND AVOID PINCHING WIRES BETWEEN HANDLE HALVES WHEN ASSEMBLING.

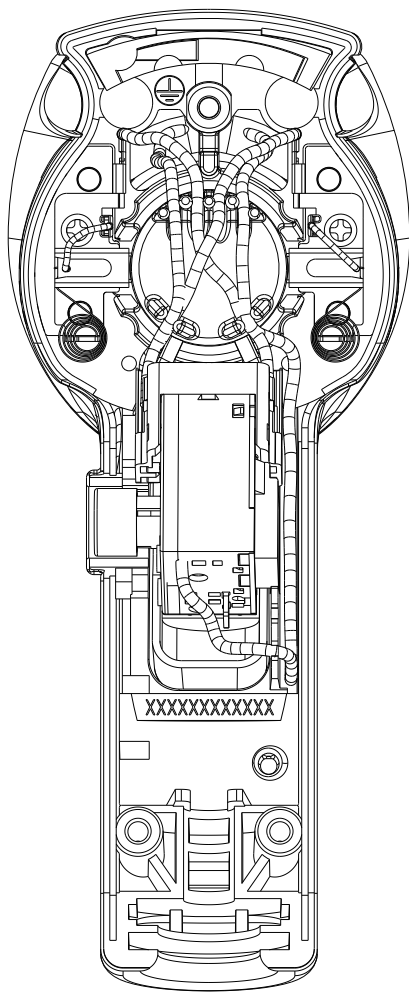

When used, orient blade housing assembly with white leadwire #2 on the bottom and black leadwire #1 on top when inserted into bottom cavity of motor housing

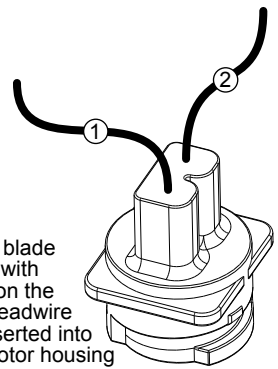

**WIRING SPECIFICATIONS**

| Wire No. | Wire Color | Origin or Gauge | Length | Terminals, Connectors and 1 or 2 End Wire Preparation                                      |
|----------|------------|-----------------|--------|--|
| 1        | Black      | *               | ----   | *Component of cord set, pin hsg. assy. or blade hsg. assy. Connect to #2 on switch bottom. |
| 2        | White      | *               | ----   | *Component of cord set, pin hsg. assy. or blade hsg. assy. Connect to #6 on switch top.    |
| 4        | Brown      | Field           | ----   | Component of field. Connect to #5 on switch top.   |
| 5        | Black      | Field           | ----   | Component of field. Connect to #2 on switch bottom.  |
| 6        | White      | 23-94-0490      | ----   | Leadwire assembly. Connect to right brush holder and #8 on switch top.                     |
| 7        | Red        | 23-94-0495      | ----   | Leadwire assembly. Connect to left brush holder and #7 on switch top.                      |