



# SERVICE PARTS LIST

BULLETIN NO.  
54-42-0145

SPECIFY CATALOG NO. AND SERIAL NO. WHEN ORDERING PARTS		REVISED BULLETIN	DATE
<b>2 SPEED CORDLESS SCREWDRIVER</b>			Feb.'91
CATALOG NO. 6546-1	DATE CODE 870720	WIRING INSTRUCTION <b>See Reverse Side</b>	

**EXAMPLE:**

Component Parts ( Small #)  
Are Included When Ordering  
The Assembly (Large #).

FIG.	PART NO.	DESCRIPTION OF PART	NO. REQ.
1	31-58-0070	Clutch Adjustment Ring	(1)
2	44-90-4300	Clutch Ring	(1)
3	40-50-8250	Clutch Spring	(1)
4	44-90-4290	Thrust Ring	(1)
5	44-60-1130	Clutch Pin	(3)
6	02-02-2020	Steel Ball	(7)
7	32-48-0080	Gear Box Assembly	(1)
8	14-50-0490	Motor	(1)
9	23-66-1740	Switch	(1)
10	31-50-0760	Motor Housing Set	(1)
11	05-78-0100	2 x 8 mm Self Tap. Phil. Screw	(4)
12	44-10-0270	Gear Change-Lever	(1)
13	40-50-8260	Click Spring	(2)
14	05-78-0700	Handle Screw Special	(1)
15	45-88-7920	Decorative Washer	(1)
16	44-60-0810	Retaining Pin	(1)
17	31-15-0360	Hinge Cover	(1)
18	31-44-1560	Handle	(1)
19	48-11-0100	Battery Pack	(1)
24	40-50-8410	Button & Spring Assembly	(1)

00-0

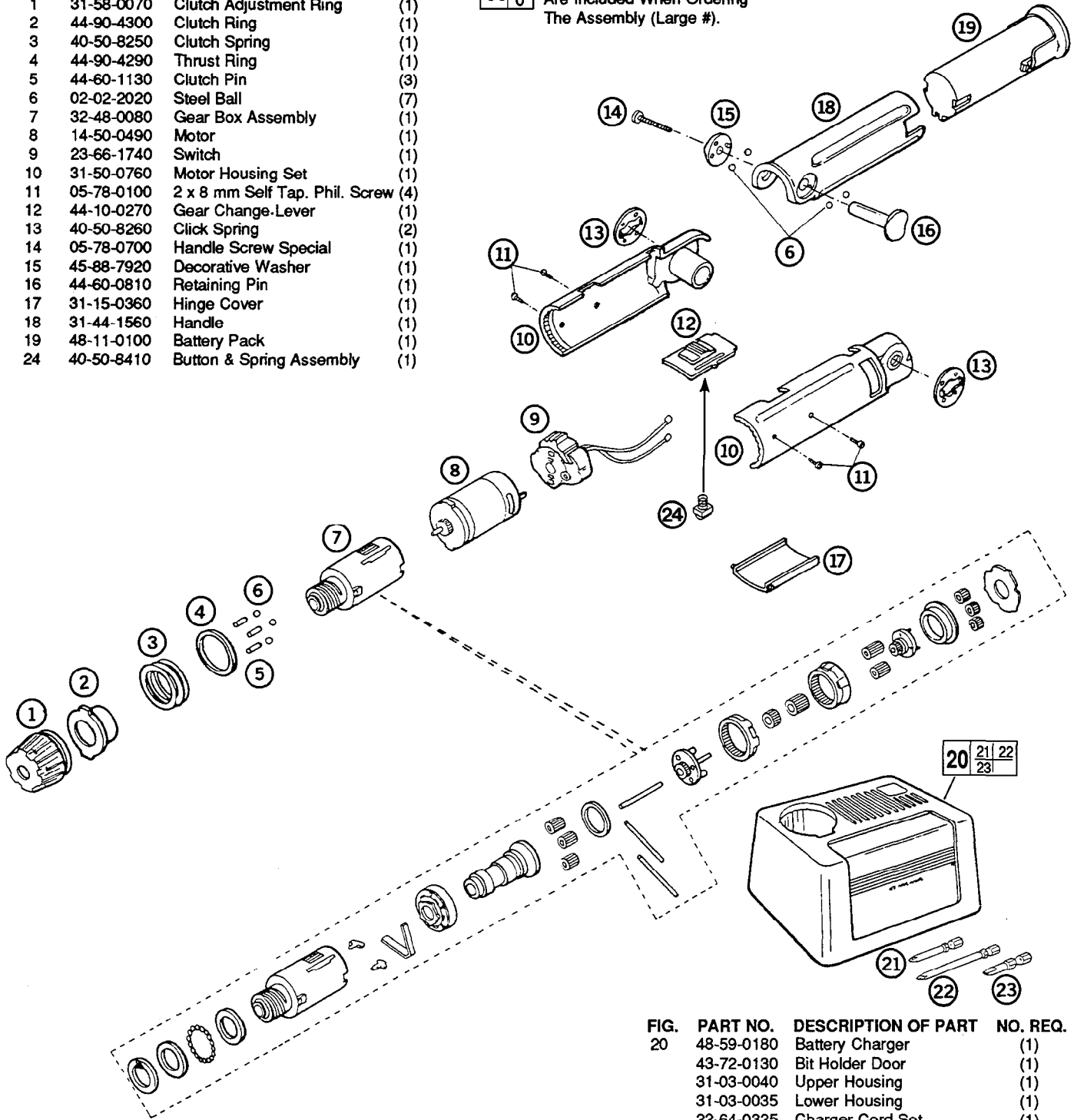

FIG.	PART NO.	DESCRIPTION OF PART	NO. REQ.
20	48-59-0180	Battery Charger	(1)
	43-72-0130	Bit Holder Door	(1)
	31-03-0040	Upper Housing	(1)
	31-03-0035	Lower Housing	(1)
	22-64-0325	Charger Cord Set	(1)
	45-04-0700	Charger Screw	(3)
21	48-30-1510	Bit-No. 1 Phil. 1/4 Hex	(1)
22	48-30-1525	Bit-No. 2 Phil. 1/4 Hex	(1)
23	48-30-0500	Bit-6F 8R 1/4 Hex	(1)

# WIRE CONNECTION DIAGRAM

