



# SERVICE PARTS LIST

**BUL. 54-98-6500**

**24 VOLT SAWZALL**

REVISED BUL  
6384-1

DATE  
DEC '68

**Catalog No. 6536**

Starting  
Serial No. **384-1001**

WIRING INSTR.  
**58-01-0140**

Both Model and Serial No. must be furnished to obtain correct parts.

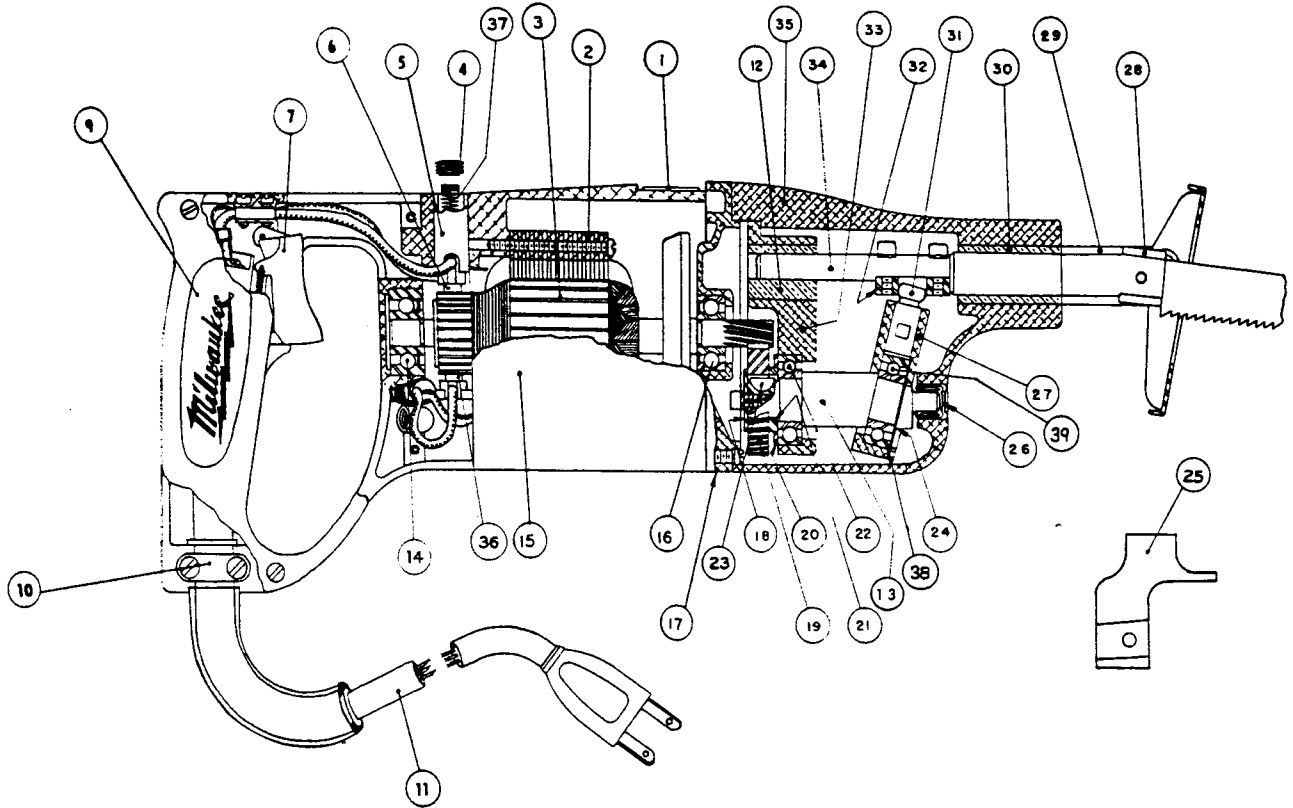

**ILLUSTRATED PARTS**

FIG.	PART NO.	DESCRIPTION OF PART	FIG.	PART NO.	DESCRIPTION OF PART
1	12-98-3000	Name Plate	21	45-36-0121	Gear Spacer
2	18-40-1000	Field Assembly	22	02-04-1510	Ball Bearing
3	16-40-1010	Armature Assembly	23	06-42-1200	Woodruff Key
4	23-44-0020	Brush Retaining Screw (2)	24	34-60-1200	Retaining Ring
5	22-22-0170	Brush Holder Assembly (2)	25	28-02-0051	Off Set Blade Adaptor
6	22-18-0280	Carbon Brush Assembly	26	02-50-1640	Needle Bearing
7	23-66-0230	Switch	27	28-72-9001	Wobble Plate
9	26-20-3602	Handle Cover	28	42-68-0071	Blade Clamp
10	26-17-0400	Cord Clamp Strap		42-68-0073	Blade Clamp
11	22-64-0310	Cord Set	29	45-16-0055	Pivot Shoe Assembly
12	42-24-0101	Spindle Bearing	30	42-24-0091	Spindle Bearing
13	36-92-0601	Wobble Shaft	31	45-58-0050	Ball End Stud
14	02-04-0970	Ball Bearing	32	42-28-0050	Reciprocating Spindle Block
15	27-50-4487	Motor Housing (Includes item 9 & screws)	33	28-72-1001	Bearing Plate
16	02-04-0940	Ball Bearing	34	38-50-2002	Reciprocating Spindle
17	28-28-0341	Diaphragm	35	28-14-0571	Gear Case
18	45-88-0180	Gear Retaining Washer	36	22-18-0290	Carbon Brush Assembly
19	32-40-1101	Intermediate Gear	37	23-52-0090	Brush Spring (2)
20	44-86-0090	Bearing Retainer	★ 38	34-80-2300	Retaining Ring
			★ 39	02-04-1510	Ball Bearing

**MISCELLANEOUS PARTS NOT SHOWN**

PART NO.	DESCRIPTION OF PART	PART NO.	DESCRIPTION OF PART
06-81-8650	6-32x1/4 Rd. Hd. Spring Clip Scr.	06-81-9525	10-24x1/2 Truss Hd. Shoe Bracket Sems (4)
06-81-5800	6-32x5/16 Fil. Hd. Switch Mtg. Sem (2)	06-81-2500	6-32x3/8 Flat Hd. Bearing Ret. Screws (2)
06-81-8400	4-40x1/4 Rd. Hd. Name Plate Sems (2)	06-81-0900	8-32x7/16 Brg. Plate Screws (2)
06-83-2645	1/4-20x3/8 Soc. (Hd'less) Set Sc. (Self-Locking)	06-81-6500	8-32x1-3/8 Fil. Hd. Gear Case Sems (2)
06-83-2650	1/4-20x3/8 Brush Holder Set Screw (2)	06-81-6650	8-32x1-3/4 Fil. Hd. Gear Case Sems (2)
06-75-2400	10-32x1/2 Socket Head Screws (6)	06-81-6600	8-32x1-3/4 Fil. Hd. Field Sems (2)
49-96-0070	Socket Screw Wrench	06-81-3700	8-32x7/8 Oval Hd. Handle Cover Screws (2)
06-97-1800	Lock Washer	06-81-6150	8-32x1/2 Fil. Hd. Cord Clamp Strap Sems (2)
42-70-0050	Spring Clip		
06-81-6150	8-32x1/2 Fil. Hd. Diaphragm Sems	06-81-3750	8-32x1 Oval Hd. Handle Cover Screws (2)
06-97-3200	No. 8 Split Ring Lock Washer (2)	06-97-3400	No. 10 Split Ring Lock Washer (3)
42-14-0090	Wire Baffle		