

WILTON C-CLAMP Replacement Parts

PERMA-PAD® REPLACEMENT PROCEDURE.
*** MUST WEAR SAFETY GOGGLES WHEN CHANGING PERMA-PAD***

SCREW SPINDLE INTO ARM WITHOUT THE PERMA-PAD ATTACHED TO THE SPINDLE. PLACE PERMA-PAD ON A FLAT SURFACE. PUT RETAINING RING ON BALL END STEM OF SPINDLE. ASSEMBLE BALL END INTO PERMA-PAD. ANGLE SPINDLE TO ONE SIDE TO ALLOW SPACE TO PUSH ONE END OF RETAINING RING INTO THE INTERNAL GROOVE OF THE PERMA-PAD. ANGLE SPINDLE TO CAPTURE END OF RING. SLOWLY ROTATE SPINDLE ON AN ANGLE TO FORCE RING INTO SLOT. IF RING DOES NOT SNAP INTO GROOVE, USE A SMALL SCREWDRIVER TO PRESS IT DOWN INTO POSITION.

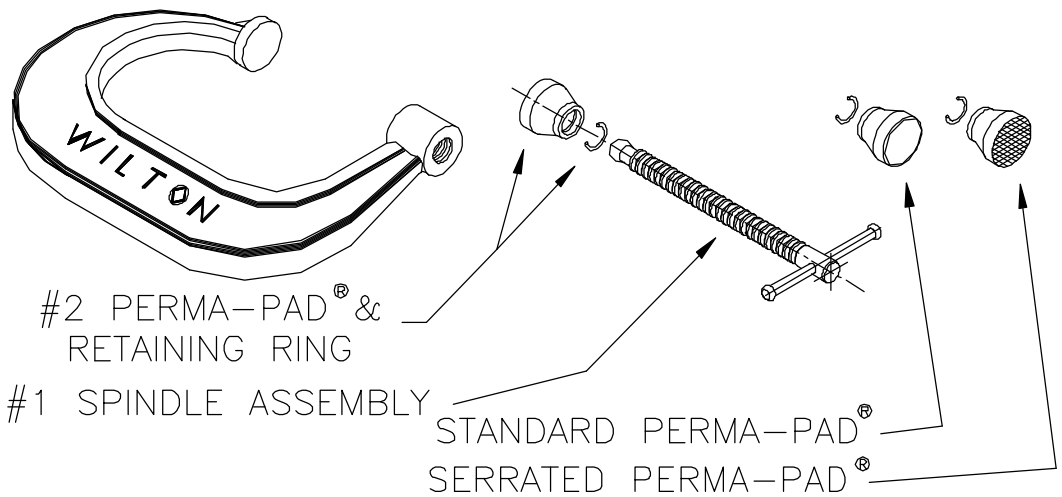

#2 PERMA-PAD® &
RETAINING RING

#1 SPINDLE ASSEMBLY

STANDARD PERMA-PAD®

SERRATED PERMA-PAD®

CLAMP MODEL NUMBER	ITEM #1 SPINDLE ASSEMBLY WITH RING	ITEM #2 PERMA-PAD® WITH RING	CLAMP MODEL NUMBER	ITEM #1 SPINDLE ASSEMBLY WITH RING	ITEM #2 PERMA-PAD® WITH RING	CLAMP MODEL NUMBER	ITEM #1 SPINDLE ASSEMBLY WITH RING	ITEM #2 PERMA-PAD® WITH RING	CLAMP MODEL NUMBER	SPINDLE	NO SPINDLE PAD AVAILABLE RANGE OF OPENING
WILTON "400" & "400-SF" SERIES FORGED C-CLAMPS, REGULAR DUTY MODELS			WILTON "400 SEP" SERIES C-CLAMPS REGULAR DUTY "SLIP-NOT" MODELS WITH COPPER PLATED SERRATED PAD & SPINDLE			WILTON "800" SERIES FORGED C-CLAMPS REGULAR DUTY MODELS			WILTON "0" SERIES C-CLAMPS EXTRA HEAVY DUTY MODELS DROP FORGED STEEL FRAMES		
402 &	402-SF	1701080 2901300	402 SEP	1701090 2907730	2907730	802	1701080 2907920	2907920	2	07142-35	0-2 3/8"
403 &	403-SF	1701160 2901300	403 SEP	1701110 2907730	2907730	803	1701160 2907920	2907920	3	07161-35	0-3 3/8"
404 &	404-SF	1700150 2901310	404 SEP	1700160 2907740	2907740	804	1700750 2901320	2901320	4	07147-35	0-4 1/2"
406 &	406-SF	1700170 2901310	406 SEP	1700180 2907740	2907740	806	1700740 2901320	2901320	5	07147-35	1-5 1/2"
408 &	408-SF	1700190 2901310	408 SEP	1700210 2907740	2907740	808	1700190 2907930	2907930	6	07181-35	1 5/8-6 1/2"
410 &	410-SF	1700190 2901310	410 SEP	1700210 2907740	2907740	810	1700190 2907930	2907930	8	07181-35	3 5/8-8 1/2"
412 &	412-SF	1700220 2901310	412 SEP	1700230 2907740	2907740	812	1700630 2907930	2907930	10	07181-35	5 5/8-10 1/2"
									12	07181-35	7 7/8-12 1/4"
WILTON "400 STG" & "400 SFSG" SERIES C-CLAMPS, REGULAR DUTY MODELS WITH WILTON-GRIP HANDLES*			WILTON "100" SERIES FORGED C-CLAMPS HEAVY DUTY MODELS			WILTON "800-P" SERIES FORGED C-CLAMPS, REGULAR DUTY MODELS WITH COPPER PLATED PADS AND SPINDLES			WILTON "0" SERIES EXTRA HEAVY DUTY DROP FORGED STEEL FRAMES WITH FULL CLOSING SPINDLES		
402 STG &	SFSG	1701080 2901300	102	1700010 2901300	2901300	802-P	1701090 2901400	2901400	0 FC	20201-35	0-3/4"
403 STG &	SFSG	1701160 2901300	103	1700020 2901300	2901300	803-P	1701110 2901400	2901400	1 FC	20202-35	0-1 7/16"
404 STG &	SFSG	1700150 2901310	104	1700030 2901310	2901310	804-P	1701370 2901350	2901350	1-1/2FC	20203-35	0-1 7/8"
406 STG &	SFSG	1700170 2901310	106	1700030 2901310	2901310	806-P	1701380 2901350	2901350	2 FC	07142-35	0-2 3/8"
408 STG &	SFSG	1700190 2901310	108	1700030 2901310	2901310	808-P	1700210 2901410	2901410	3 FC	07161-35	0-3 3/8"
410 STG &	SFSG	1700190 2901310	110	1700030 2901310	2901310	810-P	1700210 2901410	2901410	4 FC	07147-35	0-4 1/2"
			112	1700030 2901310	2901310	812-P	1701420 2901410	2901410	5 FC	07162-35	0-5 1/2"
									6 FC	07149-35	0-6 1/2"
									8 FC	07150-35	0-8 1/2"
									10 FC	07151-35	0-10 1/2"
									12 FC	07152-35	0-12 1/4"
WILTON "400-P" SERIES C-CLAMPS REGULAR DUTY, EXTRA DEEP THROAT WITH COPPER PLATED PADS & SPINDLES			WILTON SQUARE THROAT FORGED C-CLAMPS, STANDARD DUTY MODELS			COPPER PLATED SPINDLES AND SERRATED PADS			* REPLACEMENT SPINDLE ASSEMBLY DOES NOT INCLUDE WILTON-GRIP HANDLES.		
402-P		1701090 2901330	4404	1700150 2901310	2901310						
403-P		1701110 2901330	4406	1700170 2901310	2901310						
404-P		1700160 2901340	4408	1700170 2901310	2901310						
406-P		1700180 2901340	COPPER PLATED SPINDLES AND SERRATED PADS								
408-P		1700210 2901340	4404 SEP	1700160 2907740	2907740						
410-P		1700210 2901340	4406 SEP	1700180 2907740	2907740						
412-P		1700230 2901340	4408 SEP	1700180 2907740	2907740						