



SERVICE PARTS LIST

BUL. 54-38-3108

9" DISC SANDER

REVISED BUL 54-38-3107 DATE Jan, '70

Catalog No. 6060

Starting Serial No. **48-86522**

WIRING INSTR. **58-01-0310**

Both Model and Serial No. must be furnished to obtain correct parts.

Cat. No. 6080 Tool only less backing discs and hub assembly.
 Cat. No. 6100 Welders Kit See catalog for list of accessories.

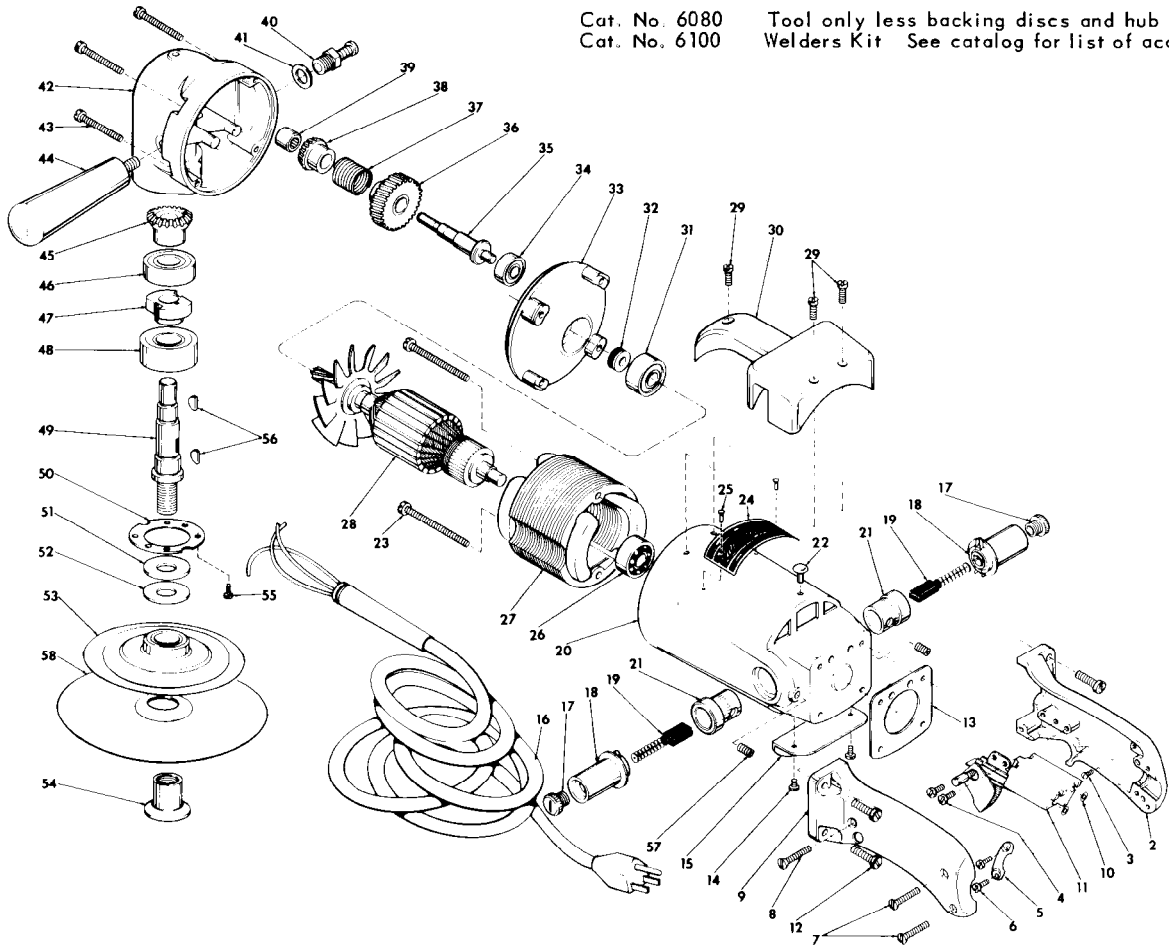

FIG.	PART NO.	DESCRIPTION OF PART	NO.REQ.	FIG.	PART NO.	DESCRIPTION OF PART	NO.REQ.
1	14-78-0100	Switch Handle Assembly (includes Fig. Nos. 2 thru 9)		30	31-70-0100	Tool Rest	
2	28-44-1041	Handle (Switch Mount Side)		31	02-04-1340	Ball Bearing	
3	06-81-8625	6-32x1/4 Rd.Hd. Bronze		32	45-28-0080	Grease Slinger	
4	06-81-5400	8-32x5/16 Binder Sem	(2)	33	28-28-0381	Diaphragm	
5	28-17-0200	Clamp Strap		34	02-04-0910	Ball Bearing	
6	06-81-6150	8-32x1/2 Fil.Hd. Sem	(2)	35	36-66-3301	Intermediate Shaft	
7	06-81-3700	8-32x7/8 Oval Hd. Screw	(2)	36	32-40-1481	Intermediate Gear	
8	06-81-3750	8-32x1 Oval Hd. Screw		37	40-50-3200	Clutch Spring	
9	28-44-9081	Handle (Switch Cover Side)		38	32-50-1261	Miter Gear (Sold with fig.45 as a set)	
10	06-97-1800	Lockwasher	(4)	39	02-50-2130	Needle Bearing	
11	23-66-0250	Switch		40	44-20-0060	Spindle Lock Assembly	
★12	06-81-7620	12-28x3/4 Fil.Hd. Sem	(4)	41	45-88-5320	Flat Washer	
13	43-86-0050	Handle Insulator		42	28-14-0610	Gear Case	
14	06-81-8650	6-32x1/4 Rd.Hd. Sem	(2)	43	06-81-7300	10-24x1-3/4 Fil.Hd. Sem	(4)
15	44-66-0100	Cover Plate		44	43-62-0141	Side Handle	
16	22-64-0090	Cord Set		45	32-50-1241	Miter Gear (Refer to fig.38)	
17	23-44-0065	Brush Retaining Screw	(2)	46	02-04-1710	Ball Bearing	
18	22-22-0130	Brush Holder Assembly	(2)	47	42-74-0061	Spindle Lock Cog	
19	22-18-0260	Carbon Brush Assembly	(2)	48	02-04-2060	Ball Bearing	
★20	28-50-4563	Motor Housing Assembly (includes Fig. Nos. 21 thru 23)		49	38-50-1751	Spindle	
21	22-24-0100	Bushing	(2)	50	45-88-0220	Retaining Washer	
22	06-77-1400	14x5/16 Driv-In Screw		51	45-88-0141	Thrust Washer	
23	06-81-9225	10-24x2-3/4 Round Sem	(2)	52	45-88-0160	Rubber Washer	
24	12-98-3500	Nameplate		53	48-80-0750	5" Flat Disc Hub Assembly	
★25	06-77-0625	6x1/4 Rd. Drive-In Screw	(2)	54	44-40-0120	Disc Nut	
26	02-04-1070	Ball Bearing		55	06-81-6050	8-32x5/16 Fil.Hd. Sem	(6)
27	18-82-1180	115 Volt Field		56	06-42-1600	Woodruff Key	(2)
28	16-82-1710	115 Volt Armature		★57	06-83-2725	1/4-28x3/8 Hdls. Set Screw	(2)
29	06-81-6950	10-24x1/2 Fil.Hd. Sem	(3)	58	48-80-0900	7" Flat Backing Disc	
					48-80-1100	9" Flat Backing Disc	