

PORTER-CABLE DEMOLITION HAMMER

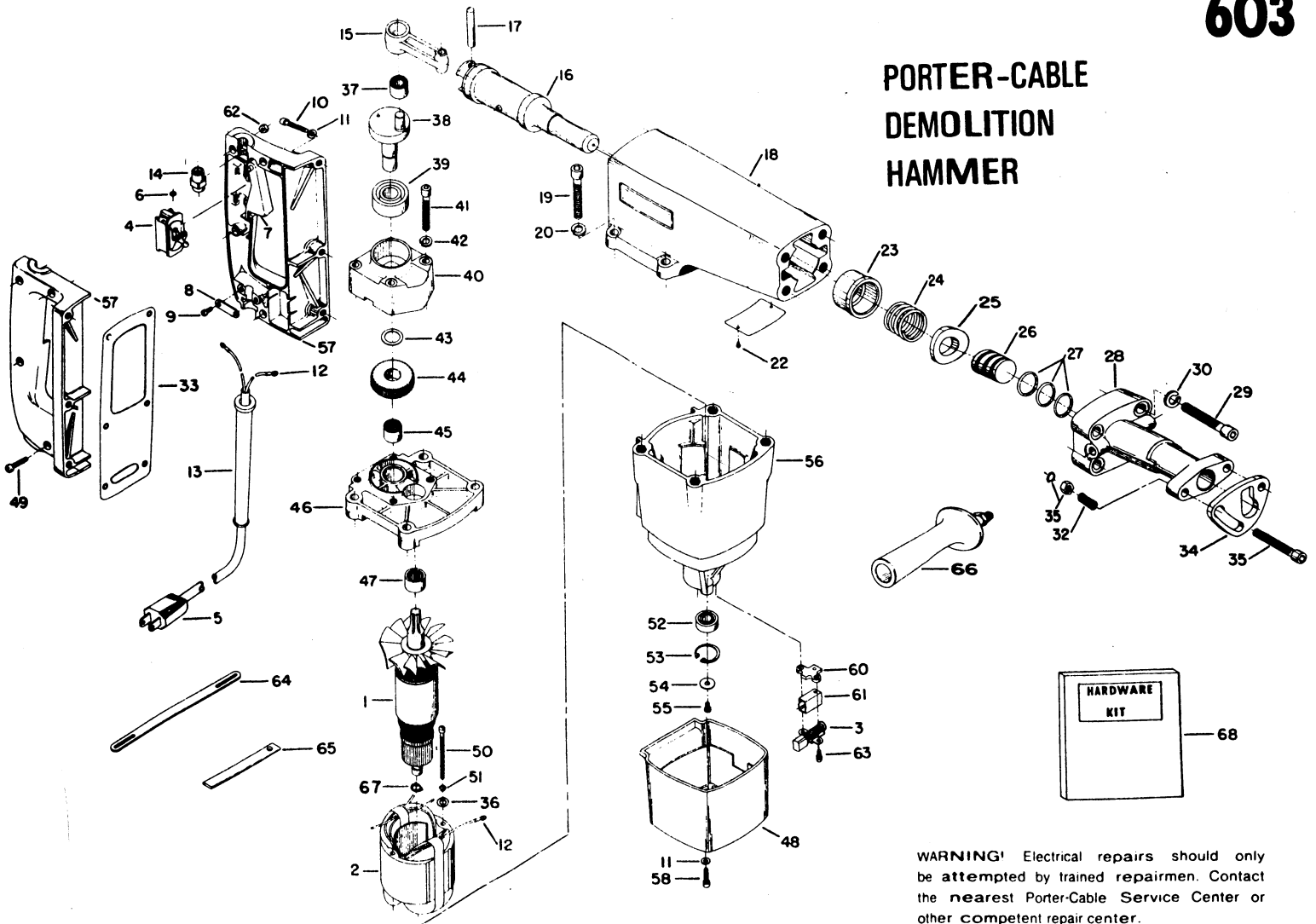

WARNING! Electrical repairs should only be attempted by trained repairmen. Contact the nearest Porter-Cable Service Center or other competent repair center.

Ref. No.	Part No.	Description	Ref. No.	Part No.	Description	Ref. No.	Part No.	Description
1	862961	Armature	34	862934	Latch	65	863599	Latch Release
2	862962	Field	35	862931**	Screw Package Incl: Nut and Snap Ring	66	810820	Auxiliary Handle
3	861677	Brush and Spring	36	846619	Washer	67	845979	Retaining Ring
4	847546	Switch	37	864841**	Bearing	68	867347**	Hardware Kit
5	862234	Cord Set	38	861349	Crankshaft	*	810984	Fan
6	802209	Lock Washer	39	855182	Bearing	LUBRICANTS		
7	862572	Switch Actuator	40	861342	Gear Housing	59842		Gear Lubricant (6 oz.)(170 gm.)
8	850550	Cord Clamp	41	861388**	Screw	18338		Bearing Lubricant
9	859227**	Screw	42	803222	Lock Washer	863106		Gear Lubricant (4 lbs.)(1811 gm.)
10	852705**	Screw	43	861398	Washer	** SERVICE SPECS **		
11	860550	Washer	44	861346	Gear	Ref. 9		Torque 15 - 20 in. lbs.
12	862450	Terminal	45	859767**	Bearing	Ref. 10		Torque 50 - 55 in. lbs.
13	838487	Strain Reliever	46	862237	Intermediate Plate	Ref. 19		Torque 45 - 50 ft. lbs.
14	860188	Insert	47	864842**	Bearing	Ref. 29		Torque 45 - 50 ft. lbs.
15	852020	Connecting Rod	48	862954	Motor Housing Cover	Ref. 35		Screw nut past ring groove. Place ring in groove and back off nut to ring
16	862746	Piston Assembly	49	802589**	Screw	Ref. 37		Loctite and press flush
17	861357	Pin	50	864927**	Screw	Ref. 39		Press flush
18	864126	Hammer Housing	51	802430	Lock Washer	Ref. 41		Torque 25 - 28 ft. lbs.
19	861406**	Screw	52	860572	Bearing	Ref. 45		Press flush on stamp face
20	857901	Lock Washer	53	859382	Retaining Ring	Ref. 47		Press flush
22	801896	Drive Screw	54	802412	Washer	Ref. 49		Torque 20 - 25 in. lbs.
23	862008	Spring Holder	55	860575**	Screw	Ref. 50		Loctite and torque 50 - 55 in. lbs.
24	862004	Spring	56	862953	Motor Housing	Ref. 55		Torque 25 - 30 in. lbs. (L.H.Thd.)
25	862009	Nose Plug Seat	57	862955	Handle Set	Ref. 58		Torque 50 - 55 in. lbs.
26	862005	Nose Seal Plug	58	804486**	Screw	Ref. 63		Torque 10 - 15 in. lbs.
27	862006	"O" Ring	60	863553	Insulator	Ref. 68		See Service Notes
28	862935	Nose	61	851974	Brush Holder			
29	861389**	Screw	62	862641	Nut			
30	862725	Lock Washer	63	801443	Screw and Lock Washer			
32	864875	Spring	64	56508	Wrench Holder			
33	864940	Gasket						

SERVICE NOTES

603

ARMATURE ROTATION

It is extremely important that when a repair is completed on this model, the direction of rotation be checked. Looking at the commutator end, the armature should be turning clockwise. An armature turning in reverse will cause the unit to heat excessively.

NOSE

Reference 35 screw is now packaged with a nut and snap ring. Install the screw, latch plate, spacer, spring and nut. Turn the nut on the screw beyond the snap ring groove located on the screw. Install the snap ring and back off nut to the snap ring.

We recommend changing the early type bolt and lock nut to the bolt, nut and snap ring design. However, if the bolt and lock nut is used, draw down the nut to compress the spring to a distance of $31/32$ ". (See Diagram Below)

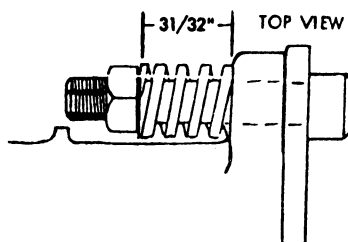

HARDWARE KIT

Hardware Kit includes the following reference numbers for use when complete tear-down is required: 3, 9, 10, 11, 12, 19, 20, 22, 27, 29, 30, 35, 36, 41, 42, 43, 49, 50, 51, 54, 55, 58, 62, 63, 67.