



# SERVICE PARTS LIST

## 9" POLISHER

**Catalog No. 5590**

Starting Serial No. **47-9416**

Specify Catalog and Serial No. when ordering parts

**BUL. 54-32-1218**

REVISED BUL.  
54-32-1217

DATE  
June '74

WIRING INSTRUCTIONS  
**58-01-0310**

1450 R.P.M.

FOR 230V TOOL USE:  
22-64-2090 CORD SET  
18-86-1100 FIELD  
16-86-1160 ARMATURE

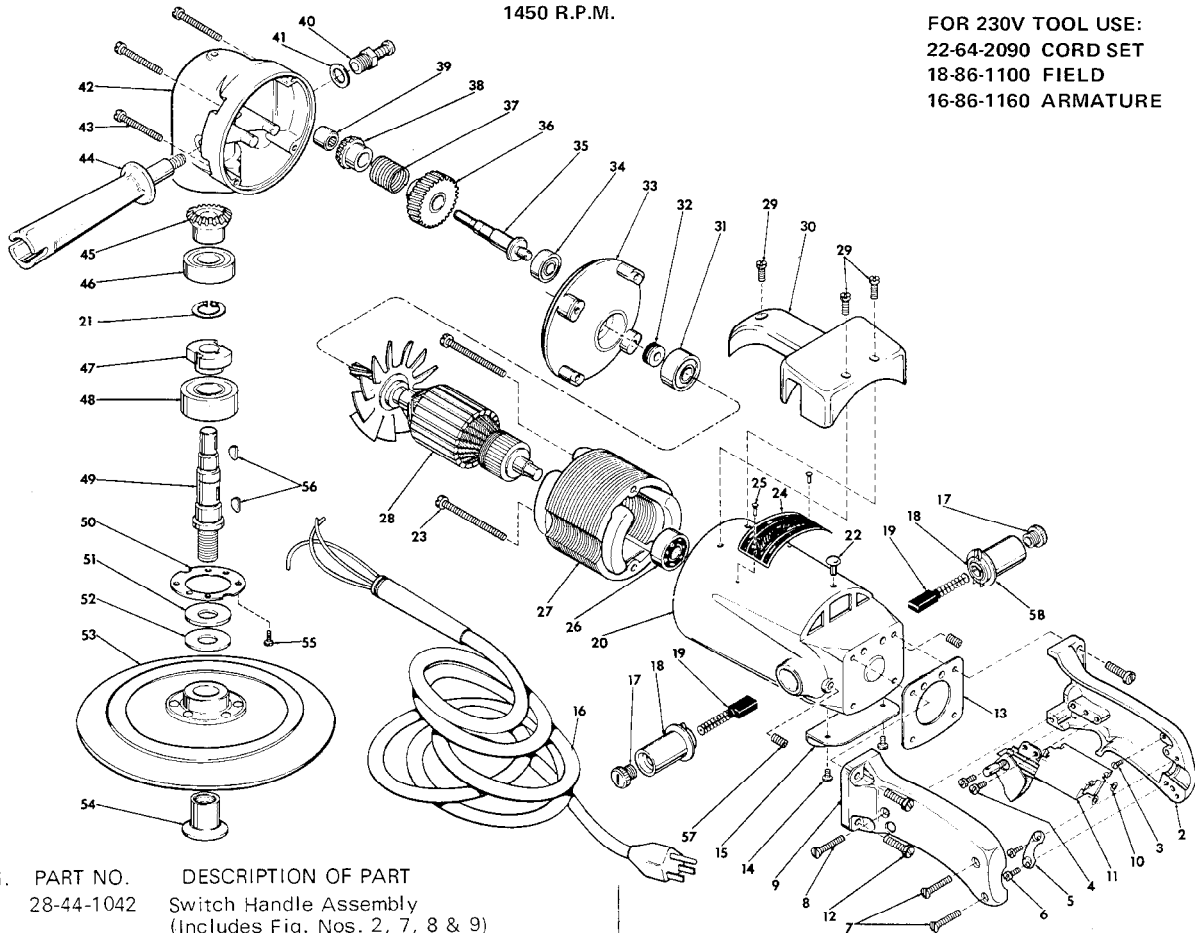

FIG.	PART NO.	DESCRIPTION OF PART	NO. REQ.
★ 1	28-44-1042	Switch Handle Assembly (Includes Fig. Nos. 2, 7, 8 & 9)	(1)
2	—	Handle (Switch Mount Side)	(1)
3	06-81-8625	6-32x1/4 Ground Screw	(1)
4	06-81-5400	8-32x5/16 Binder Sem	(2)
5	28-17-0200	Clamp Strap	(1)
6	06-81-6150	8-32x1/2 Fil. Hd. Sem	(2)
7	06-81-3700	8-32x7/8 Oval Hd. Screw	(2)
8	06-81-3750	8-32x1 Oval Hd. Screw	(1)
9	—	Handle (Switch Cover Side)	(1)
10	06-97-1800	Lockwasher	(4)
11	23-66-0250	Switch	(1)
12	06-81-7620	12-28x3/4 Fil. Hd. Sem	(4)
13	43-86-0050	Handle Insulator	(1)
14	06-81-8650	6-32x1/4 Rd. Hd. Sem	(2)
15	44-66-0100	Cover Plate	(1)
16	22-64-0090	Cord Set	(1)
17	23-44-0065	Brush Retaining Screw	(2)
★ 18	22-22-0291	Brush Holder Assy.	(2)
19	22-18-0260	Carbon Brush Assy.	(2)
★ 20	28-50-4564	Motor Housing	(1)
★ 21	34-60-1290	Retaining Ring	(1)
22	06-77-1400	14x5/16 Driv-In Screw	(1)
23	06-81-9200	10-24x2-1/2 Rd. Hd. Sem	(2)
★ 24	12-99-0032	Nameplate	(1)
★ 25	06-85-0200	6x1/4 Rd. Hd. Type Z Screw	(2)
26	02-04-1070	Ball Bearing	(1)
27	18-82-1110	115 Volt Field	(1)
28	16-82-1180	115 Volt Armature	(1)
29	06-81-6950	10-24x1/2 Fil. Hd. Sem	(3)
30	31-70-0100	Tool Rest:	(1)
31	02-04-1140	Ball Bearing	(1)

FIG.	PART NO.	DESCRIPTION OF PART	NO. REQ.
32	45-28-0050	Grease Slinger	(1)
33	28-28-0381	Diaphragm	(1)
34	02-04-0910	Ball Bearing	(1)
35	36-66-1701	Intermediate Shaft	(1)
36	32-40-1181	Intermediate Gear	(1)
37	40-50-3100	Drive Spring	(1)
38	32-05-1022	Bevel Gear (Sold with Fig. 45 as set)	(1)
39	02-50-2130	Needle Bearing	(1)
40	44-20-0060	Spindle Lock Assembly	(1)
41	45-88-5320	Flat Washer	(1)
42	28-14-0610	Gear Case	(1)
43	06-81-7300	10-24x1-3/4 Fil. Hd. Sem	(4)
★ 44	43-62-0570	Side Handle	(1)
45	32-05-1001	Bevel Gear (Refer to Fig. 38)	(1)
46	02-04-1710	Ball Bearing	(1)
★ 47	42-74-0065	Spindle Lock Cog	(1)
48	02-04-2060	Ball Bearing	(1)
49	38-50-1751	Spindle	(1)
50	45-88-0220	Retaining Washer	(1)
51	45-88-0141	Thrust Washer	(1)
52	45-88-0160	Rubber Washer	(1)
53	49-36-2200	Polisher Backing Pad	(1)
★ 54	49-40-0160	Disc Nut	(1)
55	06-81-6050	8-32x5/16 Fil. Hd. Sem	(6)
56	06-42-1600	Woodruff Key	(2)
57	06-83-2725	1/4x28x3/8 Hdls. Set Screw	(2)
58	23-86-0060	Insulating Washer	(2)
★ 59	12-98-7081	Caution Plate (Not Shown)	(1)