



# SERVICE PARTS LIST

BUL. 54-32-1004

7" POLISHER

REVISED BUL. 6100-5 DATE Feb. '68

Catalog No. 5450

Starting Serial No. 100-6245

WIRING INSTR.

Both Model and Serial No. must be furnished to obtain correct parts.

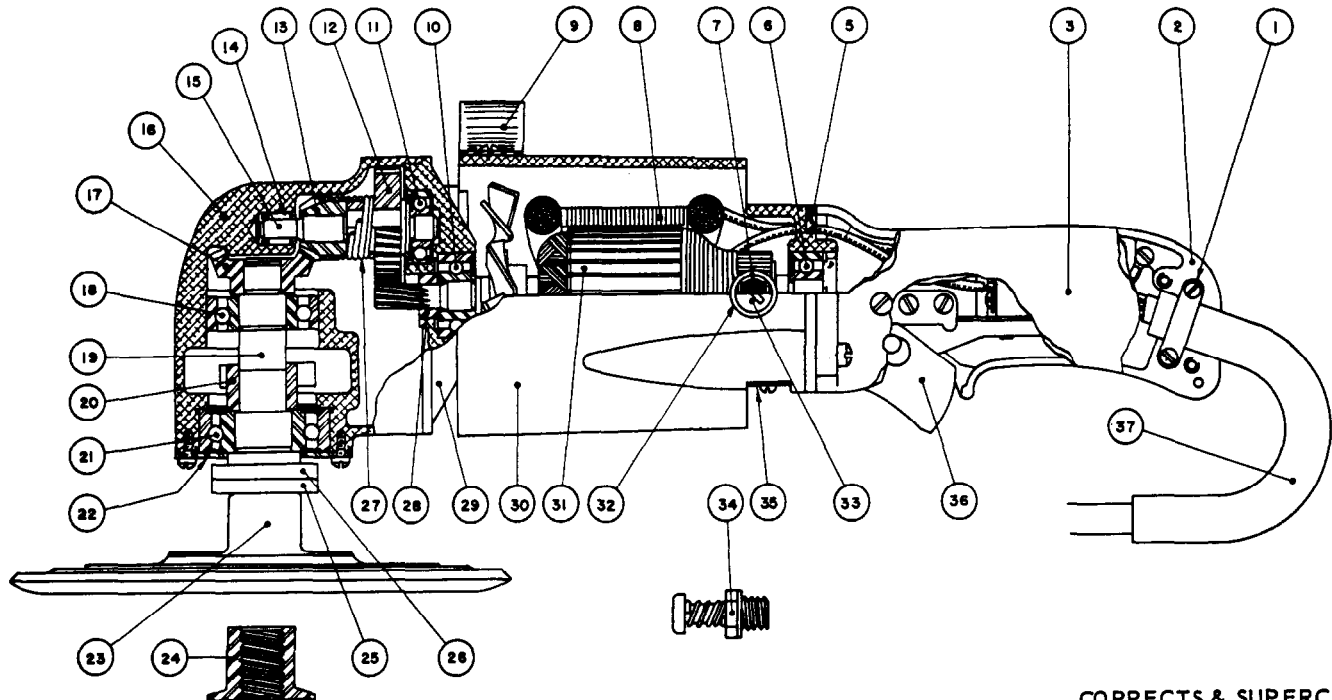

CORRECTS & SUPERCEDES SERVICE BULLETIN 6100-5 DATED 11/28/58

### ILLUSTRATED PARTS

FIG.	PART NO.	DESCRIPTION OF PART	FIG.	PART NO.	DESCRIPTION OF PART
1	28-17-0200	Cord Clamp Strap	19	38-50-3751	Spindle
2	28-44-1041	Handle (Switch Mounting Side)	20	42-74-0061	Spindle Locking Cog
3	28-44-9081	Handle (Switch Cover Side)	21	02-04-2060	Ball Bearing (Lower)
5	43-86-0050	Handle Insulator	22	45-88-0220	Ball Bearing Retaining Washer
6	02-04-0960	Ball Bearing (Comm. End)	23	49-36-2500	Rubber Backing Pad
7	22-18-0105	Carbon Brush Assemblies (per set)	24	44-40-0160	Disc Nut (5/8-11 Thread)
8	18-62-1030	Field Assembly	25	45-88-0160	Hub Rubber Washer
9	28-79-0321	Tool Rest	26	45-88-0141	Hub Steel Washer
10	02-04-1070	Ball Bearing (Pinion End)	27	40-50-3100	Drive Spring
11	02-04-0910	Ball Bearing	28	45-28-0070	Grease Slinger
12	32-40-1401	Intermediate Gear	29	28-28-1101	Diaphragm
13	32-05-1081	Bevel Gear (Sold only with 32-05-1101 as set)	30	28-50-4881	Motor Housing
14	02-50-1630	Needle Bearing	31	16-62-1030	Armature Assembly
15	36-66-3251	Intermediate Shaft	32	22-22-0090	Brush Holder Assemblies (2)
16	28-14-1082	Gear Case	33	23-44-0065	Brush Retaining Cap (2)
17	32-05-1081	Bevel Gear (See Item 13)	34	44-20-0060	Spindle Lock Assembly
18	02-04-1710	Ball Bearing (Upper)	35	44-66-0230	Commutator Cover Plate (2)
			36	23-66-0270	Switch Assembly
			37	22-64-0090	Cord Set

### MISCELLANEOUS PARTS NOT SHOWN

PART NO.	DESCRIPTION OF PART	PART NO.	DESCRIPTION OF PART
12-98-2500	Name Plate	06-81-5400	8-32x5/16 Bind Hd. Switch Mounting Scs. Sems (2)
43-62-0140	Wooden Side Handle Assembly	06-81-8625	6-32x1/4 (Brass) Rd.Hd. Ground Wire Scs. Sems
06-81-6950	10-24x1/2 Fil.Hd. Sem Tool Rest Screw (2)	06-81-3750	8-32x1 Oval Hd. Handle Cover Screw
06-81-3650	8-32x3/4 Oval Hd. Switch Handle Screws (4)	06-81-6100	8-32x7/16 Fil.Hd. Cord Clamp Strap Scs. Sem
06-81-7300	10-24x1-3/4 Fil.Hd. Gear Case Screws (4)	06-81-6750	8-32x2-1/2 Fil.Hd. Field Screws Sems (2)
06-81-3700	8-32x7/8 Oval Hd. Handle Cover Screws (2)	06-81-8650	6-32x1/4 Rd.Hd. Sems Commutator Cover Scs. (2)
06-83-2650	1/4-20x3/8 Unbrako Knurled Point Soc. Hd. Hd <sup>l</sup> less Brush Holder Set Sc. (2)	06-81-6050	8-32x5/16 Fil.Hd. Sems Ball Brg. Ret. Washer Scs. (6)
48-03-0010	Attachment Plug Adaptor	06-81-8200	4-36x3/16 Rd.Hd. Sems Name Plate Screws (2)