



# SERVICE PARTS LIST

**BUL. 54-24-1100**

## 1/2" ELECTRIC HAMMER

REVISED BUL. 6275-1      DATE Feb. '68

**Catalog No. 5320**

Starting Serial No. **275-1001**

WIRING INSTR.

Both Model and Serial No. must be furnished to obtain correct parts.

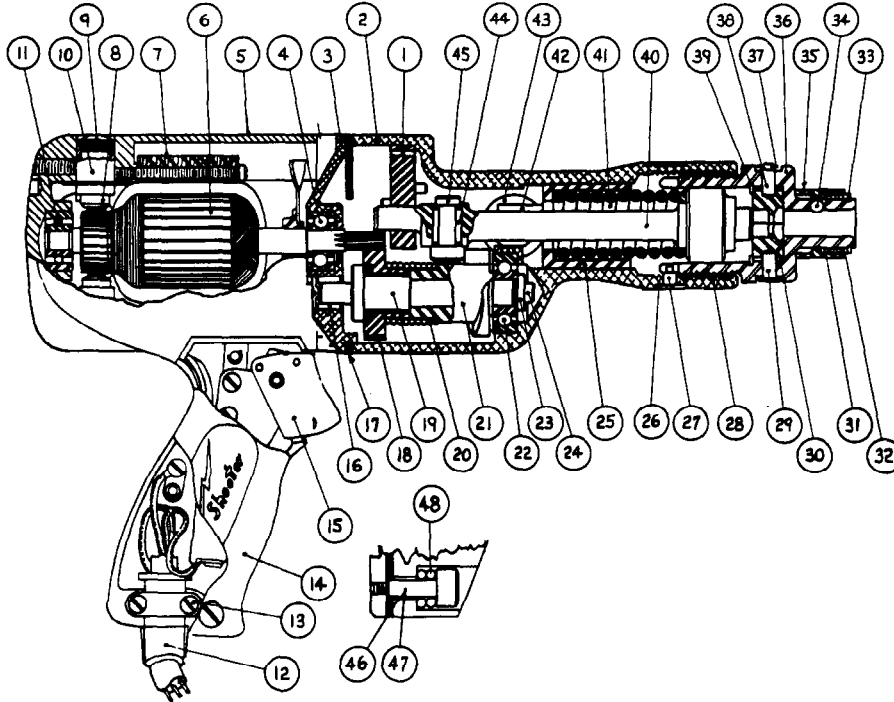

FIG.	PART NO.	DESCRIPTION OF PART
1	42-24-0075	Ram Bearing (Rear)
2	28-14-0101	Gear Case
3	28-28-0011	Diaphragm
4	02-04-0740	Ball Bearing (Pinion End)
5	28-50-4601	Motor Housing
6	16-22-1180	Armature Assembly
7	18-22-1080	Field Assembly
8	22-18-0090	Carbon Brush Assembly
9	23-44-0020	Brush Retaining Cap
10	22-22-0050	Brush Holder Assembly
11	02-04-0740	Ball Bearing (Comm. End)
12	22-64-0170	Cord Set
13	28-17-0400	Cord Clamp
14	28-20-3171	Switch Cover Plate
15	23-66-0290	Switch
16	02-50-2020	Needle Bearing
17	43-44-0020	Shock Absorber Gasket
18	32-75-1011	Spur Gear
19	36-10-0051	Cam Shaft
20	40-50-3100	Drive Spring
21	42-50-0057	Cam
22	02-04-1030	Ball Bearing
23	44-86-0075	Bearing Retainer
24	06-75-2050	8-32x1/2 Socket Hd. Cap Screw

**ILLUSTRATED PARTS**

FIG.	PART NO.	DESCRIPTION OF PART
25	43-76-0030	Spring Housing
26	40-50-0815	Nose Lock Spring
27	44-60-0117	Nose Locking Pin
28	06-38-0200	Heli-Coil
29	44-60-0241	Blow Check Pin
30	42-62-0060	Blow Check (Sold in Pairs Only)
31	40-50-1000	Collar Stop Spring
(2)	32	45-88-0063 Collar Stop Washer
(2)	33	34-60-1575 Spirolox Retaining Ring
(2)	34	02-02-0180 Bit Retainer Plug
	35	42-76-0063 Bit Retainer Collar
	36	42-56-0090 Casing Nose
	37	40-50-0817 Blow Check Spring
	38	44-60-0231 Blow Check Guide Pin
	39	34-80-2000 Retainer Ring
	40	44-82-0050 Ram
	41	40-50-0810 Spring
	42	42-50-0055 Adjusting Cam
	43	42-40-0055 Adjusting Cam Bushing
	44	02-55-0100 Needle (18)
	45	44-60-0115 Rotary Pin
	46	06-15-0100 Stripper Bolt 1/4x1/2 Lg. with 10-24 (2)
	47	06-15-0400 Stripper Bolt 1/4x1/4 Lg. with 10-24 (2)
	48	34-40-3000 'O' Ring

**MISCELLANEOUS PARTS NOT SHOWN**

PART NO.	DESCRIPTION OF PART	QUANTITY	PART NO.	DESCRIPTION OF PART	QUANTITY
06-83-2670	1/4-20x1/2 Brush Holder Set Screw	(2)	06-97-3400	Split Ring Lock Washer	(2)
06-81-6150	8-32x1/2 Fil.Hd.Sem Gear Case Screws	(4)	06-42-0400	Woodruff Key	
06-81-5400	8-32x5/16 Binder Hd. Switch Mounting Scs.	(2)	06-65-0825	1/8x1/2 Type S Groove Pin	
06-81-3650	8-32x3/4 Oval Hd. Handle Cover Screw		44-66-0110	Air Intake Cover Plate	(2)
06-81-3700	8-32x7/8 Oval Hd. Handle Cover Screws	(2)	43-33-0050	Alemite Fitting Type 1610	
06-81-4300	3-48x3/16 Rd.Hd. Name Plate Screws	(2)	06-75-2100	10-24x3/4 Socket Hd. Cap Screw	(2)
06-81-5950	6-32x1-7/8 Fil.Hd.Sem Field Screws	(2)	06-83-2280	10-24x3/8 Cone Pt. Set Screw	
06-81-8650	6-32x1/4 Rd.Hd. Vent Plate Screws	(4)		Name Plate	
06-81-8625	6-32x1/4 Rd.Hd. Sem Ground Wire Screw		49-14-0100	Grease Gun	
06-81-0900	8-32x7/16 Fil.Hd. Cord Clamp Screws	(2)	49-96-0100	1/4 Allen Wrench	

Numbers in brackets indicate number required.