

SERVICE PARTS LIST

BULLETIN NO.
55-22-1220

SPECIFY CATALOG NO. AND SERIAL NO. WHEN ORDERING PARTS		REVISED BULLETIN	DATE
1/2 H.P. BENCH GRINDER W/LIGHTED EYESHIELDS			May '91
CATALOG NO. 4991-2	SERIAL NUMBER W-4-91	WIRING INSTRUCTION	
		58-01-0026	

00 | 0

EXAMPLE:
Component Parts (Small #) Are Included
When Ordering The Assembly (Large #).

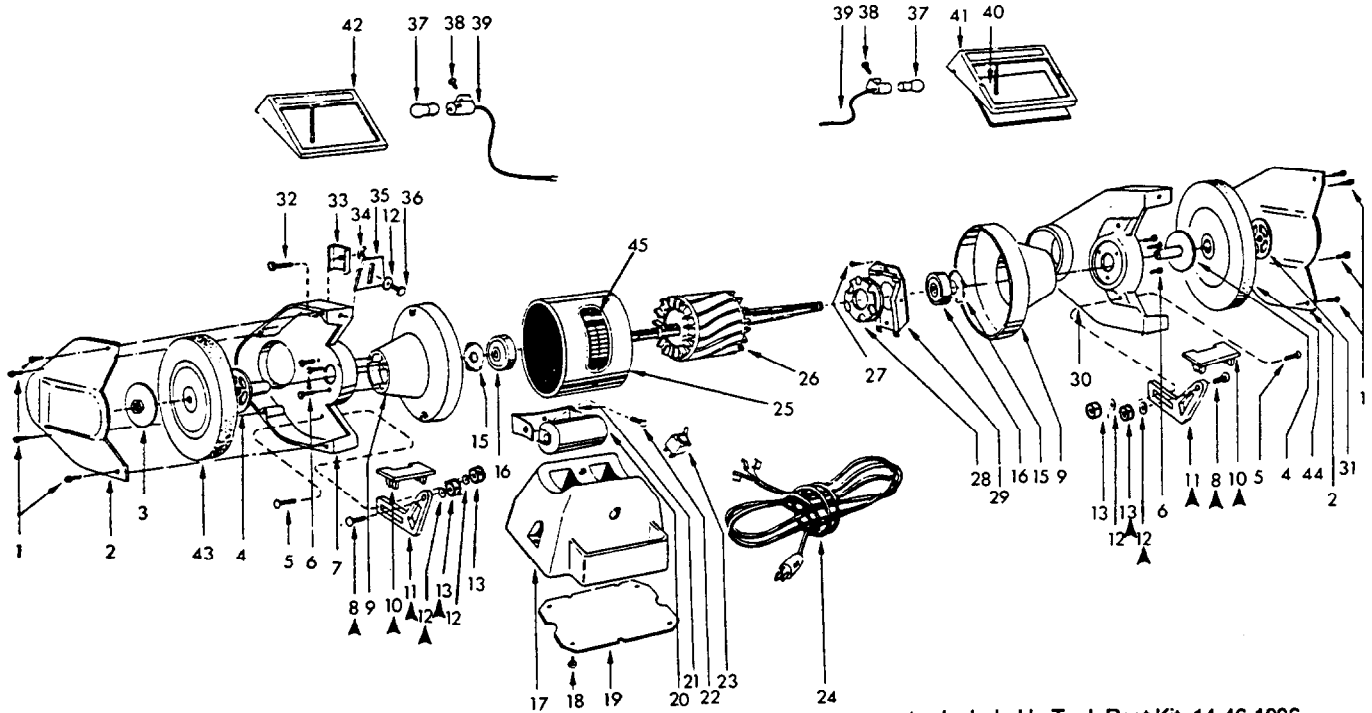

▲ = Included in Tool Rest Kit, 14-46-1096

FIG.	PART NO.	DESCRIPTION OF PART	NO. REQ.
1	06-95-0325	Self Tapping Screw	(8)
2	42-92-0690	Guard Cover	(2)
3	43-34-0660	Left Flange w/Hex Nut	(1)
4	43-34-0620	Wheel Flange	(2)
5	06-75-0535	Cap Screw 3/8-16 x 1-1/4	(2)
6	06-75-0090	Cap Screw 1/4-20 x 5/8	(6)
7	43-54-0600	Left Guard	(1)
8	06-10-1300	Carriage Bolt 3/8-16 x 1-1/2	(2)
9	42-25-2540	Endbell	(2)
10	44-85-0200	Tool Rest	(2)
11	42-09-0020	Tool Rest Arm	(2)
12	45-88-8090	Washer 3/8 Flat	(4)
13	06-55-2500	Hex Nut 3/8-16	(4)
15	45-88-8110	Bearing Felt Washer	(2)
16	02-04-1745	Bearing	(2)
17	42-20-0630	Base	(1)
18	42-38-0250	Rubber Foot	(4)
19	44-66-5670	Base Plate	(1)
20	22-33-0400	Capacitor	(1)
21	22-40-0130	Capacitor Bracket	(1)
22	06-81-2661	Machine Screw Flat Hd. #10-24x3/8	(1)
23	23-66-1560	Toggle Switch	(1)
24	22-64-4155	Cord Set	(1)
25	23-58-0770	Stator(With Internal Coils for Lights)	(1)
26	23-40-0610	Rotor (Incl. Fig. 29)	(1)
27	06-95-0110	Self Tapping Screw	(2)
28	23-66-1600	Stationary Switch	(1)
29	23-66-1570	Rotary Switch	(1)

FIG.	PART NO.	DESCRIPTION OF PART	NO. REQ.
30	43-54-0610	Right Guard	(1)
31	43-34-0670	Right Flange with Hex Nut	(1)
32	06-75-0150	Cap Screw 1/4-20 x 1	(2)
33	42-70-5060	Eyeshield Clip	(2)
34	06-59-2000	Wing Nut 1/4-20	(2)
35	45-12-0390	Spark Shield	(2)
36	06-75-0296	Self Tapping Screw 5/16-18 x 1/2	(2)
37	22-23-0010	Automotive Bulb	(2)
38	06-75-0022	Cap Screw #10-24 x 5/16	(2)
39	23-33-0430	Light Socket	(2)
40	49-62-0115	Replacement Plexiglass Lens	(2)
41	43-40-0260	Right Eyeshield Frame (Incl. Fig. 40)	(1)
42	43-40-0270	Left Eyeshield Frame (Incl. Fig. 40)	(1)
43		Grinding Wheel 7x1x5/8 (See Catalog)	(1)
44		Grinding Wheel 7x1x5/8 (See Catalog)	(1)
45	12-99-0460	Nameplate Blank	(1)

PARTS NOT SHOWN

14-46-1096	Tool Rest Kit	(1)
06-08-0060	Thru Bolt #10-24x7-3/4"	(2)
(Used to Secure Endbells to Stator)		
06-55-1050	Hex Nut #10-24	(4)
(2 Used On The End Of Each 06-08-0060 Thru Bolt)		
22-90-0180	Grommet (For Cord Set)	(1)

MILWAUKEE ELECTRIC TOOL CORPORATION
13135 W. LISBON RD., BROOKFIELD, WI 53005