



# SERVICE PARTS LIST

**BULLETIN NO.**  
54-22-1200

SPECIFY CATALOG NO. AND SERIAL NO. WHEN ORDERING PARTS		REVISED BULLETIN	DATE
1/3 H.P. BENCH GRINDER W/ LIGHTED EYESHIELDS			Dec. '98
CATALOG NO. 4931	STARTING SERIAL NUMBER W10-86	WIRING INSTRUCTION 58-01-0026	

EXAMPLE:



Component Parts (Small #)  
Are Included When Ordering  
The Assembly (Large #).

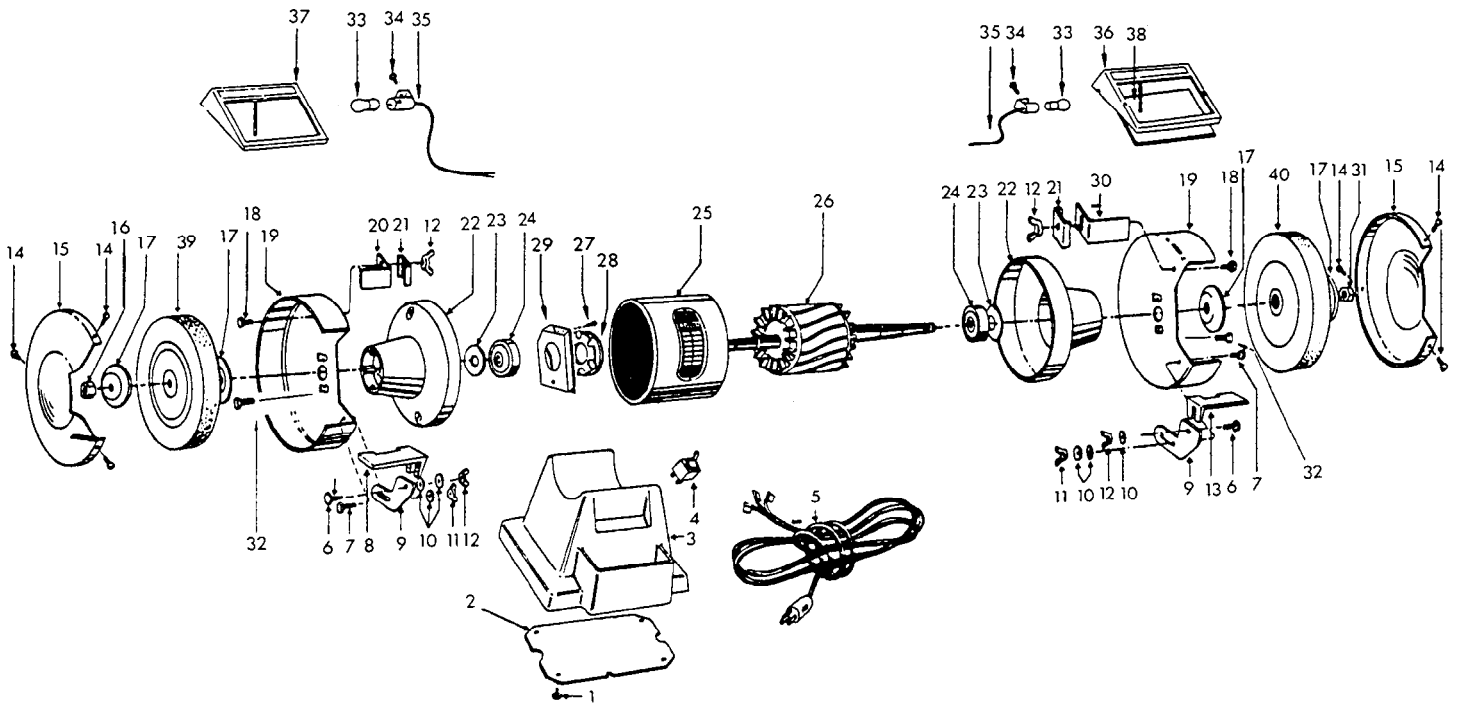

FIG.	PART NO.	DESCRIPTION OF PART	QTY
1	42-38-0250	Rubber Foot	(4)
2	44-66-5670	Base Plate	(1)
3	42-20-0630	Base	(1)
4	23-66-1560	Toggle Switch	(1)
5	22-64-1120	Cord Set	(1)
6	06-10-0400	Carriage Bolt 1/4"-20 x 1/2"	(2)
7	06-75-0296	Cap Screw 5/16"-18 x 1/2"	(2)
8	44-85-0180	Left Tool Rest	(1)
9	42-09-0010	Tool Rest Arm	(2)
10	45-88-5220	Washer 1/4" Flat	(6)
11	06-59-1500	Wing Nut 5/16"-18	(2)
12	06-59-2000	Wing Nut 1/4"-20	(4)
13	44-85-0190	Right Tool Rest	(1)
14	06-95-5225	Self Tapping Screw 8-32 x 5/16"	(6)
15	42-92-0680	Guard Cover	(2)
16	06-55-3175	Left Hand Hex Nut 1/2"-20	(1)
17	43-34-0610	Wheel Flange	(4)
18	06-10-0650	Carriage Bolt 1/2"-20 x 1"	(2)
19	43-54-0590	Guard	(2)
20	45-12-0360	Left Spark Shield	(1)
21	42-70-5060	Eyeshield Clip	(2)
22	42-25-2540	Endbell	(2)
23	45-88-8095	Bearing Felt Washer	(2)
24	02-04-1745	Bearing	(2)
25	23-58-0710	Stator, 1/3 H.P.	(1)

FIG.	PART NO.	DESCRIPTION OF PART	QTY
26	23-40-0600	Rotor, 1/3 H.P. (Incl. Fig. 28)	(1)
27	06-95-0110	Pan Head Screw Taptite 6-32 x 5/16"	(2)
28	23-66-1570	Rotary Switch	(1)
29	23-66-1600	Stationary Switch	(1)
30	45-12-0370	Right Spark Shield	(1)
31	06-55-3150	Right Hand Hex Nut 1/2"-20	(1)
32	06-75-0075	Cap Screw 1/4"-20 x 51/2"	(4)
33	22-23-0010	Automotive Bulb	(2)
34	06-75-0022	Cap Screw 10-24 x 5/16"	(2)
35	23-33-0430	Light Socket	(2)
36	43-40-0260	Right Eyeshield Frame (Incl. Fig. 38)	(1)
37	43-40-0270	Left Eyeshield Frame (Incl. Fig. 38)	(1)
38	49-62-0115	Replacement Plexiglass Lens	(2)
39	-----	Grinding Wheel 6" x 3/4" x 1/2" (see catalog)	(1)
40	-----	Grinding Wheel 6" x 3/4" x 1/2" (see catalog)	(1)
---	12-99-0460	Nameplate	(1)

**Items Not Shown**

---	22-90-0180	Grommet	(1)
---	06-08-0050	Thru Bolt 10-24 x 6-3/4"	(2)
---	06-55-1050	Hex Nut 10-24	(4)