

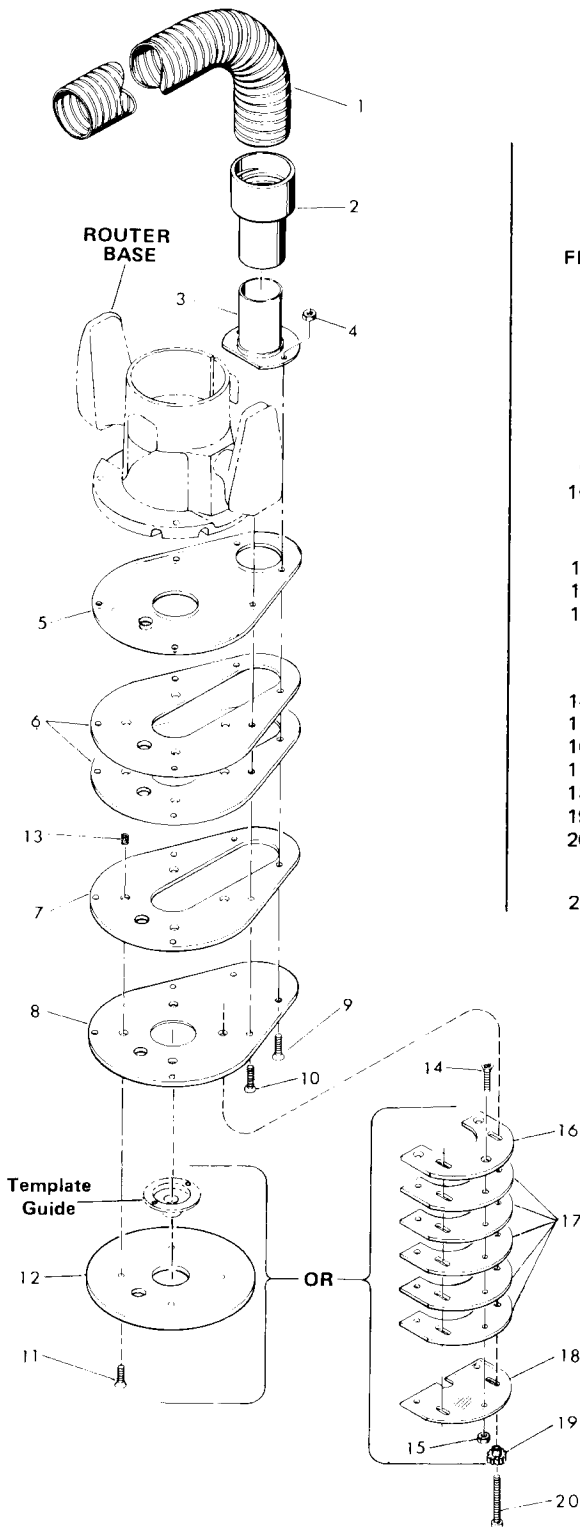

SERVICE PARTS LIST

BULLETIN NO.
54-37-0320

SPECIFY CATALOG NO. AND SERIAL NO. WHEN ORDERING PARTS		REVISED BULLETIN	DATE
ROUTER CHIP COLLECTOR			Feb. '84
CATALOG NO. 49-54-2000	STARTING SERIAL NO.	WIRING INSTRUCTION	
CAT. NO.	START SER. NO.	BILINGUAL LABEL	



ROUTER CHIP COLLECTOR KIT (Fig. Nos. 1 thru 21)

FIG.	PART NO.	DESCRIPTION OF PART	NO. REQ.
1	49-90-0060	Hose - 1-1/2" x 10'	(1)
2	42-76-0210	Hose Cuff - 1-1/2"	(2)
3	43-34-0550	Dust Extractor Port & Mounting Flange	(1)
4	06-55-1000	Hex Nut - 10-24	(2)
5	31-15-0340	Cover - Clear Plastic	(1)
6	31-86-0170	Sub. Base Filler - P.V.C.	(2)
7	28-72-0040	Sub. Base Filler - Aluminum	(1)
8	31-06-0110	Sub. Base - P.V.C.	(1)
9	06-81-2673	Machine Screw - 10-24 x 7/8" Fl. Hd.	(2)
10	06-81-2673	Machine Screw - 10-24 x 7/8" Fl. Hd.	(4)
Use Fig. Nos. 11 thru 13 w/Template Guide			
11	06-81-2667	Machine Screw - 10-32 x 3/4" Fl. Hd.	(4)
12	31-55-0170	Template Holder - P.V.C.	(1)
13	06-38-0340	Threaded Brass Insert - 10-32	(4)
Use Fig. Nos. 14 thru 20 w/Air Block Edge Guide			
14	06-81-2695	Machine Screw - 10-24 x 1-1/2" Fl. Hd.	(3)
15	06-55-1000	Hex Nut - 10-24	(3)
16	31-06-0100	Air Block Base - P.V.C.	(1)
17	31-86-0180	Air Block Fillers - P.V.C.	(5)
18	31-15-0350	Air Block Cover - Clear Plastic	(1)
19	31-75-0030	Air Block Knob - 10-32	(2)
20	06-81-4685	Machine Screw - 10-32 x 2-1/2" Rd. Hd.	(2)
21	12-98-7125	Nameplate (Not Shown)	(1)