



SERVICE PARTS LIST

BULLETIN NO.
54-04-0355

SPECIFY CATALOG NO. AND SERIAL NO. WHEN ORDERING PARTS		REVISED BULLETIN	DATE
AUTOMOTIVE CHARGER			Aug. 2002
CATALOG NO. 48-59-0186	SERIAL NUMBER A13A	WIRING INSTRUCTION	

00 0

EXAMPLE:
Component Parts (Small #)
Are Included When Ordering
The Assembly (Large #).

Rib of top housing is to separate
the terminals of circuit board
assembly and the cord set wires.

Insert strain relief
as shown with the flat side of the strain
relief positioned
against the inside
wall of the charger
housing.

White striped lead.
Connect to J1.
(Outside terminal)

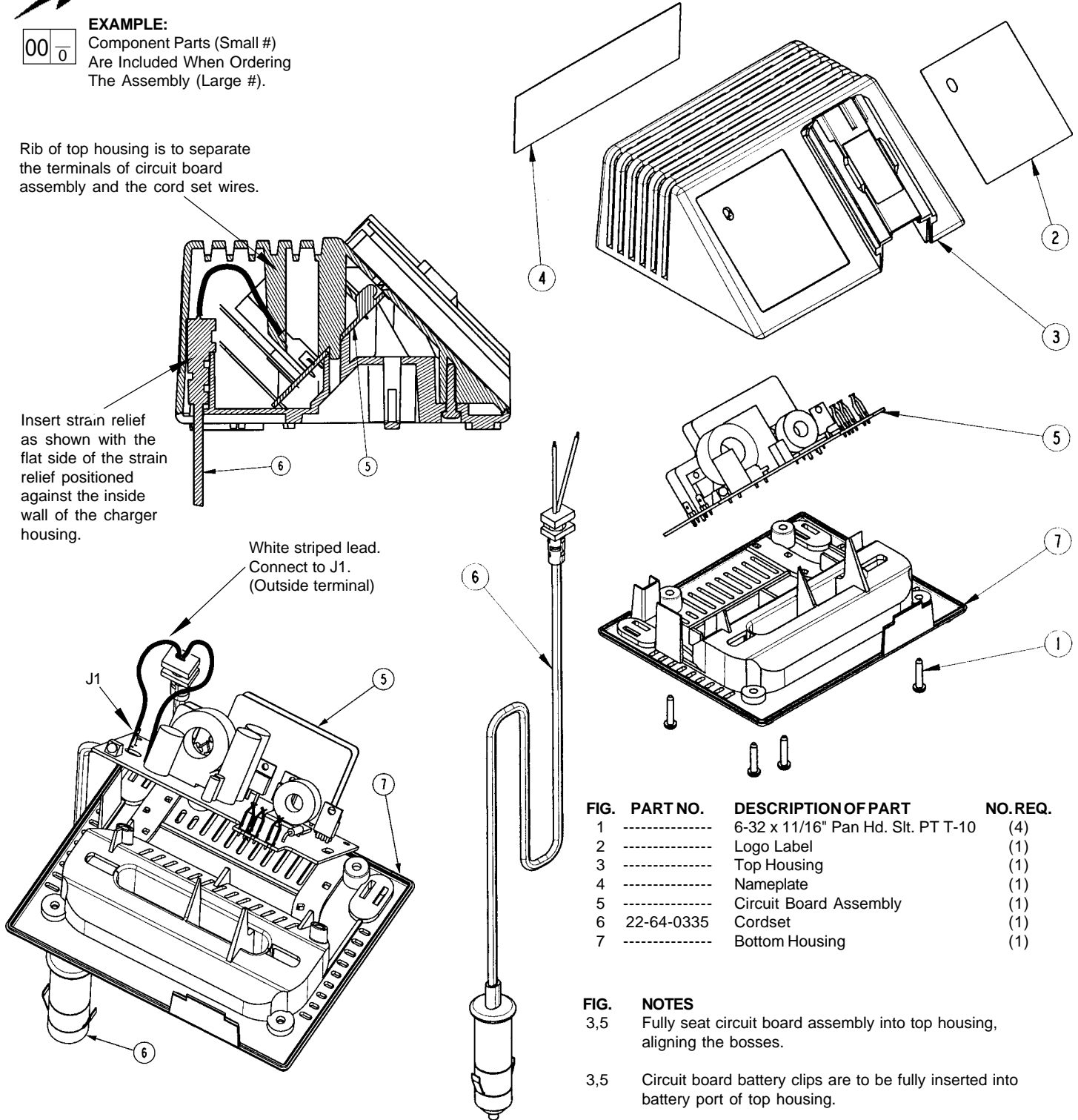

FIG.	PART NO.	DESCRIPTION OF PART	NO. REQ.
1	-----	6-32 x 11/16" Pan Hd. Slit. PT T-10	(4)
2	-----	Logo Label	(1)
3	-----	Top Housing	(1)
4	-----	Nameplate	(1)
5	-----	Circuit Board Assembly	(1)
6	22-64-0335	Cordset	(1)
7	-----	Bottom Housing	(1)

FIG. NOTES

- 3,5 Fully seat circuit board assembly into top housing, aligning the bosses.
- 3,5 Circuit board battery clips are to be fully inserted into battery port of top housing.
- 5,6 Cord set terminals are to be fully seated on mating terminals of printed circuit board assembly and perpendicular to printed circuit board surface.
- 3,6 Cord set to be free from conductor twists and cord crossover prior to installation of strain relief into top housing.

MILWAUKEE ELECTRIC TOOL CORPORATION
13135 W. LISBON RD., BROOKFIELD, WI 53005