



SERVICE PARTS LIST

1-1/4" TWO SPEED DRILL

Catalog No. 4297-1

Starting Serial No. **505-1001**

BUL. 54-14-4300

REVISED BUL. DATE
June '75

WIRING INSTRUCTIONS
58-01-0371

Specify Catalog and Serial No. when ordering parts

FOR CAT. NO. 4297-3 (240V) TOOLS USE:

- 18-86-1065 FIELD
- 16-86-1810 ARMATURE
- 22-64-2740 CORD SET
- 22-56-0285 STRAIN RELIEF

250/500 R.P.M.

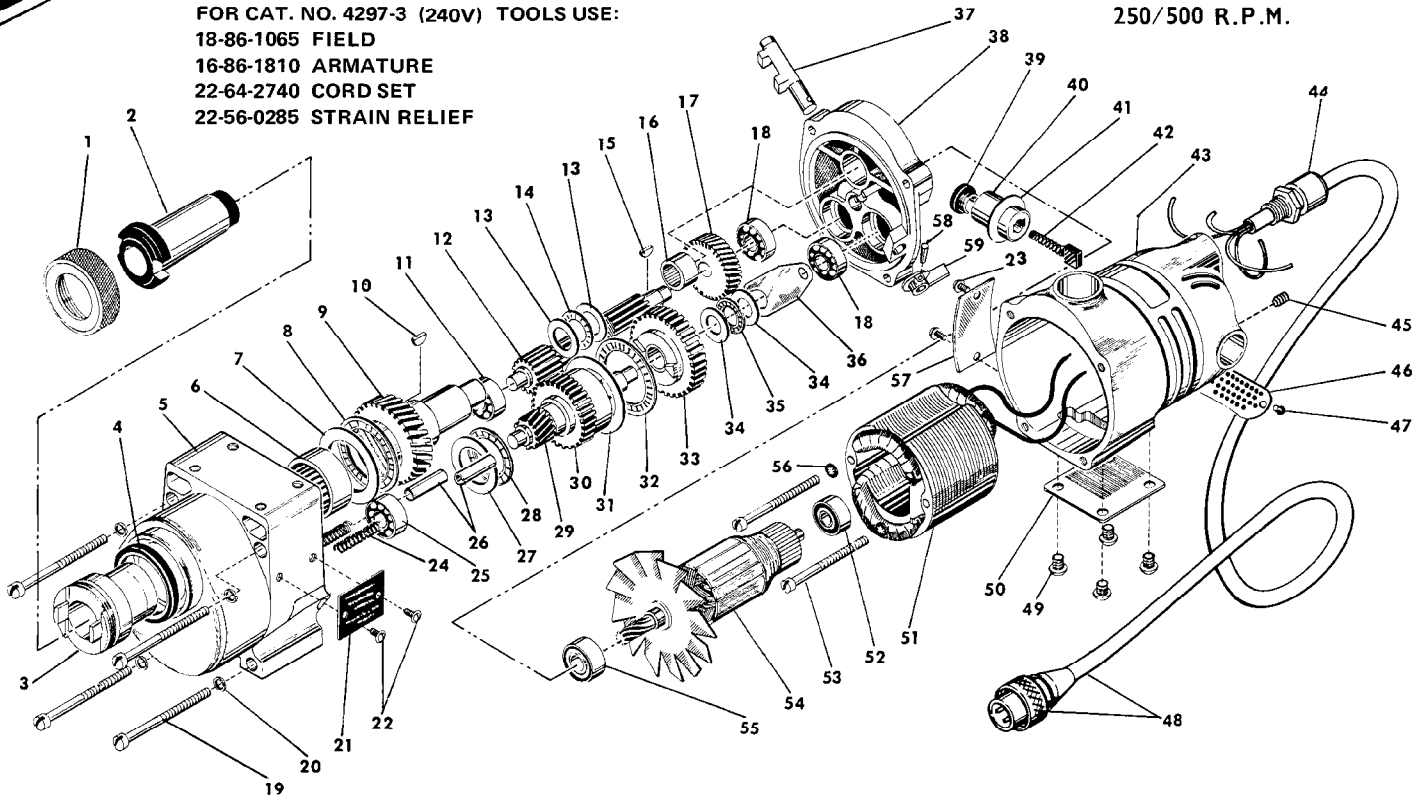

FIG.	PART NO.	DESCRIPTION OF PART	NO. REQ.	FIG.	PART NO.	DESCRIPTION OF PART	NO. REQ.
1	42-52-0050	Taper Socket Cap	(1)	31	45-88-0530	Thrust Bearing Washer	(1)
2	45-34-0050	#3 Taper Socket	(1)	32	02-80-5000	Thrust Bearing	(1)
3	38-50-4651	Spindle	(1)	33	32-10-0051	Clutch Gear Assembly	(1)
4	45-06-0100	Oil Seal	(1)	34	45-88-0510	Thrust Bearing Washer	(2)
5	28-14-1221	Gear Case	(1)	35	02-80-1200	Thrust Bearing	(1)
6	02-50-9975	Needle Bearing	(1)	36	45-98-0090	Shifting Yoke	(1)
7	45-88-0530	Thrust Bearing Washer	(1)	37	30-15-0051	Shifting Cam	(1)
8	02-80-5000	Thrust Bearing	(1)	38	28-28-1365	Diaphragm - Includes:	(1)
9	32-75-2581	Spindle Gear	(1)		06-65-0680	Groove Pin	(1)
10	06-42-2400	Woodruff Key	(1)	39	23-44-0030	Brush Retaining Screw	(2)
11	02-04-1260	Ball Bearing	(1)	40	22-22-0015	Brush Holder	(2)
12	36-66-3751	Pinion Shaft Assembly	(1)	41	23-86-0060	Brush Holder Washer	(2)
13	45-88-0515	Thrust Washer	(2)	42	22-18-0055	Carbon Brush	(2)
14	02-80-1525	Thrust Bearing	(1)	43	28-50-4121	Motor Housing	(1)
15	06-42-1600	Woodruff Key	(1)	44	22-56-0280	Strain Relief	(1)
16	02-50-4830	Needle Bearing	(1)	45	06-83-2650	1/4-20x3/8 Knrl. Set Screw	(2)
17	32-40-1581	Intermediate Gear	(1)	46	44-66-0180	Cover Plate	(1)
18	02-04-1205	Ball Bearing	(2)	47	06-81-8650	6-32x1/4 Rd. Hd. Sem	(2)
19	06-81-2125	1/4-20x3-1/2 Fil. Hd. Screw	(4)	48	22-64-0740	Cord Set	(1)
20	06-97-3800	Lockwasher	(4)	49	06-81-5000	1/4-20x3/8 Truss Hd. Screw	(4)
21	12-98-2105	Instruction Plate	(1)	50	44-66-0050	Body Cover Plate	(1)
22	06-81-4430	4-40x1/4 Rd. Hd. Screw	(2)	51	18-82-1070	120 V. Field	(1)
23	06-85-0200	6x1/4 Rd. Hd. Type Z Screw	(2)	52	02-04-1070	Ball Bearing	(1)
24	40-50-6300	Shifting Spring	(2)	53	06-81-1150	10-24x3-1/8 Fil. Hd. Screw	(2)
25	02-04-1260	Ball Bearing	(1)	54	16-82-1781	120 V. Rev. Armature	(1)
26	44-70-0100	Shifting Plunger	(2)	55	02-04-1265	Ball Bearing	(1)
27	45-88-0520	Thrust Bearing Washer	(1)	56	06-97-2200	Lockwasher	(2)
28	02-80-1800	Thrust Bearing	(1)	57	12-99-0040	Nameplate	(1)
29	36-14-0071	Pinion Clutch Shaft	(1)	58	06-65-0840	1/8x3/4 Groove Pin	(1)
30	32-10-0061	Clutch Gear Assembly	(1)	59	28-60-0051	Shift Knob Housing	(1)
				60	12-98-7081	Caution Plate (Not Shown)	(1)