



SERVICE PARTS LIST

BULLETIN NO.
54-14-4203

SPECIFY CATALOG NO. AND SERIAL NO. WHEN ORDERING PARTS		REVISED BULLETIN 54-14-4202	DATE Aug.'87
1-1/4" TWO SPEED DRILL			
CATALOG NO. 4292-1	STARTING SERIAL NO. 504-10560	WIRING INSTRUCTION 58-01-0375	
CAT. NO.	START SER. NO.	BILINGUAL LABEL	

FOR CAT. NO. 4292-3
(240 V.) TOOL USE:
16-76-0100 ARMATURE
18-76-0070 FIELD
22-64-2740 CORD SET
22-56-0286 STRAIN RELIEF

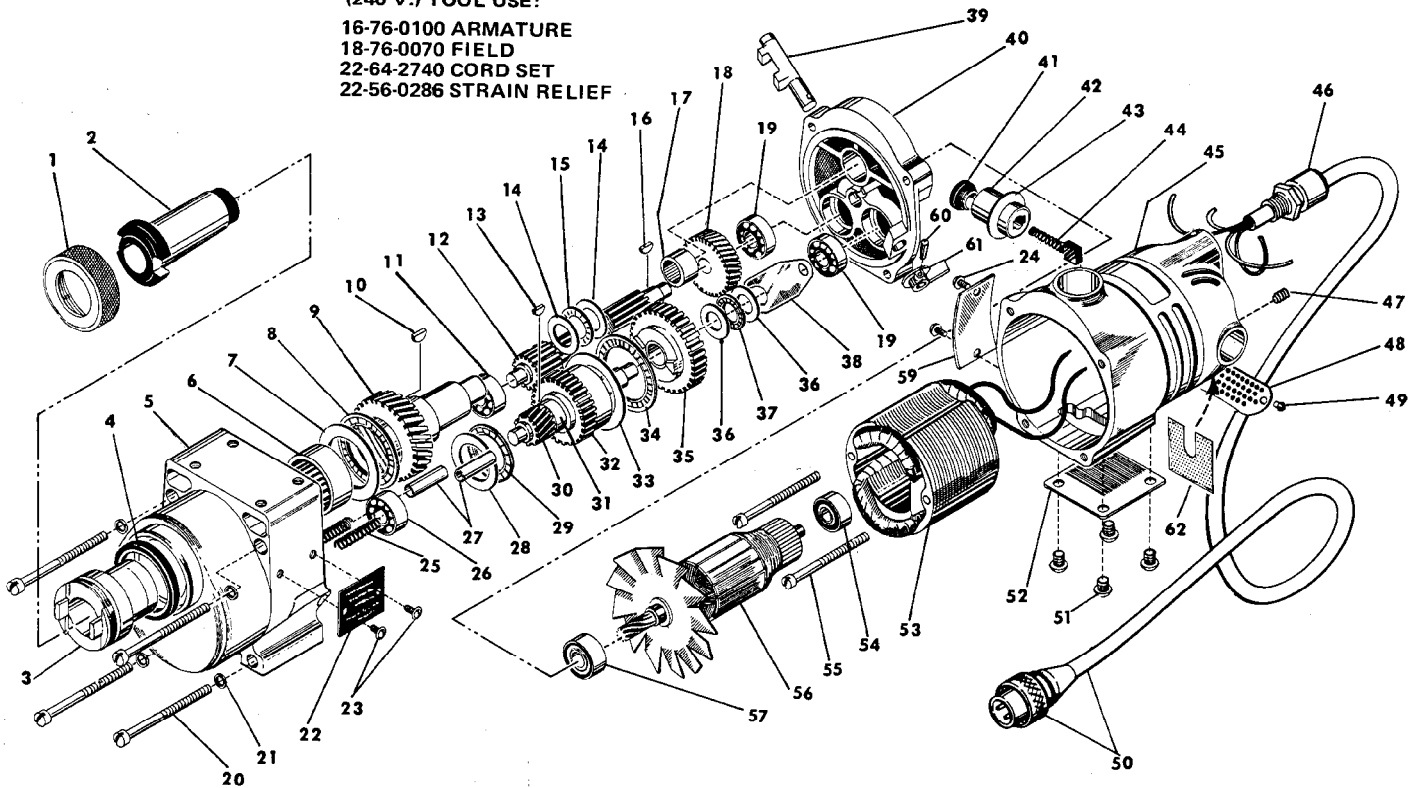

FIG.	PART NO.	DESCRIPTION OF PART	NO. REQ.	FIG.	PART NO.	DESCRIPTION OF PART	NO. REQ.
	1	42-52-0050 Taper Socket Cap	(1)	32	32-10-0061	Clutch Gear Assembly	(1)
	2	45-34-0050 #3 Taper Socket	(1)	33	45-88-0530	Thrust Bearing Washer	(1)
★	3	38-50-5490 Spindle	(1)	34	02-80-5000	Thrust Bearing	(1)
★	4	45-06-0380 Oil Seal	(1)	35	32-10-0051	Clutch Gear Assembly	(1)
★	5	28-14-1880 Gear Case Assy. (Includes 44-60-0320 Pivot Pin and 06-65-1535 Roll Pin)	(1)	36	45-88-0510	Thrust Bearing Washer	(2)
★	6	02-50-9970 Needle Bearing	(1)	37	02-80-1200	Thrust Bearing	(1)
	7	45-88-0530 Thrust Bearing Washer	(1)	38	45-98-0090	Shifting Yoke	(1)
	8	02-80-5000 Thrust Bearing	(1)	39	30-15-0055	Shifting Cam	(1)
	9	32-75-2561 Spindle Gear	(1)	40	28-28-1365	Diaphragm - Includes:	
	10	06-42-2400 Woodruff Key	(1)			Groove Pin	(1)
★	11	02-04-1205 Ball Bearing	(1)	41	23-44-0030	Brush Retaining Screw	(2)
	12	36-66-3751 Pinion Shaft Assembly	(1)	42	22-22-1015	Brush Holder	(2)
	13	06-42-2000 Woodruff Key	(1)	43	23-86-0060	Brush Holder Washer	(2)
	14	45-88-0515 Thrust Washer	(2)	44	22-18-0055	Carbon Brush	(2)
	15	02-80-1525 Thrust Bearing	(1)	45	28-50-4122	Motor Housing (Incl 45-30-0110 BB Rtnng. Slug)	(1)
	16	06-42-1600 Woodruff Key	(1)	46	22-56-0280	Strain Relief	(1)
	17	02-50-4830 Needle Bearing	(1)	47	06-83-2650	1/4-20x3/8 Knrl. Set Screw	(2)
	18	32-40-1581 Intermediate Gear	(1)	48	44-66-0180	Cover Plate	(1)
	19	02-04-1205 Ball Bearing	(2)	49	06-81-8650	6-32x1/4 Rd. Hd. Sem	(2)
	20	06-81-2125 1/4-20x3-1/2 Fil. Hd. Screw	(4)	50	22-64-0740	Cord Set	(1)
	21	06-97-3800 Lock Washer	(4)	51	06-81-5000	1/4-20x3/8 Truss Hd. Screw	(4)
	22	12-98-2105 Instruction Plate	(1)	52	44-66-0050	Body Cover Plate	(1)
	23	06-81-5789 4-40 x 1/4 Pan Hd. Taptite Screw	(2)	53	18-70-0070	120 V. Field	(1)
	24	06-85-0200 6x1/4 Rd. Hd. Type Z Screw	(2)	54	02-04-1070	Ball Bearing	(1)
	25	40-50-6300 Shifting Spring	(2)	55	06-81-9190	10-24x2-1/4 Rd. Hd. Sem	(2)
★	26	02-04-1205 Ball Bearing	(1)	56	16-70-0100	120 V. Rev. Armature	(1)
	27	44-70-0100 Shifting Plunger	(2)	57	02-04-1260	Ball Bearing	(1)
	28	45-88-0520 Thrust Bearing Washer	(1)	58	12-98-7082	Caution Plate (Not Shown)	(1)
	29	02-80-1800 Thrust Bearing	(1)	59	12-99-0040	Nameplate	(1)
	30	32-60-1041 Pinion Gear	(1)	60	06-65-0840	1/8x3/4 Groove Pin	(1)
	31	36-14-0061 Clutch Shaft	(1)	61	28-60-0056	Shift Knob	(1)
				62	23-16-0830	Arc Insulator	(1)