



SERVICE PARTS LIST

BUL. 54-46-2401

ADJUSTABLE BASE ELECTROMAG DRILL STAND

REVISED BUL. 54-46-2400 DATE Aug. '77

Catalog No. 4231

Starting Serial No. **500-1001**

WIRING INSTRUCTIONS
* SEE NOTE

Specify Catalog and Serial No. when ordering parts

FOR CAT. NO. 4231-2
(240V) DRILL STAND USE:
22-64-4000 CORD SET
42-20-0521 MAGNETIC BASE ASSEMBLY

*NOTE:
WIRING DETAILS ALONG WITH A LISTING OF COMPONENTS FOR (FIG. NO. 3) PANEL ASSEMBLY ARE SHOWN ON BULLETIN 54-30-0300.

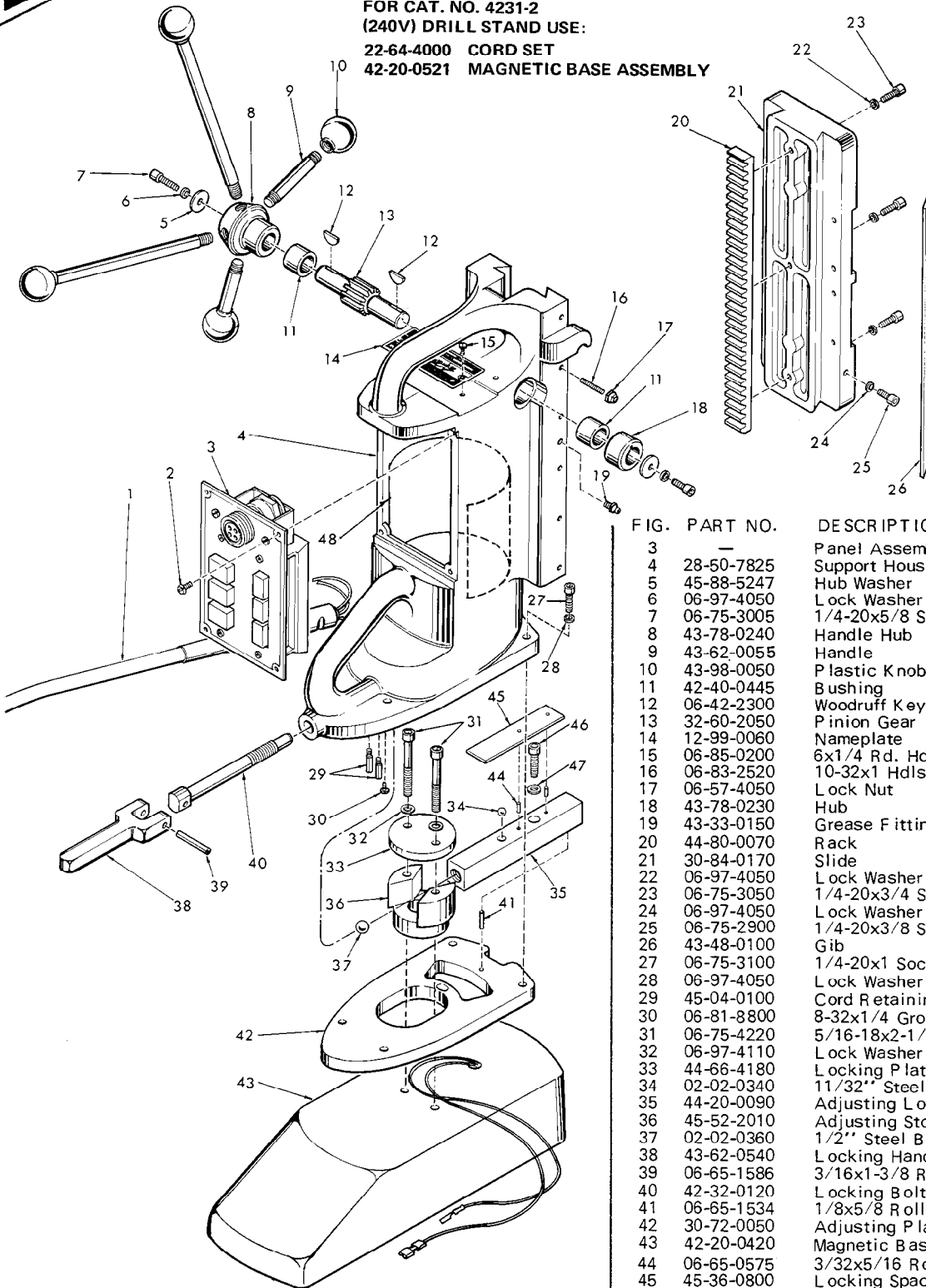

FIG.	PART NO.	DESCRIPTION OF PART	NO. REQ.
1	22-64-0075	Cord Set	(1)
2	06-81-5400	8-32x5/16 Binder Sems	(4)

FIG.	PART NO.	DESCRIPTION OF PART	NO. REQ.
	3	Panel Assembly (See Note)	(1)
	4	28-50-7825 Support Housing	(1)
	5	45-88-5247 Hub Washer	(2)
	6	06-97-4050 Lock Washer	(2)
	7	06-75-3005 1/4-20x5/8 Socket Hd. Screw	(2)
	8	43-78-0240 Handle Hub	(1)
	9	43-62-0055 Handle	(4)
	10	43-98-0050 Plastic Knob	(4)
	11	42-40-0445 Bushing	(2)
	12	06-42-2300 Woodruff Key	(2)
	13	32-60-2050 Pinion Gear	(1)
	14	12-99-0060 Nameplate	(1)
	15	06-85-0200 6x1/4 Rd. Hd. Type Z Screw	(4)
	16	06-83-2520 10-32x1 Hdls. Socket Screw	(6)
	17	06-57-4050 Lock Nut	(6)
	18	43-78-0230 Hub	(1)
	19	43-33-0150 Grease Fitting	(2)
	20	44-80-0070 Rack	(1)
	21	30-84-0170 Slide	(1)
	22	06-97-4050 Lock Washer	(3)
	23	1/4-20x3/4 Socket Hd. Screw	(3)
	24	06-97-4050 Lock Washer	(1)
	25	06-75-2900 1/4-20x3/8 Socket Hd. Screw	(1)
	26	43-48-0100 Gib	(1)
	27	06-75-3100 1/4-20x1 Socket Hd. Screw	(4)
	28	06-97-4050 Lock Washer	(4)
	29	45-04-0100 Cord Retaining Screw	(2)
	30	06-81-8800 8-32x1/4 Ground Screw	(1)
	31	06-75-4220 5/16-18x2-1/2 Socket Hd. Screw	(2)
	32	06-97-4110 Lock Washer	(2)
	33	44-66-4180 Locking P late	(1)
	34	02-02-0340 11/32" Steel Ball	(1)
	35	44-20-0090 Adjusting Lock	(1)
	36	45-52-2010 Adjusting Stop	(1)
	37	02-02-0360 1/2" Steel Ball	(1)
	38	43-62-0540 Locking Handle	(1)
	39	06-65-1586 3/16x1-3/8 Roll Pin	(1)
	40	42-32-0120 Locking Bolt	(1)
	41	06-65-1534 1/8x5/8 Roll Pin	(1)
	42	30-72-0050 Adjusting P late	(1)
	43	42-20-0420 Magnetic Base Assembly	(1)
	44	06-65-0575 3/32x5/16 Roll Pin	(2)
	45	45-36-0800 Locking Spacer	(1)
	46	06-75-3975 5/16-18x1 Socket Hd. Screw	(1)
	47	06-97-4110 Lock Washer	(1)
	48	23-16-0760 Panel Insulator	(1)
	49	12-98-7035 Instruction Plate (Not Shown)	(1)

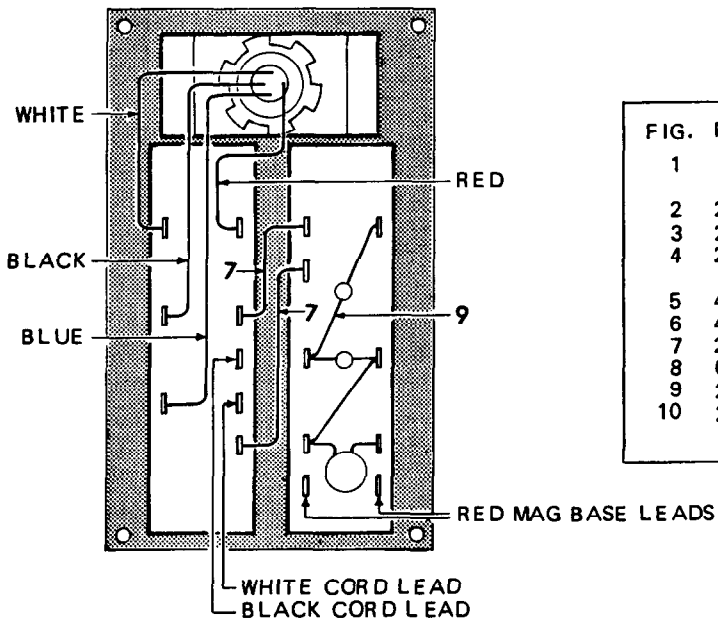
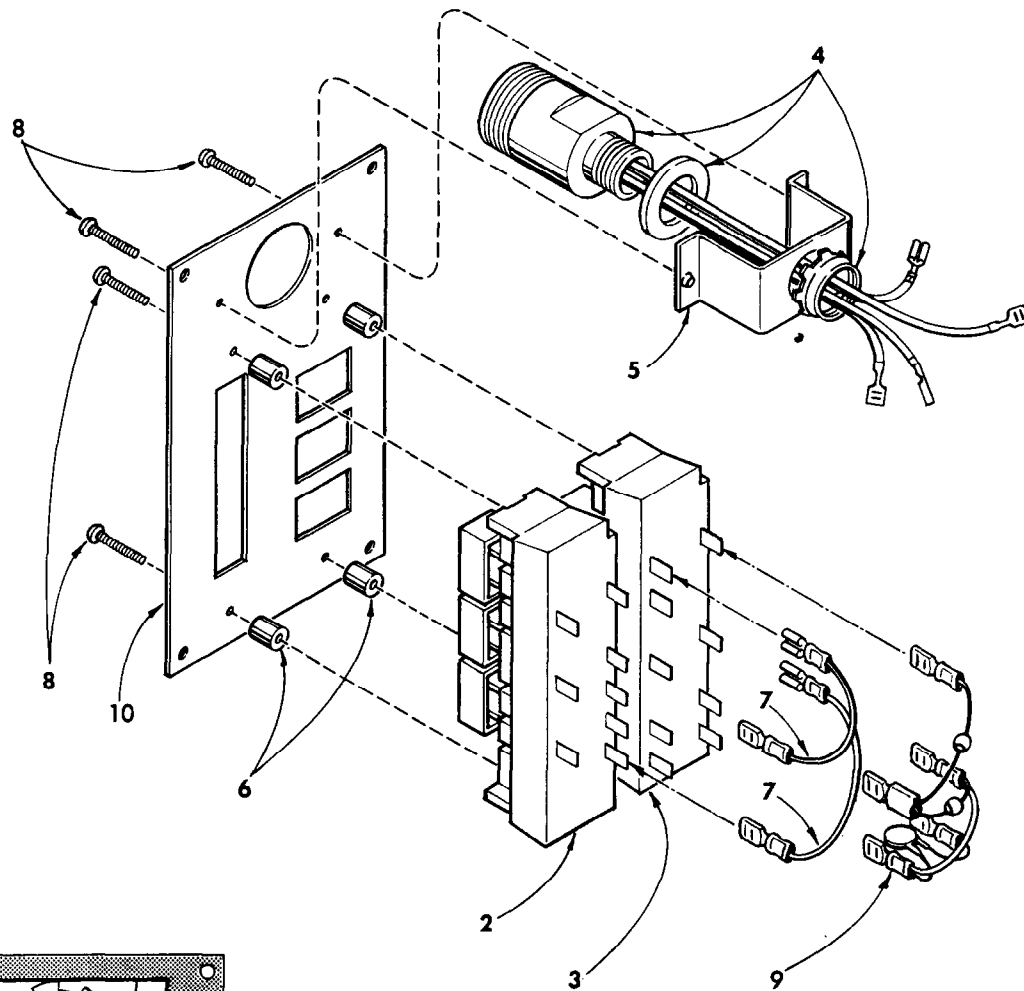

FIG.	PART NO.	DESCRIPTION OF PART	NO. REQ.
1	—	Mag Stand Panel Assembly (Includes Fig. Nos. 2 thru 10)	(1)
2	23-66-0935	Drill Switch	(1)
3	23-66-0930	Magnet Switch	(1)
4	23-33-0230	Receptacle Assy. (Socket, Rubber Washer & Nut)	(1)
5	42-36-0410	Mounting Bracket	(1)
6	45-36-0770	Spacer	(4)
7	23-46-0070	Jumper	(2)
8	06-85-0400	6-20x3/4 Phillips Pan Hd. Screw	(6)
9	23-38-2750	Rectifier Assembly (Includes Fig. 3)	(1)
10	23-35-0140	Panel	(1)

CORD SET PART NO. 22-64-0075		
WIRE	LENGTH	TERMINAL
Green	3-1/4"	23-74-0320
White	9"	23-74-0470
Black	9"	23-74-0470