

# PORTER-CABLE

## DRYWALL CUT-OUT UNIT

WARNING: Electrical repairs should only be attempted by trained repairmen. Contact the nearest Porter-Cable Service Center or other competent repair center

399

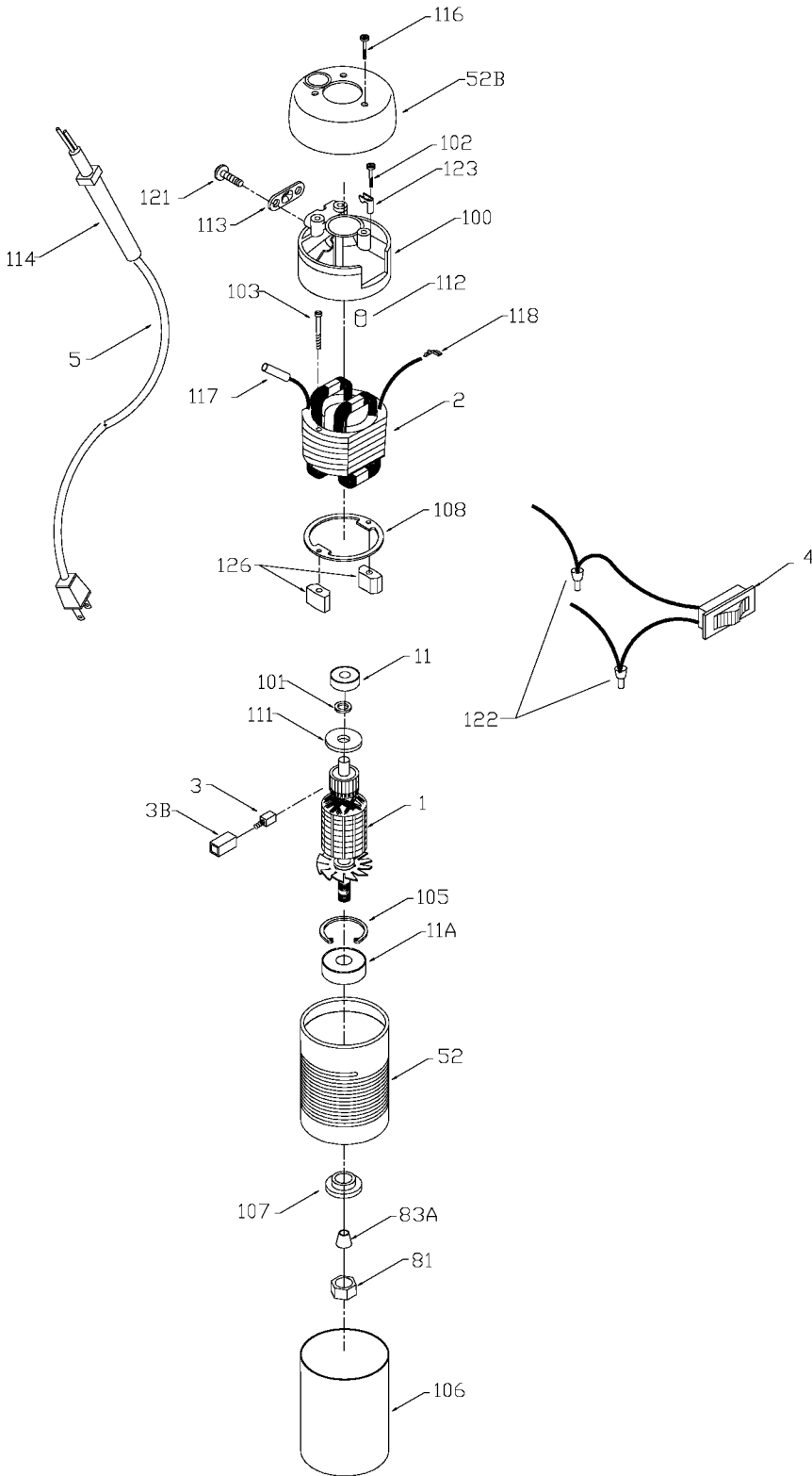

| Ref. No. | Part No.          | Description            |
|----------|-------------------|------------------------|
| 1        | n 883524          | Armature T1            |
| 2        | 681036**          | Field T1               |
| 3        | 850842            | Brush                  |
| 3B       | 849326            | Brush Holder           |
| 4        | n 882294          | Switch                 |
| 5        | n 872258          | Cord                   |
| 11       | 855216            | Commutator End Bearing |
| 11A      | 855287            | Fan End Bearing        |
| 52       | 683060**          | Motor Housing T1       |
| 52B      | 810315            | Motor Cap              |
| 81       | 844642            | Collet Nut             |
| 83A      | 844651            | Collet Nut             |
| 100      | 680735            | Motor Bracket          |
| 101      | 849328            | Spacer                 |
| 102      | 852554            | Brush Holder Screw     |
| 103      | 849821**          | Field Screw T1         |
| 105      | 802302            | Fan End Bearing Ring   |
| 106      | 694827            | Sleeve                 |
| 107      | 849826            | Fan End Bearing Ret.   |
| 108      | 849326            | Field Clamp Ring       |
| 111      | 849327            | Seal Washer            |
| 112      | 810425            | Comm. End Bearing Plug |
| 113      | 851630            | Cord Clamp             |
| 114      | 843464            | Cord Sleeve            |
| 116      | n 876384          | Motor Cap Screw        |
| 117      | 845757            | Insulating Sleeve      |
| 118      | 845946            | Terminal               |
| 121      | 802783            | Cord Clamp Screw       |
| 122      | 846249            | Wire Nut               |
| 123      | 852452            | Brush Holder Clip      |
| 126      | 810643            | Field Retainer         |
| *        | 44745             | Collet Wrench          |
| *        | 810286            | Fan                    |
| *        | 43218             | Bit                    |
| *        | See Service Notes |                        |

## Parts List for 399 Type 1

| Item Number | Part Number | Description         | Qty Required |
|-------------|-------------|---------------------|--------------|
| 1           | 883524      | ARMATURE            | 1            |
| 1           | 810286      | FAN                 | 1            |
| 2           | 681036      | FIELD 115V          | 1            |
| 3           | 850842      | BRUSH               | 2            |
| 3           | 849326      | BRUSH HOLDER        | 2            |
| 4           | 911374      | SWITCH              | 1            |
| 5           | 330072-97   | CORD/10 FT/18-2     | 1            |
| 11          | 855216      | BEARING             | 3            |
| 11          | 874538      | BALL BEARING        | 3            |
| 52          | 683060      | MOTOR HOUSING       | 1            |
| 52          | 699634      | CAP                 | 1            |
| 81          | 691257      | NUT COLLET          | 10           |
| 83          | 684718      | COLLET              | 1            |
| 100         | 684228      | MOTOR BRACKET       | 1            |
| 101         | 849328      | SPACER              | 10           |
| 102         | 852554      | SCREW               | 10           |
| 103         | 849821      | SCREW               | 10           |
| 105         | 802302      | RING                | 10           |
| 106         | 000000-00   | No Longer Available | 1            |
| 107         | 849826      | RETAINER            | 10           |
| 108         | 849326      | BRUSH HOLDER        | 2            |
| 111         | 849327      | SEAL                | 1            |
| 112         | 810425      | PLUG                | 1            |
| 113         | 851630      | CLAMP               | 1            |
| 114         | 901266      | STRAIN RELIEVER     | 1            |
| 116         | 876384      | SCREW               | 10           |
| 117         | 845757      | SLEEVE              | 1            |

## Parts List for 399 Type 1

| Item Number | Part Number | Description        | Qty Required |
|-------------|-------------|--------------------|--------------|
| 118         | 845946      | TERMINAL           | 1            |
| 121         | 802848      | SCREW              | 10           |
| 122         | 846249      | NUT                | 10           |
| 123         | 852452      | CLIP               | 1            |
| 126         | 810643      | RETAINER           | 10           |
| 127         | 683875      | WRENCH OPEN END    | 1            |
| 127         | 683875      | WRENCH OPEN END    | 1            |
| 128         | 43218       | DRYWALL CUTOUT BIT | 1            |