



SERVICE PARTS LIST

BUL. 54-12-2020

5/8" ELECTRIC DRILL

REVISED BUL 663-1 DATE FEB. '68

MODEL NO. **D-582**

Starting Serial No. **63-1001**

WIRING INSTR.

Both Model and Serial No. must be furnished to obtain correct parts.

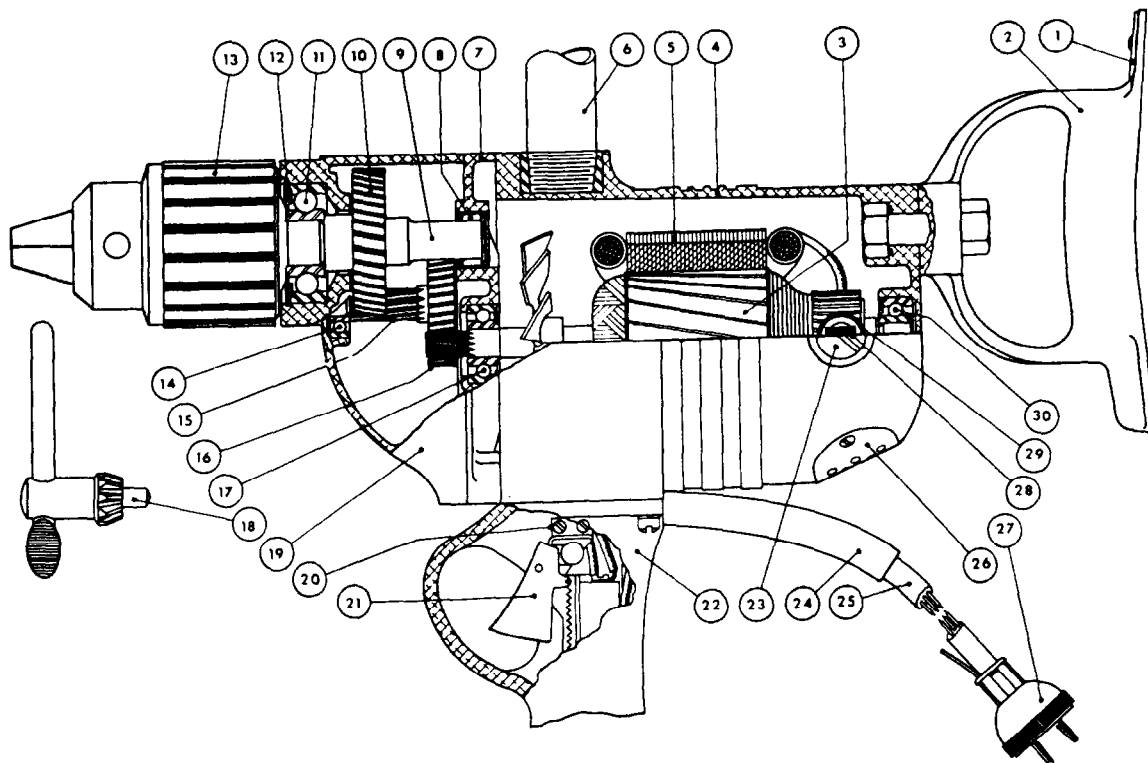

Fig. Part No. Name of Part

1	88D1-6	Spade Handle Key Clip
2	88D1-3A	Spade Handle
3	58D-600B	Armature Assembly
4	23D-1	Body or Motor Housing
5	23C-700A	Field Assembly
6	88D-43	Pipe Handle
7	2D-2	Diaphragm
8	MH-1081	Spindle Needle Bearing
9	5CK-8A	Spindle
10	7CK-11A	Spindle Gear
11	ND8603	Spindle Ball Bearing
12	RR-185	Spindle Ball Brg. Retaining Ring
13	5/8"-3B	Chuck (5/8"-16 Thrd.)
14	ND7039	Inter. Shaft Ball Bearing
15	5CK-13A	Intermediate Shaft

Fig. Part No. Name of Part

16	89D-14	Intermediate Gear
17	WC8011	Armature Ball Brg. (Pinion End)
18	5/8" #3	Chuck Key
19	2D-3	Gear Case
20	88D-23	Switch Bracket
21	CH8636K1	Switch
22	88D1-1A	Switch Handle
23	88D-400	Brush Retaining Screw Ass'y.
24	88D-48	Cord Protector Tube
25	S#16-3	Cord (3-Wire) (per ft.)
26	23D-41	Air Intake Cover Plate
27	2	Prong Attachment Plug
28	88D-370	Carbon Brush Assemblies (per set 2)
29	88D-320	Brush Holder Assembly
30	ND8500	Armature Ball Bearing (Comm.End)

MISCELLANEOUS PARTS (NOT SHOWN)

<u>Size or Part No.</u>	<u>Description of Part</u>	<u>Size or Part No.</u>	<u>Description of Part</u>
MH 681	Inter. Shaft Needle Bearing	1/4"-20x1" Fil. Hd.	Gear Case Screws (2)
D-582	Name Plate	1/4"-20x1-3/4" Fil.Hd.	Gear Case Screws (2)
1/2"-13x1-1/2"Hex.Hd.	Spade Handle Bolt (1)	8-32x2-1/2" Rd. Hd.	Field Screws (2)
1/2"-13	Spade Handle Jam Nut (1)	1/4"-20x3/4" Fil. Hd.	Switch Handle Screws (4)
#4x5/16" Driv-In	Spade Handle Key Clip Screw (1)	1/4"-20x1/2" H'dless	Brush Holder Set Screws (2)
6-32x1/4" Rd. Hd.	Switch Mounting Screws (2)	#8	Kantlink Lock Washers (2)
6-32x1/4" Fil. Hd.	Switch Bracket Screws (2)	#14	Kantlink Lock Washers (10)
#4x5/16" Driv-In	Name Plate Screws (2)	#2	Woodruff Keys (2)
#6x1/4" P. K.	Air Intake Plate Screws (2)	#3	Woodruff Keys (1)